



2022-23 WINTER COLLECTION

NEW CABINET ACCESSORY PRODUCTS



TIERED MAXX DRAWER



- Designed for 24" base face frame cabinet drawers
- Complete drawer system, just add your drawer front
- Easy installation
- Natural maple construction with semi-gloss finish
- Full-extension, BLUM soft-close undermount slides
- 5/8" drawer side walls
- (5) drawer compartments
- Comes with (8) short dividers, (5) long dividers and (26) clips
- Mounts to cabinet drawer front, rear and sidewalls
- Figure 8 door mount brackets
- TSCA Title VI compliant



Tiered MAXX Drawer w/ BLUMOTION Soft-Close

PRODUCT	DESCRIPTION	DIMS	MCO	CAB	FINISH
4WTMD24HSC1	Tiered Maxx Drawer	21" (533 mm) W x 21-17/32" (547 mm) D x 4-11/32" (111 mm) H	FF: 21" (533 mm) FL: 21" (533 mm)	B24	Maple

CHROME UNIVERSAL WASTE PULLOUT



- Designed for 15" and 18" base cabinets and 27", 30" and 33" Sink Base
- Universal frame configuration
- Single 20 and 32 qt. polymer containers, gray
- Chrome-plated welded wire frame
- Full-extension, ball-bearing, 100 lb. rated slides
- Clip-on handle
- RB versions come with a rear storage basket
- 4-screw installation
- Mounts to cabinet floor

Chrome Universal Waste Pullout

PRODUCT	DESCRIPTION	DIMS	MCO	CAB	FINISH
RUKD8201	Single 20 qt.	8-5/8" (219 mm) W x 15-3/4" (400 mm) D x 16-5/8" (422 mm) H 14-1/2" (368 mm) W x 15-3/4" (400 mm) D x 16-5/8" (422 mm) H	8-1/2" (216 mm) 14-1/2" (368 mm)	B12 B18	Gray/Chrome
RUKD1420RB1	Single 20 qt. w/ Rear Basket	14-1/2" (368 mm) W x 15-3/4" (400 mm) D x 16-5/8" (422 mm) H	14-1/2" (368 mm)	B18	Gray/Chrome
RUKD9321	Single 32 qt.	9-3/8" (238 mm) W x 15-3/4" (400 mm) D x 19-1/2" (495 mm) H 14-1/2" (368 mm) W x 16-7/16" (418 mm) D x 19-1/2" (495 mm) H	9-1/2" (241 mm) 14-1/2" (368 mm)	B12	Gray/Chrome
RUKD1432RB1	Single 32 qt. w/ Rear Basket	14-1/2" (368 mm) W x 16-7/16" (418 mm) D x 19-1/2" (495 mm) H	14-1/2" (368 mm)	B18	Gray/Chrome

WOOD UTENSIL TRAY INSERT



- Designed for 36" or smaller base cabinet drawers
- New shallow drawer version (2-3/8" height)
- Trim-to-fit existing drawer
- Drop-in installation
- Natural maple construction with semi-gloss finish or walnut construction with satin finish
- Up to (2) adjustable compartments
- Up to (12) static compartments
- Shallow height sizes available
- TSCA Title VI compliant

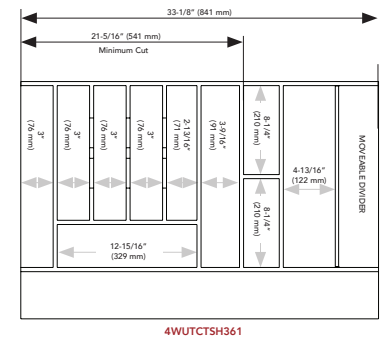
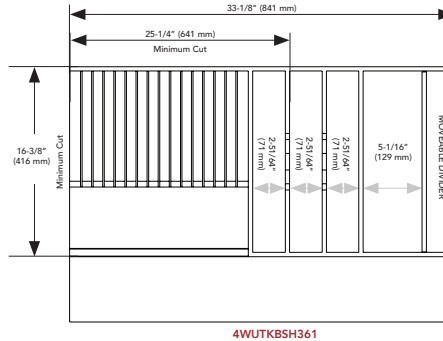
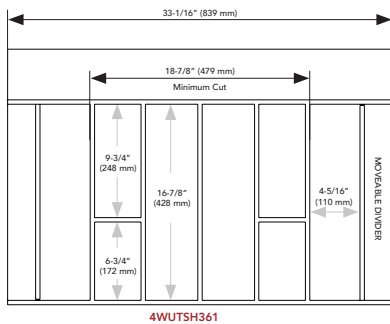

Shallow Wood Utensil Tray Insert

PRODUCT	DESCRIPTION	DIMS	FINISH
4WUT36SH1	Shallow Height Utensil Drawer Insert	33-1/8" (841 mm) W x 22" (559 mm) D x 2-3/8" (60 mm) H	Maple
4WUTCT36SH1	Shallow Height Utensil/Cutlery Drawer Insert	33-1/8" (841 mm) W x 22" (559 mm) D x 2-3/8" (60 mm) H	Maple
4WUTKB36SH1	Shallow Height Knife Block/Utensil Drawer Insert	33-1/8" (841 mm) W x 22" (559 mm) D x 2-3/8" (60 mm) H	Maple

SWIVEL SHELF PULLOUT



- Designed for 9" and 12" full height face frame base cabinets
- Natural maple construction with a semi-gloss finish
- Blum slides w/ soft-close
- Patent-pending design
- Built-in "Extension Lock"
- Adjustable rear wall
- (2) swivel shelves with built-in self-centering axis system
- Adjustable accessory top shelf
- Chrome accents
- Patented door mount brackets provide 5" of door mounting adjustability and include micro door trim adjustment (US Patent No. 8,388,076)
- Mounts to cabinet door and floor
- TSCA Title VI Compliant

Swivel Shelf Pullout

PRODUCT	DESCRIPTION	DIMS	MCO	CAB	FINISH
448SWBCSC5C	Swivel Shelf Pullout	6" (152 mm) W x 22-25/32" (579 mm) D x 25-1/2" (648 mm) H	FF: 5-3/4" (146 mm) FL: 6" (152 mm)	FHB9	Maple
448SWBCSC8C	Swivel Shelf Pullout	8-3/4" (222 mm) W x 22-25/32" (579 mm) D x 25-1/2" (648 mm) H	FF: 8-3/4" (222 mm) FL: 9" (229 mm)	FHB12	Maple

CASSEROLE DISH ORGANIZER



- Designed for 18" and 24" base cabinets
- Natural maple dovetail construction with semi-gloss finish
- Blum slides w/ soft-close
- Customize drawer compartment with included removable dividers
- Up to (6) dividers and (12) clips
- Mounts to cabinet floor
- TSCA Title VI compliant

Casserole Dish Organizer

PRODUCT	DESCRIPTION	DIMS	MCO	CAB	FINISH
4CDS18SC1	Casserole Dish Organizer	14-1/2" (368 mm) W x 22-1/4" (565 mm) D x 10-1/2" (267 mm) H	FF: 14-1/2" (368 mm) FL: 14-1/2" (368 mm)	B18	Maple
4CDS24SC1	Casserole Dish Organizer	20-1/2" (521 mm) W x 22-1/4" (565 mm) D x 10-1/2" (267 mm) H	FF: 20-1/2" (521 mm) FL: 20-1/2" (521 mm)	B24	Maple

WOOD PLATE DIVIDER INSERT



- Designed for 36" or 33" (3) drawer base cabinet
- Natural maple construction with semi-gloss finish
- Trim-to-fit existing drawer
- Drop-in installation
- (16) compartments
- Holds (8) small plates up to 1" thick, and 8-1/4" in diameter and (8) large plates 1-1/4" thick, and 10-3/4" in diameter
- TSCA Title VI compliant

Wood Plate Divider Insert

PRODUCT	DESCRIPTION	DIMS	MCO	FINISH
4PDI36	36" Wood Plate Divider Insert	33-3/32" (841 mm) W x 22" (550 mm) D x 3-3/32" (79 mm) H	DB36-3 & DB33-3	Maple

Minimum Trim: 28-1/2 (571 mm) x 18" (457 mm)

PILASTER UTENSIL PULLOUT



- Pullout drawer designed for 18" and 24" base cabinets
- Designed to be used with our 4PIL-21* Pilaster uprights
- Natural maple dovetail construction with semi-gloss finish
- Included accessories; (1) 2 qt. and (2) 1.25 qt. stainless steel bins and (1) chrome wire basket w/ 18" or (2) 2 qt. and (3) 1.25 qt. stainless steel bins and (1) chrome wire basket w/ 24"
- Mounts to cabinet side walls
- Blum slides w/ soft-close
- Mount to Pilaster Rails (sold separately)
- TSCA Title VI compliant

**Designed to be used with our 4PIL-21* Pilaster uprights*



Pilaster Utensil Pullout

PRODUCT	DESCRIPTION	DIMS	MCO	CAB	FINISH
4PUT18SC1	Pilaster Utensil Pullout	13-13/16" (350 mm) W x 21-21/32" (550 mm) D x 8-7/8" (253 mm) H	FF: 15" (381 mm) FL: 15" (381 mm)	B18	Maple
4PUT24SC1	Pilaster Utensil Pullout	19-13/16" (503 mm) W x 21-21/32" (550 mm) D x 8-7/8" (253 mm) H	FF: 21" (533 mm) FL: 21" (533 mm)	B24	Maple

UTENSIL PULLOUT



- Designed for 18" and 24" base cabinets
- Natural maple dovetail construction with a semi-gloss finish
- Blum slides w/ soft-close
- (1) drawer
- Includes one pull-out utensil drawer, Blumotion soft close slides, and adjustable spacers for side mounting.
- Mounts to cabinet rear and side walls



Utensil Pullout

PRODUCT	DESCRIPTION	DIMS	MCO	CAB	FINISH
4WDUT18SCSM1	Side Mount Utensil Pullout	16-7/16" (418 mm) - 17-9/16" (446 mm) W x 21-21/32" (550 mm) D x 8-7/8" (253 mm) H	FF: 15" (381 mm) FL: 15" (381 mm)	B18	Maple
4WDUT24SCSM1	Side Mount Utensil Pullout	22-7/16" (570 mm) - 23-9/16" (598 mm) W x 21-21/32" (550 mm) D x 8-7/8" (253 mm) H	FF: 21" (533 mm) FL: 21" (533 mm)	B24	Maple

USB CHARGING DRAWER



- Designed for 18" full access base cabinet drawers
- Natural maple construction with semi-gloss finish
- Blum slides w/ soft-close
- In-drawer receptacle with thermal fuse protection, (4) 2.1-amp USB-A ports and (1) USB-C adapter
- The thermal fuse senses abnormal temperature and shuts off electrical power to the load on the outlet when overheating occurs.
- Max Current: USB 4.2 amp
- UL Recognized to UL962/CSA-C22.2 No. 0-10
- Power cord with NEMA 5 -15 plug
- Integrated cord guide to ensure safe operation
- Additional front storage compartment
- Door mount brackets
- Shock absorbent mat, black
- Mounts to cabinet door, rear and side walls
- Drawer front (NOT) included
- The overall safety of this product is determined by its end use
- TSCA Title VI compliant

USB Charging Drawer

PRODUCT	DESCRIPTION	DIMS	MCO	CAB	FINISH
4WCDB18FLSC1USB	USB Charging Drawer	16-1/2" (419 mm) W x 23-1/2" (597 mm) D x 4-5/16" (110 mm) H	16-1/2" (419 mm)	FLB18	Maple

WIRE DOOR MOUNT WASTE CONTAINER



- Designed for 30" sink base cabinets
- Single 8 L polymer container, metallic silver
- Built-in hand towel rack
- Chrome-plated wire frame
- Extended mounting bar included
- Extended mounting bar
- Mounts to cabinet door
- (1) white lid included

Wire Door Mount Waste Container

PRODUCT	DESCRIPTION	DIMS	MCO	CAB	FINISH
5SOWC81	Single 8 Liter Wire Door Mount Waste Container	8-7/8" (225 mm) W x 7-25/32" (198 mm) D x 13-17/32" (344 mm) H	12" (305 mm)	VB30	Gray

BASE CABINET PULLOUT W/ UTENSIL BINS



- Designed for 9", 12" and 15" full height base cabinets
- Natural maple construction with semi-gloss finish
- Full-extension, 135 lb. slides with BLUMOTION soft-close
- (3) 1.25 qt. or (3) 2 qt. or (6) 1.25 qt. stainless steel bins
- Adjustable shelves and rear wall for added stability
- Adjustable rub bushings that prevent side to side movement
- Patented door mount brackets (US Patent No. 8,388,076)
- TSCA Title VI Compliant

Base Cabinet Pullout w/ Utensil Bins and BLUMOTION Soft-Close

PRODUCT	DESCRIPTION	DIMS	MCO	CAB	FINISH
448UTBCSC6C	Base Organizer	7-1/8" (184 mm) W x 21-5/8" (549 mm) D x 25-1/2" (648 mm) H	FF: 7-1/2" (191 mm) FL: 7-1/2" (191 mm)	FLFHB9	Maple
448UTBCSC9C	Base Organizer	10-1/8" (260 mm) W x 21-5/8" (549 mm) D x 25-1/2" (648 mm) H	FF: 10-1/2" (268 mm) FL: 10-1/2" (268 mm)	FLFHB12	Maple
448UTBCSC11C	Base Organizer	11-5/8" (298 mm) W x 21-5/8" (550 mm) D x 25-1/2" (648 mm) H	FF: 11-1/2" (292 mm) FL: 12" (305 mm)	FHB15	Maple

BASE CABINET PULLOUT W/TRAY DIVIDER/FOIL WRAP HOLDER



- Designed for 9" and 12" base cabinets
- Natural maple construction with semi-gloss finish
- Blum slides w/ soft-close
- Removable center divider T-Bar divider for taller items
- Patented door mount brackets provide 5" of adjustability (US Patent No. 8,388,076)

Base Cabinet Pullout Tray Divider/Foil Wrap Holder w/ BLUMOTION Soft-Close

PRODUCT	DESCRIPTION	DIMS	MCO	CAB	FINISH
447BCSC6C	Base Tray Divider Pullout	7-1/8" (184 mm) W x 21-5/8" (549 mm) D x 19-1/2" (495 mm) H	FF: 7-1/2" (191 mm) FL: 7-1/2" (191 mm)	FLB9	Maple
447BCSC9C	Base Tray Divider Pullout	10-1/8" (260 mm) W x 21-5/8" (549 mm) D x 19-1/2" (495 mm) H	FF: 10-1/2" (268 mm) FL: 10-1/2" (268 mm)	FLB12	Maple

BASE CABINET PULL-OUT W/KNIFE BLOCK & UTENSIL BINS



- Designed for 9" full height full access cabinets
- Natural maple construction with a semi-gloss finish
- Adjustable shelves with chrome rails
- Patented door mount brackets provide 5" of door mounting adjustability and include micro door trim adjustment (US Patent No. 8,388,076)
- Blum slides w/ soft-close
- Mounts to cabinet door and floor
- (1) 1.25 qt. and (1) 2.0 qt. removable stainless steel bins
- TSCA Title VI Compliant

Base Cabinet Pullout w/ Knife Block and Utensil Bins w/ BLUMOTION Soft-Close

PRODUCT	DESCRIPTION	DIMS	MCO	CAB	FINISH
448KBBCSC6CC	Base Organizer	7-1/8" (184 mm) W x 21-5/8" (549 mm) D x 25-1/2" (648 mm) H	FF: 7-1/2" (191 mm) FL: 7-1/2" (191 mm)	FLFHB9	Maple



 **REV·A·SHELF**

 **Richelieu**
www.richelieu.com

Serving you across North America

CANADA

Tel.: 1 800 361-6000
Fax: 1 800 363-0193

UNITED STATES

Tel.: 1 800 619-5446
Fax: 1 800 876-7454



Follow us on



RASFC22E