



Available Finishes:



Black (BL)



Nickel (NI)

3W EquiLine Puck

With recessed or surface mount ability, EquiLine LED Pucks are perfect for use in a wide range of applications. Designed for the economically conscious, they feature a slim profile and a 79" (2 m) starter cord attached with an unattached AMP® connector for easy wire routing.

Part #	Description
LPOC3EQFRCBL10	3W EQUILINE PUCK 5000K BLACK
LPOC3EQFRCNI10	3W EQUILINE PUCK 5000K NICKEL
LPOC3EQFRWBL10	3W EQUILINE PUCK 3000K BLACK
LPOC3EQFRWNI10	3W EQUILINE PUCK 3000K NICKEL
Accessories	
LSMR2LEDBL	SURFACE MOUNT RING, BLACK
LSMR2LEDNI10	SURFACE MOUNT RING, NICKEL
LLEDLINKD245	96" EXTENSION CORD FOR PUCK LIGHTS

218 Lumens



FineLine 2.0

330 Lumens per ft.
(1082 per meter)



Pencil thin but still packing a big punch, FineLine is the unobtrusive way to provide stunning lighting to casework, displays, store fixtures and more. The low-profile design features a milk diffuser for even illumination, Luniform technology, and with optional manual or remote-control dimmers, creating the perfect atmosphere is effortless.



Part #	Description
LSTKH08CNI	4.4W/FT 8" FINELINE 2.0 5000K
LSTKH012CNI	4.4W/FT 12" FINELINE 2.0 5000K
LSTKH022CNI	4.4W/FT 22" FINELINE 2.0 5000K
LSTKH034CNI	4.4W/FT 34" FINELINE 2.0 5000K
LSTKH08WNI	4.4W/FT 8" FINELINE 2.0 3000K
LSTKH012WNI	4.4W/FT 12" FINELINE 2.0 3000K
LSTKH022WNI	4.4W/FT 22" FINELINE 2.0 3000K
LSTKH034WNI	4.4W/FT 34" FINELINE 2.0 3000K

Accessories

LLEDLINKD245	96" EXTENSION CORD FOR FINELINE 2.0 LIGHTS
LLEDSTKLNK5	2" FINELINE 2.0 JUMPER CORD
LLEDSTKLNK15	6" FINELINE 2.0 JUMPER CORD
LLEDSTKLNK25	10" FINELINE 2.0 JUMPER CORD
LLEDSTKLNK60	24" FINELINE 2.0 JUMPER CORD
LLEDSTKLNK120	48" FINELINE 2.0 JUMPER CORD
LLEDSTKLNK180	72" FINELINE 2.0 JUMPER CORD

NOTE: 79" Starter Cord, AMP Connector and Mounting U-Clips are included with each light



Straight and adjustable mounting U-clips included



Pencil thin, 5/16" (8 mm) low-profile design



FlexTape®

A unique design makes our Tape Lighting the most versatile LED light on earth. Curve them under frosted glass to create a stunning display or run them under shelving for continuous illumination. The tape features an adhesive backing for easy peel-and-stick installation.

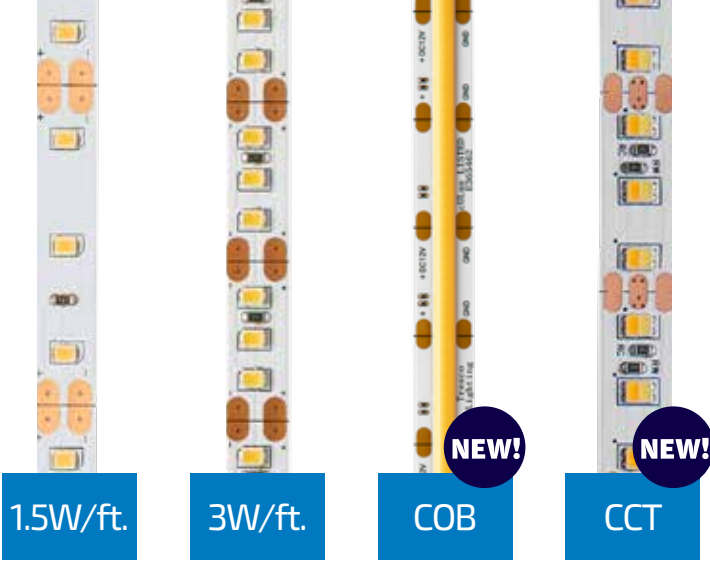

LRGBCCTRMT



LWLDCTWH

Part #	Description
Single Color FlexTape®	
LTPELED30SER	1.5W/FT 20' EQUILINE TAPE ROLL 3000K
LTPELED48SER	1.5W/FT 20' EQUILINE TAPE ROLL 4800K
LTPELED30HER	3W/FT 16.4' EQUILINE TAPE ROLL 3000K
LTPELED48HER	3W/FT 16.4' EQUILINE TAPE ROLL 4800K
LFLXCOB1230RV	4.4W/FT 13' COB FLEXTAPE ROLL 3000K
LFLXCOB1248RV	4.4W/FT 13' COB FLEXTAPE ROLL 4800K
Single Color FlexTape® Accessories	
LLEDTPEPKT2M	79" FLEXTAPE STARTER CORD W/WRENCH
LLEDLINKD245	96" FLEXTAPE EXTENSION CORD FOR TAPE STARTER LEAD
LLEDTPELNK5	2" FLEXTAPE JUMPER CORD
LLEDTPELNK15	6" FLEXTAPE JUMPER CORD
LLEDTPELNK25	10" FLEXTAPE JUMPER CORD
LLEDTPELNK60	24" FLEXTAPE JUMPER CORD
LLEDTPELNK120	48" FLEXTAPE JUMPER CORD
LLEDTPELNK180	72" FLEXTAPE JUMPER CORD
White Tunable FlexTape®	
LFLXTPE12CCT	3W/FT 16.4' WHITE TUNABLE FLEXTAPE ROLL (2700K - 6500K)
White Tunable FlexTape® Accessories	
LTPEPKT2MCCT	79" WHITE TUNABLE FLEXTAPE STARTER CORD
LCCTEXT120	48" WHITE TUNABLE FLEXTAPE EXTENSION CORD FOR STARTER LEAD
L4P60	6 OUTPUT ADAPTOR TO RUN MULTIPLE WHITE TUNABLE STARTER CORDS OFF ONE RECEIVER
LTPELNK5CCT	2" WHITE TUNABLE FLEXTAPE JUMPER CORD
LTPELNK15CCT	6" WHITE TUNABLE FLEXTAPE JUMPER CORD
LTPELNK25CCT	10" WHITE TUNABLE FLEXTAPE JUMPER CORD
LTPELNK60CCT	24" WHITE TUNABLE FLEXTAPE JUMPER CORD
LTPELNK120CCT	48" WHITE TUNABLE FLEXTAPE JUMPER CORD
LTPELNK180CCT	72" WHITE TUNABLE FLEXTAPE JUMPER CORD
LRGBCCT1PREC	PARENT RECEIVER FOR WHITE TUNABLE FLEXTAPE
LRGBCCT1CREC	CHILD RECEIVER FOR WHITE TUNABLE FLEXTAPE
LRGBCCTRMT	HANDHELD WIRELESS REMOTE CONTROL FOR WHITE TUNABLE FLEXTAPE
LWLDCTWH	WHITE DECO WALL DIMMER FOR WHITE TUNABLE FLEXTAPE



INFINEX Extrusions

Infinex is the innovative, patented, LED aluminum extrusion system by Tresco® Lighting. Gone are the days of set fixture sizes, simply choose your style, cut to desired length and assemble to create a customized LED fixture. Designed by our in-house engineers and made in the USA, Infinex carries a UL safety certification and is designed for easy DIY application. We also offer prefabricated custom solutions with a minimum quantity order.

US PATENT NO: D783,533 and 9,618,194

FLUSH

- ✓ No end caps, meant for channels that go the entire width or height of the casework
- ✓ Comes with milk diffuser (unattached)
- ✓ Uses standard FlexTape® starter lead



RECESSED

- ✓ Grooved sides allow extrusion to pressure fit into place
- ✓ Uses standard FlexTape® starter lead



Part #	Description
LXFL94SC	94" FLUSH EXTRUSION SATIN CLEAR W/FLAT MILK DIFFUSER
LXFL72SC	72" FLUSH EXTRUSION SATIN CLEAR W/FLAT MILK DIFFUSER
LXREC72SC10	72" RECESSED OR SURFACE MOUNT EXTRUSION SATIN CLEAR
LX72DIFFMLK	MILK DIFFUSER FOR LXREC72SC10 EXTRUSION
LXSQRUCLP10	U-CLIPS SET (2-CLIPS) FOR LXREC72SC10 EXTRUSION
LXRECECPGY10	GRAY END CAP SET FOR LXREC72SC10 EXTRUSION



Controllers and Receivers

FREEDiM
WIRELESS CONTROL



FREEDiM SERIES UNIVERSAL RECEIVER

Features:

- ✓ 60W Capacity
- ✓ Power failure memory
- ✓ Multiple receivers can be used on a single power supply or within a room to achieve multiple zones of control
- ✓ Install in-line between power supply and lights
- ✓ Easy one-touch pairing with dimmers

Part #	Description
LWLDIM1REC	12VDC 60W UNIVERSAL FREEDiM SERIES RECEIVER

A single receiver can be programmed to up to 8 different FREEDiM Series remotes/dimmers



FREEDiM SERIES MICRO DIMMER

Features:

- ✓ Single zone wireless dimmer
- ✓ Black or nickel finish
- ✓ Easy to replace, long life lithium battery
- ✓ 65 ft. range of control from dimmer to receiver
- ✓ Controls all Tresco® 12/24VDC dimmable low voltage lights
- ✓ Recess or surface mount

Part #	Description
LWLDIM1RNDBL	FREEDiM WIRELESS ROUND DIMMER, BLACK
LWLDIM1RNDNI	FREEDiM WIRELESS ROUND DIMMER, NICKEL

A single dimmer can be programmed to up to 10 different receivers
Must have at least one receiver (LWLDIM1REC) to operate

FREEDiM SERIES DECO WALL DIMMER

Features:

- ✓ Available in single and 2-zone
- ✓ Can be programmed to multiple receivers for more lighting control
- ✓ White finish
- ✓ Fits Decora® style wall plates
- ✓ 65 ft. range of control from dimmer to receiver
- ✓ Controls all Tresco® 12/24VDC dimmable low voltage lights
- ✓ Unlike traditional hardwire dimmers, you can control the same set of lights from multiple Deco Wall Dimmers

Part #	Description
KXWDIMW	FREEDiM SERIES SINGLE ZONE DECO WALL DIMMER, WHITE
LWLD2WALWH	FREEDiM SERIES TWO-ZONE DECO WALL DIMMER, WHITE

A single dimmer can be programmed to up to 10 different receivers.
Must have at least one receiver (LWLDIM1REC) to operate



EquiLine Plug-in Power Supplies

- ✓ 12VDC constant voltage output
- ✓ Short circuit protection*
- ✓ Overload protection*
- ✓ RFI protection
- ✓ Dimmable on trailing edge (12VDC side)
- ✓ Class 2
- ✓ 2-year warranty

Class 2   

✓ Compatible with all Tresco® low voltage dimmers
⊘ NOT compatible with hardwire wall dimmers

Part #	Description
LDCEQ30	30W EQUILINE PLUG-IN POWER SUPPLY W/MNT BLOCK
LDCEQ60	60W EQUILINE PLUG-IN POWER SUPPLY W/MNT BLOCK
LTRANSMNTBL10	EXTRA 6 PORT MOUNTING BLOCK

* Automatic reset (no fuses)

30W 12VDC 100V - 277V OR 60W 12VDC 100V - 277V



Commercial Wall Dimmable Hardwire Power Supplies

✓ Compatible with all Tresco® low voltage dimmers
Compatible with hardwired LED wall dimmers

- ✓ Under 1" height
- ✓ (2) configurations: 30W or 60W
- ✓ 12VDC constant voltage output
- ✓ High power factor (Pf > .95)
- ✓ Dimmable by standard LED wall dimmers
- ✓ Continuous smooth dimming
- ✓ Wire directly into unit
- ✓ Electronic units are lower profile and generate less heat than magnetic transformers
- ✓ Quiet operation
- ✓ Works with all Tresco® 12VDC dimmable LED fixtures
- ✓ One 6-snap mounting block included
- ✓ RFI protection
- ✓ Class 2 with short circuit and automatic reset

30W 12VDC
100V - 277V



60W 12VDC
100V - 277V



Class 2 **cULUS**
LISTED



SELV

Part #	Description
LDCE30DCON	12VDC 30W DIMMABLE LED POWER SUPPLY
LDCE60DCON	12VDC 60W DIMMABLE LED POWER SUPPLY
LTRANSMNTBL10	EXTRA 6-SNAP MOUNTING BLOCK

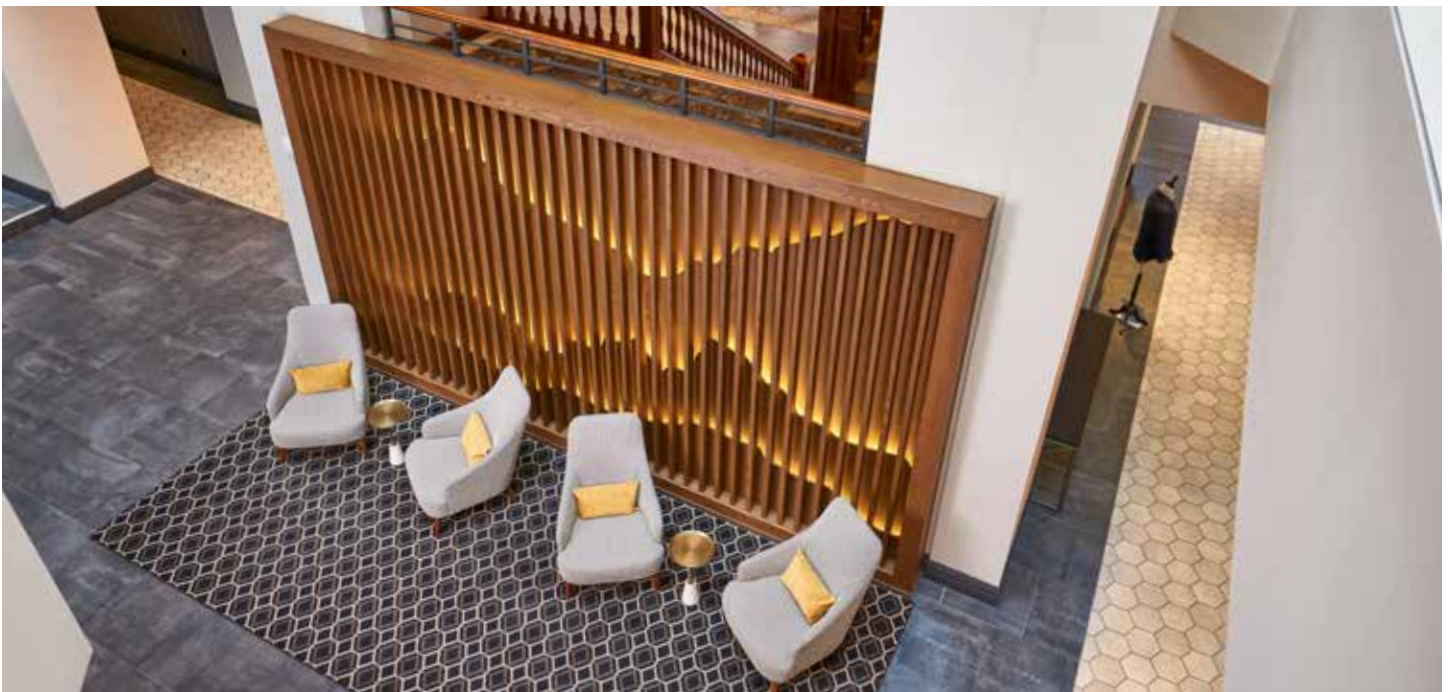

COMPLIMENTARY

Layout Design Services

The increasingly popular application of LED lighting is new to many design professionals. Let our Lighting Layout Assistance Program guide you in specifying the ideal product and wiring schematic for your next residential or commercial project.

Typical Setup:

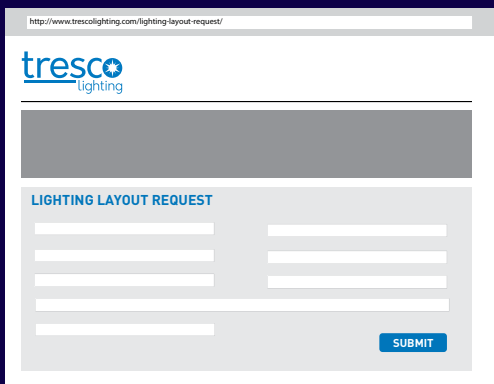

A screenshot of the Tresco Lighting website's 'LIGHTING LAYOUT REQUEST' form. The form is titled 'LIGHTING LAYOUT REQUEST' and contains several input fields for user information. A 'SUBMIT' button is located at the bottom right of the form.

Visit: trescolighting.com/layout



A screenshot of the Tresco Lighting website's 'LIGHTING LAYOUT REQUEST' form, showing a kitchen cabinet drawing uploaded to the form. A blue circular icon with a white upward-pointing arrow is overlaid on the drawing, indicating the upload process. A 'SUBMIT' button is visible at the bottom right.

Fill out the form and upload your drawings.

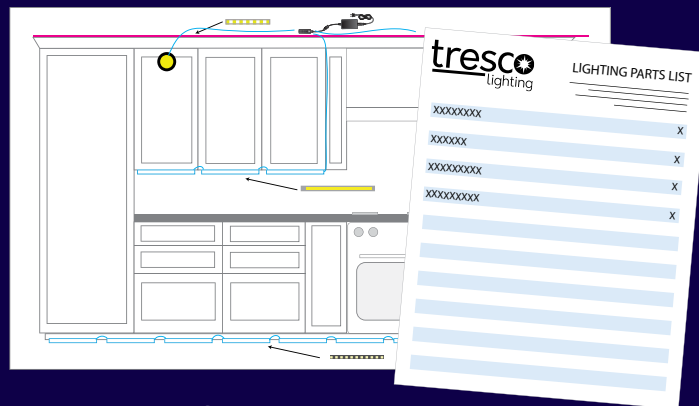

Receive your professionally engineered schematic and matching parts list.

GET STARTED
TODAY



trescolighting.com/layout



A 50% discount is available to you for each display product unit placed in a showroom. Verification of installment to claim the rebate should be handled through your Richelieu Representative.

Tel.: 800 619-5446 • Fax: 1 800 876-7454 • www.richelieu.com

Innovation
through
Illumination

tresco
lighting