

## MOOWME CASTER MECHANISM

The Moowme caster mechanism is designed to allow you to move your furniture easily and effortlessly. The patented "stop & go" technology locks and unlocks the caster with one simple 15 mm lift and has a 360° rotation on the caster ball. Once the required movement is achieved, another lift and drop puts furniture into the "stop" mode again.

- Applicable to nearly all types of furniture via direct insertion or with use of adaptors
- Load capacity per caster:
  - 220 lb (100 kg): Static load
  - 110 lb (50 kg): Dynamic load
- Special large ball design for safe usage on hard flooring, hardwood floors and parquet, as well as carpets of up to 10mm

Sold by unit

PRODUCT	FINISH	APPLICATION	MOUNTING HOLE Ø	WHEEL Ø	TOTAL HEIGHT	MOUNTING TYPE	QTY/BOX
640100190	Black	to be fixed on steel or aluminum	44 mm	30 mm	2 3/8" to 3 17/32" (60 to 90 mm)	Threaded insert	144
640100290	Black	to be fixed on wood	42 mm		2 3/8" (60 mm)	Direct insertion	

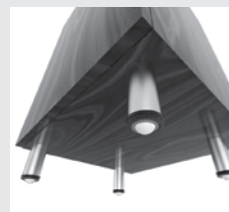
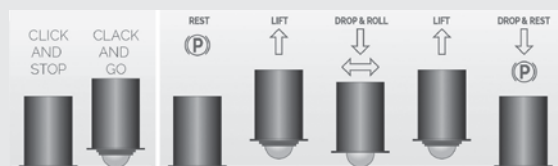

## INSERTS FOR MOOWME RETRACTABLE CASTER

Plug-in for steel or aluminium tubes to be used with the adjustable Moowme caster mechanism to ensure maximum 30 mm adjustability.

INSERTS: only for 640100190.

Sold by unit

PRODUCT	FINISH	MOUNTING HOLE Ø	QTY/BOX
640100390	Black	50 mm	144
640100490	Black	60 mm	
640100590	Black	80 mm	

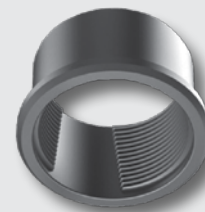
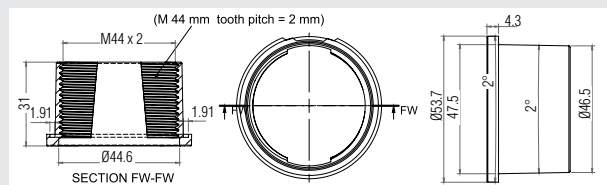

1  
SCREWS  
AND  
FASTENERS

2  
FURNITURE  
EQUIPMENT

3  
HINGES

4  
SLIDES

5  
CASTERS  
AND LEGS

6  
KITCHEN  
SOLUTIONS

7  
CLOSET  
SOLUTIONS

8  
LIGHTING  
SOLUTIONS

9  
SINKS  
AND  
FAUCETS

10  
OFFICE

11  
SLIDING  
DOORS

12  
GLASS  
HARDWARE

13  
PANELS  
AND  
SURFACES

14  
EDGE-  
BANDING

15  
CABINET  
DOORS  
AND  
DRAWERS

16  
CORBELS  
AND FLOOR  
REGISTERS

17  
GLUES,  
SILICONES,  
CAULK AND  
INSULATING

18  
TOOLS  
AND  
SECURITY

19  
FINISHING  
PRODUCTS  
AND SHOP  
SUPPLIES

20  
COMMERCIAL  
DISPLAY  
HARDWARE

21  
MOLDING,  
RAILING AND  
BATHROOM  
HARDWARE

## MOEBIUS CASTERS SERIES

The Moebius series includes more captivating, high-performance, quality-standard models. Continuous surface, perfectly joined up design lines with an appearance of continuity inside and out.

- Load capacity per caster: 110.2 lb (50 kg)
- Material: Nylon, Polyurethane

Sold by unit



PRODUCT	FINISH	MOUNTING TYPE	MOUNTING PLATE DIMENSION	STEM LENGTH	FASTENING TYPE	QTY/BOX
176549090	Black	Plate	1 7/8" (47 x 47 mm)	-	Swivel without break	24
176543030	White					
1765414090	Black, Chrome					
176543005	White, Green					
176519090	Black	Friction grip stem	-	25/32" (20 mm)	Swivel without break	100
176513030	White					
1765114090	Black, Chrome					
176513005	White, Green					

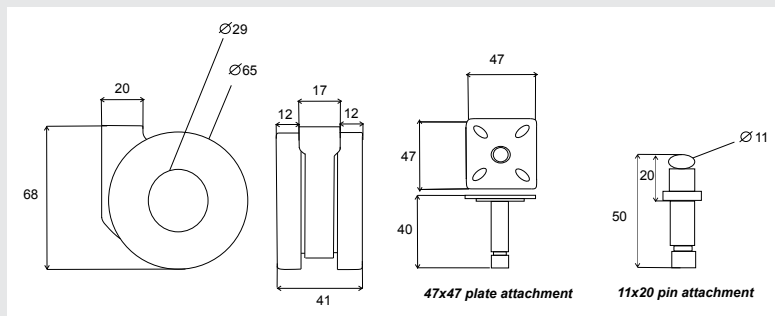

## JACK DESIGN CASTERS

A perfectly designed caster easy to assemble.

- Load capacity per caster: 55.1 lb (25 kg)

Sold by unit

PRODUCT	FINISH	MOUNTING TYPE	MOUNTING PLATE DIMENSION	STEM LENGTH	FASTENING TYPE	QTY/BOX
11801140100	Gray, Chrome	Friction Grip Stem	-	25/32" (20 mm)	Swivel without break	100
11801185100	Satin Nickel, Gray					
11804140100	Gray, Chrome	Plate	1 27/32" x 1 27/32" (47 mm x 47 mm)	-	Swivel without break	
11804185100	Satin Nickel, Gray					

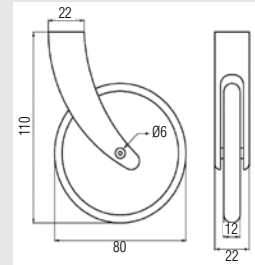

## GIRO DESIGN CASTERS

Wheel designed particularly for trolleys and small tables and can be used in many other applications.

- Load capacity per caster: 55.1 lb (25 kg)

Sold by unit

PRODUCT	FINISH	MOUNTING TYPE	MOUNTING PLATE DIMENSION	STEM LENGTH	FASTENING TYPE	QTY/BOX
1280114090	Black, Chrome	Friction Grip Stem	-	25/32" (20 mm)	Swivel without break	150
1280118590	Satin Nickel, Black					
1280414090	Black, Chrome	Plate	1 27/32" x 1 27/32" (47 mm x 47 mm)	-	Swivel without break	
1280418590	Satin Nickel, Black					

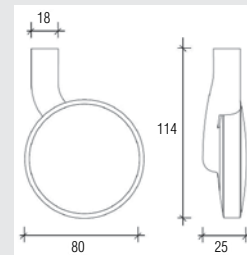

### ALUMINUM SINGLE WHEEL DESIGN CASTERS

For interior use.

Sold by unit

PRODUCT	FINISH	LOAD CAPACITY PER CASTER	WHEEL Ø	TOTAL HEIGHT	FASTENING TYPE	TREAD WIDTH	QTY/BOX
875020190290	Rustic Iron	110.2 lb (50 kg)	2 15/16" (75 mm)	3 7/8" (98 mm)	Swivel without brake	15/16" (24 mm)	32
875020290290					Swivel with brake		
8100020190290		132.3 lb (60 kg)	3 15/16" (100 mm)	4 15/16" (125 mm)	Swivel without brake	15/16" (24 mm)	
8100020290290					Swivel with brake		
8125020190290		176.3 lb (80 kg)	4 15/16" (125 mm)	5 15/16" (151 mm)	Swivel without brake	1 1/8" (29 mm)	
8125020290290					Swivel with brake		

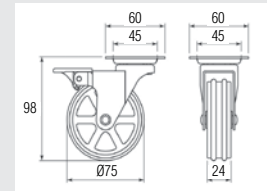
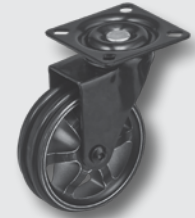

875020190290

### ALUMINUM SINGLE WHEEL VINTAGE CASTERS

For interior use.

Sold by unit

PRODUCT	FINISH	LOAD CAPACITY PER CASTER	WHEEL Ø	TOTAL HEIGHT	FASTENING TYPE	TREAD WIDTH	QTY/BOX
8750201AB90	Rustic Brass	110.2 lb (50 kg)	2 15/16" (75 mm)	3 7/8" (98 mm)	Swivel without brake	15/16" (24 mm)	32
8750202AB90					Swivel with brake		
81000201AB90		132.3 lb (60 kg)	3 15/16" (100 mm)	4 15/16" (125 mm)	Swivel without brake	15/16" (24 mm)	
81000202AB90					Swivel with brake		
81250201AB90		176.3 lb (80 kg)	4 15/16" (125 mm)	5 15/16" (151 mm)	Swivel without brake	1 1/8" (29 mm)	
81250202AB90					Swivel with brake		

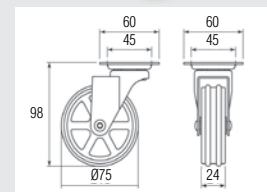

8750201AB90

### ALUMINUM SINGLE WHEEL DESIGN CASTERS

For interior use.

Sold by unit

REF.	PRODUCT	FINISH	LOAD CAPACITY PER CASTER	WHEEL Ø	TOTAL HEIGHT	FASTENING TYPE	TREAD WIDTH	QTY/BOX
<b>A</b>	<b>875020114090</b>	Black, Chrome	110.2 lb (50 kg)	2 15/16" (75 mm)	3 7/8" (98 mm)	Swivel without brake	15/16" (24 mm)	32
	<b>875020214090</b>					Swivel with brake		
	<b>8100020114090</b>		132.3 lb (60 kg)	3 15/16" (100 mm)	4 15/16" (125 mm)	Swivel without brake	15/16" (24 mm)	
	<b>8100020214090</b>					Swivel with brake		
<b>B</b>	<b>87502019090</b>	Black	110.2 lb (50 kg)	2 15/16" (75 mm)	3 7/8" (98 mm)	Swivel without brake	15/16" (24 mm)	32
	<b>87502029090</b>					Swivel with brake		
	<b>810002019090</b>		132.3 lb (60 kg)	3 15/16" (100 mm)	4 15/16" (125 mm)	Swivel without brake	15/16" (24 mm)	
	<b>810002029090</b>					Swivel with brake		

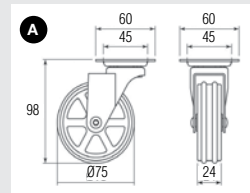

8750201AB90

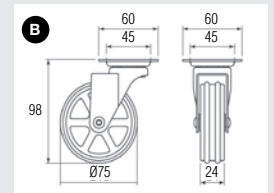

87502019090

### ADJUSTABLE FURNITURE LEG - 475

Practical, functional and adjustable metal sofa leg. This leg comes with a detachable plate and leveler.

Sold by unit

PRODUCT	FINISH	LEG Ø	HEIGHT	QTY/BOX
<b>475120140</b>	Polished Chrome	1 3/8" (35 mm)	4 3/4" (120 mm)	40

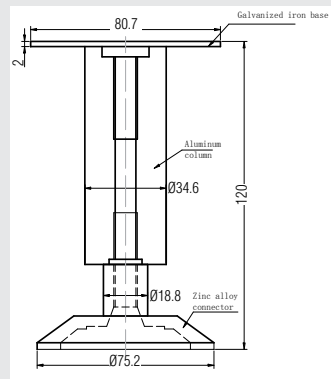

## CONTEMPORARY L-SHAPE FURNITURE LEGS

Screw-in leg.  
Sold by unit

PRODUCT	FINISH	LOAD CAPACITY PER LEG	HEIGHT	ADJUSTABILITY	QTY/BOX
203100010	Aluminum	441 lb (200 kg)	3 15/16" (100 mm)	9/32" (7 mm)	40
203100140	Chrome				
203100060	Dark Brown				
203140010	Aluminum	441 lb (200 kg)	5 1/2" (140 mm)	9/32" (7 mm)	30
203140140	Chrome				
203140060	Dark Brown				
203200010	Aluminum	441 lb (200 kg)	7 7/8" (200 mm)	9/32" (7 mm)	20
203200140	Chrome				
203200060	Dark Brown				

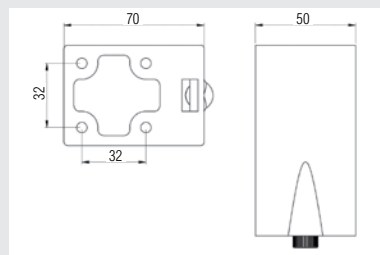

## ADJUSTABLE METAL FURNITURE LEGS

Practical, functional, and adjustable. 1/2" (13 mm) adjustment.

**Included:** Mounting plate of 2 25/32" x 2 25/32" (70 x 70 mm)

Sold by unit

PRODUCT	FINISH	LOAD CAPACITY PER LEG	LEG DIMENSION	HEIGHT	ADJUSTABILITY	QTY/BOX
80410010	Aluminum	Max. 88 lb (40 kg)	1 3/16" x 1 3/16" (30 x 30 mm)	3 15/16" (100 mm)	1/2" (13 mm)	40
80412010				4 3/4" (120 mm)		24
80415010				5 7/8" (150 mm)		50
<b>New!</b> 80420010				7 7/8" (200 mm)		

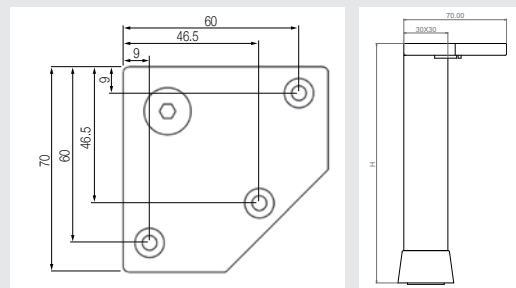

### ADJUSTABLE FURNITURE LEGS - 555

20 mm (3/4") adjustment.

- Base: 1 15/16" x 1 15/16" (49 mm x 49 mm)
- Plate: 5 1/16" x 5 1/16" (129 mm x 129 mm)

**Included:**

- Mounting plate
- Screws
- Allen Key

Sold in sets of 4 legs

PRODUCT	FINISH	LOAD CAPACITY	HEIGHT	ADJUSTABILITY	SET/BOX
555100140	Chrome	771.6 lb (350 kg)	3 15/16" (100 mm)	20 mm (3/4")	1
555100900	Matte Black				
555100300	Matte White				
555100170	Stainless Steel				
555120140	Chrome		4 3/4" (120 mm)		
555120900	Matte Black				
555120300	Matte White				
555120170	Stainless Steel		5 15/16" (150 mm)		
555150140	Chrome				
555150900	Matte Black		7 7/8" (200 mm)		
555150300	Matte White				
555150170	Stainless Steel				
555200140	Chrome		7 7/8" (200 mm)		
555200900	Matte Black				
555200300	Matte White				
555200170	Stainless Steel				

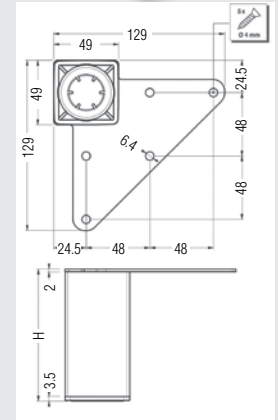

### VINTAGE ROUND LEGS - 641

- Base Ø: 71 mm
- Plate: 2 3/16" (55 mm x 55 mm)

Sold by unit

PRODUCT	FINISH	LOAD CAPACITY PER LEG	HEIGHT	ADJUSTABILITY	QTY/BOX
64130100170	Stainless Steel	154.3 lb (70 kg)	3 15/16" (100 mm)	5/16" (8 mm)	24
64130100AB90	Rustic Brass				
64130100290	Rustic Iron				
64130150170	Stainless Steel		5 15/16" (150 mm)		
64130150AB90	Rustic Brass				
64130150290	Rustic Iron		7 7/8" (200 mm)		
64130200170	Stainless Steel				
64130200AB90	Rustic Brass		9 13/16" (250 mm)		
64130200290	Rustic Iron				
64130250170	Stainless Steel		9 13/16" (250 mm)		
64130250AB90	Rustic Brass				
64130250290	Rustic Iron				

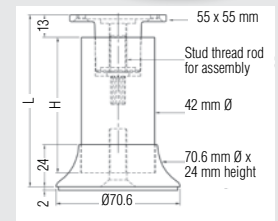

- 1** SCREWS AND FASTENERS
- 2** FURNITURE EQUIPMENT
- 3** HINGES
- 4** SLIDES
- 5** CASTERS AND LEGS
- 6** KITCHEN SOLUTIONS
- 7** CLOSET SOLUTIONS
- 8** LIGHTING SOLUTIONS
- 9** SINKS AND FAUCETS
- 10** OFFICE
- 11** SLIDING DOORS
- 12** GLASS HARDWARE
- 13** PANELS AND SURFACES
- 14** EDGE-BANDING
- 15** CABINET DOORS AND DRAWERS
- 16** CORBELS AND FLOOR REGISTERS
- 17** GLUES, SILICONES, CAULK AND INSULATING
- 18** TOOLS AND SECURITY
- 19** FINISHING PRODUCTS AND SHOP SUPPLIES
- 20** COMMERCIAL DISPLAY HARDWARE
- 21** MOLDING, RAILING AND BATHROOM HARDWARE

## VINTAGE SQUARE LEGS - 641

- Base: 2 3/16" (55 mm x 55 mm)
- Plate: 2 3/16" (55 mm x 55 mm)

Sold by unit

PRODUCT	FINISH	LOAD CAPACITY PER LEG	HEIGHT	ADJUSTABILITY	QTY/BOX	
64134100170	Stainless Steel	154.3 lb (70 kg)	3 15/16" (100 mm)	5/16" (8 mm)	40	
64134100AB90	Rustic Brass					
64134100290	Rustic Iron					
64134150170	Stainless Steel		5 15/16" (150 mm)			16
64134150AB90	Rustic Brass					
64134150290	Rustic Iron					
64134200170	Stainless Steel		7 7/8" (200 mm)	16		
64134200AB90	Rustic Brass					
64134200290	Rustic Iron					
64134250170	Stainless Steel		9 13/16" (250 mm)		16	
64134250AB90	Rustic Brass					
64134250290	Rustic Iron					

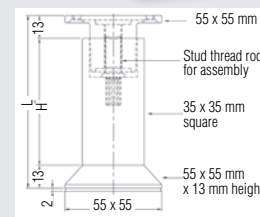

## RETRO TABLE LEGS

Add vintage design to your kitchen, living room, loft, etc. by selecting one of our table legs available in three heights.

Sold by unit

REF.	PRODUCT	FINISH	LEG SHAPE	LOAD CAPACITY PER LEG	HEIGHT	TABLE TYPE	ADJUSTABILITY	QTY/BOX
<b>A</b>	76902812	Steel	Round	400 lb (181.4 kg)	28 1/4" (710 mm)	Dining	1/2" (12.7 mm)	4
	76903412				34 3/4" (883 mm)	Counter		
	76904012				40 3/4" (1035 mm)	Bar		
<b>B</b>	76912812	Steel	Triangular	400 lb (181.4 kg)	28 1/4" (710 mm)	Dining	1/2" (12.7 mm)	4
	76913412				34 3/4" (883 mm)	Counter		
	76914012				40 3/4" (1035 mm)	Bar		

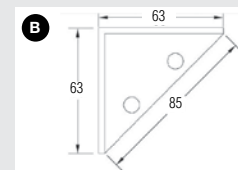
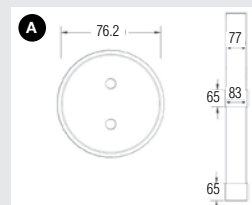
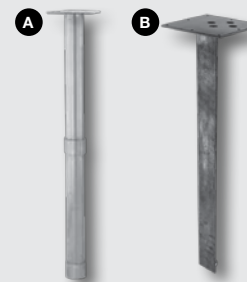

### ADJUSTABLE SQUARE LEGS

- 10 mm adjustment capacity for optimal adjustment
- Adds a personalized, contemporary and innovative style to your table

PRODUCT	FINISH	LOAD CAPACITY PER LEG	LEG DIMENSION	HEIGHT	QTY/BOX
643705140	Chrome	330.7 lb (150 kg)	1 31/32" x 1 31/32" (50 x 50 mm)	27 3/4" (705 mm)	4
643705170	Stainless Steel				
644705140	Chrome	330.7 lb (150 kg)	2 3/8" x 2 3/8" (60 x 60 mm)	27 3/4" (705 mm)	4
644705170	Stainless Steel				
644870140	Chrome	330.7 lb (150 kg)		34 1/4" (870mm)	1
644870170	Stainless Steel				
645705140	Chrome	330.7 lb (150 kg)	3 1/8" x 3 1/8" (80 x 80 mm)	27 3/4" (705 mm)	4
645705170	Stainless Steel				
642705010	Aluminum	330.7 lb (150 kg)	3 15/16" x 3 15/16" (100 x 100 mm)	27 3/4" (705 mm)	4

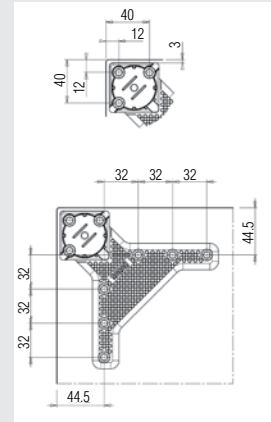

### SQUARE END BALUSTERS

- Perfect for stability and durability
- Suitable for tables, furniture legs, and all types of staircases

PRODUCT	MATERIAL	LENGHT	WIDTH	QTY/BOX
AWS63836B	Birch	36" (914 mm)	1 1/4" (32 mm)	1
AWS63840B		40" (1016 mm)		

