

# SHOP SUPPLIES

For your  
everyday needs

ADHESIVES  
CUTTERS  
FINISHING  
PRODUCTS  
GLOVES  
HAND TOOLS  
LEVELERS  
NAILERS  
PACKAGING  
SANDERS  
RESPIRATORS  
SEALANTS  
STAPLERS  
TAPES



**ORDER  
NOW!**



**R**  
**Richelieu**

# SHOP SUPPLIES

Richelieu presents a catalog featuring an outstanding selection of shop supplies that you need on a daily basis. This new catalog is easy to use and covers the most popular products across our entire range, such as sealers, adhesives, tools, tapes, packing supplies and much more. You'll want to consult it often. You're sure to find the products you need, plus save yourself time and money.

Place your order today online at [www.Richelieu.com](http://www.Richelieu.com)

## Table of contents

<b>ADHESIVES, SEALANTS AND ACCESSORIES</b>	<b>A3 - A11</b>
Mitre Pro & Fastcap Adhesives	A3
Titebond Adhesives	A4 - A5
LionGrip Adhesives	A5 - A7
Accessories for Adhesives	A8
Adhesives & Silicone Sealants	A9
<b>Video: 100% Silicone Sealant</b>	<b>A9</b>
Custom Colored Caulk	A10 - A11
<b>ABRASIVES</b>	<b>B12 - B16</b>
Sanding Sheets & Sponges	B12
Sanding Discs & Belts	B13 - B14
Sanders & Sanding Sheets	B15 - B16
<b>TOOLS</b>	<b>C17 - C37</b>
Nailers & Staplers	C17 - C19
<b>Video: Headless Pinner - 23 gauge</b>	<b>C17</b>
Nails & Staples	C19 - C20
Compressors & Accessories	C21
Hole Saws & Accessories	C22 - C23
Universal Blades	C24
Circular Saw & Blades	C25
Bits	C26 - C27
Jig Saws & Blades	C28 - C29
Other Tools & Accessories	C29 - C31
Splines & Dowels	C30
<b>Video: Dowelmax Classic Kit</b>	<b>C30</b>
Cutters, Trimmers & Files	C31 - C33
Hand Tools	C33 - C34
<b>Video: Gorilla Grippers</b>	<b>C34</b>
Screwdrivers	C35
<b>Video: Angle Driver for Screwdriver Bits</b>	<b>C36</b>
Tool Cases	C36
Measuring Tapes	C37
<b>FINISHING PRODUCTS</b>	<b>D38 - D42</b>
Wood Fillers	D38 - D39
Touch-Up Products	D40 - D41
<b>Videos: Mohawk Touch-Up Markers</b>	<b>D40</b>
<b>Video: "Blendal Sticks" Color Replacement</b>	<b>D41</b>
Oils, Lacquers & Sealers	D42
<b>WORKSHOP SUPPLIES</b>	<b>E43 - E46</b>
3M Tapes	E43
Brushes, Rags & Protection Blankets	E44
Paint Preparation System	E45 - E46
<b>SAFETY</b>	<b>F47 - F56</b>
Dust Masks	F47
Respirators & Filters	F48
Eye Protection	F49 - F51
Head Protection	F52
Hearing Protection	F52 - F53
Gloves	F54 - F55
Protective Clothing	F55 - F56
<b>WORK SUPPORT</b>	<b>G57 - G61</b>
Work Support Accessories	G57 - G59
<b>Video: Handling Trolley</b>	<b>G57</b>
<b>Video: LegUp™ Table Saw Panel-Lifting Accessory</b>	<b>G58</b>
Jigs & Rollers	G59
<b>Video: Puck Light Jig - Majig Light</b>	<b>G59</b>
<b>Video: Precision Jig Systems</b>	<b>G59</b>
Measuring & Layout	G60
<b>Video: Thingamejig Scribing Tool</b>	<b>G60</b>
Caulking Guns & Drying System	G61
<b>Video: SUN-SPOT® Brand Catalytic Reactor</b>	<b>G61</b>
<b>MAINTENANCE AND PACKAGING PRODUCTS</b>	<b>H62 - H64</b>
Lubricants & Cleaners	H62 - H63
Packaging	H64

Mitre-Pro

High-viscosity adhesive system for bonding where large gap fill is important or where materials are absorbent.

NO.	DESCRIPTION	VOLUME
099606A	ACTIVATOR	6.76 OZ (200 ML)
099606GT	GLUE (Thin viscosity)	1.76 OZ (50 G)
099606G	GLUE (Medium viscosity)	1.76 OZ (50 G)

The activator does not affect PVC plastics.



10 Second Bonding

No Clamping!

Instant 2P-10 Adhesive

2P-10 is a two-part ten-second adhesive. Just apply the adhesive, then spray the activator and stick it together for a strong, permanent bond. 10 second bonding! 30 seconds to cure.

NO.	VISCOSITY	VOLUME
916499	THIN	2.25 OZ (66.54 ML)
916438	MEDIUM	2.25 OZ (66.54 ML)
916496	THICK	2.25 OZ (66.54 ML)
9164311	JEL	2.25 OZ (66.54 ML)
916442	DEBONDER	2 OZ (59.15 ML)
916440	ACTIVATOR	2 OZ (59.15 ML)
918842	THIN	8 OZ (236.59 ML)
916428	MEDIUM	10 OZ (295.74 ML)
916429	THICK	10 OZ (295.74 ML)
916431	JEL	10 OZ (295.74 ML)
916453	ACTIVATOR	10 OZ (295.74 ML)
918850	JEL	10.14 OZ (300 ML)

RUBBER TOUGHENED		
916467	THICK	2.25 OZ
916469	THICK	10 OZ
916461	JEL	2.25 OZ
916465	JEL	10 OZ

Aerosol Activator

10 second bonding! 30 seconds to cure.

NO.	DESCRIPTION	VOLUME
916453	2P-10 AEROSOL	12 OZ (354.88 ML)



10 Second Bonding



No Clamping!

Instant 2P-10 Adhesive Kit

- Includes:
- 1 x 2.25 oz Medium
  - 2 x 2 oz Activators
  - 1 x 2.25 oz Thick
  - 1 x 2 oz Debonder
  - 1 x 2.25 oz Jel

NO.	DESCRIPTION
Q2P10KIT	KIT



2P-10 Adhesive Colorant Kit

This new high-tech adhesive colorant is specifically made to work with the 2P-10 system and allows you to mix exactly the right tint of 2P-10 filler in seconds. The 2P-10 colorants provide filling perfection in a matter of minutes. This colorant is extremely effective on all surfaces.

NO.	DESCRIPTION
918856	ADHESIVE COLORANT KIT



All products are sold by unit except those shown with an \*. These are sold by box.





### Titebond Original Wood Glue

Titebond Original Wood Glue is the industry standard for woodworking. Ideal for wood, hardboard, particleboard, leather, cloth, and most other porous materials. Titebond Original is non-toxic, easy to use, and cleans up with water.

- Fast setting to shorten clamp time
- Bonds stronger than wood
- Excellent heat and solvent resistance
- Excellent sandability
- Unaffected by finishes
- Versatile: bonds wood, hardboard, high pressure laminates and particleboard
- Easy clean-up with water

NO.	VOLUME	QTY/BOX
<b>15005066</b>	3.79 L (1 GALLON)	2
<b>15005067</b>	18.93 L (5 GALLONS)	1



### Titebond II Fluorescent Wood Glue

Titebond II Fluorescent contains a dye that, when viewed under a black light, enables woodworkers to inspect the glue line and assist in the cleanup process.

- Passes ANSI Type II water resistance
- Versatile: bonds wood, hardboard, high pressure laminates, and particleboard
- Excellent heat and solvent resistance
- Fast-setting, shortening clamp time
- Ideal for radio frequency (R-F) gluing systems
- Easy cleanup with water

NO.	VOLUME	QTY/BOX
<b>15002316</b>	3.79 L (1 GALLON)	2
<b>15002317</b>	18.93 L (5 GALLONS)	1



### PVA Glue - Titebond Extend Wood Glue

A slower setting version of Titebond Original Wood Glue; offers superior performance in a broad range of applications, including edge and face gluing.

- Slow drying
- Recommended for indoors
- Color: Yellow
- Open assembly time: 11 to 30 minutes
- Dried Film: Yellow

NO.	VOLUME	QTY/BOX
<b>15009106</b>	3.79 L (1 GALLON)	2
<b>15009107</b>	18.93 L (5 GALLONS)	1



### PVA Glue - Titebond II Extend Wood Glue

Titebond II Extend Wood Glue combines weatherproof performance (ANSI Type II water-resistance) with a slower speed of set. For all types of wood, agglomerate, MDF, plywood and other porous materials.

- Slow drying
- Recommended for outdoors
- Color: Off White
- Open assembly time: 11 to 30 minutes
- Open time under pressure: 30 minutes and more
- Dried Film: White

NO.	VOLUME	QTY/BOX
<b>15004136</b>	3.79 L (1 GALLON)	2
<b>15004137</b>	18.93 L (5 GALLONS)	1



### PVA GLUE - Titebond III Ultimate Wood Glue

Safer to use than traditional waterproof wood glues, Titebond III is non-toxic, solvent-free, and cleans up with water.

- Recommended for outdoors and indoors
- Color: Havana
- Dried Film: Light Brown
- Open assembly time: 6 to 10 minutes
- Open time under pressure: 11 to 20 minutes

NO.	VOLUME	QTY/BOX
<b>15001414</b>	473.18 ML (16 OZ)	12
<b>15001415</b>	946.35 ML (32 OZ)	6
<b>15001416</b>	3.79 L (1 GALLON)	2
<b>15001417</b>	18.93 L (5 GALLONS)	1

**Waterproof**

### PVA Glue - Titebond White Glue

Titebond White Glue is an exceptionally strong, economical white glue that sets faster than most other comparable glues.

- General use glue
- Recommended for indoors
- Color: White
- Open assembly time: 1 to 5 minutes
- Dried Film: Clear

NO.	VOLUME	QTY/BOX
150015026	3.79 L (1 GALLON)	2
15005027	18.93 L (5 GALLONS)	1



**Strong and economical**

### Brush and Roller Adhesive - LIONGRIP R505

Particularly suitable for environments where climatic conditions and ambient temperatures normally make bonding difficult.

- Resistant to high temperatures
- Multipurpose
- Open time: 60 minutes
- Dry time: 5 to 10 minutes

NO.	COLOR	VOLUME
R505411L	NATURAL	3.79 L (1 GALLON)
R5052011L	NATURAL	18.93 L (5 GALLONS)



### High-Performance Adhesive Spray - LIONGRIP R517

Ideal choice for most permanent adhesive applications on a wide variety of substrates.

- Resistant to high temperatures
- Highly resistant to tearing and shearing
- Waterproof
- Flexible
- Open time: 60 minutes
- Dry time: 3 to 5 minutes

NO.	COLOR	VOLUME
R5172011L	NATURAL	18.93 L (5 GALLONS)
R5172080L	RED	18.93 L (5 GALLONS)
R5175411L	NATURAL	204.41 L (54 GALLONS)
R5175480L	RED	204.41 L (54 GALLONS)



### High-Solids, Low-VOC Adhesive Spray - LIONGRIP R250

LIONGRIP R250 is a high solid contact adhesive for HPL, countertop.

- Open time: up to 60 minutes
- Dry time: 4 to 6 minutes

NO.	COLOR	VOLUME
R2502011L	NATURAL	18.93 L (5 GALLONS)
R2502080L	RED	18.93 L (5 GALLONS)
R2505411L	NATURAL	204.41 L (54 GALLONS)
R2505480L	RED	204.41 L (54 GALLONS)



### Adhesive Cleaner - LIONGRIP RS020

Dissolves fresh or dry adhesive from laminates or other surfaces. Can also be used to clean tools and equipment such as sprayers, brushes, rollers, and containers.

NO.	VOLUME
RS02020L	18.93 L (5 GALLONS)



**NEW!**

**Ultra strong**

### Multi-Purpose Citrus Adhesive Remover

LIONGRIP RCCAR is a cleaner and adhesive remover. It may be used to remove adhesives, grease, decal residue, soap film and much more.

NO.	COLOR	VOLUME
RCCAR13C	CLEAR	13 OZ
RCCAR09C	CLEAR	9 LB

All products are sold by unit except those shown with an \*. These are sold by box.



**NEW!**



### PVA Glue - Liongrip 1000 - White Glue

This general purpose woodworking adhesive is for general wood assembly and edge gluing of soft and hard wood species.

- Fast gripping action with less slippage
- Robust and durable glue line
- Excellent sandability
- Medium to long open time
- Fluorescent

NO.	VOLUME	QTY/BOX
<b>R1000130</b>	3.79 L (1 GALLON)	4
<b>R1000530</b>	18.93 L (5 GALLONS)	1
<b>R10004530</b>	170.34 L (45 GALLONS)	1

**NEW!**



### PVA Glue - Liongrip 2000 - Moisture Resistant/Butcher Block Glue

Specifically formulated for applications where Type II water resistant bonds are required. Well suited for automated finger jointers and all roll coaters for flat laminations of veneer or High Pressure Laminates (HPL). Also recommended for edge-gluing on Radio Frequency Presses (RF).

- Meets ASTM 5572 TYPE II interior use water resistance
- Meets ASTM E2074 fire rating for interior flush doors assemblies up to 90 minutes
- NSF51 certified for food contact
- Fluorescent

NO.	VOLUME	QTY/BOX
<b>R2000130</b>	3.79 L (1 GALLON)	4
<b>R2000530</b>	18.93 L (5 GALLONS)	1
<b>R20004530</b>	170.34 L (45 GALLONS)	1

**NEW!**



### PVA Glue - Liongrip 3000 - Yellow Glue

This general purpose yellow carpenter's glue is specifically formulated for cabinet and furniture assembly and panel edge gluing.

- Fast gripping action with less slippage
- Very hard glue line
- Excellent sandability
- Fast drying time
- Fluorescent

NO.	VOLUME	QTY/BOX
<b>R3000111</b>	3.79 L (1 GALLON)	4
<b>R3000511</b>	18.93 L (5 GALLONS)	1
<b>R30004511</b>	170.34 L (45 GALLONS)	1

**NEW!**



### PVA Glue - Liongrip 5000 - High Performance Hardwood Glue

Specially formulated for the manufacturing of edge and faced glued panels where extremely strong and resilient bonds on hardwoods are required.

- Fast gripping action with less slippage
- Superior adhesion to hardwoods
- Deeper wood penetration
- Fluorescent

NO.	VOLUME	QTY/BOX
<b>R5000130</b>	3.79 L (1 GALLON)	4
<b>R5000530</b>	18.93 L (5 GALLONS)	1
<b>R50004530</b>	170.34 L (45 GALLONS)	1



## High-temperature, High-strength Adhesive Spray

Adhesives with high bond strength and excellent adhesion to a variety of substrates including, but not limited to laminates, particle board, plywood, hardwood, leather, rubber and metal.

- Open time: 30 minutes
- Coverage rate: 2.5 dry grams/sq. ft. min.
- Cleanup: LIONGRIP RS02020L, RCCAR13C or RCCAR09C

### LIONGRIP R015

- Flash point: -156°F
- Dry time: approximately 2-3 Minutes
- VOC: 426 grams/liter (EPA Method 24)

NO.	VOLUME	COLOR	QTY/BOX
R01516C	16 OZ	CLEAR	12
R01511C	11 LB	CLEAR	1
R01511R	11 LB	RED	1
R01538C	38 LB	CLEAR	1
R01538R	38 LB	RED	1
R015177C	177 LB	CLEAR	1
R015177R	177 LB	RED	1

Our Best Seller!



### LIONGRIP R015NF

- High heat resistance
- Fast drying
- High performance
- Fast grab
- Easy and uniform coverage
- High tack and excellent contactability

NO.	VOLUME	COLOR	QTY/BOX
R015NF35C	35 LB	CLEAR	1
R015NF35G	35 LB	GREEN	1
R015NF162C	162 LB	CLEAR	1
R015NF162G	162 LB	GREEN	1
R015NF326C	326 LB	CLEAR	1
R015NF326G	326 LB	GREEN	1

Non-Flammable



### LIONGRIP R013

- Flash point: -13°F
- Dry time: approximately 2-3 minutes
- VOC: 141.5 grams/liter (EPA Method 24)

NO.	VOLUME	COLOR	QTY/BOX
R01313C	13 OZ	CLEAR	12
R01323C	23 LB	CLEAR	1
R01323R	23 LB	RED	1
R013124C	124 LB	CLEAR	1
R013124R	124 LB	RED	1
R013252C	252 LB	CLEAR	1
R013252R	252 LB	RED	1

Low VOC



### LIONGRIP R661

- Flash point: -13°F
- Dry time: approximately 3-5 minutes
- VOC: 651 grams/liter (EPA Method 24)

NO.	VOLUME	COLOR	QTY/BOX
R66130C	30 LB	CLEAR	1
R66130R	30 LB	RED	1
R661140C	140 LB	CLEAR	1
R661140R	140 LB	RED	1
R661300R	300 LB	CLEAR	1



All products are sold by unit except those shown with an \*. These are sold by box.



## Light Texture Fiberglass & Adhesive Glue Roller

- 1 1/2" diameter core

NO.	DESCRIPTION	QTY/BOX
<b>D015030</b>	3" ROLLER WITH HANDLE	1
<b>D015031</b>	3" ROLLER REPLACEMENT	1
<b>DYROLLERADH</b>	9.5" ROLLER	1



## Spray Nozzles

NO.	DESCRIPTION	QTY/BOX
<b>TIP6501</b>	65 DEGREES	1
<b>TIP80015E</b>	80 DEGREES	1
<b>TPU9501</b>	95 DEGREES	1



## Spray Gun

NO.	DESCRIPTION	QTY/BOX
<b>AA23L45885</b>	ADJUSTABLE FLOW	1



## T-Fitting for Two Flow Spray Guns

NO.	DESCRIPTION	QTY/BOX
<b>TFIT2GUNS</b>	T-FITTING	1



## Hoses

NO.	DESCRIPTION	QTY/BOX
<b>WSB06</b>	6 FT	1
<b>WSB09</b>	9 FT	1
<b>WSB12</b>	12 FT	1
<b>WSB18</b>	18 FT	1
<b>WSB25</b>	25 FT	1

## Construction Adhesive LIONGRIP PU Plus

It can be used for interior or exterior and is specially designed for water-resistant substrate assemblies. 100% polyurethane-based, VOC-compliant adhesive.

NO.	VOLUME	QTY/BOX
R519300PU	296 ML (10 OZ)	12

## Interior/Exterior Glue Cartridges (multipurpose)

Versatile adhesive ideal for wood, paneling, drywall, ceramic tile, metal, foam-board and tub surrounds.

NO.	VOLUME	QTY/BOX
15003451	299 ML (10.1 OZ)	12

## Heavy-Duty Glue Cartridge

Titebond low VOC heavy-duty construction adhesive. Designed for a wide range of construction applications including wet, frozen and treated lumber.

NO.	VOLUME	QTY/BOX
15005251	296 ML (10 OZ)	12

## 100% Silicone Sealant for Baths & Kitchen

Specially formulated to resist mold and mildew when fully cured.

NO.	COLOR	VOLUME	QTY/BOX
94160030	WHITE	300 ML (10.14 OZ)	12
94160011	CLEAR	300 ML (10.14 OZ)	12

## Painter's Ultra Siliconized Acrylic Latex

Paintable within minutes.

NO.	COLOR	VOLUME	QTY/BOX
94150130	WHITE	300 ML (10.14 OZ)	12
94150111	CLEAR	300 ML (10.14 OZ)	12

## "NuFLEX®" 180 Tub & Tile Sealant

Siliconized acrylic latex.

NO.	COLOR	VOLUME	QTY/BOX
94150116211	CLEAR	162 ML (5.48 OZ)	12
94150116230	WHITE	162 ML (5.48 OZ)	12
94150116240	ALMOND	162 ML (5.48 OZ)	12

## Silicone Sealant and Adhesive - CSL 160

CSL160 is ideal for sealing around carpentry, cabinetry, tubs, sinks, shower and bath panel joints, counter tops, doors, windows and flashings, a general adhesive.

NO.	COLOR	VOLUME	QTY/BOX
160011	CLEAR	300 ML (10.14 OZ)	20
160030	WHITE	300 ML (10.14 OZ)	20
160040	ALMOND	300 ML (10.14 OZ)	20
160060	MEDIUM BROWN	300 ML (10.14 OZ)	20
160090	BLACK	300 ML (10.14 OZ)	20
CS1T	TRANSLUCENT	300 ML (10.14 OZ)	20
1600401	BONE	300 ML (10.14 OZ)	20
1600105	GREY	300 ML (10.14 OZ)	20

All products are sold by unit except those shown with an \*. These are sold by box.



VIDEO



**Over 100  
Colors!**



### ColorFlex

Custom colored acrylic latex caulk with silicone designed for corner and perimeter caulking of decorative surfaces. ColorFlex colored caulk is recommended for indoor use as it can fade and is not intended for contact with water on a regular basis.

- Quantity/box: 6

### ColorFlex

COLOR	10.5 OZ (311 ML)	4 OZ (118 ML)
ALMOND	CF800810	CF800804
ANTIQUE RED	CF818110	-
ANTIQUE WHITE	CF801210	CF801204
BEIGE	CF801310	CF801304
BLACK	CF821910	CF821904
BLUE IRIS	-	CF814604
BLUSH	-	CF818004
BRITE GREEN	-	CF812304
BRITISH TAN	CF803710	CF803704
BUCKSKIN	-	CF806004
BURGUNDY	CF817310	CF817304
BUTCHERBLOCK	CF804410	CF804404
BUTTERSCOTCH	-	CF810904
CAMEL	-	CF804804
CARDBOARD	CF804910	-
CHALK	CF800210	-
CHAMELEON	-	CF809604
CHAMOIS	CF804010	CF804004
CHARCOAL	CF821210	CF821204
CHOCOLATE	-	CF807404
CIDER	CF806510	CF806504
CLAM SHELL	CF814010	-
CLASSIC BLACK	CF821710	-
COFFEE BEAN	CF807710	CF807704
COPPER	CF806210	-
DAFFODIL	CF810610	CF810604
DEEP GREEN	-	CF812504
DESERT	CF802110	CF802104
DOLPHIN	CF819810	CF819804
DOVE GREY	CF819210	-
EBONY	-	CF821604
EGGSHELL	CF800710	-
FAWN	CF818310	CF818304
FEATHERSTONE	-	CF804104
FLESH	-	CF802204
FOG	CF803410	-
FOREST	CF809810	-
FOSSIL	CF803210	-
FRENCH VANILLA	CF802610	-
FUDGE	CF807110	CF807104
GINGER	-	CF807204
GLACIER GREEN	CF812010	-
GOLDEN ASH	CF805810	-
GRANITE	-	CF807504
GRAPHITE	-	CF821004
GREIGE	CF819010	-
GREY SAND	CF800610	CF800604
GREY SLATE	-	CF820704
GREY SUEDE	-	CF808104
GREY	CF819510	CF819504
GREYSTONE	CF819410	-
HICKORY	-	CF808604
HOLLYBERRY	CF817410	CF817404
HONEY	CF805610	CF805604
HUNTER GREEN	-	CF812604
INDIGO	-	CF815204
IVORY	CF801010	-

All colors are available in both formats. Please contact Special Order for additional information.

ColorFlex (continued)		
COLOR	10.5 OZ (311 ML)	4 OZ (118 ML)
JEWEL	CF807010	-
KHAKI	-	CF804204
LAVENDER	-	CF808004
LEAD	-	CF821104
LEAF GREEN	-	CF812404
LEMONWOOD	CF810810	-
LIGHT GREY	-	CF800504
MAHOGANY	-	CF806704
MALT	CF800910	-
MAPLE	-	CF804304
MARSH	CF809710	-
METAL GREY	-	CF820904
NAVY	CF814810	-
OAK	CF804710	CF804704
OATMEAL	CF802410	CF802404
OYSTER SHELL	CF801410	-
PALE BLUE	-	CF800404
PARCHMENT	CF802310	CF802304
PEACH	CF817910	-
PEANUT	CF805310	CF805304
PEARL	CF800310	-
PEPPERDUST	CF808410	-
PEWTER	CF820610	CF820604
PINE	CF809210	-
PLATINUM	CF819910	CF819904
PLUM BROWN	-	CF807804
PLUM	-	CF816604
PRALINE	-	CF805704
PUMICE	CF819310	CF819304
PURPLE	CF816410	-
PUTTY GREY	CF801710	CF801704
PUTTY	CF801110	CF801104
QUARRY	CF808210	-
RED OAK	CF804610	CF804604
ROSE PEBBLE	CF805010	CF805004
ROYAL BLUE	-	CF815404
SABLE	-	CF821804
SAGE	-	CF809304
SAND	-	CF802904
SANDSTONE	CF809910	CF809904
SEA FOAM	-	CF808904
SEA GREEN	-	CF811704
SILVERADO	CF819610	-
SLATE BLUE	CF816210	-
SLATE	CF821310	-
SPARTAN	CF804510	CF804504
SPICE	-	CF806604
STONE	-	CF803104
STORM CLOUD	CF808510	CF808504
TAUPE STONE	CF808710	CF808704
TAUPE	-	CF803004
TEAK	-	CF805104
TEAL	-	CF813504
TERRA COTTA	CF806310	CF806304
WALNUT	CF807310	CF807304
WHITE	CF800110	CF800104
WINE	-	CF817204



A11

All colors are available in both formats. Please contact Special Order for additional information.

All products are sold by unit except those shown with an \*. These are sold by box.



## Abrasives

## SECTION B

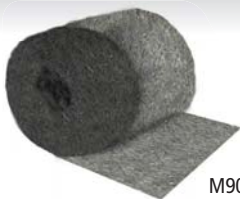

M9090540



M9090301 to M9090306

**Steel Wool**

- Flexible alternative to sanding
- Recommended for use with most stains, lacquers and protective finishes

GRIT	NO.	QTY/BOX
00 VERY FINE	<b>M9090301</b>	16
0000 SUPER FINE	<b>M9090303</b>	16
4/0 (3 1/2" × 125')	<b>M9090540</b>	1 ROLL (5 LB)

Sold by box only

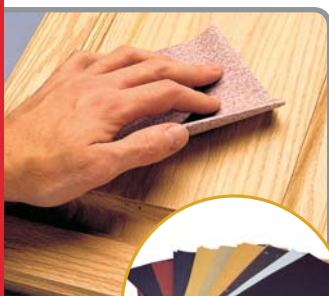
**NORTON****"Adalox 275 NO-FIL" Sanding Sheets**

- Aluminum oxide resin bond
- 9" × 11"
- B-weight paper backing

GRIT	NO.	QTY/BOX
100	<b>4909110100</b>	100
120	<b>4909110120</b>	100
150	<b>4909110150</b>	100
220	<b>4909110220</b>	100
320	<b>4909110320</b>	100
400	<b>4909110400</b>	100

Sold by box only

**"Adalox 275 NO-FIL" 2 3/4" × 5" Sanding Sheets**

Designed for all types of wood sanding and all applications.

Features:

- Premium, P-graded heat-treated aluminum oxide abrasive
- B-weight paper backing
- New bond system

GRIT	NO.	QTY/BOX
150	<b>5502345150</b>	100
180	<b>5502345180</b>	100
220	<b>5502345220</b>	100

Sold by box only

**SOFT-TOUCH Sanding Sponges**

- 4 1/2" × 5 1/2" × 3/16"
- Can be used on a variety of materials - Metal, glass, composites, and plastic

GRIT	NO.	QTY/BOX
MICROFINE (P1500/P1200)	<b>5500041205</b>	20
ULTRAFINE (P1000/P800)	<b>5500041210</b>	20
SUPERFINE (P600/P500)	<b>5500041215</b>	20
FINE (P400/P320)	<b>5500041220</b>	20
MEDIUM (P180/P120)	<b>5500041225</b>	20

Sold by box only

**B12**

Best on the market!

"Adalox 275 NO-FIL" Stick-on Sanding Discs				
GRIT	Ø 5"	Ø 5" (5 holes)	Ø 6"	QTY/ROLL
80	2500050080	-	2500060080	100
100	2500050100	2500055100	2500060100	100
120	2500050120	2500055120	2500060120	100
150	2500050150	2500055150	2500060150	100
180	2500050180	-	2500060180	100
220	2500050220	-	2500060220	100
320	2500050320	-	2500060320	100
400	2500050400	-	-	100

Sold by roll only

Above average performance!

"CORA PB273" Stick-on Sanding Discs			
GRIT	Ø 5"	Ø 6"	QTY/ROLL
80	1800050080	1800060080	100
120	1800050120	1800060120	100
150	1800050150	1800060150	100
220	1800050220	-	100
320	1800050320	-	100

Sold by roll only



Good dollar value!

"A290" Stick-on Sanding Discs			
GRIT	Ø 5"	Ø 6" (6 holes)	QTY/ROLL
80	1600050080	-	100
100	1600050100	-	100
120	1600050120	1600066120	100
150	1600050150	1600066150	100
180	1600050180	-	100
220	1600050220	1600066220	100
320	1600050320	-	100

Sold by roll only



Best on the market!

"Adalox 275 NO-FIL" Grip-on Sanding Discs					
GRIT	Ø 5"	Ø 5" (5 holes)	Ø 6"	Ø 6" (6 holes)	QTY/BOX
80	3500500080	3500550080	3500600080	-	100
100	3500500100	3500550100	3500600100	3500660100	100
120	3500500120	3500550120	3500600120	3500660120	100
150	3500500150	3500550150	3500600150	3500660150	100
180	3500500180	3500550180	3500600180	-	100
220	3500500220	3500550220	-	-	100
320	3500500320	3500550320	-	-	100
400	-	3500550400	-	-	100

Sold by box only

All products are sold by unit except those shown with an \*. These are sold by box.

# Abrasives

SECTION B

*Above average performance!*

## "CORA PB273" Grip-on Sanding Discs

GRIT	Ø 5"	Ø 5" (8 holes)	QTY/BOX
80	2800050080	2800058080	100
100	2800050100	2800058100	100
120	2800050120	2800058120	100
150	2800050150	2800058150	100
180	2800050180	2800058180	100
220	2800050220	2800058220	100
320	2800050320	-	100

Sold by box only



*Good dollar value!*

## "A290" Grip-on Sanding Discs

GRIT	Ø 5" (5 holes)	Ø 5" (8 holes)	QTY/BOX
100	2600055100	2600058100	50
120	2600055120	2600058120	50
150	2600055150	2600058150	50
220	2600055220	2600058220	50
320	2600055320	2600058320	50

Sold by box only

## Portable Sanding Belts

Premium abrasive grain ensures a long product life, fast cutting, and an optimal finish. Manufactured with a smooth bidirectional butt splice. An X-weight cotton backing offers cool operation on platen sanders.

Features:

- Aluminum oxide
- Full resin bond
- Belts may be reversed in direction to achieve maximum performance



B14

NO.	WIDTH	LENGTH	GRIT	GRIT TEXTURE	QTY/BOX
1500318050	3"	18"	50	COARSE	10
1500318080	3"	18"	80	COARSE	10
1500318120	3"	18"	120	MEDIUM	10
1500321050	3"	21"	50	COARSE	10
1500321060	3"	21"	60	COARSE	10
1500321080	3"	21"	80	COARSE	10
1500321100	3"	21"	100	MEDIUM	10
1500321120	3"	21"	120	MEDIUM	10
1500324050	3"	24"	50	COARSE	10
1500324060	3"	24"	60	COARSE	10
1500324080	3"	24"	80	COARSE	10
1500324100	3"	24"	100	MEDIUM	10
1500324120	3"	24"	120	MEDIUM	10
1500424050	4"	24"	50	COARSE	10
1500424060	4"	24"	60	COARSE	10
1500424080	4"	24"	80	COARSE	10
1500424100	4"	24"	100	MEDIUM	10
1500424120	4"	24"	120	MEDIUM	10
1500424100	4"	24"	100	MEDIUM	10
1500424120	4"	24"	120	MEDIUM	10



Mirka Orbital Sander

The unique symmetrical design makes it just as comfortable whether it's being used in the left hand or the right hand and the longer body provides the option of a two-hand grip. Equipped with a backing pad, which has a central air inlet. This results in improved air flow and helps extract dust away from the center of the tool even faster.

NO.	DESCRIPTION	QTY/BOX
AMID55020CAUS	5" DIRECT ELECTRIC RANDOM ORBITAL SANDER	1
AMID65020CAUS	6" DIRECT ELECTRIC RANDOM ORBITAL SANDER	1



"SPIRIT" Light to Medium Duty Sander

- 12,000 RPM air motor. High-strength, composite rotor has better lubricating qualities, allowing blades to last longer

Includes:  
• Low profile, premium urethane weight-mated sanding pad

Ø	ORBIT Ø	DETAILS	USE	NO.
5"	3/16"	CENTRAL VACUUM	GENERAL SANDING	9159024*
5"	3/16"	CENTRAL VACUUM	GENERAL SANDING	9159024HL**
6"	3/16"	CENTRAL VACUUM	GENERAL SANDING	9159029HL**

\* With stick-on pad \*\* With grip-on pad



"SILVER SUPREME" Medium to Agressive Duty Sander

- 12,000 RPM air motor. High-strength, composite rotor has better lubricating qualities, allowing blades to last longer

Includes:  
• Low profile, premium urethane weight-mated sanding pad

Ø	ORBIT Ø	DETAILS	USE	NO.
5"	3/16"	CENTRAL VACUUM	GENERAL SANDING	9169024*
5"	3/16"	CENTRAL VACUUM	GENERAL SANDING	9169024HL**

\* With stick-on pad \*\* With grip-on pad



All products are sold by unit except those shown with an \*. These are sold by box.



**Abrasive Finishing Tool - 1/4" Collar**

- Lightweight air-powered abrasive finishing tool for use with spindle-mount, arbor-mount and eyelet sanding stars.
- For whitewood/sealer sanding, light deburring of metal, or fabricating and finishing composite surfaces.
- Excellent for use on wooden parts, moldings, raised panels and intricate profiles. Eliminates raised grain and removes loose fibers when sanding whitewood, and scuffs sealer coats.
- Tool includes 94407 air-flow control fitting for maximum maneuverability and control.

Ø	ORBIT Ø	DETAILS	USE	NO.
4"	1/4"	LIGHT-WEIGHT	FINISHING	9152050



**DYNABUG II Orbital Sander**

- 3" × 4 1/4" (74 × 109 mm)
- Rectangular shape sands deep into corners where round pads cannot reach.

ORBIT Ø	DETAILS	USE	NO.
3/32"	NON-VACUUM	ULTRA-FINE SANDING	9158509*
3/32"	NON-VACUUM	ULTRA-FINE SANDING	9158500**

\* With stick-on pad \*\* With grip-on pad



**A275 Grip-on Sanding Sheets  
(for DYNABUG II Orbital Sander)**

- 3" × 4 1/4" (74 × 109 mm)
- Premium, P-graded heat-treated aluminum oxide abrasive

GRIT	for 9158500	QTY/BOX
120	5003414120	100
150	5003414150	100
180	5003414180	100
220	5003414220	100
280	5003414280	100
320	5003414320	100



**Headless Pinner  
23 Gauge**

- Powerful motor penetrates fasteners through the hardest materials
- Double-trigger safety prevents accidental firing of tool
- Innovative and patented design that eliminates the need to adjust to different fastener lengths

NO.	DESCRIPTION	PIN LENGTH
9145P650L	COMPRESSED AIR PINNER	1/2" TO 2"
9145P635	COMPRESSED AIR PINNER	3/8" TO 1 3/8" (EXCEPT 1 1/4")

- Accommodates smaller compressors
- For more headless pins and more hardwood applications

NO.	DESCRIPTION	PIN LENGTH
9145P650LX	COMPRESSED AIR PINNER	1/2" TO 2"



**Cordless 18-Gauge Brad Nailer**

- This cordless brad nailer has a small nose and is by far the smallest cordless tool
- Over 1300 shots per gas cylinder

NO.	DESCRIPTION	QTY/BOX
91456C1850	NAILER	1
9146GFC0104	FUEL CARTRIDGE	4
9146GFC0112	FUEL CARTRIDGE	12



**Crown Corrugated Nailer - 25 Gauge**

- Powerful motor penetrates fasteners through the hardest materials
- Innovative and patented design that eliminates the need to adjust to different fastener lengths

NO.	DESCRIPTION	CORRUGATED CROWNS
9145CF15AA	COMPRESSED AIR NAILER	1/4", 3/8", 1/2"



All products are sold by unit except those shown with an \*. These are sold by box.



### Brad Nailer - 16 Gauge

For your heavier finishing needs and also suitable for light wood construction applications, such as door and window casings.

- 360° adjustable exhaust cover lets tool be used in any position

NO.	DESCRIPTION	PIN LENGTH
91451664	COMPRESSED AIR NAILER	1 1/4" TO 2 1/2"



### Brad Nailer - 18 Gauge

- A narrow nose design lets you reach in corners and tight areas
- Dual firing options : sequential and contact fire modes
- Automatic trigger lockout prevents empty firing and alerts

NO.	DESCRIPTION	PIN LENGTH
9145P1850	COMPRESSED AIR NAILER	5/8" TO 2"
91451850GB	COMPRESSED AIR NAILER, GREEN BUDDY	1/2" TO 2"



### Narrow Crown Stapler - 18 Gauge

The unique long-nose feature permits difficult fastener placement in many cabinet assembly and drawer applications.

NO.	DESCRIPTION	STAPLE LENGTH
91459032	COMPRESSED AIR STAPLER	3/8" TO 1 1/4"
91459040	COMPRESSED AIR STAPLER	1/2" TO 1 9/16"



### Crown Stapler - 50AD - 20 Gauge

Duo-Fast 5000 series compatible

- Powerful motor with a fast air recycling time
- Easy pull-up magazine latch for quick access to fastener reloading
- Heavy steel head cap can be used as a hammer for quick fixes

Fine Wire

NO.	DESCRIPTION	STAPLE LENGTH
914550AD	COMPRESSED AIR STAPLER	3/16" TO 5/8"

### Magnesium Brad Nailer and Stapler

- Lightweight magnesium body design
- 360° adjustable exhaust
- Depth drive adjustment
- Quick release nose
- Adjustable dual action firing mode

**Includes:**

- Hex wrenches
- Oil
- Swivel plug
- Safety glasses

### Magnesium Brad Nailer - 18 Gauge

NO.	DESCRIPTION	NAIL LENGTH
980182	COMPRESSED AIR NAILER	5/8" TO 2"



### Magnesium Narrow Crown Stapler - 18 Gauge

NO.	DESCRIPTION	STAPLE LENGTH
9889041	COMP. AIR NARROW CROWN STAPLER	5/8" TO 1 1/2"



### Galvanized Brad Nails - 16 & 18 Gauge

Compatible with:

- Arto Tip Tools • Duofast 700, LFN, 764A • Max NF 16
- Airy ATM 0365, ATF 0350 • Bea SK40 • CRISP-AIR • Hitachi NT65
- Paslode F16, IMF250F • Bex 16ga Bradders • FA500 FN tools
- Porter Cable FN200, FN250, CFN250 • Bostitch BT1200
- Haubold SKN16 • Campbell Hausfeld NB006500 • Bex 16ga Bradders
- FA500 FN tools • Porta Cable FN200, FN250, CFN250
- Bostitch BT1200 • Haubold SKN16 • Campbell Hausfeld NB006500

16 GAUGE	
NO.	LENGTH
98001316B	13/16"
980100B	1"
9801316B	1 3/16"
980114B	1 1/4"
980138B	1 3/8"
980112B	1 1/2"
980134B	1 3/4"
980200B	2"
980214B	2 1/4"
980212B	2 1/2"

18 GAUGE	
NO.	LENGTH
91291058	5/8"
91291034	3/4"
912910100	1"
912911316	1 3/16"
91291114	1 1/4"
91291138	1 3/8"
91291112	1 1/2"
912911916	1 9/16"
91291134	1 3/4"
91291200	2"

Sold by box only (5000/box)



All products are sold by unit except those shown with an \*. These are sold by box.





### Galvanized Crown Staples - 20 Gauge

Compatible with Duo-Fast 5000 Series. Grex 50AD.

NO.	LENGTH	QTY/BOX
91464014	1/4 "	5000
914640516	5/16 "	5000
91464038	3/8 "	5000
91464012	1/2 "	5000
914640916	9/16 "	5000

Sold by box only



### I-Pins - 23 Gauge

NO.	LENGTH	QTY/BOX
914662012	1/2 "	10 000
91462058	5/8 "	10 000
91462100	1 "	10 000
914621316	1 3/16 "	10 000
91462138	1 3/8 "	10 000
91462112	1 1/2 "	10 000
91462200	2 "	10 000

Sold by box only



C20

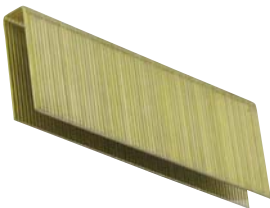

### Narrow Crown Staples, Series 90 - 18 Gauge

NO.	LENGTH	QTY/BOX
91298012	1/2 "	5000
91298058	5/8 "	5000
91298034	3/4 "	5000
91298078	7/8 "	5000
91298100	1 "	5000
91298118	1 1/8 "	5000
91298114	1 1/4 "	5000
91298112	1 1/2 "	5000

Sold by box only

**Silent Compressor - 1 HP**

- 8-amp motor
- Low noise at only 60 dB

**Quiet**

NO.	VOLTAGE	DESCRIPTION
91350010	120V	INDUSTRIAL-GRADE

**Auto-Retractable Polyurethane Air Hoses**

Cabinet workshops

- Temperature rating: -37°C/ 93°C (-35°F/200°F)

NO.	BRASS FITTING Ø	LENGTH	DIAMETER
913501425	1/4"	25'	1/4"
913511450	1/4"	50'	1/4"

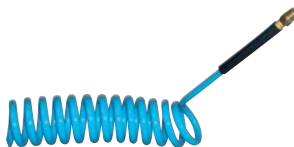
**Premium Air Hose**

- 40% lighter than a rubber hose
- Flexible in low temperatures
- Made from hybrid polymer
- Abrasion resistant
- Working pressure: 300 PSI
- Aluminum fittings
- Temperature rating: -40 °C/65 °C (-40 °F/150 °F)
- Inner braided nylon reinforcement

NO.	LENGTH	DIAMETER
91350425	25'	1/4"
91350450	50'	1/4"
91350650	50'	3/8"

**NEW!****Flexreel with Hybrid Hose (M) NPT**

For wherever hose storage and handling is an issue, construction sites.

- Maximum working temperature: -40°C to 65°C (-40°F to 150°F)

NO.	BRASS FITTING Ø	LENGTH	DIAMETER
913579805	1/4"	50'	3/8"

**PolyReel Flexair Portable Hose Reels (M) NPT (With Polyurethane Hose)**

For wherever hose storage and handling is an issue, construction sites.

- Maximum working temperature: -20°C to 74°C (-4°F to 165°F)

NO.	BRASS FITTING Ø	LENGTH	DIAMETER
913579040	1/4"	100'	1/4"

**Rolair with Flex Hybrid PVC Hose (M) NPT**

Ideal for indoor and outdoor use.

- Maximum working temperature: 0°C to 60°C (32°F to 140°F)

NO.	BRASS FITTING Ø	LENGTH	DIAMETER
913579365	1/4"	27'	1/4"

**Medium-Duty Tool Balancer - 3.0 to 5.0 lb.**

For pneumatic and electric tools, screw drivers, drills, riveting machines.

NO.	DESCRIPTION
913564130	GALVANIZED STEEL CABLE, NYLON COATED



All products are sold by unit except those shown with an \*. These are sold by box.



Bi-Metal Hole Saws

Ideal for cutting wood, laminate, sheet metal, thick metal, stainless steel, and plastic.  
• Teeth in cobalt alloy (8%) for longer life and higher heat resistance

NO.	DIA.	QTY/BOX	NO.	DIA.	QTY/BOX
BSHB063	5/8 "	1	BSHB231	2 5/16 "	1
BSHB075	3/4 "	1	BSHB236	2 3/8 "	1
BSHB087	7/8 "	1	BSHB250	2 1/2 "	1
BSHB100	1 "	1	BSHB263	2 5/8 "	1
BSHB112	1 1/8 "	1	BSHB275	2 3/4 "	1
BSHB125	1 1/4 "	1	BSHB300	3 "	1
BSHB136	1 3/8 "	1	BSHB312	3 1/8 "	1
BSHB150	1 1/2 "	1	BSHB363	3 5/8 "	1
BSHB175	1 3/4 "	1	BSHB375	3 3/4 "	1
BSHB187	1 7/8 "	1	BSHB412	4 1/8 "	1
BSHB200	2 "	1	BSHB425	4 1/4 "	1
BSHB212	2 1/8 "	1	BSHB436	4 3/8 "	1
BSHB225	2 1/4 "	1			

NEW!



Daredevil Hole Saws

- Deliver up to 10x speed and life, deeper drilling in multiple materials
- Provide fast, clean cuts in multiple sandwich materials

NO.	DIAMETER
BSHMD175	1 3/4 "
BSHMD200	2 "
BSHMD212	2 1/8 "
BSHMD225	2 1/4 "
BSHMD250	2 1/2 "
BSHMD275	2 3/4 "
BSHMD300	3 "
BSHMD363	3 5/8 "



Bi-Metal Hole Saw Set

Includes:

- Hole saws (BSHB25M: 11, BSHB19EL: 8, BSHB17PL: 7)
- Adapters (BSHB25M: 11, BSHB19EL: 8, BSHB17PL: 7)
- 1 Quick Change mandrel • 2 Pilot bits • 1 Plastic case

NO.	DESCRIPTION	QTY/BOX
BSHB25M	MASTER SET, 25 PIECES	1
BSHB19EL	GREAT FOR ELECTRICIANS, 19 PIECES	1
BSHB17PL	GREAT FOR PLUMBERS, 17 PIECES	1



BOSCH

Hole Saws & Accessories

**3/8" Universal Quick Change Mandrel Kit**

- 1 Mandrel (3/8") • 1 Small adapter for hole saw sizes from 9/16" to 1 3/16" • 1 Large adapter for hole saw sizes from 1 1/4" to 6"

NO.	QTY/BOX
BSPCM38AN	1



**Quick Change Conversion Kit**

- 2 Small adapters for hole saw sizes from 9/16" to 1 3/16"
- 4 Large adapters for hole saw sizes from 1 1/4" to 6"

NO.	QTY/BOX
BSCK2	1



**Hole Enlarger Kit**

This kit makes it possible to expand holes in tight retrofit situations, door lock installations, and conduit fittings.

NO.	QTY/BOX
BSHE1	1



**3/8" Bi-Metal Power Change Hole Saw Mandrel**

For hole saw sizes from 9/16" to 6"

NO.	QTY/BOX
BSPCM38	1



**Diamond Hole Saw Set (3 Pieces)**

Ideal for fiberglass, cement board, wall tile (ceramic), hard tile (porcelain), stone (granite), and glass.

NO.	DESCRIPTION	QTY/BOX
BSHDGM	MINI DIAMOND HOLE SAW SET	1
BSHDG138QA	1 3/8" STARTER SET	1



All products are sold by unit except those shown with an \*. These are sold by box.

NEW!



### Universal Bi-Metal Titanium STORM Blades - T340

- Designed for wood, metal and PVC
- Width: 1 3/4"
- Plunge Depth: 1 5/8"
- Teeth per inch: 18

NO.	QTY/BOX
IB3401	BLISTER OF 1 UNIT
IB3403	BLISTER OF 3 UNITS
IB34010	BLISTER OF 10 UNITS
IB34025	BOX OF 25

NEW!



### Universal Bi-Metal Titanium STORM Blades - T330

- Especially designed for cutting through nail-laden wood, deck screws, sheet metal, etc.
- Width: 1 1/4"
- Plunge Depth: 1 5/8"
- Teeth per inch: 18

NO.	QTY/BOX
IB3301	BLISTER OF 1 UNIT
IB3303	BLISTER OF 3 UNITS
IB33010	BLISTER OF 10 UNITS

NEW!



### Bi-Metal Titanium STORM Blades for Wood with Nails - T337

- Width: 2 1/2"
- Plunge Depth: 1 5/8"
- Teeth per inch: 18

NO.	QTY/BOX
IB3371	BLISTER OF 1 UNIT
IB3373	BLISTER OF 3 UNITS

NEW!



### Bi-Metal Titanium STORM Blades for Wood with Nails - T336

- Width: 1 1/4"
- Plunge Depth: 1 5/8"
- Teeth per inch: 18

NO.	QTY/BOX
IB3361	BLISTER OF 1 UNIT
IB3363	BLISTER OF 3 UNITS

NEW!



### Segment HSS Saw Blade - T410

- A high-speed steel flat saw blade segmented on one side that cuts through harder wood and sheet metal up to 1mm thick as well as carbon fiber, fiberglass, and nails.
- Width: 3 1/8"
- Teeth per inch: 18

NO.	QTY/BOX
IB4101	BLISTER OF 1 UNIT

NEW!



### Variety Pack - STORM Blades

- Includes:
- 2x IB330 blades
  - 2x IB336 blades
  - 2x IB340 blades
  - 1x carrying case

NO.	QTY/BOX
IB0006	BLISTER OF 7 UNITS

**Makita**

### 7 1/4" Circular Saw

- New and improved with high power to weight ratio
- Two-stage safety trigger switch prevents accidental start up
- Aluminum baseplate for added durability

NO.	DESCRIPTION
MKTH57600	BEVEL CAPACITY OF 45°



**NEW!**



### "MAMBA" Saw Blades

NO.	APPLICATIONS	DIAMETER		TEETH	GRIND	KERF		PLATE		BORE	
		MM	IN			MM	IN	MM	IN	MM	IN
ATMA10080	NON-FERROUS, PLASTICS & PVC SAW BLADE	250	10	80	TCG	2.5	3/32	1.8	5/64	15.875	5/8
ATMA10060	FINISHING SAW BLADE	250	10	60	ATB + F	2.5	3/32	1.8	5/64	15.875	5/8
ATMD7240	FOR FRAMING AND DECKING	185	7 1/4	24	FT	1.8	5/64	1.2	3/64	15.875	5/8
ATMD7400	FOR FRAMING AND DECKING	185	7 1/4	40	FT	1.8	5/64	1.2	3/64	15.875	5/8

### 2-Piece 12" Miter Saw Blade Set

NO.	APPLICATIONS	DIAMETER MM IN		TEETH	KERF MM IN		PLATE MM IN		BORE MM IN	
ATMA12012	MA12045 GENERAL PURPOSE	305	12	45	2.8	0.11	2.2	0.087	25	1
	MA12072 FINISHING COMPOUND	305	12	72	2.8	0.11	2.2	0.087	25	1

### Melamine Saw Blades 10" to 12"

BEST FOR DOUBLE SIDED MELAMINE

- Easily re-sharpened
- 6° negative hook/10 mm pitch 25° "HIGH-ATB" grind



NO.	DIAMETER		TEETH	GRIND	KERF (B)		PLATE (C)		BORE	QTY/BOX
	IN	MM			INCH	MM	INCH			
ATMB10800C	10	250	80	H-ATB	0.126	3.2	0.102		5/8"	1
ATMB12960C	12	300	96	H-ATB	0.126	3.2	0.102		1"	1

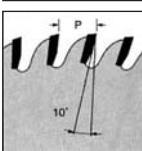
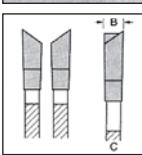
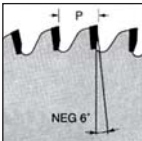

### General Purpose Cut-Off Saw Blades

- Universal use, rip and cross-cut natural wood and resize plywood

NO.	DIAMETER		TEETH	GRIND	KERF (B)		PLATE (C)		BORE	QTY/BOX
	IN	MM			IN	MM	IN			
AT610601C	10	250	60	TCG	0.126	3.2	0.087		5/8"	1
AT612721C	12	300	72	TCG	0.126	3.2	0.087		1"	1

All products are sold by unit except those shown with an \*. These are sold by box.

NEW!

**Titanium Nitride Coated Drill Bits**

Multipurpose drill bit designed to drill through wood, metals, PVC and non-ferrous materials. Coated in titanium nitride to provide added protection from heat build-up and 6X longer tool life than HSS.

NO.	Ø	LENGTH	QTY/BOX
AT616104	1/16"	1 7/8"	3
AT616106	5/64"	2"	3
AT616108	3/32"	2 1/4"	3
AT616109	3/32"	2 1/4"	10
AT616110	7/64"	2 5/8"	3
AT616111	7/64"	2 5/8"	10
AT616112	1/8"	2 3/4"	3
AT616113	1/8"	2 3/4"	10
AT616114	9/64"	2 7/8"	1
AT616116	5/32"	3 1/8"	1
AT616118	11/64"	3 1/4"	1
AT616120	3/16"	3 1/2"	1
AT616121	3/16"	3 1/2"	10
AT616122	13/64"	3 5/8"	1
AT616124	1/16"	1 7/8"	1
AT616126	5/64"	2"	1
AT616128	3/32"	2 1/4"	1
AT616132	3/32"	2 1/4"	1
AT616136	7/64"	2 5/8"	1
AT616140	7/64"	2 5/8"	1
AT616144	1/8"	2 3/4"	1
AT616162	1/8"	2 3/4"	1

**Drill Bit Treated Steel**

- Brad point

NO.	LENGTH	SHANK Ø (d) × BORING Ø (D)	QTY/BOX
AT606117	85 MM	5 MM × 5 MM	1
AT606123	90.5 MM	6 MM × 6 MM	1
AT606124	101 MM	6 MM × 6 MM	1
AT606130	111 MM	7.5 MM × 7.5 MM	1
AT606142	130 MM	9.5 MM × 10 MM	1
AT606143	165 MM	10 MM × 10 MM	1
AT606160	197 MM	12.7 MM × 19 MM	1

**3-Piece Euro Hinge Boring Set**

Includes:

- 2 × 8 mm bits (left hand)
- 1 × 35 mm bit (right hand)

NO.	QTY/BOX
ATHBM102	1



### Brad Point Boring Bits

- With carbide tips
- The best choice for precision woodworking
- They are fully ground and polished to give superior chip clearance

NO.	SHANK Ø (d)	BORING Ø (D)	CUTTING LENGTH (B)	LENGTH (L)
AT201005	10 MM	5 MM (RIGHT HAND)	27 MM	57 MM
AT301005	10 MM	5 MM (LEFT HAND)	27 MM	57 MM
AT201008	10 MM	8 MM (RIGHT HAND)	27 MM	57 MM
AT301008	10 MM	8 MM (LEFT HAND)	27 MM	57 MM
AT201010	10 MM	10 MM (RIGHT HAND)	27 MM	57 MM
AT301010	10 MM	10 MM (LEFT HAND)	27 MM	57 MM

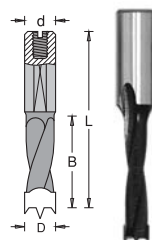

### Hinge Boring Bit

- With carbide tips

NO.	SHANK Ø (d)	BORING Ø (D)	CUTTING LENGTH (B)	LENGTH (L)
AT203351	10 MM	35 MM (RIGHT HAND)	27 MM	57 MM

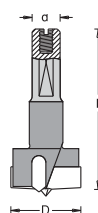

### Panel Pilot Bits

- Single flute panel pilot bits • 1/4" Ø shank

NO.	TYPE OF CUT	CUTTING Ø (D)	CUTTING LENGTH (B)	OVERALL LENGTH (L)
AT51200	FLUSH	1/4"	1/4"	1 1/2"
AT51202	7°	1/4"	1/4"	1 1/2"

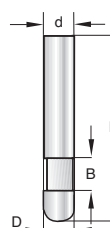

### "NO-FILE™" Trim Bits

- 2-flute with ball bearing guide router bit • 1/4" Ø shank

NO.	CUTTING Ø (D)	CUTTING LENGTH (B)	RADIUS (d)	OVERALL LENGTH (L)
AT47150	1/2"	3/8"	.059 (1.5 MM)	1 7/8"
AT47154	5/8"	3/8"	.015 (.4 MM)	1 7/8"

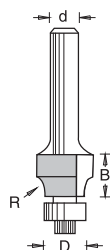

### Flush Trim Bits

- 2-flute with ball bearing guide • 1/4" shank Ø

NO.	CUTTING Ø (D)	CUTTING LENGTH (B)	OVERALL LENGTH (L)
AT47102	3/8"	1/2"	2 1/8"
AT47106	1/2"	1/2"	2 1/4"
AT47104	1/2"	1"	2 5/8"

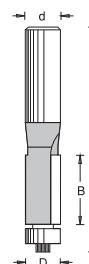

### DecoMetal Router Bits

These innovative new bits are specially designed and tested for trimming all decorative metal laminates and have been recommended by Advanced Technology Inc. and Formica® for use in all DecoMetal® material.

NO.	CUTTING Ø (D)	CUTTING LENGTH (B)	OVERALL LENGTH (L)
AT51430	1/4"	5/8"	2 3/8"
AT51432	1/2"	5/8"	3 1/4"



All products are sold by unit except those shown with an \*. These are sold by box.



Jig Saws

- Powerful 7.0-amp motor: top jigsaw amp rating
- Ergonomic body with front soft-grip area for maximum comfort and control
- Exclusive multidirectional blade clamp provides superior grip on T-shank blades

NO.	DESCRIPTION	QTY/BOX
BSJS470E	TOP-HANDLE JIG SAW, 110V	1
BSJS470EB	BARREL GRIP JIG SAW, 110V	1



Jig Saw Blades

- Made of HCS • Fit most jig saw power tools

REF. NO.	LEN.	TEETH/ INCH	APPLICATIONS	QTY/ BOX
A 101B	4"	10	Clean cut in all woods, plastics. 3/16" to 1 1/4"	5
BST101B100	4"	10		100
B 101D	4"	6	Clean cut in all woods, plastics. 1/4" to 2 3/8"	5
BST101D100	4"	6		100
C 111C	4"	8	Fast coarse cut in softwoods. 7/32" to 2 3/8"	5
D 144DBR	4"	5-6	Very fast cuts in all woods. 1/4" to 2 3/8"	100
E 101AO	3"	20	Curved cuts splinter free on both sides : all woods and laminates. 5/64" to 3/4"	5
BST101AO100	3"	20		100
F 101BR	4"	10	Splinter free cut on top of the surface all woods and plastics. 3/16" to 1 1/4"	5
101BRB	4"	10		100
G 127D	4"	8	Special for aluminum fast straight cuts. 3/16" to 5/8"	5
H BST308B	4 1/2"	12	X-tra clean straight cuts on both sides of all woods.	5
BST308B25	4 1/2"	12		25
I BST244D	4"	5-6	Scroll blade for curved and fast cuts in all woods. 1/4" to 2 3/8"	5
J BST118A	3 5/8"	17-24	Straight cuts in metals up to 1/8" thick.	5
K BST118GFS	3 1/4"	36	Straight cuts in stainless steel gauge 8 to 26.	5
L BST123X	4"	5-10	Fast cuts in metal and fiberglass.	5
M BST345XF	5 1/4"	10	Fast cuts in wood with nails.	5
N BST130RF1	3 1/4"	30	Straight or curved cuts in ceramics , glass or fiberglass.	5



NEW!

Jig Saw Blades for Wood

REF NO.	DESCRIPTION	APPLICATION	TEETH/INCH	QTY/BOX
A 99101A030	Curved cut jig saw blade - splinter-free on both sides	Double-sided laminates, laminated particleboard, MDF, hard and soft woods, plywood (5/64" to 3/4")	18	30
99101A05				5
B 99101B30	Straight fine cut jig saw blade	Hard and soft woods, plastics, fiberglass, oriented strand board, plywood, and laminated particleboard (3/16" to 1 1/4")	10	30
99101B5				5
C 99101BR30	Reverse pitch jig saw blade - splinter free top side	Hard and soft woods, chipboard, wood core plywood, fiberboard, laminated board, clean surface	10	30
99101BR5				5
D 99101D30	Straight fast and clean cut jig saw blade	Hard and soft woods, plywood, Oriented Strand Board and plastics (1/4" to 2 3/8")	6	30
99101D5				5
E 99144D30	Very fast straight cut jig saw blade	Soft woods (3/16" to 2"), chipboards, wood core plywood, fiberboard, fiberglass and plastic	6	30
99144D5				5

Tabletop Edgebander

Electronically controlled heating element offers infinitely variable heat from 100 to 200° C to accommodate a wide range of edgebanding materials up to 2 1/4" wide.

NO.	QTY/BOX
PPEB101B	1



Laminate Trimmer

- Rack & Pinion mechanism for fine depth adjustment
- Adjustable guide for trimming laminates
- Ergonomic slim body style for maximum operator comfort and control
- Soft rubber grip design for vibration absorption and comfortable operation

NO.	DESCRIPTION	QTY/BOX
MKT3709	LAMINATE TRIMMER 1/4"	1



Laminate Trimmer Bit with Euro Square Teflon Bearing

Diameter: 1/2 in (12.7 mm)

NO.	SHANK Ø		CUTTING Ø		CUTTING LENGTH		OVERALL LENGTH	
	MM	IN	MM	IN	MM	IN	MM	IN
BITETH	6.35	1/4	12.7	1/2	7.54	19/64	44.5	1 3/4
BITETT	6.35	1/4	19.1	3/4	15.9	5/8	60.3	2 3/8
BITETT12	12.7	1/2	19.1	3/4	15.9	5/8	66.7	2 5/8



NEW!

All products are sold by unit except those shown with an \*. These are sold by box.



Single-Speed Palm Router (1.0 HP)

- Rugged aluminum fixed base: durable, solid and precise
- Versatile bit-changing system: fast, easy bit changes using two wrenches or spindle lock and one wrench
- Palm-grip design: the most comfortable router in its class

NO.	DESCRIPTION	QTY/BOX
BSPR10E	1.0 HP PALM ROUTER	1



DB 210 Foreman Electric Pocket Hole Machine

- Extremely easy to setup and use
- Precise pocket depth and repeatable accuracy
- Creates all three types of Kreg joints

NO.	DESCRIPTION	QTY/BOX
9132059	POCKET HOLE MACHINE	1



Spline & Biscuit Joiner

- Lightweight and compact design with enhanced ergonomics for maximum manoeuvrability
- Rack & Pinion fence for accurate height adjustments
- Adjustable fence with positive detents at 0°, 45° and 90°

NO.	VOLTAGE	QTY/BOX
MKTPJ7000	120 V	1



Wood Splines

NO.	SIZE	NUMBER	QTY/BOX
90000	47 MM × 14 MM	00	1,000
90010	53 MM × 19 MM	10	1,000
90020	60 MM × 23 MM	20	1,000

Dowelmax Classic Kit

The Dowelmax Kit is hand polished and assembled using top-quality machined parts.

Includes:

- 1 instructional DVD
- 1 instruction manual
- 3 spacers: 1 5/8", 3/4", 3/8"
- 1 index pin for longer joints
- 1 distance gauge for long work pieces
- 1 HSS drill bit, collar stop and wrench
- 1 reference bracket • 5 drill guides (1 3/4" long)
- 1 reference block • 1 clamp bracket

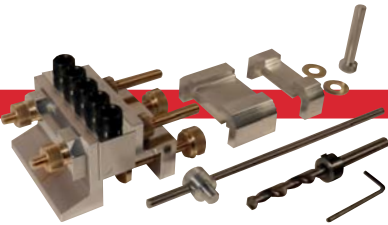

VIDEO

NO.	DESCRIPTION	QTY/BOX
9141001	PRECISION ENGINEERED JOINING	1

C30

Dowels

NO.	DESCRIPTION	Ø × LENGTH	QTY/BOX
MP830T	WOOD	8 MM × 30 MM (5/16" × 1 3/16")	1,000
830T	WOOD	8 MM × 30 MM (5/16" × 1 3/16")	9,200
MP835T	WOOD	8 MM × 35 MM (5/16" × 1 3/8")	1,000
835T	WOOD	8 MM × 35 MM (5/16" × 1 3/8")	16,400
MP525T	WOOD	5 MM × 25 MM (13/64 " × 63/64")	1,000
883020T	WOOD, PRE-GLUED	8 MM × 30 MM (5/16" × 1 3/16")	8,000*
MP883020T	WOOD, PRE-GLUED	8 MM × 30 MM (5/16" × 1 3/16")	1,000
883520T	WOOD, PRE-GLUED	8 MM × 35 MM (5/16" × 1 3/8")	8,000*
MP9827	PLASTIC	8 MM × 27 MM (5/16" × 1 1/16")	1,000

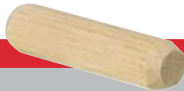

Heavy-Duty Cutters (Uses LB replacement blades)

- The original heavy-duty cutter
- Contoured handle includes a ratchet wheel blade locking mechanism

NO.	MODEL	DESCRIPTION	QTY/BOX
901041	L-1	WITH RATCHET WHEEL	6

- Exceptional comfort and safety
- Chemical resistant handle for easy cleaning auto-lock blade

901042	LA-X	WITH AUTO-LOCK	6
--------	------	----------------	---

Replacement Blades - LB

- Eight cutting edges per blade strip

NO.	MODEL	DESCRIPTION	QTY/BOX
901061	LB	10 SPARE BLADES	6
901073	LB	50 SPARE BLADES	6

Extra Heavy-Duty Cutters (Uses HB replacement blades)

- Extra heavy-duty sure-grip cutter features a rubber grip insert for positive handle control
- Anti-slip cushion handle for exceptional comfort and safety

NO.	MODEL	DESCRIPTION	QTY/BOX
901049	H-1	WITH RATCHET WHEEL	6
901052	XH-AL	AUTO-LOCK	6

Replacement Blades - HB

- Seven cutting edges per blade strip

NO.	MODEL	DESCRIPTION	QTY/BOX
901050	HB	10 SPARE BLADES	6
901075	HB	50 SPARE BLADES	6

High-Quality Richelieu Knives

SK4 master blade. Positive blade auto-lock

NO.	MODEL	DESCRIPTION	QTY/BOX
91291041	18 MM	ABS HANDLE	6
91291042	18 MM	ABS HANDLE	6
91291051	25 MM	ABS HANDLE	6

High-Quality Richelieu Replacement Blades

NO.	MODEL	DESCRIPTION	QTY/BOX
91291061	18 MM	10 SPARE BLADES	6
91291073	18 MM	50 SPARE BLADES	6
91291075	25 MM	10 SPARE BLADES	6
GTKB650	18 MM	650 SPARE BLADES	1

OLFA



All products are sold by unit except those shown with an \*. These are sold by box.



NEW!



### Plastic and Laminate Cutter

- Designed as a scoring tool for sheet plastics and laminates, allowing precise breaking of plastics

NO.	MODEL	DESCRIPTION	QTY/BOX
921200	PC-L	HEAVY-DUTY CUTTER	6

### Replacement Blades for Plastic and Laminate

- Dual-edge replacement blade

NO.	MODEL	DESCRIPTION	QTY/BOX
921201	AB	3 SPARE BLADES	6

### #9 Single Edge Razor Blades

- Toughest, strongest and sharpest industrial blades on the market today

NO.	DESCRIPTION	QTY/BOX
D010296	REPLACEMENT BLADE	100

### Cutters for Decorative Laminate

- Carbide tipped cutter to cut decorative laminate

NO.	DESCRIPTION	QTY/BOX
000344	6" CUTTER	1
000345	REPLACEMENT BLADE	1

### End Trimmer for Edgebanding

- Cuts even the heaviest types of edgebanding

NO.	DESCRIPTION	QTY/BOX
PPEN9	1/4" THICK	1

### End Trimmer for Edgebanding

- Blades are reversible and replaceable to provide long life

NO.	DESCRIPTION	QTY/BOX
9200	FROM 1/64" TO 2 1/8" THICK	1

### Manual Edge Trimmer

For finishing edgebanding.

NO.	DESCRIPTION	QTY/BOX
9400	3 3/4" LENGTH	1

### Quad Edge Trimmers

Trims 4 ways: forward, backward, and on both sides.

NO.	DESCRIPTION	QTY/BOX
918801	STEEL BLADES, BLUE	1
918802	CARBIDE BLADES, RED	1

### "PLASTI-CUT" Files

- For high pressure decorative laminate plastic and veneer
- They last longer than ordinary files

NO.	LENGTH	DESCRIPTION	QTY/BOX
5210	10"	FAST	10
5212	12"	FAST	5
5108	8"	MILL	10

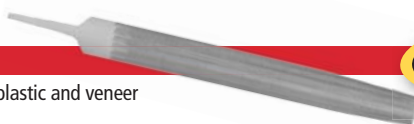

Long Lasting

NO.	LENGTH	DESCRIPTION	QTY/BOX
5110	10"	MILL	10
5112	12"	MILL	5
5114	14"	MILL	5

**Round Chainsaw File 7/32"**

NO.	LENGTH	QTY/BOX
5428	8"	12*

**10" Aluminum Flat File**

Double-cut, file with a coarse and fast cutting tooth design that is very effective on soft materials.

NO.	LENGTH	QTY/BOX
6110	10"	10

**"PLASTI-CUT" Duplex Fast/Mill File**

- "Duplex" mill and fast cut file for high pressure decorative laminate plastic and veneer
- They last longer than ordinary files

NO.	LENGTH	QTY/BOX
515210	10"	10

**Cleaning Brush for Files**

- Specially designed to clean files and prevent clogging
- For best results, pull the card across the file in the direction of the file grooves

NO.	LENGTH	QTY/BOX
00010	10"	10

**Pocket Chisels - Complete kit**

Includes:

- 1/4", 1/2", 3/4" and 1" pocket chisels
- Pocket combo putty knife
- Pocket diamond sharpener
- Pocket putty knife

NO.	DESCRIPTION	QTY/BOX
918898	COMPLETE	1

**3/4" Richelieu Pipe Clamp**

- Large feet for stability

NO.	DESCRIPTION	QTY/BOX
9129034	PIPE NOT INCLUDED	1

**3/4" Pipe, One Side Threaded**

For product # 9129034

NO.	LENGTH	QTY/BOX
PIPEBLK34	48"	1

**Richelieu Squeezer/Spreader Clamps**

- Features an I-beam bar that resists twisting and bowing, allowing maximum force to be applied

NO.	LENGTH	QTY/BOX
9129006	6"	1
9129012	12"	1

**Richelieu Spring Clamps**

- High-tech resin construction for strength and durability
- Non-marring pads to protect your workpiece

NO.	OPENING WIDTH	QTY/BOX
9129001	1"	1
9129002	2"	1
9129003	3"	1

All products are sold by unit except those shown with an \*. These are sold by box.



**NEW!**



NEW!



NEW!



C34



VIDEO

**3-Way Clamp**

- Combines a spring clamp and an edge clamp in one unit
- Approx. 30 lb. of edge pressure

NO.	QTY/BOX
912933	1

**Parallel Jaw Clamps**

- A precise 90° angle - up to 1,150 lb
- 3 3/4" -deep jaw for optimized pressure distribution

NO.	CLAMPING CAPACITY	QTY/BOX
9129024	24"	1
9129036	36"	1
9129048	48"	1

**Richelieu Clamp & Cut Guide**

- Cuts on angles up to 22.5°

NO.	QTY/BOX
9129050	1

**Adjustable Heavy-Duty Malleable F Clamps**

Throat depth: 5"

NO.	CLAMPING CAPACITY	QTY/BOX
9129251	12"	1
9129252	24"	1

**Euro Cabinetry Clamp**

Standard F clamp fitted with a unique head featuring two tapered 5 mm pins, 32 mm apart to fit into any standard Euro-style shelving system, designed for scribing and fastening stile trim to cabinets and shelving.

NO.	CLAMPING CAPACITY	QTY/BOX
912932	4 1/2"	1

**Push Toggle Clamp**

NO.	HOLDING CAPACITY	QTY/BOX
9129004	851 LB	1

**Horizontal Handle-Toggle Clamp**

NO.	CLAMPING CAPACITY	QTY/BOX
9129005	2"	1
9129007	2"	1
9129008	4"	1

**Gorilla Grippers (Carry Handle)**

Effective and essential hand tool for gripping and lifting a variety of construction industry building materials that are large, unwieldy and heavy.

NO.	CLAMPING CAP.	DESCRIPTION	QTY/BOX
911044009	0 TO 3/4"	GENERAL PURPOSE	1
911044010	3/8" TO 1 1/8"	CONTRACTOR	1
911044011	1 1/4" TO 2"	DOOR	1

Richelieu Pozidriv Screwdriver

- Length: 200 mm (7 7/8")
- Bit length: 100 mm (3 15/16")

NO.	DESCRIPTION	QTY/BOX
642101	No. 2 bit size	1
47838R	Screwdriver Magnetizer/Demagnetizer	5



Richelieu Square Drive Screwdriver

- Length: 200 mm (7 7/8")
- Bit length: 100 mm (3 15/16")

NO.	SIZE	COMPATIBLE SCREWS	COLOR	QTY/BOX
642105	No. 1	No. 5, 6, 7	RED	1
642106	No. 2	No. 8, 9, 10	GREEN	1



Torx 20 Richelieu Screwdriver

- Length: 200 mm (7-7/8")
- Bit length: 100 mm (3-15/16")

NO.	DESCRIPTION	QTY/BOX
642104	T20 bit size	1



Richelieu Ratcheting Driver

A ratchet that delivers over 225 inch-lbs of torque strength with a rubberized cushion grip handle. A precision 28-Tooth ratchet design makes driving fasteners faster and easier. The only screwdriver bits using 1-inch (25 mm). The Bit Assortment features 6 popular double end (12 tips) industrial grade durable S2 Steel bits with a HRC of 60 +/- 2. The Shaft opening serves as a 1/4" hexagonal driver.

NO.	QTY/BOX
642005	1



Richelieu Original Multi-Bit Driver

The Original bit-load driver is our most popular. Loaded with 7 double ended professional quality bits, this assortment provides 14 of the most popular tips for driving screws. The shaft opening serves as a 1/4" hex driver, hence "15 in 1"!

NO.	DESCRIPTION	QTY/BOX
642004	<ul style="list-style-type: none"><li>• 2 Phillips S2 steel double end bit sizes: 1-2,0-3</li><li>• 1 Square (Robertson) S2 steel double end bit sizes: 1-2</li><li>• 1 Pozzi S2 steel double end bit size: 1-2</li><li>• 2 Torx (Star) S2 steel double end bit sizes: 10-15, 20-25</li><li>• 1 Flat (Slot) S2 steel double end bit sizes: 4-6</li></ul>	1



All products are sold by unit except those shown with an \*. These are sold by box.



NEW!



Angle Driver for Screwdriver Bits

- Compact design allows work in tight areas
- Durable all metal housing and steel gears
- Rated up to 235 in-lb of torque
- Accepts standard 1/4" hex shank bits

NO.	QTY/BOX
ANGLEDRIVER	1



VIDEO

NEW!



Makita Interlocking Cases

- 4 Sizes Available
- Ideal for creating custom job box kits for specific applications, end users, job sites and more!
- Length: 15.6"
- Width: 11.6"
- Plastic

NO.	HEIGHT	QTY/BOX
MKT1972109	4 1/8"	1
MKT1972117	6 3/16"	1
MKT1972125	8 5/16"	1
MKT1972133	12 3/8"	1

NEW!

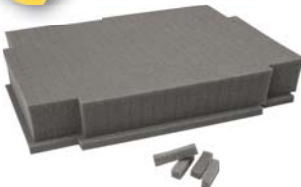

Makita Tool Case Foam Insert

- Measures 2 1/2" thick x 15 1/8" wide x 11 1/4" deep
- Features 1/2" base layer and 2" pre-scored layer
- Easily customized to unique configuration for tools, parts and accessories
- Provides a maximum protection

NO.	DESCRIPTION	QTY/BOX
MKT02571	FOAM INSERT	1

NEW!



Richelieu Tool Bag

- Tool bag with shoulder strap
- Three large compartments with 16 pockets to organize tools and accessories
- Bag has a reinforced bottom and is water resistant

NO.	DESCRIPTION	QTY/BOX
91291316	TOOL BAG	1

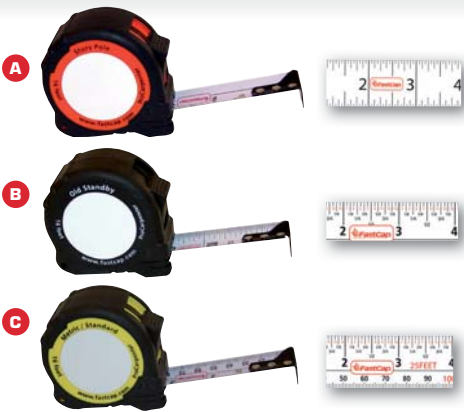

**PROCARPENTER Tape Measure**

- Erasable notepad
- Rugged compact casing
- Pencil sharpener
- Lever action belt clip
- Dual locking system
- High contrast tape
- Heavy duty 1 inch blade

	NO.	DESCRIPTION	SIZE	QTY/BOX
	916399	"STANDARD, HYPOTENUSE SQUARE ONE"	25'	1
A	916418	"STANDARD"	16'	1
	916419	"STANDARD"	25'	1
B	916412	"STORY POLE" STANDARD	16'	1
	916414	"STORY POLE" STANDARD	25'	1
	916417	"STORY POLE - LEFTY / RIGHTY" STANDARD	16'	1
	916427	"STORY POLE - LEFTY / RIGHTY" STANDARD	25'	1
	916416	"STANDARD" - AUTO-LOCK AND ERGONOMIC	16'	1
C	916413	"METRIC/STANDARD"	12'	1
	916415	"METRIC/STANDARD" RICHELIEU	16'	1
	916425	"METRIC/STANDARD" 1 IN.	25'	1
	916532	"METRIC TRUE 32 - LEFTY / RIGHTY"	5 M	1
	916411	"METRIC/STANDARD" - AUTO-LOCK	16'	1

**Richelieu Tape Measure**

NO.	DESCRIPTION	SIZE	QTY/BOX
91291634	"STANDARD" - ABS	16'	1
91292510	"STANDARD" - ABS	26'	1

**Burn One Tape Measure**

- Burn space at the beginning of the scale
- Easy to grab hook

NO.	DESCRIPTION	SIZE	QTY/BOX
916406	"STANDARD"	16'	1

**Reversible Improved Tape Measure**

Peel-and-stick tape measure.

NO.	DESCRIPTION	SIZE	QTY/BOX
917424	"STANDARD"	16'	1
917425	"METRIC/STANDARD"	16'	1

**Rigid Precision Stainless Rule**

NO.	DESCRIPTION	SIZE	QTY/BOX
91262111	"STANDARD"	6"	1
91262114	"METRIC/STANDARD"	6"	1



All products are sold by unit except those shown with an \*. These are sold by box.



No Mixing

"FAMOWOOD" Latex Wood Filler

- Easy application: this water-based latex formula wood filler requires no mixing. It spreads smoothly and evenly into small or large holes and cracks in unfinished wood
- Dries in 15 minutes
- Can be sanded, sawed, stained, nailed, painted or planed
- Indoor/outdoor use
- Non-flammable and free of solvent fumes

NO.	VOLUME	FINISH	QTY/BOX
WP40002126	1 GAL. (3.79 L.)	NATURAL	4
WP40022126	23 OZ (680 ML)	NATURAL	12
WP40042126	6 OZ (177 ML)	NATURAL	12
WP404026	3.25 OZ (96 ML)	NATURAL	12
WP22106	23 OZ (680 ML)	BIRCH	12
WP40042106	6 OZ (177 ML)	BIRCH	12
WP222110	23 OZ (680 ML)	CHERRY/DARK MAHOGANY	12
WP40042112	6 OZ (177 ML)	CHERRY/DARK MAHOGANY	12
WP40042118	6 OZ (177 ML)	FIR/MAPLE	12
WP40022118	23 OZ (680 ML)	FIR/MAPLE	12
WP40022152	23 OZ (680 ML)	GOLDEN OAK	12
WP40042152	6 OZ (177 ML)	GOLDEN OAK	12
WP40022128	23 OZ (680 ML)	OAK	12
WP40042128	6 OZ (177 ML)	OAK	12
WP22134	23 OZ (680 ML)	RED OAK	12
WP40042134	6 OZ (177 ML)	RED OAK	12
WP40042142	6 OZ (177 ML)	WALNUT	12
WP40042144	6 OZ (177 ML)	WHITE	12
WP40022144	23 OZ (680 ML)	WHITE	12
WP22148	23 OZ (680 ML)	WHITE PINE	12
WP40042148	6 OZ (177 ML)	WHITE PINE	12

"FAMOWOOD" Wood Filler Thinner

Designed to keep FAMOWOOD Original wood filler in top working condition. It will restore wood filler to its original consistency and workability.

- Outstanding UV protection
- Designed for use on hardwood floors, floor boards, boats and other high traffic surfaces
- Abrasion and scratch resistant
- Fast drying



NO.	VOLUME	QTY/BOX
WP30021	1 PT (473 ML)	12
WP30001	1 GAL. (3.79 L.)	4
WP30011	1 QT (946 ML)	12

No Mixing

"FAMOWOOD" Original Wood Filler

It spreads smoothly into cracks and holes, covers stains and paints evenly and resists cracking. Perfect for any type of custom wood project.

- Dries in 15 minutes
- Won't crack or shrink
- Can be sanded, drilled or planed
- Stainable and paintable
- Interior/exterior use



NO.	VOLUME	FINISH	QTY/BOX
WP21100	23 OZ (680 ML)	ALDER	12
WP36041100	6 OZ (177 ML)	ALDER	6
WP21102	23 OZ (680 ML)	ASH	12
WP36041102	6 OZ (177 ML)	ASH	6
WP21106	23 OZ (680 ML)	BIRCH	12
WP36041106	6 OZ (177 ML)	BIRCH	6
WP21149	23 OZ (680 ML)	CEDAR	12
WP36041149	6 OZ (177 ML)	CEDAR	6
WP21110	23 OZ (680 ML)	CHERRY	12
WP36041110	6 OZ (177 ML)	CHERRY	6
WP21116	23 OZ (680 ML)	FIR	12
WP36041119	6 OZ (177 ML)	FIR	6
WP21122	23 OZ (680 ML)	MAHOGANY	12
WP36041122	6 OZ (177 ML)	MAHOGANY	6
WP21124	23 OZ (680 ML)	MAPLE	12
WP36041124	6 OZ (177 ML)	MAPLE	6
WP21126	23 OZ (680 ML)	NATURAL TUPELO	12
WP36041126	6 OZ (177 ML)	NATURAL TUPELO	6
WP21128	23 OZ (680 ML)	OAK TEAK	12
WP36041128	6 OZ (177 ML)	OAK TEAK	6
WP21130	23 OZ (680 ML)	PINE	12
WP36041154	6 OZ (177 ML)	PINE	6
WP21134	23 OZ (680 ML)	RED OAK	12
WP36041134	6 OZ (177 ML)	RED OAK	12
WP21142	23 OZ (680 ML)	WALNUT	12
WP36041142	6 OZ (177 ML)	WALNUT	6
WP21144	23 OZ (680 ML)	WHITE	12
WP36041144	6 OZ (177 ML)	WHITE	6
WP36041152	6 OZ (177 ML)	WHITE GLAZE	6
WP21148	23 OZ (680 ML)	WHITE PINE	12
WP36041148	6 OZ (177 ML)	WHITE PINE	6

Nail Hole Filler

This complete patching system doesn't require messy putty knives. Just squeeze a small amount directly on the surface to be repaired, and it's ready to paint in 12-15 minutes. The washable, angled tip allows quick smoothing to match the texture of the wall being repaired.

NO.	VOLUME	QTY/BOX
WP311015	8.2 OZ (243 ML)	12



All products are sold by unit except those shown with an \*. These are sold by box.



Fast Drying

Background Touch-Up Markers

Fast drying opaque color markers used to replace the background color over wood filler repairs of all types.

NO.	DESCRIPTION	QTY/BOX
M2945012	12 MARKER ASSORTMENT	12



VIDEO

Touch-up Products



Instant "ULTRA MARK™" Touch-Up Markers

Contains light-fast pigments which seal, stain and finish, in one easy operation.

- Available in more than 165 colors

NO.	DESCRIPTION
M2801200	12 STANDARD ASSORTMENT
M2802401	24 STANDARD ASSORTMENT
M2803600	36 STANDARD ASSORTMENT
M2807200	72 STANDARD ASSORTMENT
M2804720	72 TREND ASSORTMENT



VIDEO



Instant "PRO-MARK™" Touch-Up Markers

Excellent flow. The colors are the most fade resistant and they have the best bleed resistance.

NO.	DESCRIPTION
M2671202	ASSORTED 12 COLORS #1
M2671204	ASSORTED 12 COLORS #2
M2671206	ASSORTED 12 COLORS #3
M2671208	ASSORTED 12 COLORS #4
M2672680	ASSORTED 24 COLORS WITH POUCH
M2673600	ASSORTED 36 COLORS



VIDEO

D40



"FIL-STIK™" Putty Sticks

Semi-hard putty sticks used to fill in nicks and scratches or open corner joints. Can be protected with Tone Finish® aerosols or other coatings. Available in more than 40 colors.

NO.	DESCRIPTION
M2301200	12 PACK ASSORTMENT
M2301210	12 PACK MAPLE/WALNUT ASSORTMENT
M2301220	12 PACK LIGHT COLOR ASSORTMENT
M2301250	12 PACK STANDARD COLOR ASSORTMENT
M2302400	24 PACK FURNITURE STORE ASSORTMENT
M2306200	62 PACK STANDARD COLOR ASSORTMENT
M2316000	60 PACK TREND COLORS ASSORTMENT
M2304720	72 NEW COLOR ASSORTMENT



VIDEO

**"BLENDAL STICKS™"**  
**Color Replacement**

Used to add or alter color when repairing and touching up wood.

NO.	DESCRIPTION	
M3401200	12 PACK ASSORTMENT	#1
M3401202	12 PACK ASSORTMENT	#2
M3401203	12 PACK ASSORTMENT	#3
M3401204	12 PACK PRIMARY & EARTH TONE ASSORTMENT	
M3403600	36 PACK ASSORTMENT	



**Hard Fill Stick Kit**

- Contains all the products and tools needed to repair minor and medium defects in wood and rigid plastics
- Recommended for repairs to floors, tops, fronts, sides, doors, drawers and wood surfaces

NO.	DESCRIPTION	QTY/BOX
M3109990	1 KIT CONTAINS 40 PCS	1



**Brush Tip Graining Markers**

This revolutionary marker and tip allows you to apply color exactly where it is needed without any messy powders, fluids, or odours. This is simply the easiest marker that you will ever use!

- Available in more than 30 colors

NO.	DESCRIPTION	
M2652201	6 PACK ASSORTMENT	#1
M2652202	6 PACK ASSORTMENT	#2
M2651203	6 PACK ASSORTMENT	#3
M2651204	6 PACK ASSORTMENT	#4



**SeamFil Kits for Plastic Laminate Repair**

Repair nicks, seams and gouges with ease. SeamFil bonds mechanically to the substrate of laminate. This product dries hard and becomes a permanent part of the laminate surface. It resists moisture, detergents and other household products as effectively as the original laminate.

NO.	DESCRIPTION
2201	SET OF 12 STANDARD COLORS
2202	SET OF 12 WOODGRAIN COLORS



Touch-up Products

D41

All products are sold by unit except those shown with an \*. These are sold by box.



Modified Tung Oil

Recognized as fast drying, hard, resistant to water, acid, alkali and mildew.

NO.	DESCRIPTION	VOLUME	QTY/BOX
M7011596	PROTECTION OIL	32 OZ (946.35 ML)	4
M7011597	PROTECTION OIL	1 GALLON (3.79 L)	2

Danish Oil

Polymerized wood finish, combines penetrating oils with resins to produce a natural oil finish on unfinished wood.

NO.	DESCRIPTION	VOLUME	QTY/BOX
M7001507	NATURAL	1 GALLON (3.79 L)	2
M7001508	NATURAL	5 GALLONS (18.93 L)	1

Protection Oil for Counters

- Suitable for food preparation surfaces and cooking utensils

NO.	DESCRIPTION	VOLUME	QTY/BOX
001512	PROTECTION OIL	15 OZ (443.6 ML)	12

Sealer Gel "EZ-DO"

- Seals and protects wood surfaces

NO.	DESCRIPTION	VOLUME	QTY/BOX
00166	"EZ-DO" SEALER GEL	16 OZ (473.18 ML)	12

"PERFECT BLEND™" Lacquer

Excellent adhesion over waxed and polished surfaces and areas contaminated with silicone.

NO.	DESCRIPTION	SHEEN	VOLUME
M1020705	DEAD FLAT	5-8 SHEEN	13.5 OZ (399.24 ML)
M1020710	FLAT	10-13 SHEEN	13.5 OZ (399.24 ML)
M1020720	MATTE	19-23 SHEEN	13.5 OZ (399.24 ML)
M1020740	SATIN	35-40 SHEEN	13.5 OZ (399.24 ML)
M1020760	SEMI-GLOSS	55-65 SHEEN	13.5 OZ (399.24 ML)
M1020780	GLOSS	80 SHEEN	13.5 OZ (399.24 ML)



A - Value Masking Tape 101

For indoor light-duty applications.

- Ideal for marking, temporary holding, wrapping and sealing
- Roll of 180 ft (55 m)

NO.	WIDTH	QTY/BOX
481011255	1/2 "	72
481011855	3/4 "	48
481012455	1 "	36
481013655	1 1/2 "	24
481014855	2 "	24
481017255	3 "	12
481019655	4 "	8

B - General Use Masking Tape 201

For light and medium-duty applications.

- Ideal for bundling, labeling and identifying
- Sticks to a wide variety of surfaces
- Roll of 180 ft (55 m)

NO.	WIDTH	QTY/BOX
482011255	1/2 "	72
482011855	3/4 "	48
482012455	1 "	36
482013655	1 1/2 "	24
482014855	2 "	24
482017255	3 "	12
482019655	4 "	8

C - Superior Painter's Grade Masking Tape - 2090

This tape removes cleanly without adhesive transfer or surface damage, even in direct sunlight. It is a medium-adhesion tape with up to 14-day removability, making it ideal for painted walls and trim, woodwork, glass, and metal.

- Roll of 180 ft (55 m)

NO.	WIDTH	QTY/BOX
48209018	3/4 "	48
48209024	1 "	36
48209036	1 1/2 "	24
48209048	2 "	24

D - Industrial Performance Masking Tape 301

- An industrial-strength performance masking tape used for paint masking, bundling, holding, and identifying applications
- Solvent-free adhesive sticks with confidence to most surfaces including metal, rubber, glass, and plastic while removing cleanly in one piece
- Roll of 180 ft (55 m)

NO.	WIDTH	QTY/BOX
483011255	1/2 "	72
483011855	3/4 "	48
483012455	1 "	36
483013655	1 1/2 "	24
483014855	2 "	24
483017255	3 "	12
483019655	4 "	8

E - Painter's Grade Masking Tape 401

- High-strength green crepe-paper backing
- Bleed-through resistant from most industrial paint systems
- Creates super-sharp paint lines
- Roll of 180 ft (55 m)

NO.	WIDTH	QTY/BOX
484011255	1/2 "	48
484011855	3/4 "	48
484012455	1 "	24
484013655	1 1/2 "	16
484014855	2 "	12
484017255	3 "	8
484019655	4 "	8

F - High-Temperature Masking Tape 501

- Offers the highest degree of industrial performance
- Ideal for all high temperature paint baking, fascia painting and pipe coating applications
- Roll of 180 ft (55 m)

NO.	WIDTH	QTY/BOX
485011855	3/4 "	48
485012455	1 "	36
485013655	1 1/2 "	24
485014855	2 "	24
485017255	3 "	12

All products are sold by unit except those shown with an \*. These are sold by box.



**Glue Brushes**

Made of pure white silk bristles for glue and general uses.

NO.	DIMENSIONS	QTY/BOX
4016405	1/2" (12.7 MM)	24
4016411	1" (25.4 MM)	24*
4016412	2" (50.8 MM)	24
4016413	3" (76.2 MM)	12*
4016414	4" (10.16 CM)	12

**Straight Scrapers**

- Flexible, stainless steel blade

NO.	DIMENSIONS	QTY/BOX
4042171	1 1/4" (31.75 MM)	12
4042172	2" (50.8 MM)	12
4042173	3" (76.2 MM)	12



2221000



2220030

**Recycled Cotton Rags**

These affordable wipers are an excellent choice for general projects. This product is extremely appreciated by furniture manufacturers (staining) and painters.

- Sizes: Min. of 16" x 16" (406 mm x 406 mm)

NO.	COLOR	QTY/BOX
2221030	WHITE	1 BAG (20 LB)
2221000	VARIOUS COLORS	1 BAG (20 LB)

**Jersey Rags - New & Washed**

- Seamless and lint free
- Ideal for applying and removing stain
- Size: 18" x 18" (457 x 457 mm)

NO.	COLOR	QTY/BOX
2220030	WHITE	1 BAG (20 LB)



M9951102

**Protection Blankets**

- Zigzag stitch pattern of 1", double stitched border
- Lighter weight pad provides good protection for furniture in transit
- Size: 80" x 72"

NO.	DESCRIPTION	QTY/BOX
M9951104	PROMOVER, BLUE	PER UNIT (7 LB)
M9951102	PREMIUM, GREEN	PER UNIT (5.20 LB)
M9951107	HEAVY-DUTY, BLACK	PER UNIT (7.51 LB)

**Richelieu Measuring Cup**

Measure accurately and consistently with metric and imperial scales.

NO.	DESCRIPTION	QTY/BOX
9632	CAPACITY: 32 OZ (946 ML)	100
9633	COVER FOR 9632	100
9680	CAPACITY: 80 OZ (2.37 L)	100
9681	COVER FOR 9680	100

### 3M™ ACCUSPRAY™ Gun System with PPS

All inclusive spraying solution providing the equivalent of multiple brand new spray guns on demand, for a fraction of the cost. The innovative Accuspray replaceable atomizing head spray gun eliminates spray gun maintenance kits and the replaceable transparent atomizing heads allow the user to visually confirm the spray gun is clean.

**Kit contains:**

- 1 each Accuspray™ ONE Spray Gun with color indicator rings
- 4 Accuspray™ atomizing heads in sizes 1.4mm and 1.8mm
- 1 airflow control valve
- 5 each liners and lids (1 each w/125 micron filter, 4 each w/200 micron filter)
- 1 each standard size 22oz PPS™ hard cup and retaining ring
- 1 mixing/measuring insert
- Instruction manual



NO.	DESCRIPTION	QTY/BOX
AC16580	COMPLETE KIT	1

### 3M™ ACCUSPRAY PPS™ High Output Mini Pressure Cup

Use this PPS H/O Pressure Cup in place of gun-mounted - or detached - 1 and 2 quart pressure pots. The PPS (Paint Preparation System) uses a rigid cup and collar which hold a disposable liner and a lid with an integral strainer.

- Designed for gravity feed or traditional siphon spray gun systems
- Eliminates the need for separate mixing cups and filters
- Offers up to 70% reduction in solvent use for gun and parts cleaning
- Reduced hazardous waste generated by equipment cleaning
- Virtually any spray gun can be adapted to the PPS paint cup system

NO.	DESCRIPTION	VOLUME	QTY/BOX
3116121	HIGH OUTPUT MINI PRESSURE CUP	6 OZ (177 ML)	4



### 3M™ ACCUSPRAY PPS™ High Output Pressure Cup and Collar

This product is intended for use in place of metal cups on most pressure cup guns. Cleaner, faster spray painting system that is safe from outside contamination.

- Leftover paint can be stored for later use without any need to remix
- Range of cup and liners sizes that enables the painter to mix only the desired amount of paint required for a particular job
- Paint gun can spray at any angle, including upside down
- Internal vacuum within the liner allows the container to collapse around the paint, so there is always paint pressure on the nozzle

NO.	DESCRIPTION	VOLUME	QTY/BOX
3116124	HIGH OUTPUT STANDARD PRESSURE CUP	29 OZ (858 ML)	1



All products are sold by unit except those shown with an \*. These are sold by box.

NEW!

**3M™ ACCUSPRAY PPS™ Kit**

Kit contains 50 lids with 200 micron filters, 50 liners, and 20 sealing plugs.

- Closed system - no outside contamination
- Faster system - from mixing to disposal
- Less operator exposure to solvents and reduction in VOC's
- Spray gun functions at any angle

NO.	DESCRIPTION	VOLUME	QTY/BOX
<b>3116000</b>	MINI	6 OZ (177 ML)	50
<b>3116114</b>	STANDARD	22 OZ (651 ML)	50
<b>3116024</b>	LARGE	28 OZ (840 ML)	50

NEW!

**3M™ ACCUSPRAY PPS™ Cup & Collar**

Hard cup that supports and holds the 3M PPS Flexible Liner.

NO.	DESCRIPTION	VOLUME	QTY/BOX
<b>3116115</b>	MINI	6 OZ (177 ML)	2
<b>3116001</b>	STANDARD	22 OZ (651 ML)	2
<b>3116023</b>	LARGE	28 OZ (850 ML)	2

NEW!

**3M™ ACCUSPRAY PPS™ Midi Kit**

Midi kit contains 50 lids with 200 micron filters, 50 liners and 20 sealing plugs.

NO.	DESCRIPTION	VOLUME	QTY/BOX
<b>3116112</b>	MIDI	13.5 OZ (399 ML)	50

NEW!

**3M™ ACCUSPRAY PPS™ Midi Cup and Collar**

Midi 400 ml or 13.5 oz size, hard cup that supports and holds the PPS Midi flexible line.

NO.	DESCRIPTION	VOLUME	QTY/BOX
<b>3116122</b>	MIDI	13.5 OZ (399 ML)	4

E46

**3M™ ACCUSPRAY™ Atomizing Head**

Replaceable atomizing heads for use with the 3M™ Accuspray™ Spray Gun.

- Reduces primer consumption
- Minimizes overspray
- Boosts productivity
- Reduces gun cleaning time

NO.	DESCRIPTION	SIZE	QTY/BOX
<b>AC16612</b>	FOR USE WITH 3M SPRAY GUN HG14	1.4 MM	4
<b>AC16611</b>	FOR USE WITH 3M SPRAY GUN HG09	1.8 MM	4
<b>3116609</b>	FOR USE WITH 3M SPRAY GUN HGP20	2.0 MM	4



NEW!

Pocket Dust Mask

Perfect for general purpose non-toxic applications where dust and particles are present.

- Easy breath valve
- NIOSH N95 rated

NO.	DESCRIPTION	QTY/BOX
916451	POCKET DUST MASK	10

With valve



Lightweight

Dust Mask - N95 8511

The 3M™ Particulate Respirator 8511 is ideally suited for work settings that involve heat, humidity or long periods of wear.

- NIOSH approved N95

NO.	DESCRIPTION	COLOR	QTY/BOX
9608511	DUST MASK	WHITE	10

3M



Dust Mask - N95 9211 for Maintenance

At least 95% filtration efficiency against solid and liquid aerosols that do not contain oil.

- NIOSH approved N95

NO.	DESCRIPTION	COLOR	QTY/BOX
9609211	DUST MASK	WHITE	10



Dust Mask - N95 8210

For protection against certain non-oil based particles.

- NIOSH approved N95

NO.	DESCRIPTION	COLOR	QTY/BOX
9608210	DUST MASK	WHITE	20



Economical Dust Respirator N95 8200

- Patented filter with advanced electrostatically charged microfibers help make breathing easier for enhanced user comfort
- Adjustable nose clip reduces eyewear fogging and helps ensure a better seal and fit
- NIOSH approved N95

NO.	DESCRIPTION	COLOR	QTY/BOX
9609221	DUST MASK	WHITE	20

NEW!



F47

Dust Masks

All products are sold by unit except those shown with an \*. These are sold by box.

3M

**Half-Face Respirator Series 6000**

With his low profile, this respirator provides a greater sight and allows to wear safety glasses. Recognized by NIOSH/MSHA for both sizes.

- The most lightweight and adjustable respirator offered on the market

NO.	DESCRIPTION	DIMENSION	QTY/BOX
9606200	HALF-FACE RESPIRATOR	MEDIUM	24
9606370	FULL KIT	MEDIUM	4
9606300	HALF-FACE RESPIRATOR	LARGE	24
9606371	FULL KIT	LARGE	4

**Half-Face Siliconed Respirator Series 7500**

This half-face reusable respirator, 7500 Series, uses advanced silicone material to help provide comfortable and durable respiratory protection. The Cool Flow Valve helps make breathing easier and reduces heat and moisture build-up for cool, dry comfort.

NO.	DESCRIPTION	SIZE	QTY/BOX
9607502	HALF-FACE RESPIRATOR	MEDIUM	10
9607503	HALF-FACE RESPIRATOR	LARGE	10

**Replacement Cartridge for 6000 & 7500 Series**

Protects against some organic vapors from spray painting and pesticide spraying

NO.	DESCRIPTION	QTY/BOX
9606001	FOR MASKS 9606200 AND 9606300	10 PAIRS
9609224	PARTICULATE FILTER 2071 FOR 6000 & 7500 SERIES	50 PAIRS
9605171	FILTER RETAINER FOR 6000 & 7500 SERIES	20
9605071	PRE-FILTER REPLACEMENT FOR 6000 & 7500 SERIES	10

"Phantom OTG" Safety Goggles

- This "OTG" style can be use over top of prescription glasses.
- Indirect ventilation providing maximum protection against chemical splashes
  - Large comfortable soft frame
  - Wide one piece lens
  - Anti-Fog protection
  - The lenses are protected with anti-fog, anti-scratch, anti-UV, anti-static coatings
  - CSA Z94.3-7 certified and meets and/or exceeds ANSI Z87.1 requirements

NO.	COLOR	QTY/BOX
DNEPMK01C	CLEAR	1



"Ultra-Tek" Safety Goggles, OTG

- This "OTG" style can be use over top of prescription glasses.
- Soft, lightweight PVC frame
  - 4 cap vents provide indirect ventilation
  - Neoprene strap for better resistance to solvents and chemicals
  - Maximum panoramic and peripheral field of vision
  - The lenses are protected with anti-fog, anti-scratch, anti-UV, anti-static coatings
  - CSA Z94.3-7 certified and meets and/or exceeds ANSI Z87.1 requirements

NO.	COLOR	QTY/BOX
DNEP40	GREEN	1



Fusion Safety Glasses Maximum Comfort

- "Flexi-Fit" Adjustable soft nose piece for increased comfort
- "EZ-ON" temples redistributes the pressure on your temples evenly
- Good for humid environments
- Large 9° base curved double lens design molded in one piece
- Offers full protection coverage and extra wide viewing field
- High impact resistant polycarbonate lens
- The lenses are protected with anti-fog, anti-scratch, anti-UV, anti-static coatings
- CSA Z94.3-7 certified and meets and/or exceeds ANSI Z87.1 requirements

NO.	COLOR	QTY/BOX
DNEP650C	BLACK	10



Renegade Reader's Diopter Safety Glasses, Adjustable Temple Arms

- "Flexi-Fit" Adjustable soft nose piece for increased comfort
- Stylish European design
- 8.50 base curve dual lens design for wrap-around coverage
- Adjustable temple arms length
- The lenses are protected with anti-scratch, anti-UV, anti-static coatings
- CSA Z94.3-7 certified and meets and/or exceeds ANSI Z87.1 requirements

NO.	DIOPTER	COLOR	QTY/BOX
DNEP400TGC15	+1.5 DIOPTER	TRANSLUCENT GRAY	12
DNEP400TGC20	+2.0 DIOPTER	TRANSLUCENT GRAY	12
DNEP400TGC25	+2.5 DIOPTER	TRANSLUCENT GRAY	12



F49

All products are sold by unit except those shown with an \*. These are sold by box.

**NEW!**

**Fits over  
prescription  
glasses**



### "OTG Extra" Safety Glasses, "EZ-ON" System

This "OTG" style can be use over top of prescription glasses.

- "Flexi-Fit" Adjustable soft nose piece for increased comfort
- "EZ-ON" temples redistributes the pressure on your temples evenly
- Adjustable branches giving you the possibility to adjust the lens up and down for better vision
- The lenses are protected with anti-fog, anti-scratch, anti-UV, anti-static coatings
- CSA Z94.3-7 certified and meets and/or exceeds ANSI Z87.1 requirements

NO.	COLOR	QTY/BOX
<b>DNEP750C</b>	BLACK	10

**NEW!**



### "Mini Specta" 3 in 1 Safety Goggles

For light and medium duty performance.

- Fast and easy interchangeable temple arms/strap included with each pair
- Easily removable foam padding forms a seal to keep dust and air born particles out
- The lenses are protected with anti-fog, anti-scratch, anti-UV, anti-static coatings
- CSA Z94.3-7 certified and meets and/or exceeds ANSI Z87.1 requirements

NO.	COLOR	QTY/BOX
<b>DNEP950C</b>	BLACK	10

**3M**

**NEW!**



### "OX" Clear Anti-Fog Safety Glasses

To be worn over prescription glasses.

- Lightweight and adjustable
- Sturdy and durable
- Wraparound sideshields
- Flexible, polycarbonate construction

NO.	COLOR	QTY/BOX
<b>96012166</b>	BLACK	20

**F50**



### "VIRTUA" Anti-Fog Safety Glasses

- Sporty, sleek unisex styling
- 9 base curve lens
- Comfortable, ultra light frame
- High impact polycarbonate filters 99.9% UV
- Meets ANSI Z87.1-2003 and CSA Z94.1 standards

NO.	DESCRIPTION	QTY/BOX
<b>9609231</b>	VIRTUA AP, CLEAR	20

3M

"BX" Anti-Fog Safety Glasses

- All the comfort for a very comfortable price
- Fully adjustable and high style
- Meets ANSI Z87.1-2003 and CSA Z94.3 standards
- Clear anti-fog lenses
- Adjustable length temple
- Lens angle adjustability
- Adjustable nose bridge

NO.	COLOR	QTY/BOX
9609232	SILVER	20



CatEyes Safety Glasses

These safety glasses are ultra comfortable, super affordable and great looking.

- Shatterproof and scratch resistant
- Reinforced temples
- ANSI Rated: Z87.1

NO.	DIOPTER	QTY/BOX
916846	+1.5 DIOPTER	12
916847	+2.0 DIOPTER	12
916848	+2.5 DIOPTER	12
916849	+3.0 DIOPTER	12



CatEyes Anti-Fog Safety Goggles

- Dust tight goggles
- Adjustable-length arms
- Shatterproof wraparound lenses
- Reinforced temples
- Quality construction
- ANSI Z87.1 rated

NO.	COLOR	QTY/BOX
916851	BLACK	12



NEW!

CatEyes Anti-Fog Safety Glasses

- Adjustable temple arms and ultra-comfortable
- Shatterproof wraparound lenses
- Anti-fog and anti-static coated lenses
- UV Protection - UVB 95% UVA 60%
- Scratch resistant lenses
- ANSI (Z87.1 rated) and OSHA approved

NO.	LENS COLOR	QTY/BOX
916843	AMBER	12
916845	BLACK-TINTED	12
918848	BLUE	12
916844	CLEAR	12
918849	RED	12



NEW!

F51

Eye Protection

All products are sold by unit except those shown with an \*. These are sold by box.





**NEW!**



**NEW!**



#### Protection Hard Hats

Hard hat features accessory slots for earmuff attachment and/or headgear and face shield attachment.

- Comfortable 4-point ratchet suspension system with height adjustment
- Low-profile, short brim design for balance, stability and upward visibility
- Replaceable brow pad
- Meets the requirements of ANSI/ISEA Z89.1-2009 Type I, Class C, G & E

NO.	DESCRIPTION	QTY/BOX
9609233	WHITE	20
9609234	YELLOW	20

#### Headgear with Face Shield

High-strength thermoplastic crown protector provides impact resistance even at very high temperatures.

- Complete headgear and face shield
- Easy-change shield
- Flat or molded style
- Meets ANSI Z-87.1 standards

NO.	DESCRIPTION	QTY/BOX
9609222	BLUE	5
9609223	REPLACEMENT FACE SHIELD - CLEAR	10

#### Banded Ear Protection "Lite-Band"

This light-weight (just 8 g) banded ear protector is ideal for short term use, such as people moving in and out of noisy areas or for visitors.

- Meets ANSI S3.19-1974 regulation
- Innovative and unique, soft, oval shape foam earplug guarantee of the most comfortable fit
- The band is ergonomically shaped and its stability limits contact with clothing and resulting sound transmission
- The lightest banded ear protector available in the market

NO.	DESCRIPTION	COLOR	QTY/BOX
DNNP105	BANDED EAR PROTECTION	BLACK/GREEN	10

#### "CLASSIC" Earplugs

- Slow-recovery foam helps ensure comfort and minimize pressure
- Moisture resistant, helps reduce moving and shifting problems when used in moist environments
- ANSI S3.19-1974; CSA Class AL
- NRR : 29dB

NO.	DESCRIPTION	QTY/BOX
9609217	FOAM EARPLUGS	200 PAIRS

#### "E-A-Rsoft" Earplugs

3M E-A-Rsoft Yellow Neons earplugs seal the ear canal with soft, slow-recovery foam for excellent noise reduction and comfort.

- These foam earplugs offer a soft, low-pressure solution for comfortable wear
- Poly bag keeps earplugs clean before use
- Highest NRR available
- Ultimate comfort
- NRR 33 dB / CSA Class AL

NO.	DESCRIPTION	QTY/BOX
9609226	FOAM EARPLUGS	200 PAIRS

\*Noise Reduction Rating

"E-A-Rsoft FX" Earplugs

- Patented bell shape and super-soft foam inserts more easily and seals more effectively to provide the highest NRR available in the industry
- Custom polyurethane foam formulation provides slow recovery and extreme softness for optimum comfort
- Best NRR: 33dB

NO.	DESCRIPTION	QTY/BOX
9609218	FOAM EARPLUGS (CORDLESS)	200 PAIRS



"Ultra-Fit" Earplugs

- These durable, reusable corded earplugs are easy to use again and again, reducing waste
- Poly bag keeps earplugs clean before use
- Single size fits comfortably in most ear canals
- Premolded, triple-flange earplug design inserts easily
- No rolling or sizing needed to get a comfortable, protective fit
- Washable and reusable
- Noise Reduction Rating (NRR)\* : 25dB. CSA Class AL

NO.	DESCRIPTION	QTY/BOX
9609227	"ULTRA-FIT" CORDED EARPLUGS	100 PAIRS

Reusable



"Optime 98" Earmuffs

- For noise levels up to 98dBA, delivers effective protection for mid-range environments comfortably
- Dual low-pressure bands improve comfort
- Broad foam cushions provide low surface pressure
- NRR 25dB
- ANSI S3.19-1974/CSA Z94.2

NO.	DESCRIPTION	QTY/BOX
9609219	GENERAL PURPOSE EARMUFFS	10



"Optime 101" Earmuffs (helmet mount)

- For noise levels up to 101 dBA, these cap-mount earmuffs provide effective hearing protection
- Cap-mounted design allows for easy use with most hard hats
- Liquid/foam filled ear cushions
- Color-coding for compliance sighting
- Noise Reduction Rating (NRR)\* : 24 dB. CSA Class A

NO.	DESCRIPTION	QTY/BOX
9609229	HELMET MOUNT EARMUFFS	10



Earmuff Replacement Hygiene Kit

Extend the life of your earmuffs with 1 pair of replacement cushions and 1 pair of dampers.

NO.	DESCRIPTION	QTY/BOX
9609220	REPLACEMENT KIT FOR 9609219	20
9609230	REPLACEMENT KIT FOR 9609229	20



\*Noise Reduction Rating

All products are sold by unit except those shown with an \*. These are sold by box.



### Disposable Gloves- Detailed Light Work

- For very detailed light work, providing better dexterity
- 4 mil
- Powder-free

NO.	SIZE	COLOR	QTY/BOX
<b>D70057</b>	SMALL	BLUE	100
<b>D70058</b>	MEDIUM	BLUE	100
<b>D70059</b>	LARGE	BLUE	100
<b>D700510</b>	X-LARGE	BLUE	100



### Disposable Gloves - Detailed & Dexterity Work

- For very detailed light work, providing better dexterity
- Powder-Free
- 8 mil

NO.	SIZE	COLOR	QTY/BOX
<b>D80058</b>	MEDIUM	BLUE	50
<b>D80059</b>	LARGE	BLUE	50
<b>D800510</b>	EXTRA-LARGE	BLUE	50



### Disposable Gloves - Ultra-Light Work

- Ultra-light maintenance work that only requires minimum protection
- Lightly powdered
- 5 mil

NO.	SIZE	COLOR	QTY/BOX
<b>D20059</b>	LARGE	NATURAL	100
<b>D200510</b>	EXTRA-LARGE	NATURAL	100



### Reusable Gloves - NITRI-FLEX LITE

- Used in general work
- Nylon knit glove, reusable, the most flexible on the market
- Excellent resistance to cuts, scratches and wear

NO.	SIZE	COLOR	QTY/BOX
<b>D45009</b>	LARGE	GREEN	12 PAIRS



### Insulated Atlas ThermaFit Gloves

A seamless, warm fleece-lined shell combines warmth, lightness, and flexibility perfect for cold weather environments. Unrivalled in both dry and wet conditions, they are the ideal gloves for cold weather or when superior protection from punctures is required.

NO.	SIZE	COLOR	QTY/BOX
<b>D4519</b>	LARGE	GRAY	1 PAIR

Knit Picker Gloves

Fully-coated PVC with seamless knit cotton liner. For general use.

NO.	SIZE	COLOR	QTY/BOX
D9619	LARGE	YELLOW	12 PAIRS
D96110	EXTRA-LARGE	YELLOW	12 PAIRS



Chemical Resistant Gloves

For work requiring solvent handling.  
• 15 mil

NO.	SIZE	COLOR	QTY/BOX
D7308	MEDIUM	GREEN	12 PAIRS*
D7309	LARGE	GREEN	12 PAIRS*
D73010	EXTRA-LARGE	GREEN	12 PAIRS*



Seamless Rubber-Coated Palm Gloves

General purpose for handling wood, glass, metal, or melamine panels.

NO.	SIZE	COLOR	QTY/BOX
D3107	SMALL	GREEN	6 PAIRS*
D3108	MEDIUM	GREEN	6 PAIRS*
D3109	LARGE	GREEN	6 PAIRS*
D31010	EXTRA-LARGE	GREEN	6 PAIRS*



Heavy-Duty "Skin" Gloves

Snag, puncture and abrasion resistant. Superior grip in dusty and oily applications. Machine washable and quick to dry.

NO.	SIZE	COLOR	QTY/BOX
918413	SMALL	GRAY	1 PAIR
918408	MEDIUM	GRAY	1 PAIR
918407	LARGE	GRAY	1 PAIR
918406	X-LARGE	GRAY	1 PAIR



Self-Healing Ballistic Apron

- Rugged ballistic nylon
- Long, fully adjustable straps
- Rivets at critical wear points
- Self-healing pockets
- Custom pockets for earplugs

NO.	COLOR	QTY/BOX
918861	GREEN	60
918846	BLACK	60



# 3M



### Coverall Protection

- Basic protection against light splashes and hazardous dusts
- Elastic hood, waist, ankles and wrists for convenient safe wear and movement
- Two-way zipper with storm flap for extra convenience and protection from contaminants
- Anti-static coating on the inner and outer surfaces for increased protection in critical areas
- 5/6 Type (protects against hazardous dusts (Type 5) and certain light liquid splashes (Type 6). CE approved under PPE Directive (89/686/ECC), Category III.

### Entry Level 4510

- Made of quality-laminated micro porous polypropylene
- Low-linting

NO.	SIZE	QTY/BOX
9609241	LARGE	20
9609242	X-LARGE	20
9609243	2X-LARGE	20



### High Performance 4540

- Made of quality non-woven laminated microporous polypropylene material for reduced heat stress and comfortable wear
- Protection against nuclear particles
- Knit cuffs
- Three-piece elastic hood for improved fit
- Reinforced gusset for increased robustness
- Breathable back panel for improved air circulation and reduced heat stress

NO.	SIZE	QTY/BOX
9609251	LARGE	20
9609252	X-LARGE	20
9609253	2X-LARGE	20
9609254	3X-LARGE	20

# Work Support

## SECTION C

### Richelieu Lateral Part Cart

- A flexible, heavy-duty, lumber delivery system

NO.	LOAD CAPACITY	QTY/BOX
9129010	2 000 LB (907 KG)	1

### Wood Dolly

- 16" x 24" • 3" casters

NO.	LOAD CAPACITY	QTY/BOX
91294304	661 LB (300 KG)	1

### Stacking Dolly

- 3" x 1 1/4" hard rubber casters

NO.	LOAD CAPACITY	QTY/BOX
91294305	1 000 LB (453.5 KG)	1

### Richelieu Drying Rack

- 50 shelves, 25 on each side
- Heavy-duty 5" casters with a break

NO.	CAPACITY/SHELVE	QTY/BOX
9129450	20 LB (9.07 KG)	1

### Richelieu Drying Rack 2.0

Innovative solution. For all your trim and door drying needs. Can be customized to fit any length or thickness

- 4 rugged 5" wheels (2 with brakes)
- 2 7/8" spacing between the horizontal rods
- Overall height: 65"
- Base: 37" x 26"
- All-metal construction
- Electrostatic paint finish

NO.	CAPACITY/SHELVE	QTY/BOX
9129451	20 LB (9.07 KG)	1

### Richelieu Woodrack Storage System

Provides generous storage capacity for timber, pipes and other long items. For internal or external mounting applications in workshops, garages, sheds, on fences and walls, etc.

- 6 storage levels
- Easy installation
- 2 brackets per box

NO.	LOAD CAPACITY	QTY/BOX
9129009	110 LB (50 KG) OF MATERIAL PER LEVEL	1

### Handling Trolley

- Superior stability
- Easy handling
- Light and durable

NO.	LOAD CAPACITY	QTY/BOX
ROLLER	1000 LB (453.5 KG)	1



VIDEO

### Speed Skate

It easily supports 4' x 8' sheets of material up to 1 3/4" wide.

NO.	LOAD CAPACITY	QTY/BOX
919107	500 LB (226.8 KG)	1



NEW!



NEW!

Work Support Accessories

657

All products are sold by unit except those shown with an \*. These are sold by box.

**NEW!**



### Clip Panel Roller

The Clip Panel Roller clips to any sheet of material of up to 1 1/4" wide allowing to move up to 500 lb in tight and narrow spaces with ease.

NO.	LOAD CAPACITY	QTY/BOX
919117	WITH CLIPS	1



**NEW!**



### POWR-GRIP Vacuum Cup with Metal Handle

- Durable metal handle
- Fast attachment on smooth, nonporous flat surfaces
- Red-line indicator warns user of any vacuum loss
- Check valve allows repumping without loss of remaining vacuum
- Release valve lever permits quick and complete release
- Eligible for Power-Grip Exchange Program

NO.	Ø	LOAD CAPACITY	QTY/BOX
914791500	8"	150 LB (68 KG)	1
914791700	9"	125 LB (57 KG)	1

**NEW!**



### POWR-GRIP Vacuum Cup with ABS Handle

- Lightweight, heavy-duty ABS handle
- Fast attachment on smooth, nonporous flat surfaces
- Red-line indicator warns user of any vacuum loss
- Check valve allows repumping without loss of remaining vacuum
- Release valve lever permits quick and complete release
- Easily replaceable handle / release valve and plunger

NO.	Ø	LOAD CAPACITY	QTY/BOX
914791400	8"	125 LB (57 KG)	1



### HOD Handle on Demand

Stop straining your back trying to lift heavy stuff!

NO.	LOAD CAPACITY	DESCRIPTION	QTY/BOX
918827	200 LB (90.72 KG)	DOUBLE	1
918828	100 LB (45.36 KG)	SINGLE	1

**NEW!**



### Concave Vacuum Cup with Vertical Handle

- Lift tabs on vacuum pad edges permit instant release

NO.	Ø	LOAD CAPACITY	QTY/BOX
914791380	6"	66 LB (30 KG)	1



### LegUp™ Table Saw Panel-Lifting Accessory

Mounts quickly and easily to the edge of your table saw or to the fence rail.

NO.	QTY/BOX
911099281	1



**VIDEO**

## "3RD HAND" and "LITTLE HAND" Levelers

These innovative products remove all the hassle of supporting cabinets during the installation.

- Capacity: 150 lb (68 kg)

NO.	DESCRIPTION	EXTENSION	QTY/BOX
913550	"3RD HAND" LEVELER	5" TO 12"	1
918927*	"3RD HAND" LEVELER SYSTEM	5" TO 12"	1
913515	"LITTLE HAND" LEVELER	16.5" TO 22.8"	1
918926**	"UPPER HAND" LEVELER SYSTEM	28" TO 60"	1
913513***	3RD HAND "LITTLE HAND" XL	23.5" TO 38"	1

\* Includes (2) 3RD Hands, (4) 6"x 6" Universal Feet, Ballistic nylon carrying bag.

\*\* Includes (2) Upper Hands, (4) 6"x 6" Universal Feet, Ballistic nylon carrying bag.

\*\*\*Includes (2) Litte Hands, (4) 6"x 6" Oversized Feet, Ballistic nylon carrying bag.



## Puck Light Jig - MAJIG Light

Quickly and accurately install LED puck lights in 5/8" and 3/4" panels. Includes 3/8" bit allows for wires and connectors to route through panels for hidden installation and seamless appearance.

NO.	DESCRIPTION	QTY/BOX
9125RICKSJIG	PUCK LIGHT INSTALLATION	1
9125TPGFA68	ADDITIONAL 2 5/8" BIT	1

## Precision Jig Systems

Includes:

- 1 T-square with center bushing
- 1 top stop
- 2 sliding guides
- Standard 5 mm drill bit

NO.	DESCRIPTION	QTY/BOX
9125TP1934	FOR HANDLES & KNOBS: 1 END STOP	1
9125TP1935	BASIC WITH LINE BORING EXTENSIONS: 2 END STOPS, 2 EXTENSION BARS	1

## Laminate Rollers

- Ideal for edges and small surfaces

NO.	DESCRIPTION	LENGTH	WIDTH	QTY/BOX
00031	ROLLER - GENERAL USE	12"	3"	1
00032	ROLLER - "J" CURVED	15"	3"	1
00033	ROLLER - ADJUSTABLE HANDLE	18" TO 27"	7 1/4"	1
00034	SEAM ROLLER	9"	2"	1

## Replacement Roller for Laminate Roller

Includes: • 1 roller • 2 clips

NO.	DESCRIPTION	WIDTH	QTY/BOX
00036	FOR GENERAL USE AND "J" CURVED ROLLERS	3"	1

All products are sold by unit except those shown with an \*. These are sold by box.

NEW!



VIDEO



VIDEO





Thingamejig Scribing Tool

Scribes laminates, painted items, stone, soft metals, timber, veneers and much more.

Includes:

- Foot pad cover
- 3 Trimming blades
- 1 Wrench
- 1 Plastic box

NO.	DESCRIPTION	QTY/BOX
9110001	IMPERIAL/METRIC	1



VIDEO

NEW!



Moisture Meter

Designed to accurately measure moisture content in wood, concrete, drywall, subflooring and other construction materials.

Includes:

- 9V battery

NO.	DESCRIPTION	QTY/BOX
91261447	MOISTURE METER	1

Mini Digital Height Gauge with Fractions

- Precise measurements
- Easy to read display

NO.	DESCRIPTION	QTY/BOX
91480025	DIGITAL HEIGHT GAUGE	1

NEW!



Digital Height Gauge with Fractions

- Precise measurements
- Easy to use
- Easy to read display

NO.	DESCRIPTION	QTY/BOX
91480200	DIGITAL HEIGHT GAUGE	1

NEW!



Digital Angle Gauge

Easy to Use:

- Super strong magnets securely attach the digital angle gauge to saw blades
- Press the ZERO button to calibrate the angle gauge to any reference surface

NO.	DESCRIPTION	QTY/BOX
91480302	DIGITAL ANGLE GAUGE	1

NEW!



8-Inch Digital Protractor

- Measure work-piece or construction angles
- Use for marking and layout
- 2" wide x 7/8" thick x 9" long

NO.	DESCRIPTION	QTY/BOX
91480410	DIGITAL PROTRACTOR	1

Stainless Steel Digital Caliper with Fractions

Precise Measurements : the large easy to read display reads in inches with fractions or millimeters.

NO.	DESCRIPTION	QTY/BOX
91480100	6" (150 MM) MEASURING LENGTH	1

Digital Sliding T-Bevel

- Large digital angle read-out

NO.	DESCRIPTION	QTY/BOX
91268280	8" (203 MM) STAINLESS STEEL BLADE	1

Thread Template

Includes:

- Screw length and diameter checker



NO.	DESCRIPTION	QTY/BOX
RKTHREADCHECKER	THREAD CHECKER BOARD: IMPERIAL (SAE)/METRIC, MALE & FEMALE	1

Caulking Guns

Super Powerful

NO.	DESCRIPTION	VOLUME	QTY/BOX
91343402	HIGH VISCOSITY	310 ML	1

Cradle Barrel

Adjustable screw to cut thrust gaps.

NO.	DESCRIPTION	VOLUME	QTY/BOX
91346829	MEDIUM VISCOSITY	310 ML	1
91343405	HIGH VISCOSITY	856 ML	1

Skeleton Steel

Drip free device.

NO.	DESCRIPTION	VOLUME	QTY/BOX
91340496	THIN VISCOSITY	310 ML	1

Aluminum Tube

Includes:

- 1 nozzle
- 1 piston

NO.	DESCRIPTION	VOLUME	QTY/BOX
91340250	HIGH VISCOSITY	600 ML	1

Cone Plastic Nozzle

NO.	COLOR	QTY/BOX
91340503	WHITE	1



SUN-SPOT® Brand Catalytic Reactor

The energy produced can force dry or cure (within 3 minutes) any type of coating system, solvent or water-based formulation.

Includes:

- 1 catalytic reactor
- 1 Sun-Spot support
- 1 adjustable tripod stand
- 1 adjustable strap
- 1 lighting base



VIDEO

NO.	DESCRIPTION	QTY/BOX
9625100	CORDLESS, PORTABLE, LIGHT-WEIGHT, AND EASILY ADJUSTABLE	1

Air Ring for SUN-SPOT®

The air ring allows the movement of compressed air in the infrared radiation. The displacement of air is warmed by the heat emitted by the catalyst pad, making the Sun-Spot unit Bi-energetic, infrared and convectional. This improvement was mainly developed for water based products (coatings).

NO.	DESCRIPTION	QTY/BOX
9625300	AIR RING	1 PAIR

All products are sold by unit except those shown with an \*. These are sold by box.



C61

**"BLADE-COTE" Aerosol Lubricant**

BLADE-COTE contains NO SILICONE or petroleum oil. Will not stain wood or interfere with glues or finishes.  
Reduces cutting friction by reducing saw or drill motor drag by up to 25%.

NO.	VOLUME	QTY/BOX
00026	10.75 OZ	12

**"GLIDE-COTE" Aerosol Lubricant**

GLIDE-COTE contains NO SILICONE or petroleum oil. Will not stain wood or interfere with glues or finishes.  
Perfect for table saw beds, drill presses, lathes, planers, band saws, miters, panel saws and all hand tools.

NO.	VOLUME	QTY/BOX
00027	10.75 OZ	12

**Bearing Lubricant**

- Extends bearing life by 3 times
- Will unfreeze frozen bearings
- Ideal for router work on all wood and solid surface
- Perfect for locks, hinges, latches and casters

NO.	VOLUME	QTY/BOX
00025	5.5 OZ	12

**Industrial Silicone Lubricant**

- Prevents sticking, speeds production, cuts down cleanup time
- Reduces friction on paper cutters, knives, drills, etc.
- Helps equipment last longer and work harder
- Note : May affect raw material to be finished

NO.	VOLUME	QTY/BOX
D030065	12 OZ	12

**Countertop & Granite Cleaner and Polish**

- Colorless, no wax build-up and pleasant fresh aroma
- Excellent results on all surfaces

NO.	VOLUME	QTY/BOX
1844TR	12 OZ	6

**"CABINET & WOOD MAGIC" Cleaner and Polish**

- Cleans and beautifies wood kitchen cabinets and wood work
- Removes grease, grime and stains
- Hides scratches

NO.	VOLUME	QTY/BOX
1432	17 OZ	6

Stainless Steel Cleaner

- Specially formulated for use on stainless steel fixtures, equipment or trim
- Cleans, polishes, protects stainless steel without scouring
- Removes old or heavy accumulation of greasy film, food spatter or oil stains

IMPORTANT : Not for use on cooking utensils

NO.	VOLUME	QTY/BOX
D010841	15 OZ	12

Glass Cleaner

- The most versatile glass cleaner available - cleans glass, windows, mirrors and windshields
- Dissolves dirt, grease, grit and grime
- Heavy-duty foam clings to vertical surfaces
- Contains perfume-grade alcohol for best performance

NO.	VOLUME	QTY/BOX
D010308	19 OZ	12

Plastic Cleaner

- Cleans plastic surfaces. Repels finger smudges, dirt and dust.
- Contains no chemicals or abrasives that will cause damage to plastic.
- Anti-static, Anti-fog, Fast-drying, Non-streaking.

NO.	VOLUME	QTY/BOX
D010346	19 OZ	12

Saw Blade Cleaner

Works in minutes. Cleans saws, router bits, shaper cutters of pitch and gum, etc. This effective cleaner is safe to use on carbide, high speed steel, stainless steel and cast iron surfaces.

NO.	VOLUME	QTY/BOX
D010355	18 OZ	12

Silicone Spray

- Stops squealing, sticking and binding of machinery
- Dries rapidly, leaves no greasy or oily film
- Note : May affect raw material to be finished

NO.	VOLUME	QTY/BOX
D010368	11 OZ	12

Citrus All Purpose Cleaner

For washable, painted surfaces, window sills, venetian blinds, all porcelain and tile surfaces. This product, formulated with orange citrus solvents, removes dirty hand prints from walls and doors, scuff marks from floors, bathtub rings, soot, grease, smoke film, oil, light carbon, dust, lipstick and crayon marks and deodorizes as it cleans.

NO.	VOLUME	QTY/BOX
D010985	19 OZ	12



All products are sold by unit except those shown with an \*. These are sold by box.

3M



### Cardboard Sealing/Packaging Tape

- For general industrial, food, beverage, medical pharmaceutical, paper, print, electronics and distribution centers
- Resists abrasion, moisture, chemicals, and scuffing
- 328 ft (100 m)

NO.	WIDTH	COLOR	QTY/BOX
48371048	2"	CLEAR	36



### Packaging Tape Dispenser

- Box sealing, combining, reinforcing and bundling
- Core Diameter: 3" (76.20 mm)
- Maximum width: 2" (48 mm)
- Length meter: 164 to 433 ft (50 to 132 m)

NO.	DESCRIPTION	QTY/BOX
48903	GENERAL USE	24



### Adjustable Stretch Film Dispenser

- Core Diameter: 3" (76.20 mm)

NO.	ADJUSTABLE	QTY/BOX
12578	3" TO 5"	60



### Adjustable Stretch Film Dispenser

- Core Diameter: 3" (76.20 mm)

NO.	ADJUSTABLE	QTY/BOX
22276	12" TO 18"	6



### Stretch Wrap Roll

- The thinner, stronger hand film in the market
- A premium-grade, cast co-extruded film that performs with less neckdown for better coverage

NO.	GAUGE	WIDTH	LENGTH	QTY/BOX
180033	20.3 MICRONS/80	3" (76 MM)	1500' (457 M)	18
180053	20.3 MICRONS/80	5" (127 MM)	1500' (457 M)	12
1651315	16.5 MICRONS/65	13" (330 MM)	1476' (450 M)	4
1651815	16.5 MICRONS/65	17" (428 MM)	1476' (450 M)	4

H64

## Notes

[illegible]

[illegible]

## Notes

[illegible]

## USA

Tel.: 1 800 619-5446 | Fax : 1 800 876-7454

### CONNECTICUT

Hartford

### FLORIDA

Dania Beach  
Hialeah  
Jacksonville  
Orlando  
Pompano Beach  
Riviera Beach  
Sarasota  
Tampa

### GEORGIA

Atlanta  
Savannah

### ILLINOIS

Chicago

### INDIANA

Indianapolis

### KENTUCKY

Louisville

### MAINE

Portland

### MASSACHUSETTS

Boston

### MICHIGAN

Detroit

### NEW JERSEY

Lincoln Park

### NEW YORK CITY

Long Island City  
New York

### NEW YORK - UPSTATE

Buffalo  
Syracuse

### NORTH CAROLINA

Charlotte  
Greensboro

### OHIO

Cincinnati

### SOUTH CAROLINA

Greenville

### TENNESSEE

Memphis  
Nashville

### TEXAS

Dallas  
Houston

### WASHINGTON

Seattle

## CANADA

Tel.: 1 800 361-6000 | Fax: 1 800 363-0193

### ALBERTA

Calgary  
Edmonton

### BRITISH COLUMBIA

Kelowna  
Vancouver  
Victoria

### MANITOBA

Winnipeg

### NEW BRUNSWICK

Moncton

### NEWFOUNDLAND

St. John's

### NOVA SCOTIA

Halifax

### ONTARIO

Barrie  
Kitchener  
Mississauga  
Ottawa  
Sudbury  
Thunder Bay  
Toronto

### QUÉBEC

Laval  
Montréal  
Québec

### SASKATCHEWAN

Regina  
Saskatoon

