

Titus+ SYSTEM 6 CONNECTORS

The assembly concept for **system 6** allows you to choose among a vast selection of entirely compatible dowels and housings to meet your particular needs.

This system is recommended for large-scale production and for furniture that requires quick and effortless mounting.



SIDE-ENTRY

Insertion of shelf panel from the side or from the top.



DROP-ON

Insertion of shelf panel only from the top.



OUTRIGGER

Ensures that the panels align flush for no possible movement.



NON-OUTRIGGER

Fits slightly tighter than other housings and dowels for reduced panel shift.



ANGLEDRIIVE FEATURE

Allows the angled position of screwdriver with a locking action creating a tight and secure joint.

AVAILABLE COLORS



Black - 90



Almond - 40



Silver - 06



White - 30



Brown - 60



Sand - 21



Cherry - 140



Zinc - 80



Nickel - 55

Titus+ SYSTEM 6

A face boring connector family for 32 mm system drilling for all cabinet manufacturing applications.

ASSEMBLY

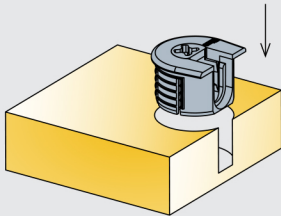

1. Knock the housing into face board

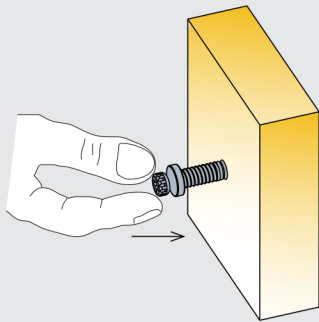

2. Press the dowel into side panel

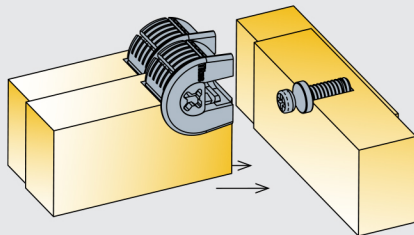

3. Assemble the panels

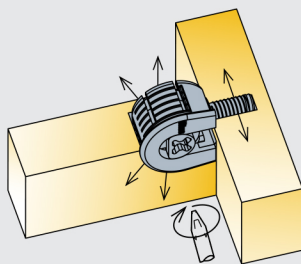

4. Tighten the joint



SYSTEM 6 - HOUSINGS

- Nylon housings with zinc cam
- Housings and dowels can be installed without tools
- Attains maximum strength when the cam is locked
- Angledrive feature on cam for maximum driving comfort
- Interchangeable pins for wood, plastic and steel applications
- Pins with twinstart drive for fast insertion
- Back-to-back fastenings for common vertical panel fixing of shelves

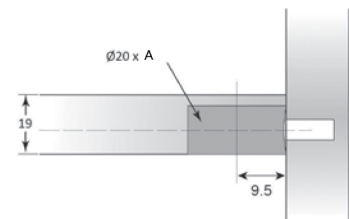

Ø 20 MM PLASTIC WEDGEFIX KNOCK-IN HOUSINGS

- Special fastener without cam: simply snap onto a pre-inserted dowel
- For use with quickfit dowels

No.	Finish	Drilling depth (A)	Panel thickness
647130	White	1/2" (12,5 mm)	5/8" (16 mm)
647160	Brown	1/2" (12,5 mm)	5/8" (16 mm)
647390*	Black	1/2" (12,5 mm)	5/8" (16 mm)
6472090	Black	9/16" (14 mm)	3/4" (19 mm)
647230	White	9/16" (14 mm)	3/4" (19 mm)
647260	Brown	9/16" (14 mm)	3/4" (19 mm)

*For use with screw-in dowels

SYSTEM 6 - HOUSINGS

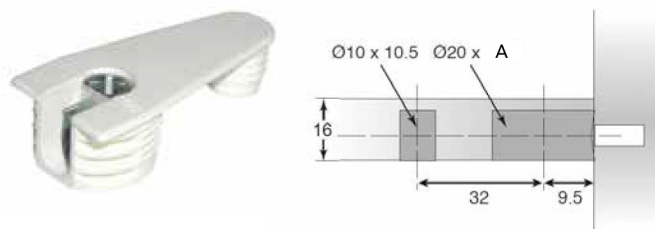

Ø 20 MM PLASTIC AND ZINC KNOCK-IN HOUSINGS, WITHOUT FLANGE

· Side-Entry

No.	Finish	Drilling depth (A)	Panel thickness
6443140	Cherry	1/2" (12,5 mm)	5/8" (16 mm)
644330	White	1/2" (12,5 mm)	5/8" (16 mm)
644360	Brown	1/2" (12,5 mm)	5/8" (16 mm)
644390	Black	1/2" (12,5 mm)	5/8" (16 mm)
644540	Almond	9/16" (14 mm)	3/4" (19 mm)
644590	Black	9/16" (14 mm)	3/4" (19 mm)
6461180	Zinc	9/16" (14 mm)	3/4" (19 mm)

Drive type: Phillips

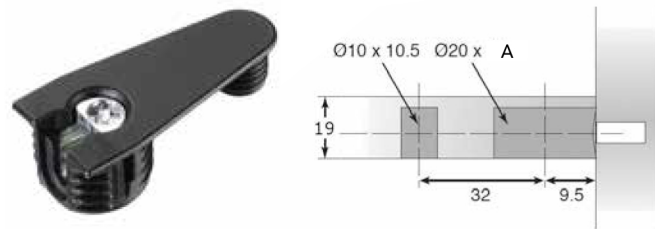

Ø 20 MM PLASTIC AND ZINC KNOCK-IN HOUSINGS, WITH FLANGE

· Drop-on

No.	Finish	Drilling depth (A)	Panel thickness
643930	White	1/2" (12,5 mm)	5/8" (16 mm)
643940	Almond	1/2" (12,5 mm)	5/8" (16 mm)
643960	Brown	1/2" (12,5 mm)	5/8" (16 mm)
643990	Black	1/2" (12,5 mm)	5/8" (16 mm)
6439421	Sand	1/2" (12,5 mm)	5/8" (16 mm)
6439140	Cherry	1/2" (12,5 mm)	5/8" (16 mm)
6455	Nickel	1/2" (12,5 mm)	5/8" (16 mm)
8644106	Silver	9/16" (14 mm)	3/4" (19 mm)
8644130	White	9/16" (14 mm)	3/4" (19 mm)
6457	Nickel	9/16" (14 mm)	3/4" (19 mm)
8644160	Brown	9/16" (14 mm)	3/4" (19 mm)
8644190	Black	9/16" (14 mm)	3/4" (19 mm)

Drive type: Phillips

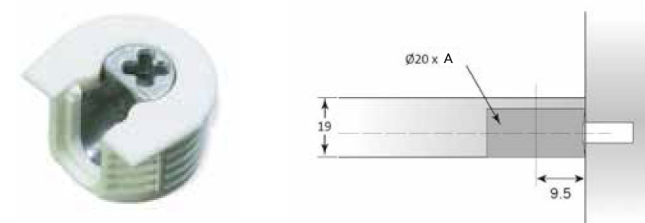

Ø 20 MM PLASTIC AND ZINC KNOCK-IN HOUSINGS, WITHOUT FLANGE

· Side-Entry

No.	Finish	Drilling depth (A)	Panel thickness
643590	Black	1/2" (12,5 mm)	5/8" (16 mm)
643530	White	1/2" (12,5 mm)	5/8" (16 mm)
643540	Almond	1/2" (12,5 mm)	5/8" (16 mm)
643560	Brown	1/2" (12,5 mm)	5/8" (16 mm)
6435140	Cherry	1/2" (12,5 mm)	5/8" (16 mm)
643730	White	9/16" (14 mm)	3/4" (19 mm)
643790	Black	9/16" (14 mm)	3/4" (19 mm)
643740	Almond	9/16" (14 mm)	3/4" (19 mm)
643760	Brown	9/16" (14 mm)	3/4" (19 mm)
6437140	Cherry	9/16" (14 mm)	3/4" (19 mm)

Drive type: Phillips

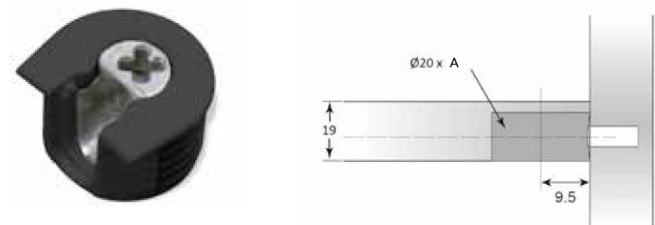

Ø 20 MM PLASTIC AND ZINC KNOCK-IN HOUSINGS, WITH FLANGE

· Drop-on

No.	Finish	Drilling depth (A)	Panel thickness
643130	White	1/2" (12,5 mm)	5/8" (16 mm)
643150	Almond	1/2" (12,5 mm)	5/8" (16 mm)
643190	Black	1/2" (12,5 mm)	5/8" (16 mm)
643160	Brown	1/2" (12,5 mm)	5/8" (16 mm)
643340	Almond	9/16" (14 mm)	3/4" (19 mm)
643360	Brown	9/16" (14 mm)	3/4" (19 mm)
643390	Black	9/16" (14 mm)	3/4" (19 mm)
643330	White	9/16" (14 mm)	3/4" (19 mm)
6433106	Silver	9/16" (14 mm)	3/4" (19 mm)
6433421	Sand	9/16" (14 mm)	3/4" (19 mm)

Drive type: Phillips



SYSTEM 6 - QUICKFIT DOWELS

- The Quickfit dowels simply slide into the predrilled 5 mm hole
- Dowels can be hand inserted, and removed without damaging the panel
- Klix locking feature for a strong, vibration-proof connection
- Depth stop collar for accurate insertion

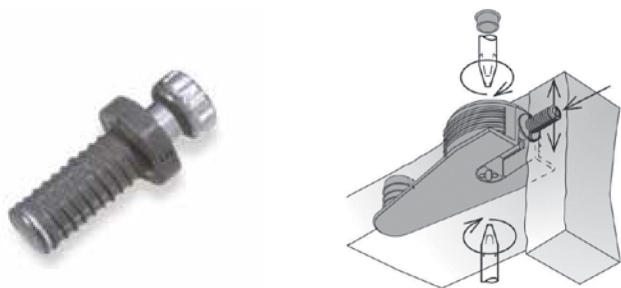

Ø 5 MM QUICKFIT **PLASTIC** **AND ZINC** EXPANDING DOWELS

- The dowel expands in the hole as the housing cam is rotated
- For panel-to-panel, and back-to-back applications

No.	Finish	Drilling Ø for Dowel Thread	Drilling Length for Dowel Thread
6408	Zinc	3/16" (5 mm)	1/2" (12,5 mm)
6479	Zinc	3/16" (5 mm)	9/32" (7,5 mm)

SYSTEM 6 - DOWELS

- Klix locking feature for a strong, vibration-proof connection
- Depth stop collar for accurate insertion

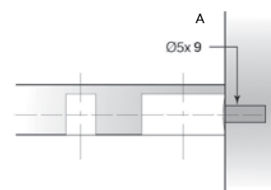

Ø 5 MM **ZINC** SCREW-IN DOWEL

- For panel-to-panel, and back-to-back applications

No.	Finish	Drilling Ø for Dowel Thread	Drilling Length for Dowel Thread (A)
6401	Zinc	3/16" (5 mm)	3/8" (9 mm)
6402	Zinc	3/16" (5 mm)	5/16" (8 mm)
6406	Zinc	3/16" (5 mm)	7/16" (11,5 mm)

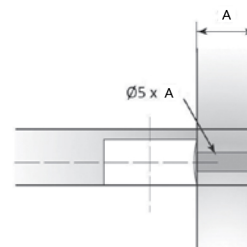

Ø 5 MM **ZINC** END DOWEL

- Above-average resistance

No.	Finish	Drilling Ø for Dowel Thread	Drilling Length for Dowel Thread	Panel thickness (A)
6412	Zinc	3/16" (5 mm)	5/8" (16 mm)	5/8" (16 mm)
6415	Zinc	3/16" (5 mm)	5/8" (16 mm)	3/4" (19 mm)

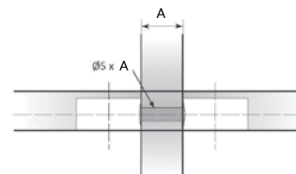

Ø 5 MM **ZINC** DOUBLE-ENDED DOWELS

- Double dowels allow for identical panels vertically and horizontally

No.	Finish	Drilling Ø for Dowel Thread	Product Diameter	Panel thickness (A)
6414	Zinc	3/16" (5 mm)	5/8" (16 mm)	5/8" (16 mm)
6416	Zinc	3/16" (5 mm)	5/8" (16 mm)	3/4" (19 mm)

