



RANGE HOODS

STAINLESS STEEL | WOOD | ACCESSORIES



CHOOSING A RANGE HOOD

WHAT YOU SHOULD KNOW:



WALL-MOUNTED, ISLAND HOODS OR CANOPY HOODS

Wall-mounted hoods are simply installed on the wall above the cooking surface. **Island hoods** are installed on the ceiling above the cooking surface. **Canopy hoods** are installed in between two upper cabinets.



CHIMNEY HOODS OR BUILT-IN HOODS

Chimney hoods include the decorative hood, the chimney structure and the vent motor, available in several models and sizes.

Built-in hoods include a motor which can be embedded in a decorative hood (notably those made of wood) or in an upper kitchen cabinet. Its suction performance will depend on the dimensions of the decorative hood or upper cabinet.



EXTERIOR VENTING OR NON-DUCTED

In **exterior venting arrangements**, the motor is surrounded by a non-flammable enclosure which is attached to an external outlet. The air is sucked in and discharged outside of the house. For optimal operation, it is recommended to have as few bends as possible in the duct leading outside.

Non-ducted models require no external exhaust duct assembly, as the air is recycled into the room through a metallic filter that retains grease and a charcoal filter that purifies the air. Once the odor is removed, air is released into the room. Ideal for apartments.



POWER

Ideally, the air volume in a kitchen should be refreshed at least 10 times an hour.

These calculations are only indicative.

- Room surface in m² x room height = X m³
- Room surface in ft² x room height = X ft³
- Room volume in m³ x 10 = the minimum air flow required (m³/h)
- (Room volume in ft³ x 10) ÷ 60 = air flow required in CFM

As a rule, you should choose a hood with a higher capacity than what you need, because it has the advantage of running the motor at low speed with greater efficiency and less noise.



NOISE

Range hood noise levels are given in sones. Look for the lowest sone number to get the quietest unit. Make sure the hood is well attached to its supporting structure, as a significant portion of noise can come from vibrations resulting from an inadequate attachment of the hood.



FILTER

Most hoods are equipped with a dishwasher-safe metal filter that captures airborne grease particles. It is recommended that they be regularly cleaned (once a month at least), as accumulated grease is highly flammable. Charcoal filters are designed to purify the air. They are essential when the hood is non ducted. It is important to change filters regularly, depending on use.



LIGHTING

As the hood is located above your cooking area, select a model with adequate lighting. Higher-end models come with halogen lamps (for maximum brightness and energy conservation). Value models will be equipped with incandescent light bulbs.



VARIABLE SPEED CONTROL

A variable speed control (using push buttons or electronic controls) will allow you to adjust the ventilation speed to the type of cooking.

PYRAMIDAL WALL-MOUNTED HOOD

STAINLESS STEEL

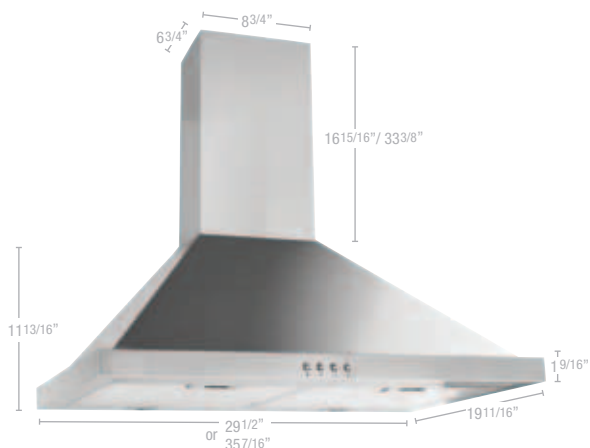

No.	Description	Noise level (sones)
52030170	30" pyramidal wall-mounted hood 450 CFM	1 (min. speed) 6.0 (max. speed)
52930170	30" pyramidal wall-mounted hood 292 CFM	1 (min. speed) 4.5 (max. speed)

Push button, incandescent bulbs

No.	Description	Noise level (sones)
52530170	30" pyramidal wall-mounted hood 600 CFM	1.5 (min. speed) 7.5 (max. speed)
52536170	36" pyramidal wall-mounted hood 600 CFM	1.5 (min. speed) 7.5 (max. speed)

Electronic control, halogen bulbs

RECTANGULAR WALL-MOUNTED HOOD

STAINLESS STEEL

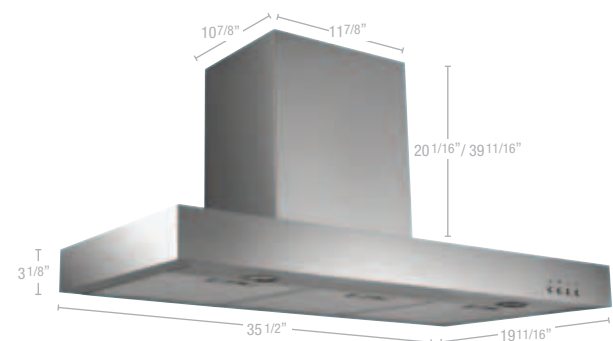

No.	Description	Noise level (sones)
53036170	36" rectangular wall-mounted hood 600 CFM	1.5 (min. speed) 7.5 (max. speed)

Electronic control

* See page 15 for accessory compatibility table

VALUE-ADDED FEATURES

- 3-speed adjustment
- Time delay for the electronic control version **ONLY**
- Power module of 450 CFM or 600 CFM
- 2 halogen bulbs or incandescent bulbs (included)
- 4-layer aluminum filter included, dishwasher-safe
- Fits ceiling up to 9' (2.75 m) high when installed 30" (762 mm) from cooking surface
- Can fit to ceiling up to 10' (3.05 m) high, adding chimney extension **No. 50130170**, sold separately
- UL 110V certified
- Made of grade 430 stainless steel

SUGGESTED PRODUCTS*

No.	Description
50130170	Chimney extension
52005100	Filter for hood No. 52030170
52008100	Charcoal filter
52010100	Ductless kit
52005100	Filter for hood No. 52530170
52536100	Filter for hood No. 52536170
52905100	Filter for hood No. 52930170

VALUE-ADDED FEATURES

- Electronic 3-speed adjustment with time delay
- Power module of 600 CFM
- 2 halogen bulbs included
- 4-layer aluminum filter included, dishwasher-safe
- Fits ceiling up to 9' (2.75 m) high when installed 30" (762 mm) from cooking surface
- Can fit to ceiling up to 10' (3.05 m) high, adding chimney extension **No. 50436170**, sold separately
- UL 110V certified
- Made of grade 430 stainless steel

SUGGESTED PRODUCTS*

No.	Description
50436170	Chimney extension
52008100	Charcoal filter
53009100	Filter for hood No. 53036170
53012100	Ductless kit

WALL-MOUNTED HOOD

STAINLESS STEEL



No.	Description	Noise level (sones)
56730170	30" wall-mounted hood 600 CFM	2.5 (min. speed) 6.5 (max. speed)

Electronic control

SUGGESTED PRODUCTS*

No.	Description
52008100	Charcoal filter
52067100	Ductless kit
56719100	Filter for hood No. 56730170
56721170	Chimney extension

WALL-MOUNTED HOOD

GLASS & STAINLESS STEEL

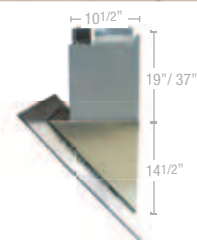
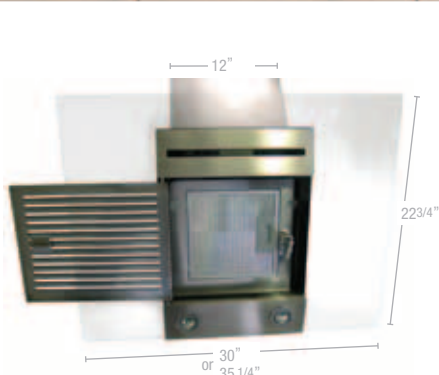

No.	Description	Noise level (sones)
57030170	30" wall-mounted hood 500 CFM	2 (min. speed) 6 (max. speed)
57036170	36" wall-mounted hood 500 CFM	2 (min. speed) 6 (max. speed)

Electronic control

VALUE-ADDED FEATURES

- Electronic 4-speed adjustment with time delay
- Power module of 500 CFM or 600 CFM
- 2 directional halogen bulbs included
- 5-layer aluminum filter included, dishwasher-safe
- Removable grease receptacle
- Filter cleaning reminder indicator
- Can fit to ceiling up to 10' (3.05 m) high, adding chimney extension **No. 57027170**, sold separately
- Cooking timer with alarm
- cETL certified
- **Cannot be converted to recycling mode system**

SUGGESTED PRODUCTS*

No.	Description
57025100	Filter for hood No. 57030170 and No. 57036170
57027170	Chimney extension

WALL-MOUNTED HOOD

GLASS & STAINLESS STEEL



No.	Description	Noise level (sones)
56030170	30" wall-mounted hood 600 CFM	1.5 (min. speed) 7.5 (max. speed)
56036170	36" wall-mounted hood 600 CFM	1.5 (min. speed) 7.5 (max. speed)

Digital electronic control



No.	Description	Noise level (sones)
56530170	30" wall-mounted hood 450 CFM	1.5 (min. speed) 6.0 (max. speed)
56536170	36" wall-mounted hood 450 CFM	1.5 (min. speed) 6.0 (max. speed)

Electronic control

VALUE-ADDED FEATURES

- Electronic 3-speed adjustment with time delay
- Power module of 450 CFM or 600 CFM
- 2 halogen bulbs included
- 4-layer aluminum filter included, dishwasher-safe
- Fits ceiling up to 9' (2.75 m) high when installed 30" (762 mm) from cooking surface
- Can fit to ceiling up to 10' (3.05 m) high, adding chimney extension **No. 50236170**, sold separately
- UL 110V certified
- Made of grade 430 stainless steel

SUGGESTED PRODUCTS*

No.	Description
50236170	Chimney extension
52008100	Charcoal filter
52020100	Ductless kit
56004100	Filter for hood No. 56030170 and No. 56036170
56503100	Filter for hood No. 56530170 and No. 56536170

ISLAND HOOD

STAINLESS STEEL

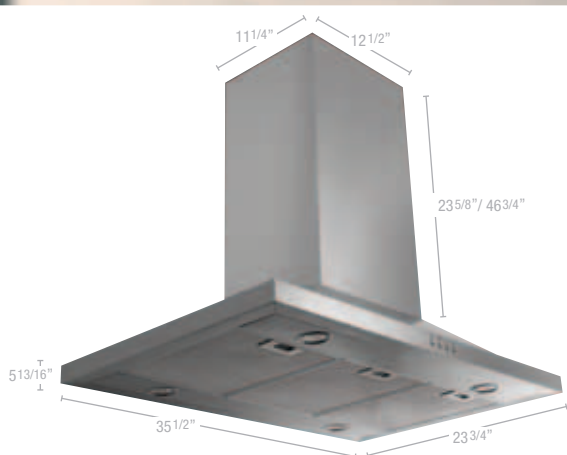

No.	Description	Noise level (sones)
52636170	36" island hood 600 CFM	1.5 (min. speed) 7.5 (max. speed)

Electronic control

VALUE-ADDED FEATURES

- Electronic 3-speed adjustment with time delay
- Power module of 600 CFM
- 4 halogen bulbs included
- 4-layer aluminum filter included, dishwasher-safe
- Fits ceiling up to 9' (2.75 m) high when installed 30" (762 mm) from cooking surface
- Can fit to ceiling up to 10' (3.05 m) high, adding chimney extension **No. 50336170**, sold separately
- UL 110V certified
- Made of grade 430 stainless steel

SUGGESTED PRODUCTS*

No.	Description
50336170	Chimney extension
52008100	Charcoal filter
52040100	Ductless kit
52608100	Filter for hood No. 52636170

* See page 15 for accessory compatibility table

BUILT-IN HOOD

STAINLESS STEEL

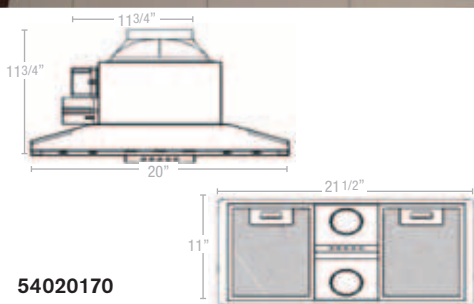

54020170

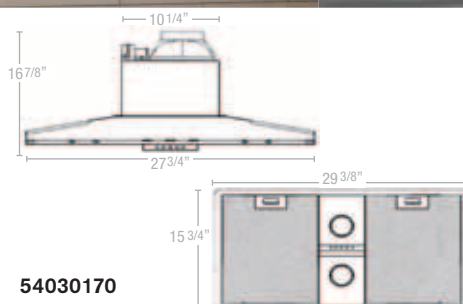

54030170

No.	Description	Noise level (sones)
54020170	22" built-in hood 300 CFM	1 (min. speed) 5.5 (max. speed)

Electronic control

No.	Description	Noise level (sones)
54030170	30" built-in hood 500 CFM	1.5 (min. speed) 6 (max. speed)
54128170	28" built-in hood 450 CFM	2 (min. speed) 6.5 (max. speed)

Electronic control

VALUE-ADDED FEATURES

- Electronic 3-speed adjustment
- Power module of 300 CFM or 500 CFM
- 2 halogen bulbs included
- 3-layer aluminum filter included, dishwasher-safe
- cETLus certified
- Made of grade 430 stainless steel
- **Cannot be converted to recycling mode system**

SUGGESTED PRODUCTS*

No.	Description
54007100	Filter for hood No. 54020170
54010100	Filter for hood No. 54030170
54128100	Filter for hood No. 54128170

UNDER-CABINET HOOD

STAINLESS STEEL

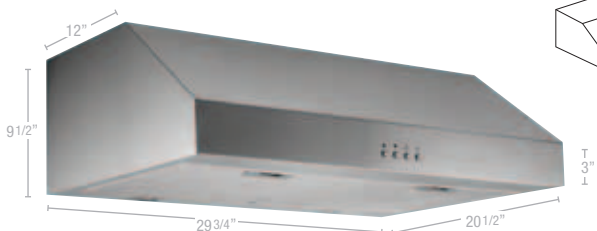

Round

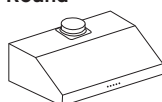

Top venting

Rectangular

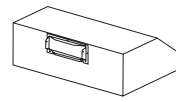

Rear venting

No.	Description	Noise level (sones)
55030170	30" under-cabinet canopy hood 450 CFM	1.5 (min. speed) 6.5 (max. speed)

Electronic control

VALUE-ADDED FEATURES

- 3-speed adjustment with time delay
- Power module of 450 CFM
- 2 halogen bulbs included
- 4-layer aluminum filter included, dishwasher-safe
- This model provides a top or rear ventilation
- Round or rectangular exhaust adaptor (both included)
- cULus certified
- Made of grade 430 stainless steel
- **Cannot be converted to recycling mode system**

SUGGESTED PRODUCTS*

No.	Description
55002100	Filter for hood No. 55030170

UNDER-CABINET HOOD

STAINLESS STEEL

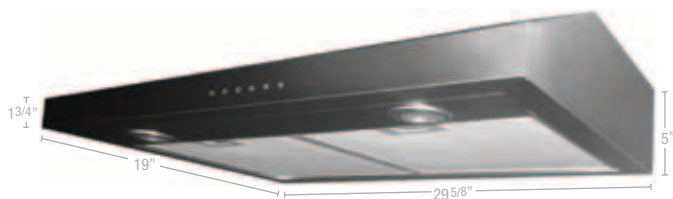

No.	Description	Noise level (sones)
55630170	30" under-cabinet hood 300 CFM	1.5 (min. speed) 6.5 (max. speed)

Electronic control

VALUE-ADDED FEATURES

- 5" slim model
- Electronic 4-speed adjustment with time delay
- Power module of 300 CFM
- 2 halogen bulbs included
- 4-layer aluminum filter included, dishwasher-safe
- UL 110V certified
- Made of an easy-to-clean corrosion-resistant stainless steel
- **Cannot be converted to recycling mode system**

SUGGESTED PRODUCTS*

No.	Description
55627100	Filter for hood No. 55630170

UNDER-CABINET HOOD

STAINLESS STEEL

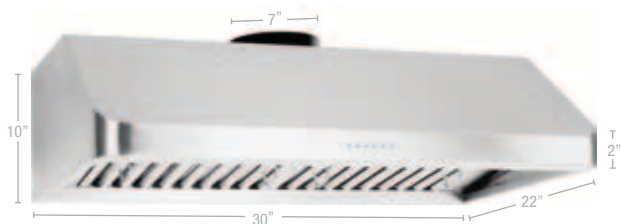
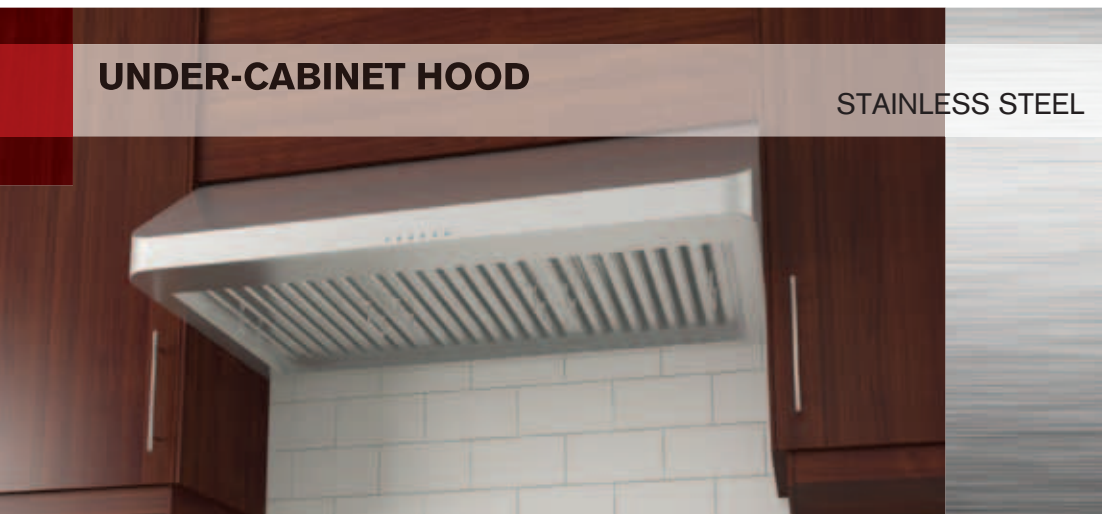

No.	Description	Noise level (sones)
55930170	30" under-cabinet hood 900 CFM	1.5 (min. speed) 6.5 (max. speed)

Electronic control

VALUE-ADDED FEATURES

- Electronic 4-speed adjustment with time delay
- Power module of 900 CFM
- 2 halogen bulbs included
- Baffle filters included providing extra grease trapping
- Dishwasher-safe filters
- Removable grease receptacle
- CSA, cUL certified

SUGGESTED PRODUCTS*

No.	Description
55934100	Filter for hood No. 55930170

* See page 15 for accessory compatibility table

EURO SERIES

WOODEN HOOD

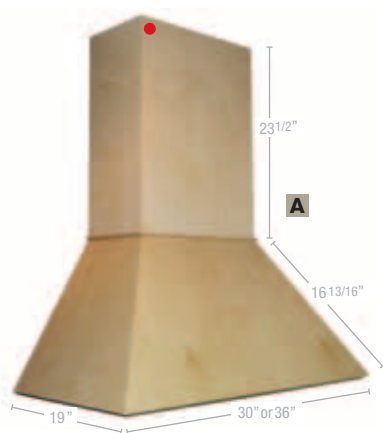

EURO HOOD

No.	Description	Material
12030150	30" (762 mm) wooden hood	Maple (unfinished)
12036150	36" (914 mm) wooden hood	Maple (unfinished)

● Chimney extension sold separatly

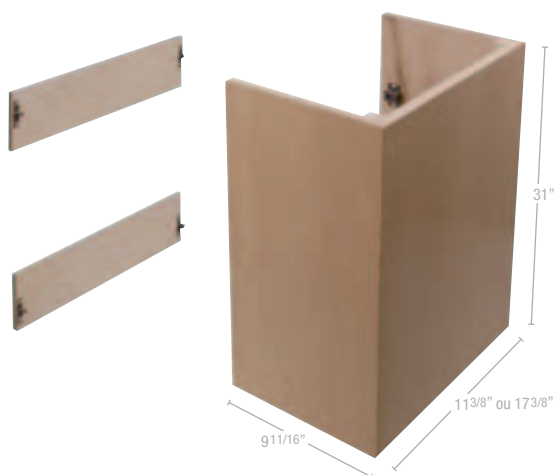

CHIMNEY EXTENSIONS

No.	Description	Material
CH213031150	For 30" Euro series hood No. 12030150 h: 31" (787 mm)	Maple (unfinished)
CH213631150	For 36" Euro series hood No. 12036150 h: 31" (787 mm)	Maple (unfinished)

VALUE-ADDED FEATURES

- Wall-mounted wooden hood
- Contemporary look
- Designed for easy and fast installation
- French cleat hanging method (patented)
- Silver metallic liner included
- Other widths and wood species available upon special order
- Designed to accept ventilator
No. 20500170 (500 CFM)

(see p. 13-15 for ventilators and accessories)

VALUE-ADDED FEATURES

- Designed to fit perfectly to Euro Series wooden hoods
- Height of 31" (787 mm) to be cut to required size
- Simply clips into place
- All hardware included

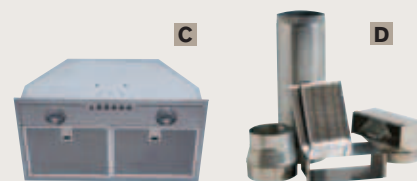

FOR A COMPLETE SYSTEM, ORDER*:

- A** 1x Euro series hood
- B** 1x Chimney extension
- C** 1x Ventilator (see p. 13-15)
- D** 1x Ductless kit, if necessary (see p. 13-15)

SIGNATURE SERIES

WOODEN HOOD



STRAIGHT SIGNATURE HOOD

No.	Description	Material
10036150	38 3/8" (975 mm) straight wooden hood	Maple (unfinished)

● Chimney extension sold separately



ARCHED SIGNATURE HOOD

No.	Description	Material
10536150	38 3/8" (975 mm) arched wooden hood	Maple (unfinished)

● Chimney extension sold separately

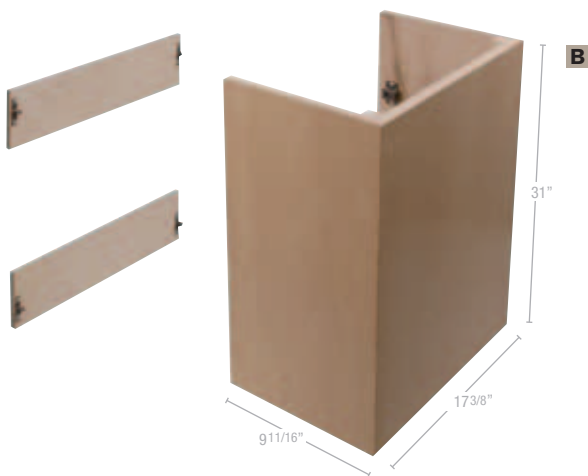

CHIMNEY EXTENSION

No.	Description	Material
CH213631150	Chimney extension for Signature and Euro series hoods h: 31" (787 mm)	Maple (unfinished)



VALUE-ADDED FEATURES

- Wall-mounted wooden hood
- 2 versions: arched or straight valance
- Designed for easy and fast installation
- French cleat hanging method (patented)
- Silver metallic liner included
- Other widths and wood species available upon special order
- Designed to accept ventilator **No. 20500170** (500 CFM) or **No. 20390100** (390 CFM) (see p. 13-15 for ventilators and accessories)

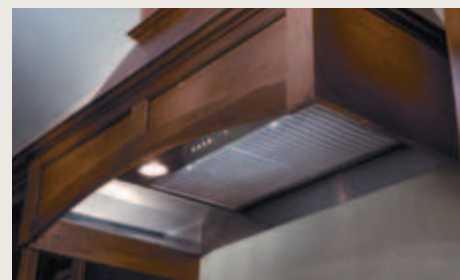

VALUE-ADDED FEATURES

- Designed to fit perfectly to Signature Series wooden hoods
- Height of 31" (787 mm) to be cut to required size
- Simply clips into place
- All hardware included

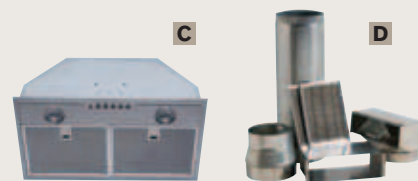

FOR A COMPLETE SYSTEM, ORDER*:

- A** 1x Arched or straight hood
- B** 1x Chimney extension
- C** 1x Ventilator (see p. 13-15)
- D** 1x Ductless kit, if necessary (see p. 13-15)

SIGNATURE CANOPY SERIES

WOODEN HOOD



ARCHED SIGNATURE HOOD

No.	Description	Material
11530150	30" (762 mm) arched Canopy hood	Maple (unfinished)
11536150	36" (914 mm) arched Canopy hood	Maple (unfinished)

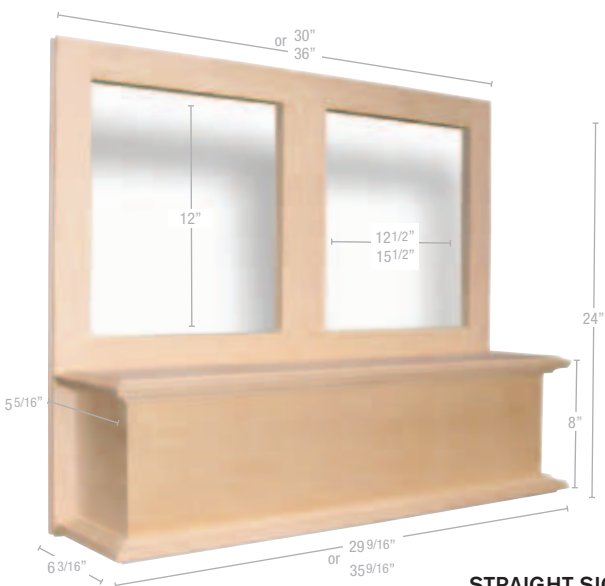

STRAIGHT SIGNATURE HOOD

No.	Description	Material
11630150	30" (762 mm) straight Canopy hood	Maple (unfinished)
11636150	36" (914 mm) straight Canopy hood	Maple (unfinished)



VALUE-ADDED FEATURES

- Canopy-mounted wooden hood
- 2 versions: arched or straight valance
- Designed for easy and fast installation
- Silver metallic liner included
- Other wood species available upon special order
- Designed to accept ventilator **No. 20390100** (390 CFM) or **No. 20250100** (250 CFM) (see p. 13-15 for ventilators and accessories)
- The doors or central panels have to be made by customer



OR

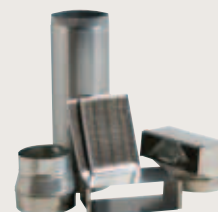

FOR A COMPLETE SYSTEM, ORDER*:

- A** 1x Arched or straight hood
- B** 1x Ventilator (see p. 13-15)
- C** 1x Ductless kit, if necessary (see p. 13-15)

ARTISAN WALL-MOUNTED HOOD

WOODEN HOOD



No.	Description	Material
11036150	38 3/8" (975 mm) Artisan hood	Maple (unfinished)

SELECT CANOPY HOOD

WOODEN HOOD

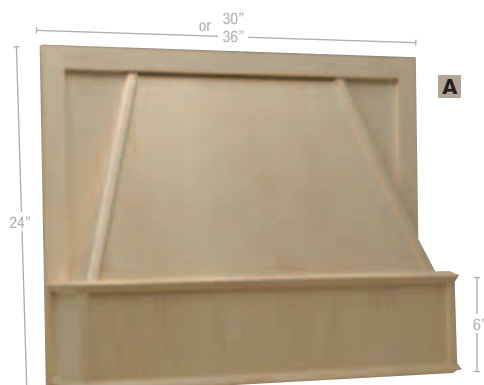

No.	Description	Material
20030150	30" (762 mm) Select hood	Maple (unfinished)
20036150	36" (914 mm) Select hood	Maple (unfinished)



VALUE-ADDED FEATURES

- Designed for easy and fast installation
- French cleat hanging method (patented)
- Silver metallic liner included
- Designed to accept ventilator **No. 20500170** (500 CFM) or **No. 20390100** (390 CFM) (see p. 13-15 for ventilators and accessories)
- Other widths and wood species available upon special order
- Can be cut up to 12" (305 mm) shorter in height

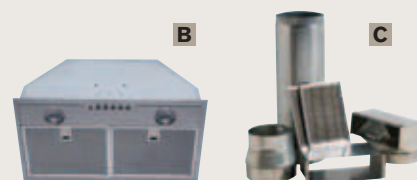

FOR A COMPLETE SYSTEM, ORDER*:

- A** 1x Artisan hood
- B** 1x Ventilator (see p. 13-15)
- C** 1x Ductless kit, if necessary (see p. 13-15)



VALUE-ADDED FEATURES

- Manufactured from solid wood and wood veneers
- Apron of 6" (152 mm) for flexibility of decoration and timeless style. Please consult our *Corbels and Ornaments* brochure for a wide selection
- Designed to be installed between 2 cabinets
- Silver metallic liner included
- Designed to accept ventilator **No. 20250100** (250 CFM) or **No. 20390100** (390 CFM) (see p. 13-15 for ventilators and accessories)
- Other wood species available upon special order

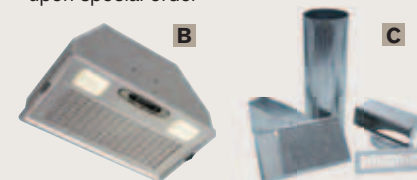

FOR A COMPLETE SYSTEM, ORDER*:

- A** 1x Select hood
- B** 1x Ventilator (see p. 13-15)
- C** 1x Ductless kit, if necessary (see p. 13-15)

TRADITION CANOPY HOOD

WOODEN HOOD



A

No.	Description	Material
30030150	30" (762 mm) Tradition hood	Maple (unfinished)
30030250	30" (762 mm) Tradition hood	Red oak (unfinished)
30030280	30" (762 mm) Tradition hood	Cherry (unfinished)
30036150	36" (914 mm) Tradition hood	Maple (unfinished)
30036250	36" (914 mm) Tradition hood	Red oak (unfinished)
30036280	36" (914 mm) Tradition hood	Cherry (unfinished)

VALUE-ADDED FEATURES

- Manufactured from solid wood and wood veneers
- Designed to be installed between 2 cabinets
- Silver metallic liner included
- Designed to accept ventilator **No. 20250100** (250 CFM) or **No. 20390100** (390 CFM) (see p. 13-15 for ventilators and accessories)
- Other wood species available upon special order

Decorative spindle rail included but not installed



FOR A COMPLETE SYSTEM, ORDER*:

- A** 1x Tradition hood
B 1x Ventilator (see p. 13-15)
C 1x Ductless kit, if necessary (see p. 13-15)



B

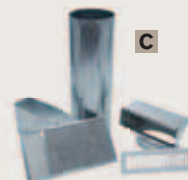

C

CLASSIC CANOPY SERIES

WOODEN HOOD



A

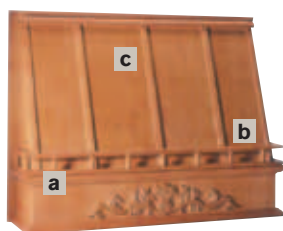

a

b

c

No.	Description	Material
40030150	30" (762 mm) Classic hood	Maple (unfinished)
40036150	36" (914 mm) Classic hood	Maple (unfinished)

VALUE-ADDED FEATURES

- Manufactured from solid wood and wood veneers
- Design to be installed between 2 cabinets
- Silver metallic liner included
- Designed to accept ventilator **No. 20250100** (250 CFM) or **No. 20390100** (390 CFM) (see p. 13-15 for ventilators and accessories)
- Decorative spindle rail and ornaments available in options to personalize your hood (see the table below)

No.	Description	For hood No.
a 40530150	Decorative ornament, natural wood (maple)	40030150 & 40036150
b 40330150 40336150	Spindle rail (maple)	40030150 40036150
c 40230150 40236150	Vertical molding (maple)	40030150 40036150

FOR A COMPLETE SYSTEM, ORDER*:

- A** 1x Classic hood
B 1x Ventilator (see p. 13-15)
C 1x Ductless kit, if necessary (see p. 13-15)

WOODEN HOOD ACCESSORIES

FOR PERSONALIZED HOOD

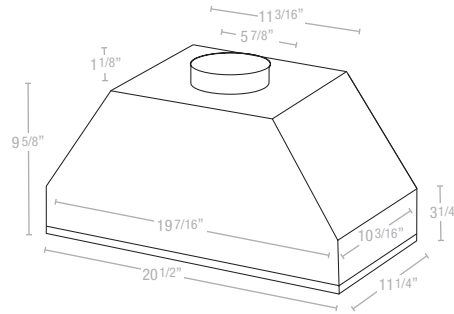

VENTILATOR

No.	Description	Noise level (sones)	Finish
20500170	Ventilator of 500 CFM	8 (max. speed)	Stainless steel

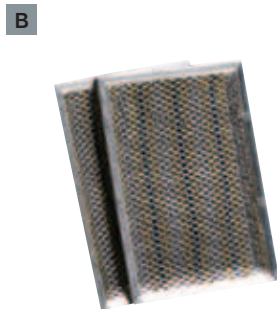

DUCTLESS KIT FOR INTERNAL RECYCLING

No.	Description
A 90359100	Ductless kit for ventilator No. 20500170
B 90372002	Charcoal filter refill for ventilator No. 20500170

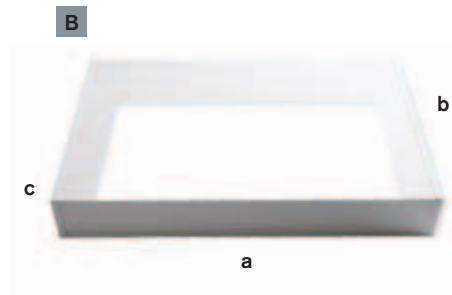
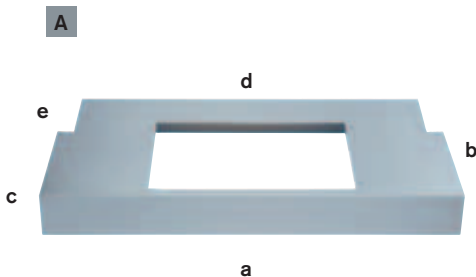

METALLIC LINERS

No.	Description	Finish	Inst. Type
A 90654100	30" (762 mm) T-shaped liner for canopy type hoods	Silver	Canopy
90655100	36" (914 mm) T-shaped liner for canopy type hoods	Silver	Canopy
B 90656100	30" (762 mm) rectangular liner for wall-mounted hoods	Silver	Wall-mounted
90657100	36" (914 mm) rectangular liner for wall-mounted hoods	Silver	Wall-mounted

DIMENSIONS

No.	a	b	c	d	e
A 90654100	29 15/16" (760 mm)	16 1/2" (419 mm)	4" (102 mm)	26 3/16" (665 mm)	11 1/8" (283 mm)
90655100	35 15/16" (912 mm)	16 1/2" (419 mm)	4" (102 mm)	32 3/16" (818 mm)	11 1/8" (283 mm)
B 90656100	28 1/2" (723 mm)	18 1/4" (464 mm)	4" (102 mm)		
90657100	34 1/2" (876 mm)	18 1/4" (464 mm)	4" (102 mm)		

VALUE-ADDED FEATURES

- Adapts perfectly to the metallic liner included with the hood
- 500 CFM power
- 3-speed adjustment
- Push button control
- Halogen light bulbs are included (2 x 20W - T3 - G4 base)
- Aluminum filters included, dishwasher-safe
- cUL-UL and HVI certified

VALUE-ADDED FEATURES

- Allows to convert your hood into an internal recycling mode
- Charcoal filter included
- We recommend replacing your filter once a year to guarantee efficient internal air recycling

VALUE-ADDED FEATURES

- All liners can receive the following ventilators :
No. 20500170 p.13
No. 20250100 p.14
No. 20390100 p.14

WOODEN HOOD ACCESSORIES

FOR PERSONALIZED HOOD

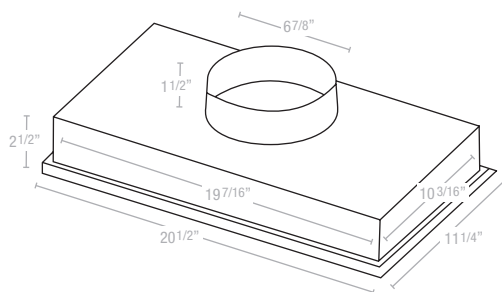

VENTILATOR

No.	Description	Noise level (sones)	Finish
20250100	Ventilator of 250 CFM	8 (max. speed)	Metallic silver

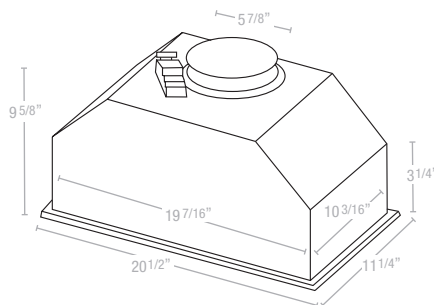

VENTILATOR

No.	Description	Noise level (sones)	Finish
20390100	Ventilator of 390 CFM	6 (max. speed)	Metallic silver



DUCTLESS KIT FOR INTERNAL RECYCLING

No.	Description
A 90358100	Ductless kit for ventilator No. 20250100 & No. 20390100
B 90372000	Charcoal filter refill for ventilator No. 20250100 & No. 20390100



VALUE-ADDED FEATURES

- 250 CFM power
- 2-speed adjustment
- Push button control
- Incandescent light bulbs are **not included** (2x 40W, candelabra base)
- Aluminum filter included, dishwasher-safe
- cUL-UL and HVI certified



VALUE-ADDED FEATURES

- 390 CFM power
- 3-speed adjustment
- Push button control
- Incandescent light bulbs are **not included** (2x 40W, candelabra base)
- Aluminum filter included, dishwasher-safe
- cUL-UL & HVI certified



VALUE-ADDED FEATURES

- Allows to convert your hood into an internal recycling mode
- Charcoal filter included
- We recommend replacing your filter a once year to guarantee efficient internal air recycling

BACKSPLASH

STAINLESS STEEL

VALUE-ADDED FEATURES

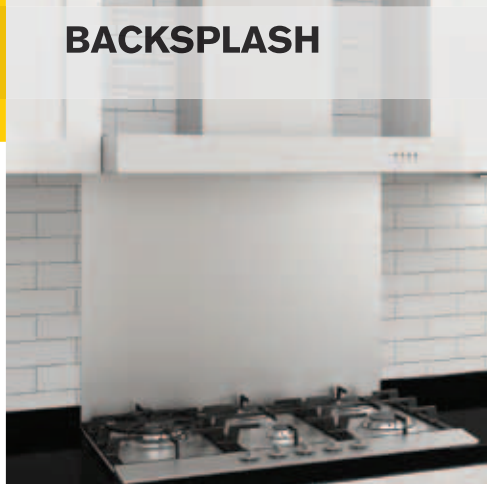

- This backsplash blends well with your stainless steel hood
- Protects the wall against accumulation of cooking grease and smoke
- Very easy to clean
- Made of grade 430 stainless steel
- Fitted with a lip of 3/8" (9.5 mm) above and below to ensure a perfect finish with ceramics
- Requires a distance of 29 1/2" (749 mm) from the base of the hood and the cooking surface

No.	Description
50300170	30" backsplash
50360170	36" backsplash

STAINLESS STEEL HOOD ACCESSORIES

REFERENCE

No.	52030170	52530170	52536170	52636170	52930170	53036170
Filter	52005100		52536100	52608100	52905100	53009100
Ductless kit		52010100		52040100	52010100	53012100
Chimney extension		50130170		50336170	50130170	50436170

No.	54020170	54030170	54128170	55030170	55630170	55930170
Filter	54007100	54010100	54128100	55002100	55627100	55934100
Ductless kit				N/A		
Chimney extension				N/A		

No.	56030170	56036170	56530170	56536170	56730170	57030170	57036170
Filter		56004100		56503100	56719100	57025100	52008100*
Ductless kit				52020100	52067100	N/A	
Chimney extension				50236170	56721170	57027170	

** Filter No. 52008100 fits on all ductless kits.



WOODEN HOOD ACCESSORIES

REFERENCE

For hoods No. 10036150, 10536150, 11036150, 11530150, 11536150, 11630150, 11636150, 12030150 and 12036150:

Chimney extension	CH213631150* CH213031150**
Filter	90372002
Ventilator	20500170**
Ductless kit	90359100

* For hoods No. 10036150, 10536150 and 12036150 only.

** For hood No. 12030150 only.

For hoods No. 20030150, 20036150, 30030150, 30030250, 30030280, 30036150, 30036250, 30036280, 40030150 and 40036150:

Chimney extension	N/A
Filter	90372000
Ventilator	20250100** or 20390100**
Ductless kit	90358100

** Recommendation only. All ventilators fit on all hood models.





CANADA

Tel. 1 800 361-6000 • Fax 1 800 363-0193

ALBERTA

Calgary
Edmonton

BRITISH COLUMBIA

Kelowna
Vancouver
Victoria

MANITOBA

Winnipeg

NEW BRUNSWICK

Moncton

NEWFOUNDLAND

St. John's

NOVA SCOTIA

Halifax

ONTARIO

Barrie
Kitchener
Mississauga
Ottawa
Sudbury
Thunder Bay
Toronto

QUÉBEC

Laval
Montréal
Québec

SASKATCHEWAN

Regina
Saskatoon

UNITED STATES

Tel. 1 800 619-5446 • Fax 1 800 876-7454

CONNECTICUT

Hartford

FLORIDA

Dania Beach
Hialeah
Pompano Beach
Riviera Beach

GEORGIA

Atlanta
Savannah

ILLINOIS

Chicago

INDIANA

Indianapolis

KENTUCKY

Louisville

MASSACHUSETTS

Boston

MICHIGAN

Detroit

NEW JERSEY

Avenel
Lincoln Park

NEW YORK

New York
Syracuse

NORTH CAROLINA

Charlotte
Greensboro
Raleigh

OHIO

Cincinnati
Cleveland
Columbus

SOUTH CAROLINA

Greenville

TENNESSEE

Nashville

WASHINGTON

Seattle

