

# Shower Header Kit For "D" and "H" Shaped Headers

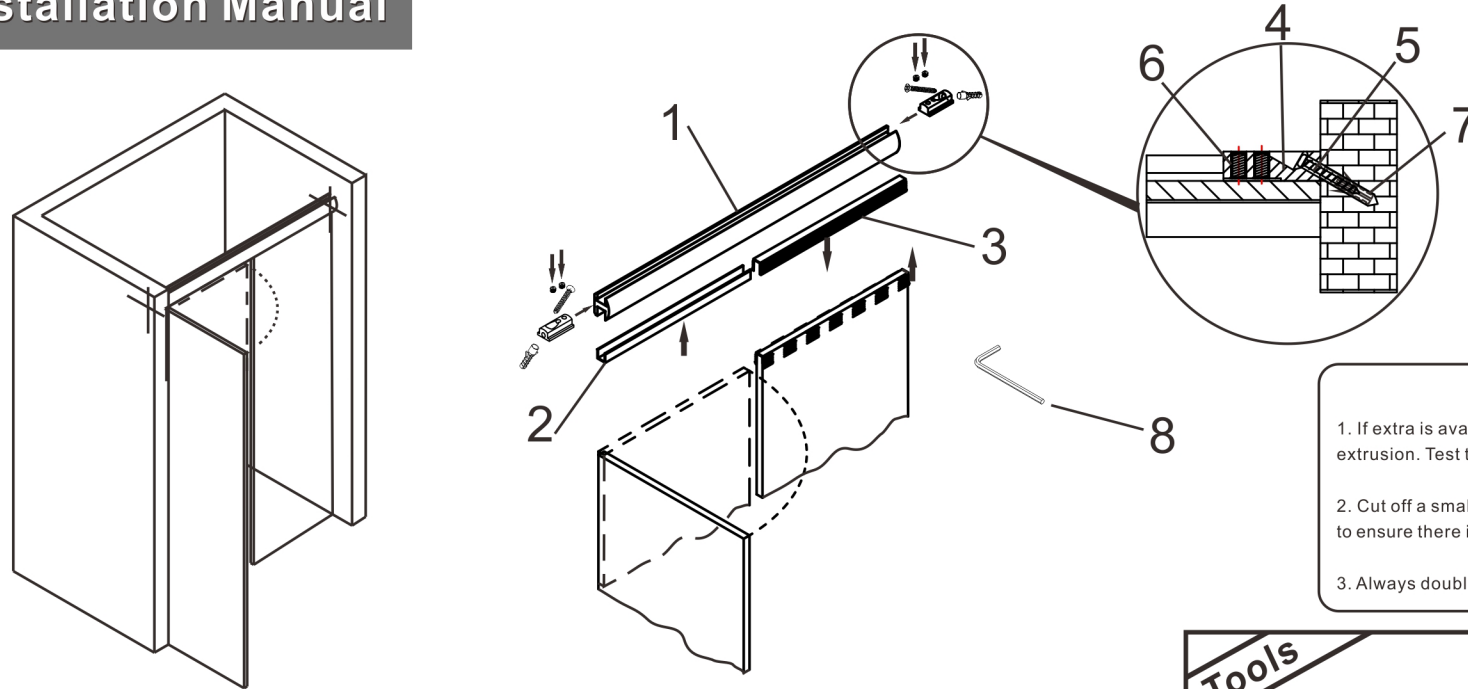

## Installation Manual



C/N	Name	Qty
1	Header Extrusion	1
2	Snap-in Filler Insert	1
3	Gasket for 10mm Glass	1
4	Wall Mounting Bracket	2
5	Mounting Screw	2
6	Assembly Screw	4
7	Wall Anchor	2
8	Allen Key	1

### Pre-installation testing

1. If extra is available, cut off a small section of the gasket and the header extrusion. Test the fit by installing on both ends of the glass panel.
2. Cut off a small section of the Snap-In filler and insert into the header extrusion to ensure there is a tight fit.
3. Always double check any measurements before making the final cut or drilling.

★ Installation differs depending on the glass thickness. Read instructions completely before beginning installation.

### Tools

Tools required for the installation.

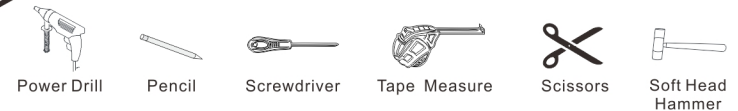

### 1 Wall anchor installation

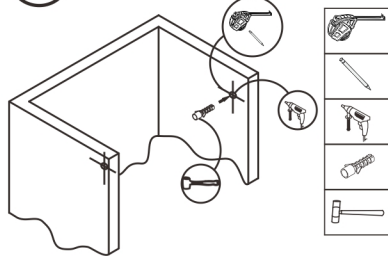

Mark the location of the header brackets and ensure they are level to avoid problems after installation. Drill the holes at a 30° on both sides and insert the bracket anchors.

### 2 Wall mounting bracket installation

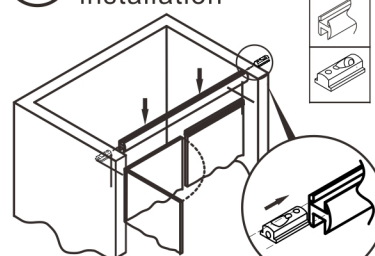

Slide the brackets into the header extrusion. For 12mm glass, simply press the extrusion down directly onto the fixed glass panel. For 10mm glass, see step 3.

### 3 10mm glass installation

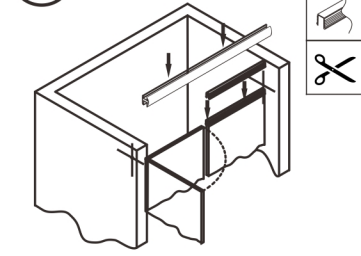

Cut the clear gasket to the desired length and install tightly onto the fixed glass panel then press the extrusion onto the panel.

### 4 Header extrusion installation

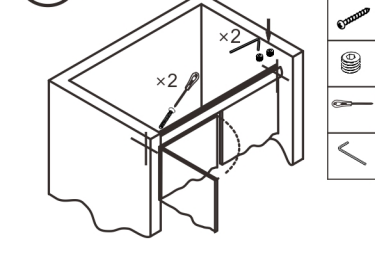

Finish installing the header by screwing in the mounting screws and assembly screws.

### 5 Snap-In filler insert installation

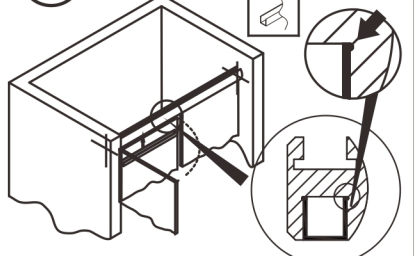

Measure the open channel space above the door. Cut and install the Snap-In filler insert into the header extrusion.