

Uncontrolled Document
For Reference Only

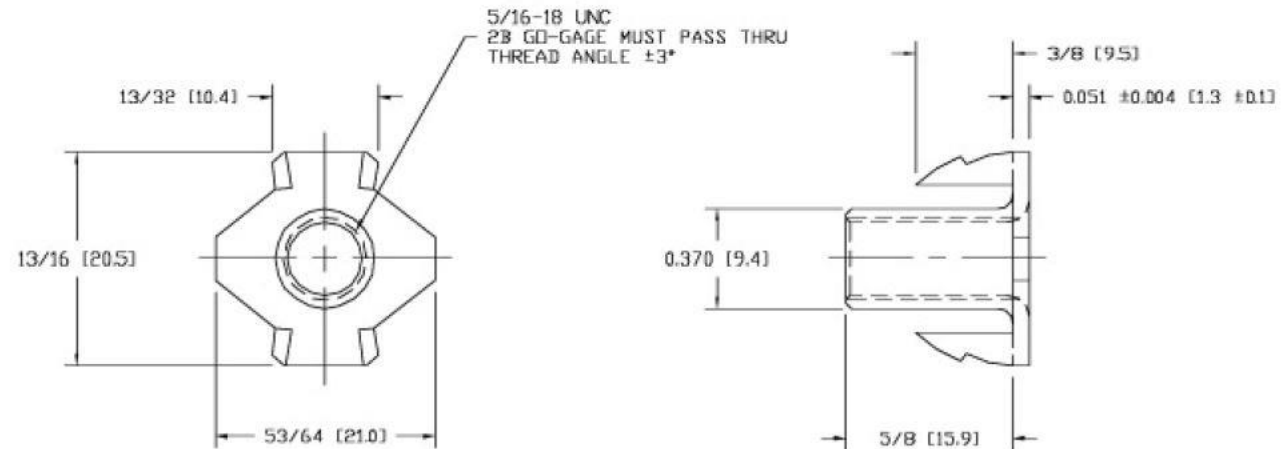

NOTES:

FLANGE RADIUS = MATERIAL THICKNESS ± 0.020
 MUST PASS THRU SLIDE GAGE
 MAXIMUM TORQUE = 100 in-lbs [114 cm-kg]
 DIMENSIONED IN INCHES [mm]

REVISIONS	TOLERANCES UNLESS NOTED
	DECIMALS: ± 0.015 [0.4] FRACTIONS: $\pm 1/32$ [0.8]
MAT'L: 1006 - 1008 CRS	