

Innovation - Innovation - Innovation - Innovation - Innovation - Innovation - Innovation - Innovation - Innovation

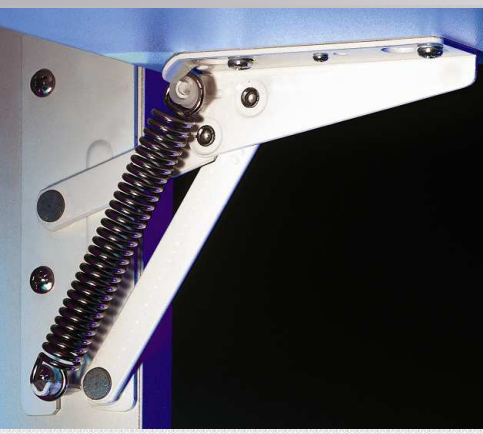

542L30 – Left flap fitting

The new 542X30 flap fittings provide hinging and support function all-in-one solution. Thus, no concealed hinges are necessary on the top panel. Based on spring technology, this series combines flexibility and durability.

The new 542X30 flap fitting pair features two variable opening angles 75° and 90° and are suitable for wooden flaps. Their installation is very easy and fitting is maintenance free

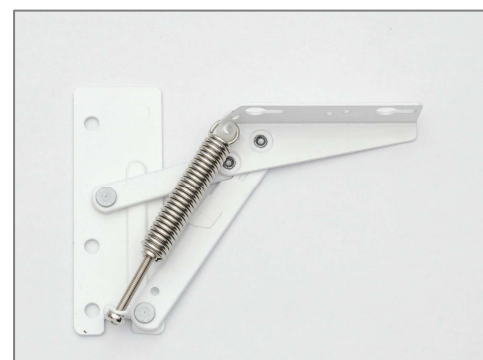

542R30 - Right flap fitting

Product benefits

- Adjustable springs
- Variable opening angles: 75° or 90°
- Perfect access to the inside of the cabinet
- Convenient for wooden flaps
- No concealed hinges in the top panel
- Two-in-one solution: hinging and support function
- 32 mm hole spacing system
- Comes in a white epoxy finish
- Excellent running properties due to maintenance-free plastic bearings
- Height adjustment of the flap due to oblong holes

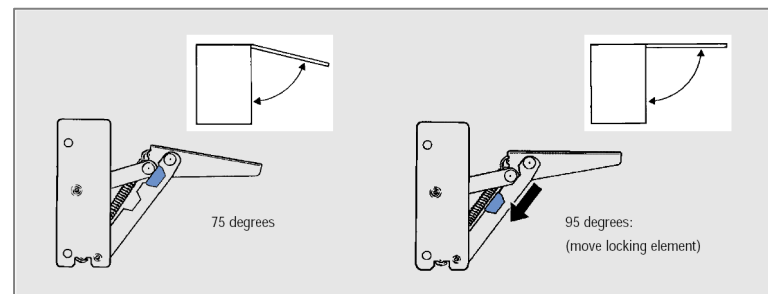

One fitting - two opening angles

Packaging

Can be ordered individually

Order Information

542R30 Adjustable spring hinge – Right - white

542L30 Adjustable spring hinge – Left - white

Mounting and installation information

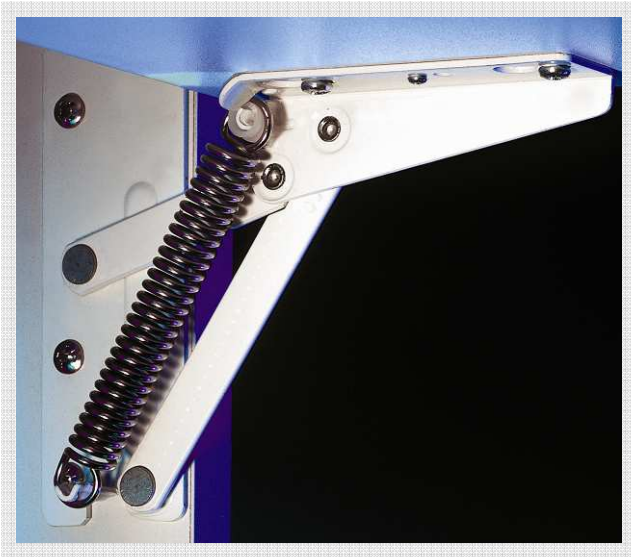

Fixture on cabinet side:

Euro screws: 6.3 x 10.5 mm

Or: 6.3 x 13.5 mm

4 mm chipboard screws

Fixture flap side:

4 mm chipboard screws

Side Wall

(Mounting with Euro Screws)

Wooden flaps

