

OPLA' FOLDING

- OPLA' FOLDING- 4117781010 for 450 - 900 mm module (18" à 36")
Pour caisson de 450 à 900mm (18" à 36")



OPLA' FOLDING WHAT'S IN THE BOX?

Pièces incluses

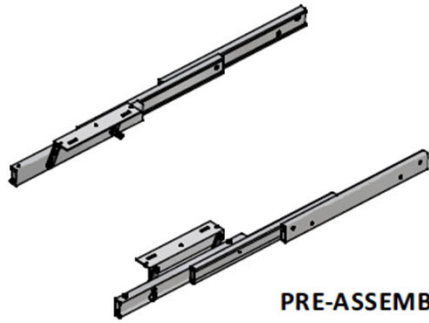

PRE-ASSEMBLED SLIDES
COULISSES PRÉ-ASSEMBLÉES

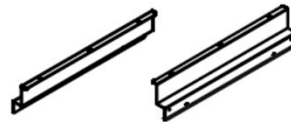

BRACKETS
SUPPORTS LATÉRAUX



F- ALU ROD
**to cut to size:
see page 3 for more details*
BARRE EN ALUMINIUM
*À couper sur mesure, voir page 3
pour les détails*

HARDWARE SET

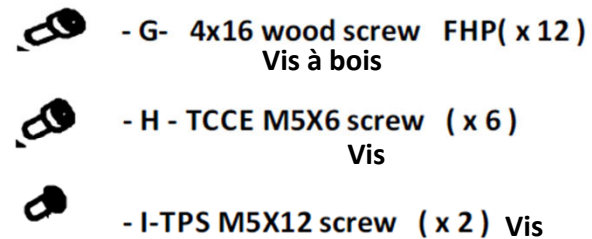
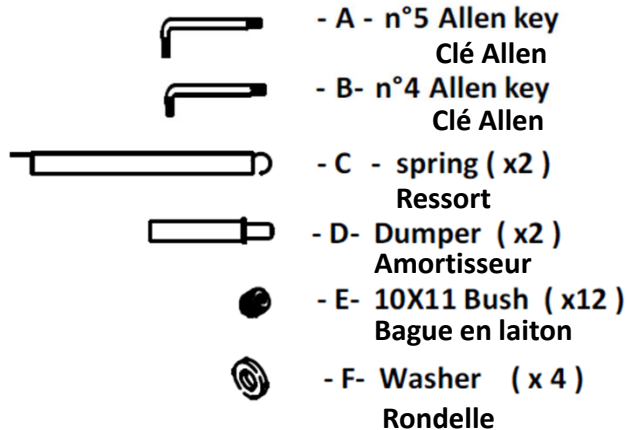

**screw to install the Alu rod
Vis pour fixer la barre en aluminium*

REQUIRED DIMENSIONS & DETAILS / DIMENSIONS REQUISES ET DÉTAILS

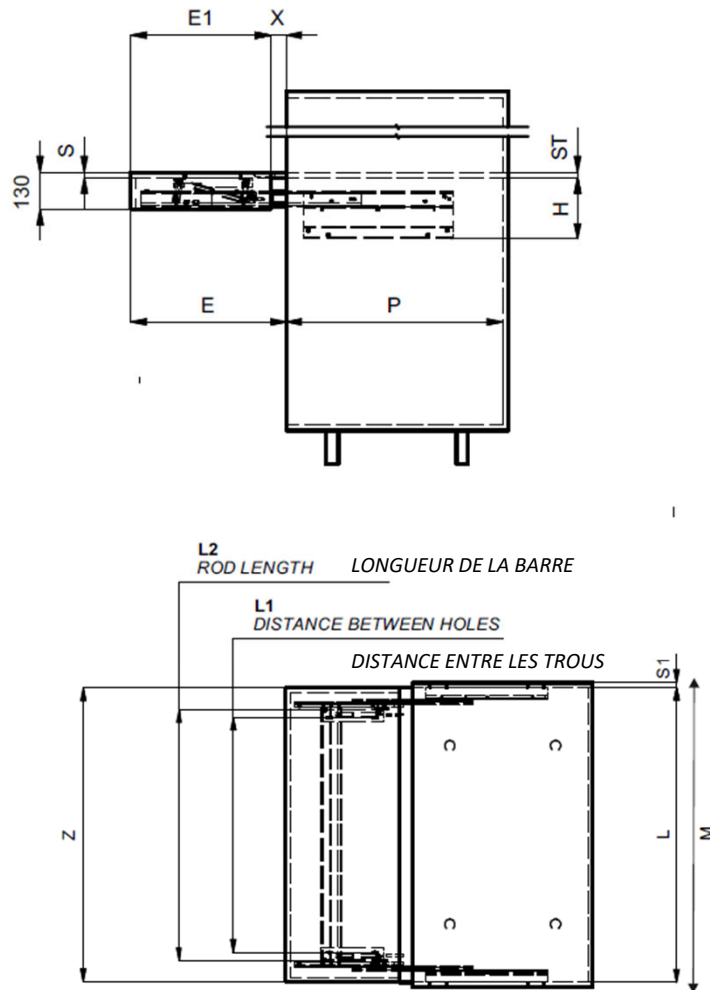

*Load capacity : 60 kg (132 lbs) evenly distributed
Capacité de poids : 60 kg (132 lbs) également distribué*

SPECIFICATIONS	SYMBOL	DIMENSIONS
HEIGHT / HAUTEUR	H	Min. 220mm (8 21/32")
DEOT / PROFONDEUR	P	Min. 540mm (21 1/4")
EXTERNAL CABINET WIDTH / LARGEUR EXTÉRIEURE DU CAISSON	M	Min, 450 Max. 914mm (Min. 17 3/4 -Max. 36")
INTERNAL WIDTH / LARGEUR INTÉRIEURE	L	M - (S1 x 2)
TOP & SIDE THICKNESS / ÉPAISSEUR DU DESSUS ET CÔTÉS	S	18 /22mm (45/64" - 55/64")
SIDE GABLE THICKNESS / ÉPAISSEUR DES PANNEAUX LATÉRAUX	S1	16 - 19mm (5/8" - 3/4")
COUNTERTOP THICKNESS / ÉPAISSEUR DU DESSUS	ST	15 / 35mm (19/32" - 1 3/8")
TOP WIDTH / LARGEUR DU DESSUS	Z	L - 5
PROTRUSION / ESPACEMENT	X	N/A
EXTENSION / EXTENSION	E	500mm (19 11/16")
TOP LENGTH / LONGUEUR DU DESSUS	E1	E - X
DISTANCE BGETWEEN 2 HOLES FOR TOP FIXING/ DISTANCE ENTRE LES TROUS POUR LA FIXATION DU DESSUS	L1	L -236.5mm (9 5/16")
ALU ROD LENGTH (CUT TO SIZE) / LONGUEUR DE LA BARRE (À COUPER SUR MESURE)	L2	L - 172mm (6 25/32")

HOW TO BUILD OPLA TOP AND SIDES

COMMENT FABRIQUER LE DESSUS ET LES CÔTÉS

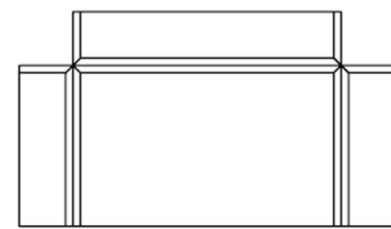
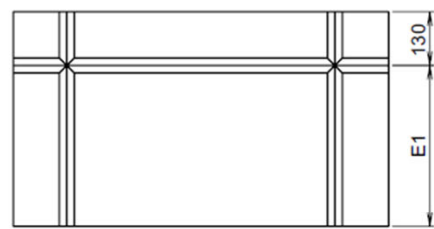
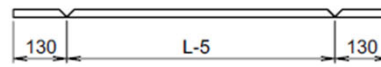
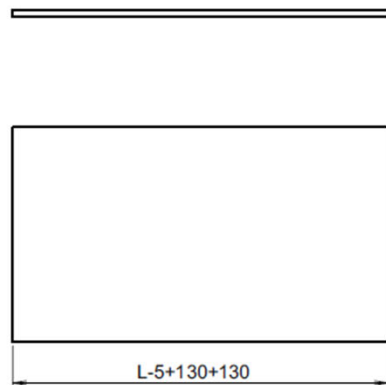

*** wood top not included

*** La surface de bois n'est pas incluse

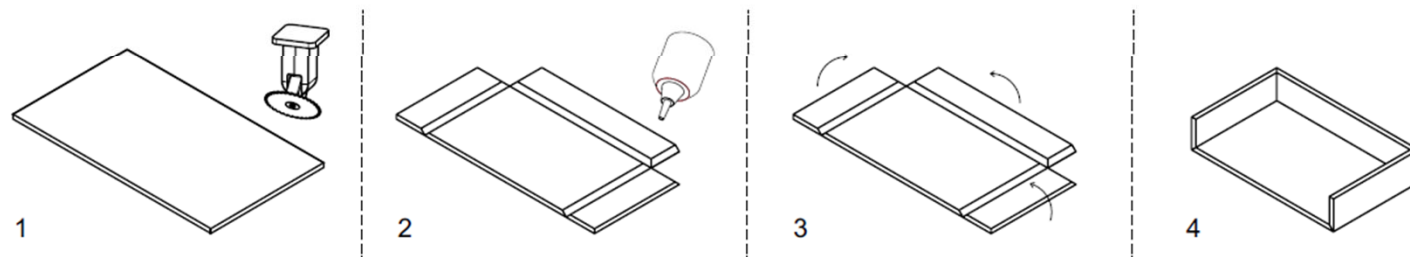

HOLES POSITION

POSITIONS DES TROUS

To fix the mechanism on the sides
/ Fixation du mécanisme sur les côtés

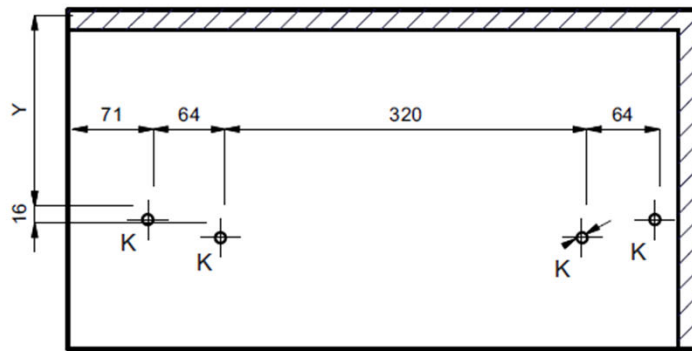

$$Y = 168\text{mm} + (S - ST)$$

K = holes of 10mm Dia. 10mm depth

trous de 10mm de dia. 10mm de profondeur

Predrilling Holes (J) for the Damper pistons (D) /
Trous de perçage (J) pour amortisseurs (D)

Top holes
/ Trous du dessus

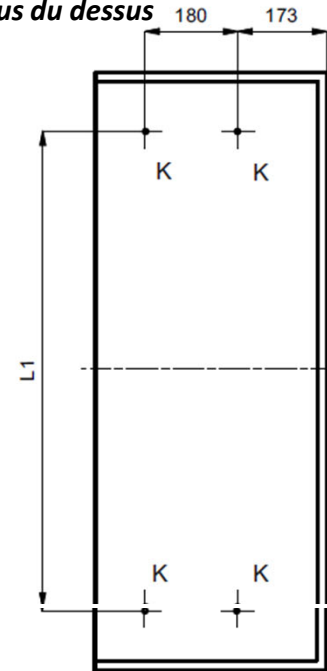

K = holes of 10mm dia. 10mm depth

trous de 10mm de dia. 10mm de profondeur

Back edge of surface panel /
Rebord à l'arrière de la surface

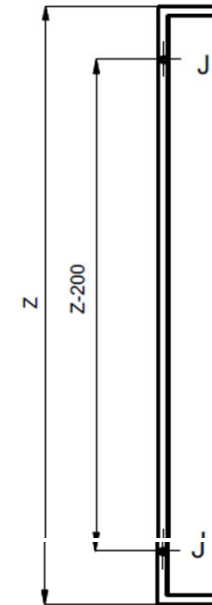

J = Holes of 10mm dia. 51mm depth
 Hole edge 12mm dia. 1mm depth /
 Trous de 10mm dia. 51mm profondeur
 Partie basse 12mm dia. 1mm profondeur

Side View
/ Vue de côté

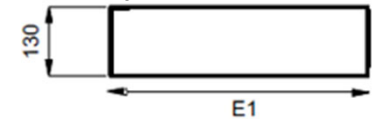

MOUNTING OF THE MECHANISM ON THE CABINET / MONTAGE DU MÉCANISME SUR LE CAISSON

1.

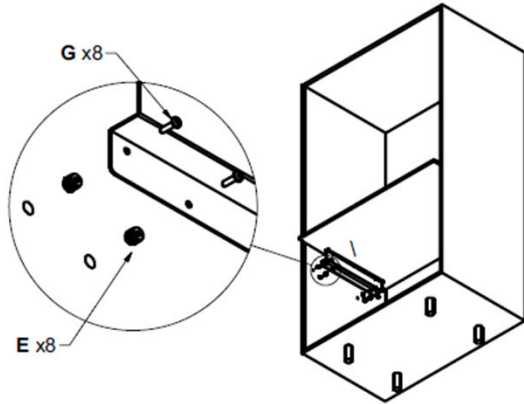

2.

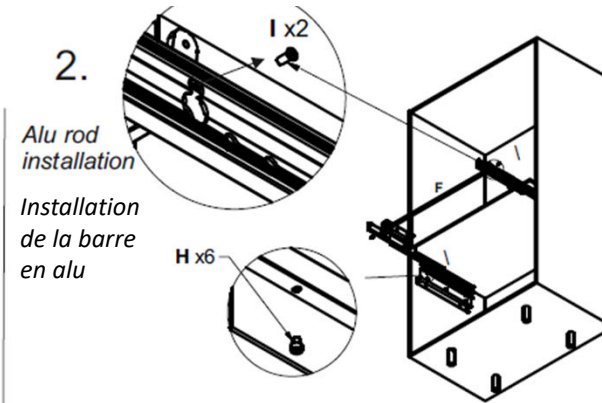

3.

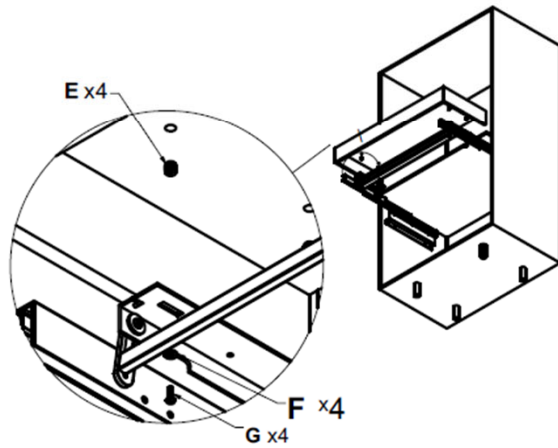

4.

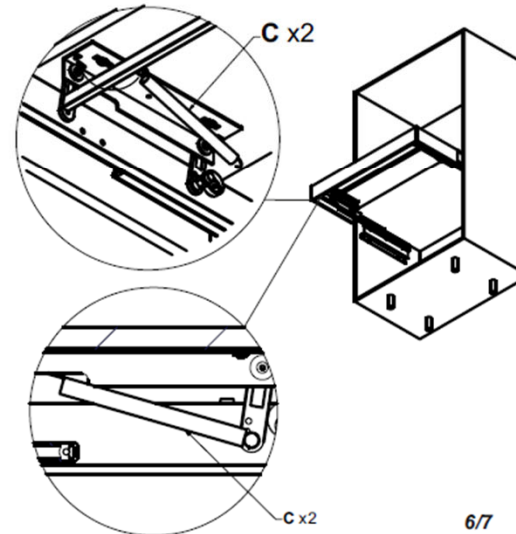

TOP ADJUSTMENT

AJUSTEMENT DU DESSUS

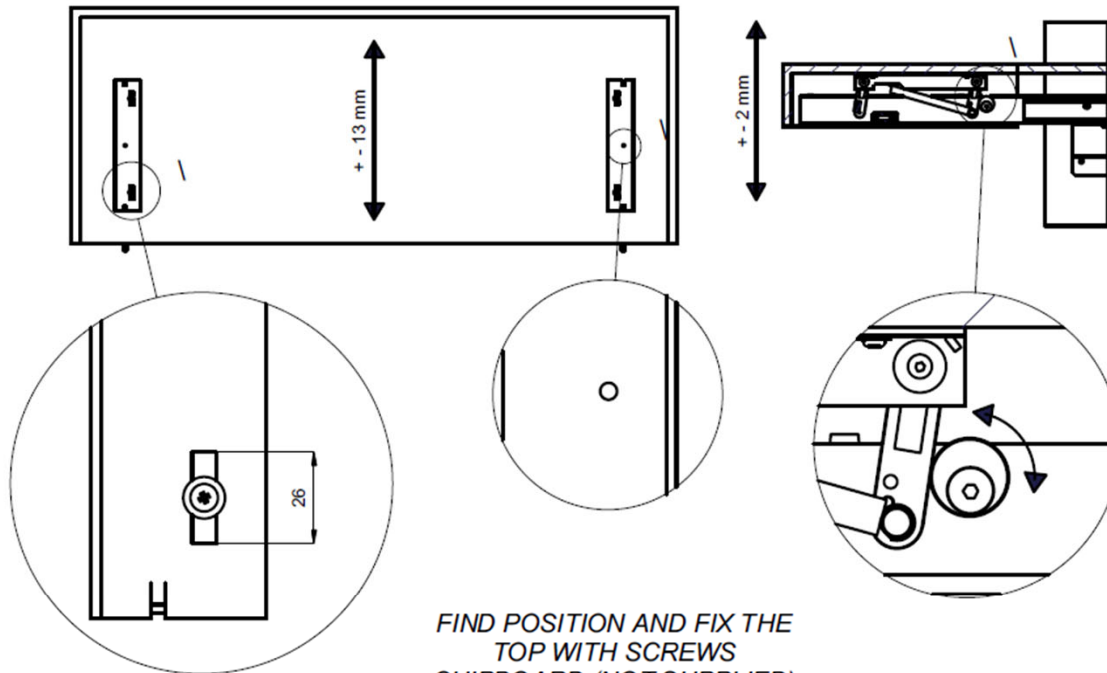

*FIND POSITION AND FIX THE
TOP WITH SCREWS
CHIPBOARD (NOT SUPPLIED)*

*TROUVEZ LA POSITION ET FIXEZ LE
DESSUS AVEC DES VIS À PANNEAUX
DE PARTICULE (NON INCLUSES)*