

CASTOR LED

CUTTABLE WARDROBE BAR

ILLUMINATE
IN STYLE

Customize the rod length to your needs



ADVANTAGES AND BENEFITS

- Dimmable LED closet rod with optional motion sensor
- Length can be adjusted by simply cutting the profile, diffuser and tape light every 1/2" (12.8 mm)
- Pre-wired bracket with 72" (1829 mm) Micro24 power cable
- Quick installation using side brackets and middle support
- PIR motion sensor, auto on/off, has a detection area about 39" (100 cm) outward and 63" (160 cm) wide
- Wardrobe bar available without sensor to use an alternate switch option, such as the BTRF switch or Xdriver and IR-XD Proximity Sensor

Proximity motion sensor



Available without sensor to use an alternate switch option

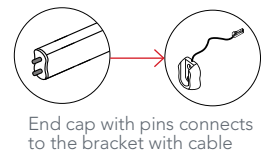
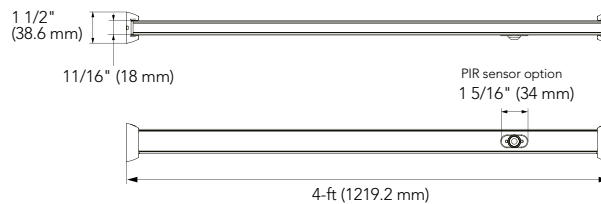

End cap with pins connects to the bracket with cable



TECHNICAL SPECS

- Weight capacity: 13.4 lb/ft (20 kg/m)
- Luminous efficiency: 65 lm/W
- Luminous flux (lumens): 624 lm
- Product (L x H x D): 4 ft x 1 3/16" x 11/16" (1219.2 x 30 x 18 mm)

No.	PIR sensor	Watts	Color temperature (K)	Finish
L002P1221219174	Yes	12 W	3000 warm white	Chrome
L002P1221219184	Yes	12 W	3000 warm white	Aluminum
L002P1221219900	Yes	12 W	3000 warm white	Black
L0021221219174	No	12 W	3000 warm white	Chrome
L0021221219184	No	12 W	3000 warm white	Aluminum
L0021221219900	No	12 W	3000 warm white	Black

Includes: closet rod LED, mounting bracket, bracket with wire, middle supporter, end cap and fasteners.

