

GIROTONDO

ITEM # 8625I3GA-8625I3GB-8625I3GC-8625I3GD-8625I3GE

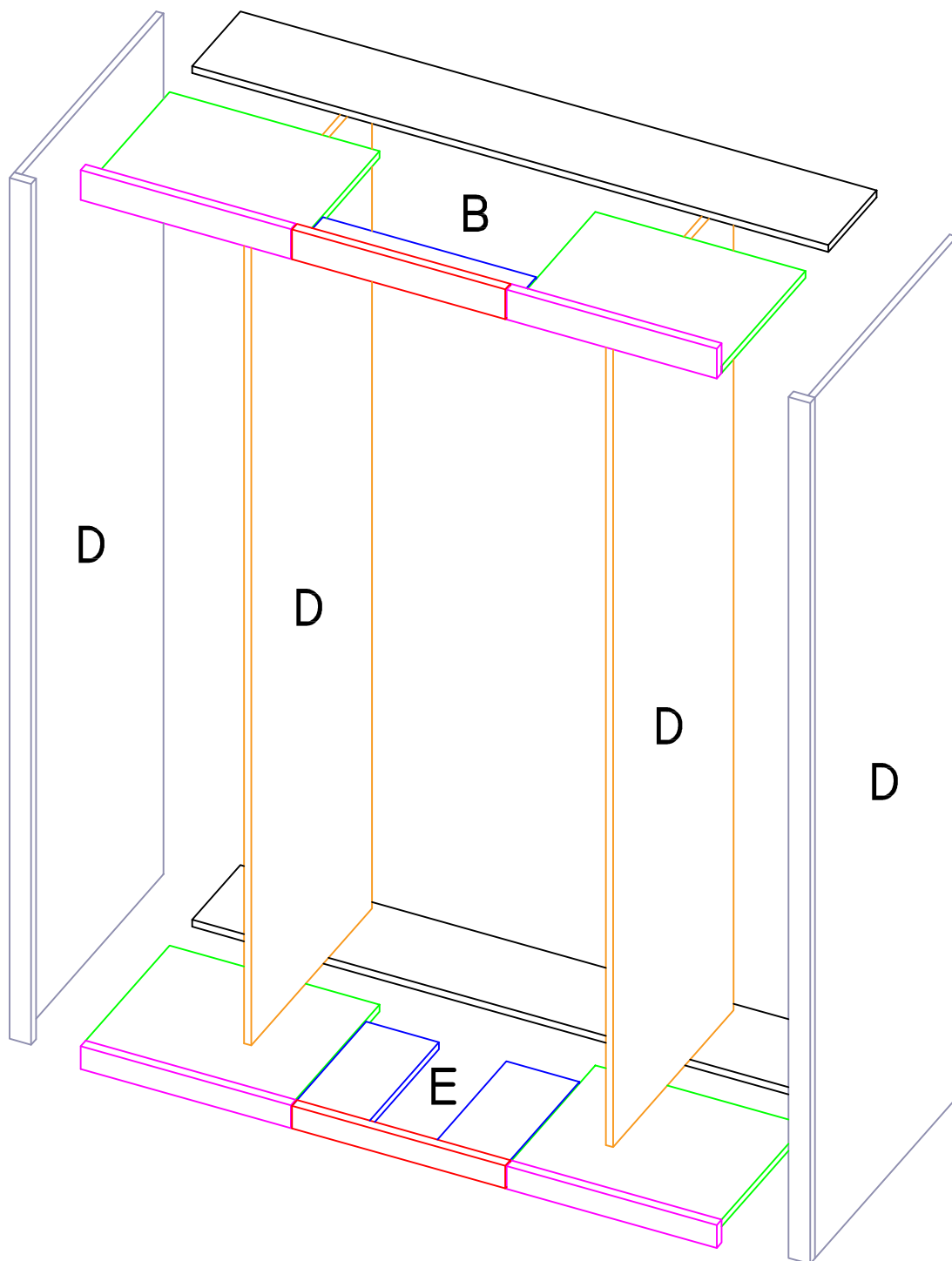

WOOD PANEL HOLES & POSITION REFERRED TO ART. 862513GC

THE DEPTH INCLUDES:
DOOR AND BACK PANEL

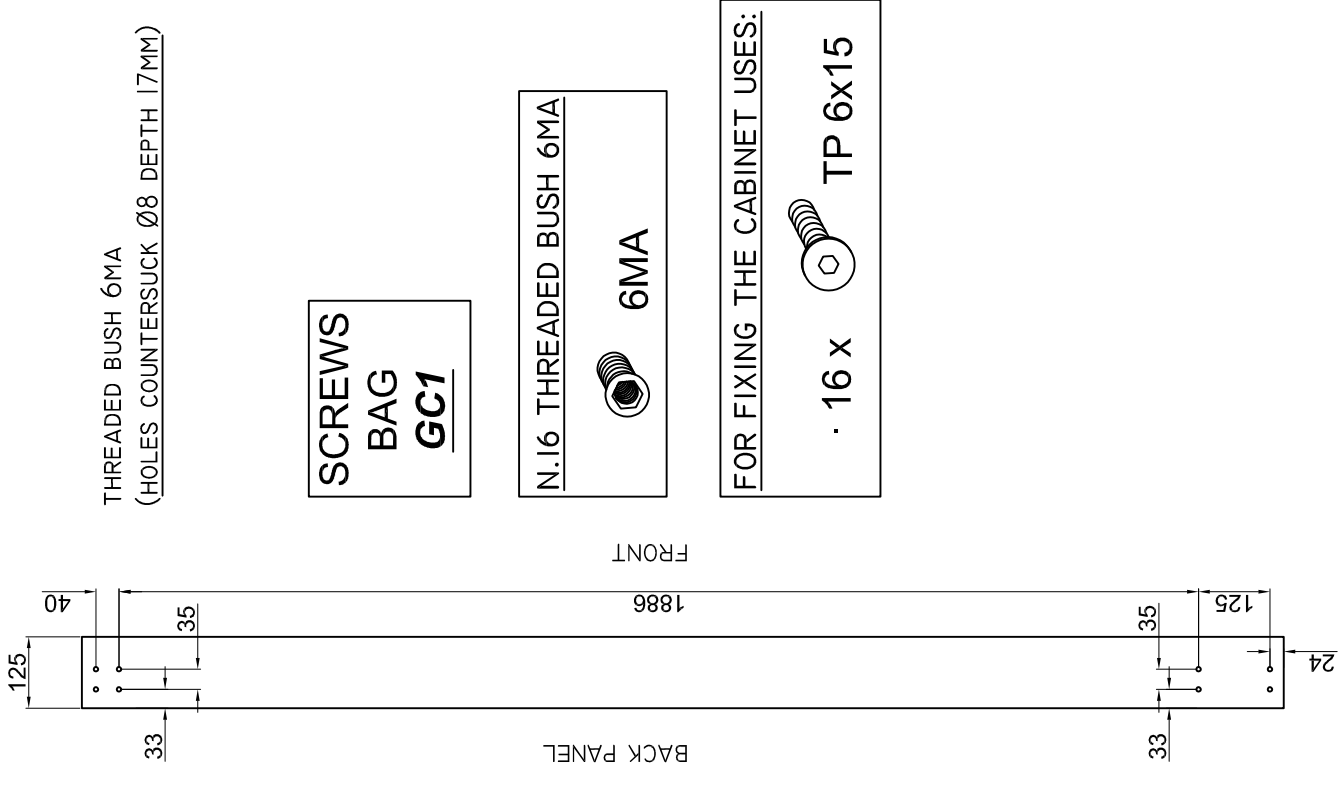
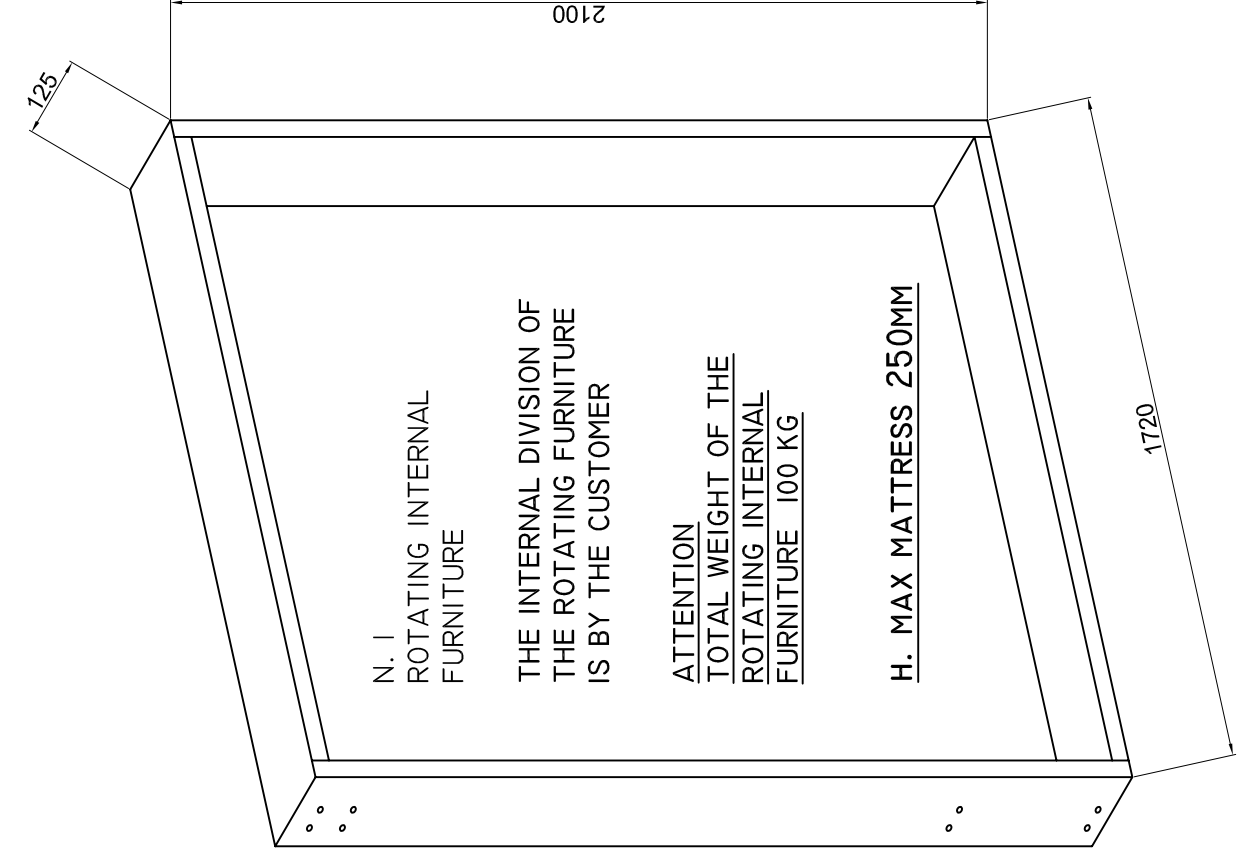

ART. 8625I3GB

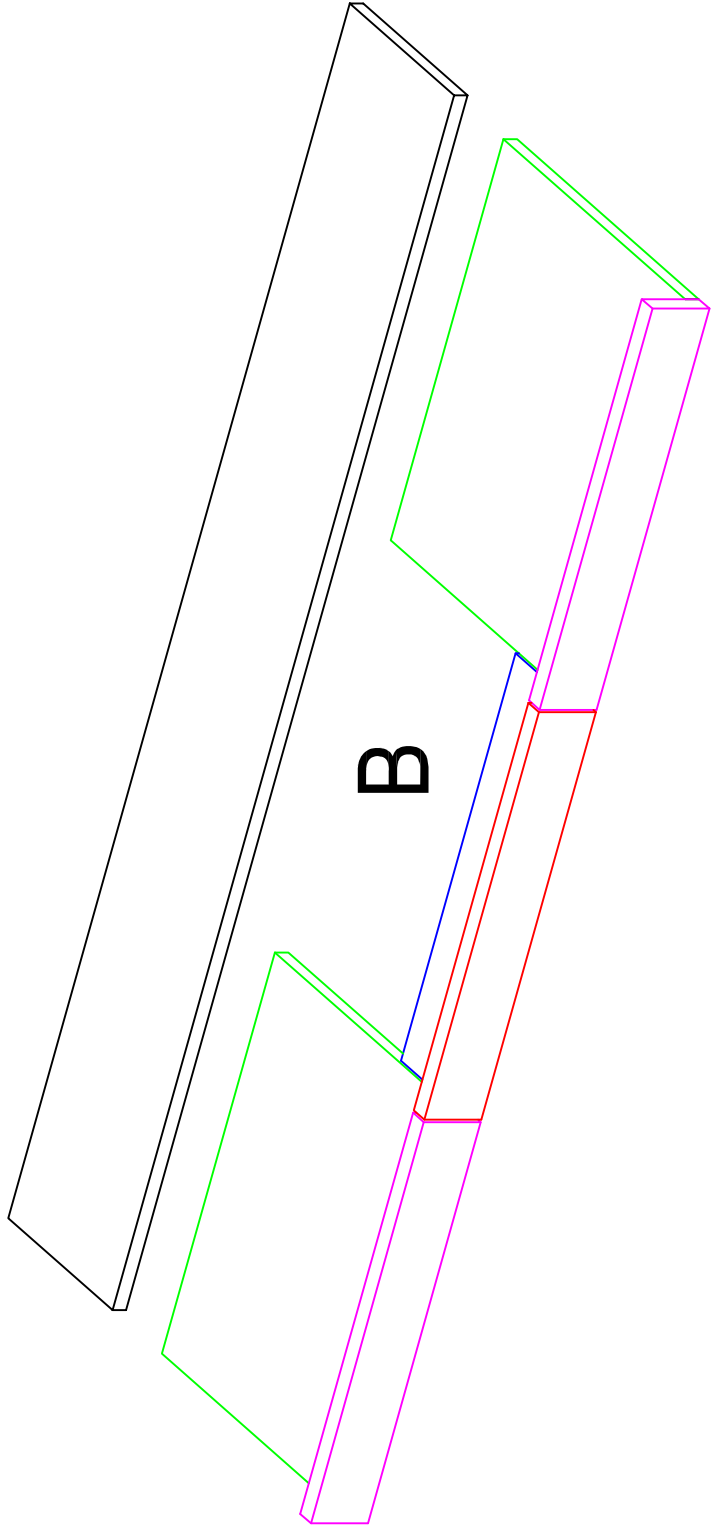

EXAMPLE OF FIXING SYSTEM:

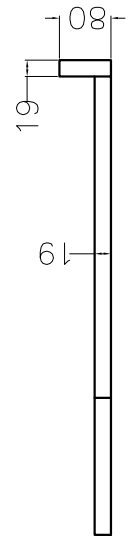
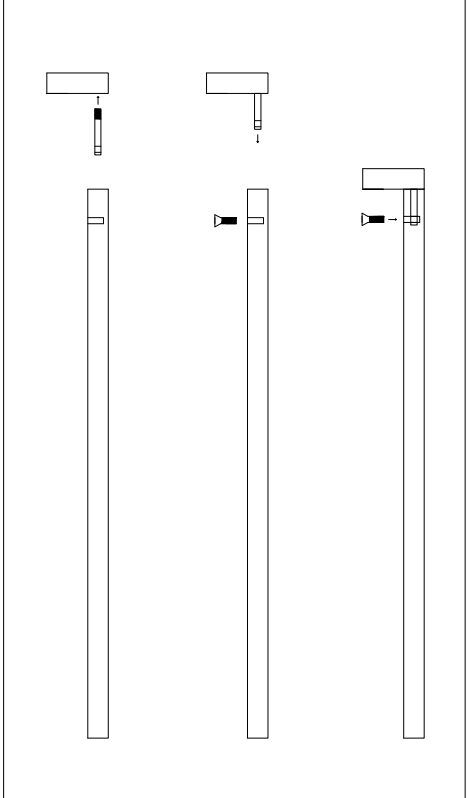

WOOD PANEL HOLES & POSITION REFERRED TO ART. 8625I3GB

(REF. B ON PAGE I)

N.1 PIECE 1771X195X19

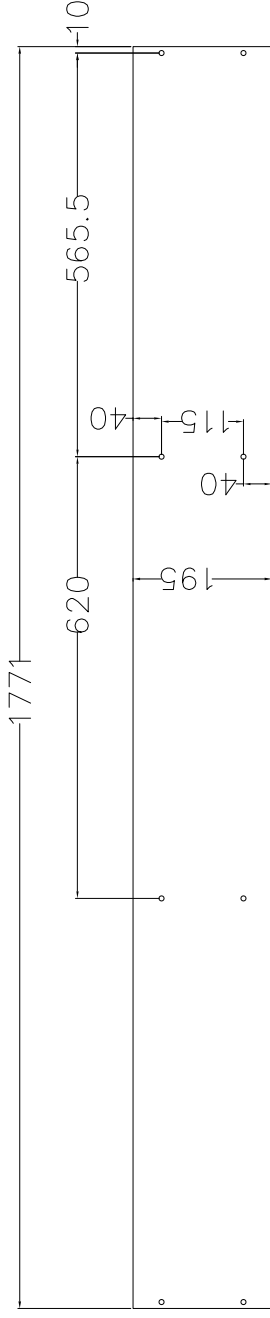

HOLES Ø8,5MM

N.2 PIECES 585.5X340X19

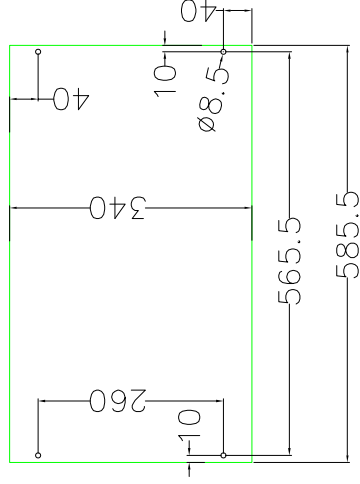

HOLES Ø8,5MM

+

N.2 PIECES 585.5X80X19

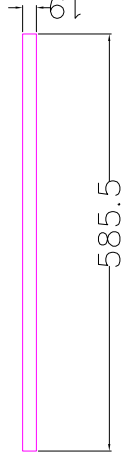

N.1 PIECE 594X110X19

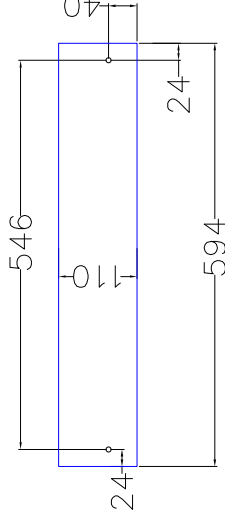

N.1 PIECE 594X80X19

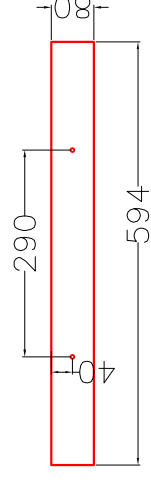
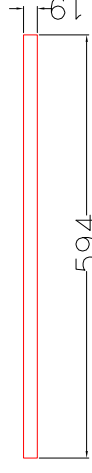

THREADED BUSH 6MA
(HOLES COUNTERSUCK
Ø8 DEPTH 17MM)

FOR FIXING THE PANEL USES:

SCREWS
BAG
GB1

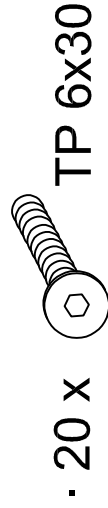

· 20 x TP 6x30

N.2 THREADED BUSH 6MA



6MA

ART. 8625I3GE

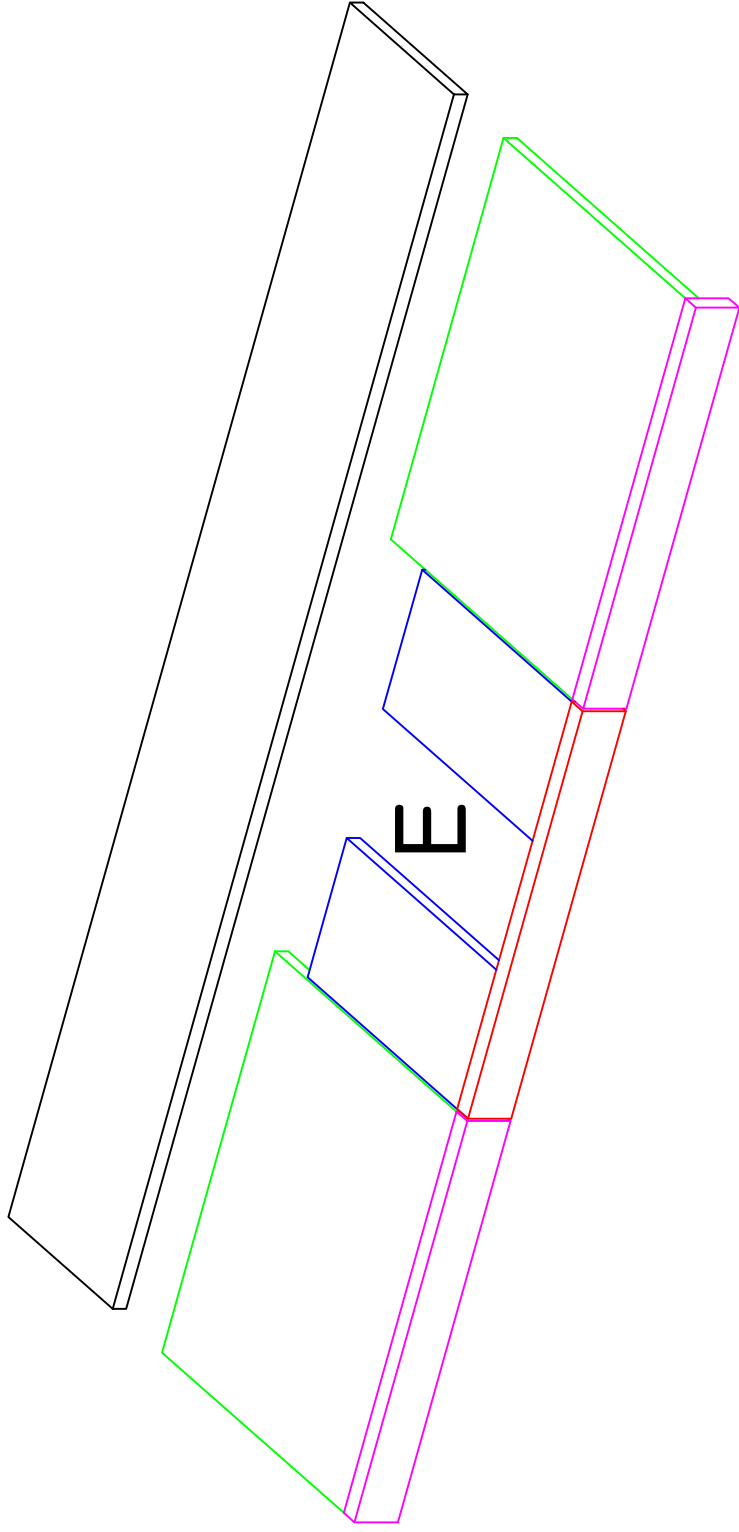

EXAMPLE OF FIXING SYSTEM

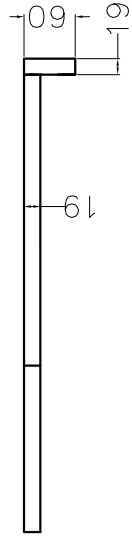
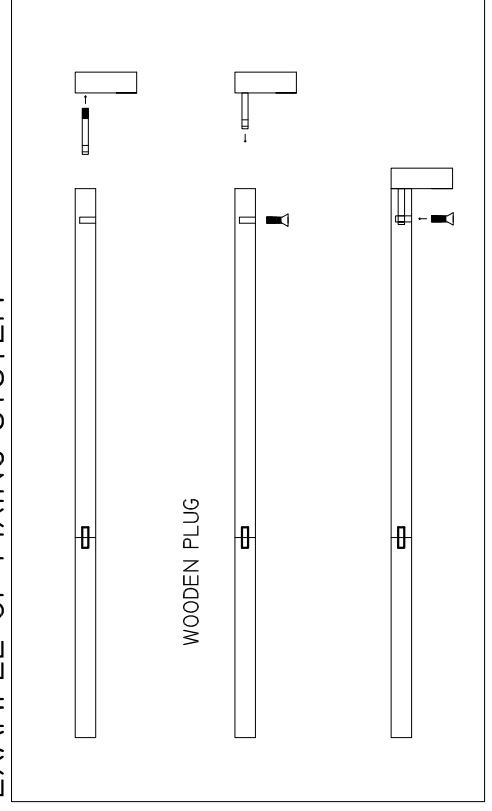

N.1 PIECE 1771x195x19

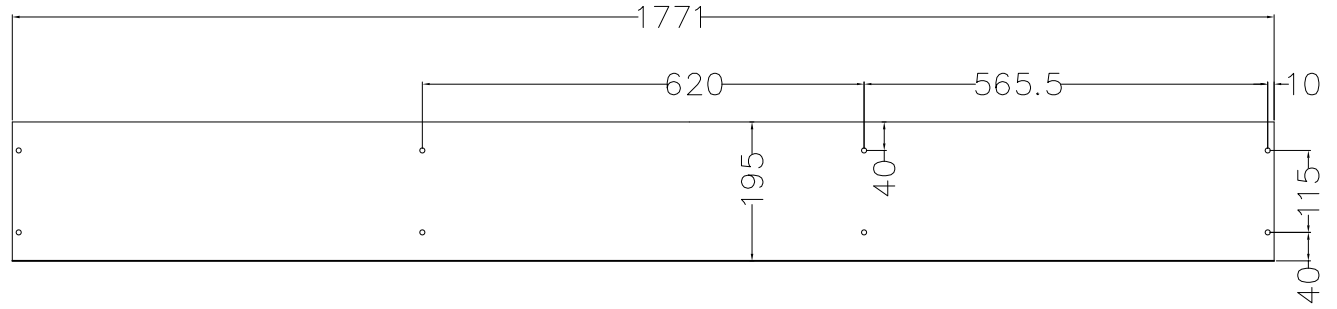

HOLES Ø8,5MM

N.2 PIECES 585.5x340x19

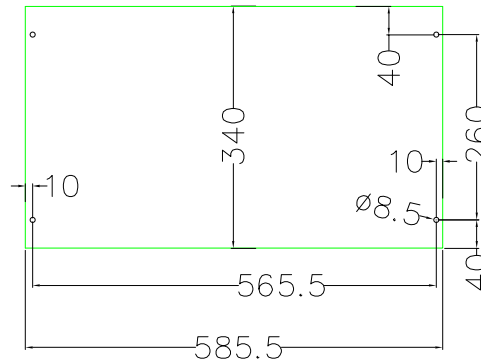

HOLES Ø8,5MM

N.2 PIECES 585.5x60x19

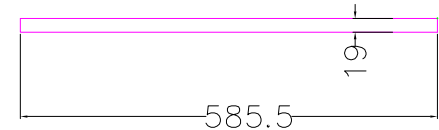

+

N.2 PIECE 203x280x19

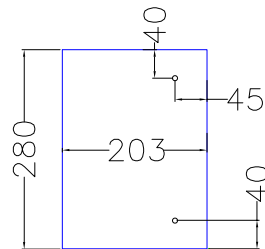

N.1 PIECE 594x60x19

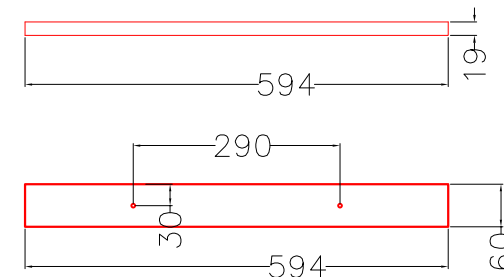

THREADED BUSH 6MA
(HOLES COUNTERSUCK
Ø8 DEPTH 17MM)

SCREWS
BAG
GE1

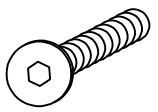
FOR FIXING THE PANEL USES:
• 20 x  TP 6x30

N.2 THREADED BUSH 6MA  6MA

ART. 862513GD

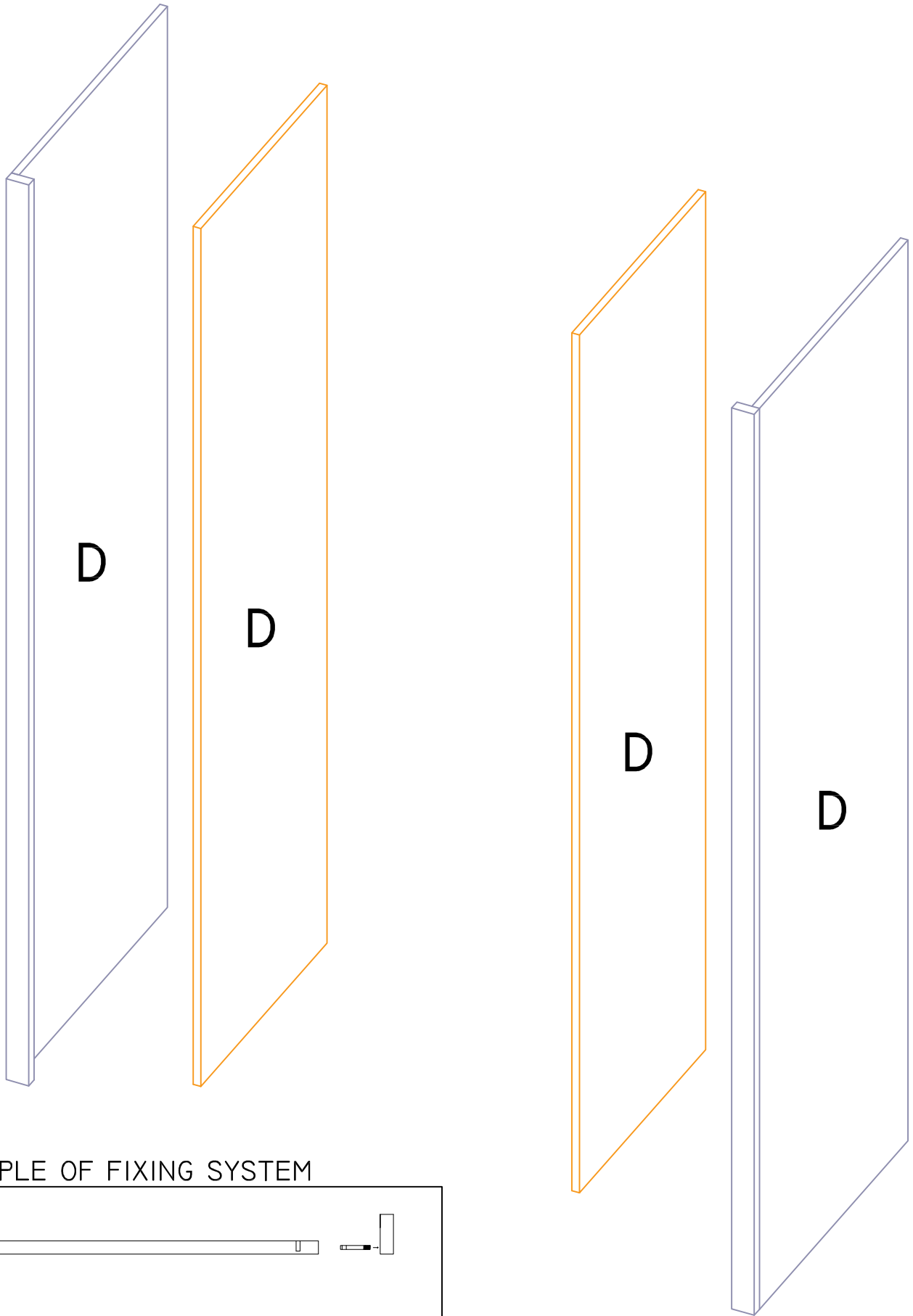

EXAMPLE OF FIXING SYSTEM

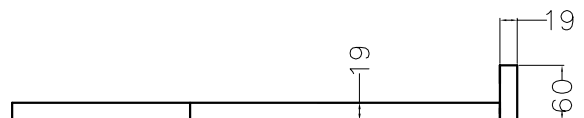
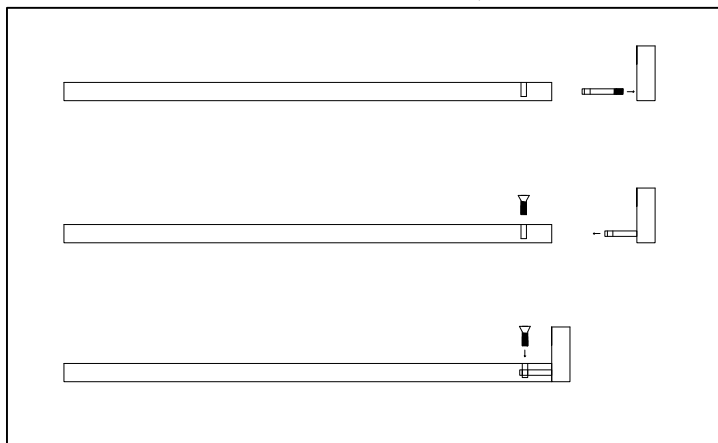

WOOD PANEL HOLES & POSITION REFERRED TO ART. 862513GD
(REF. D ON PAGE I)

INTERNAL PANEL

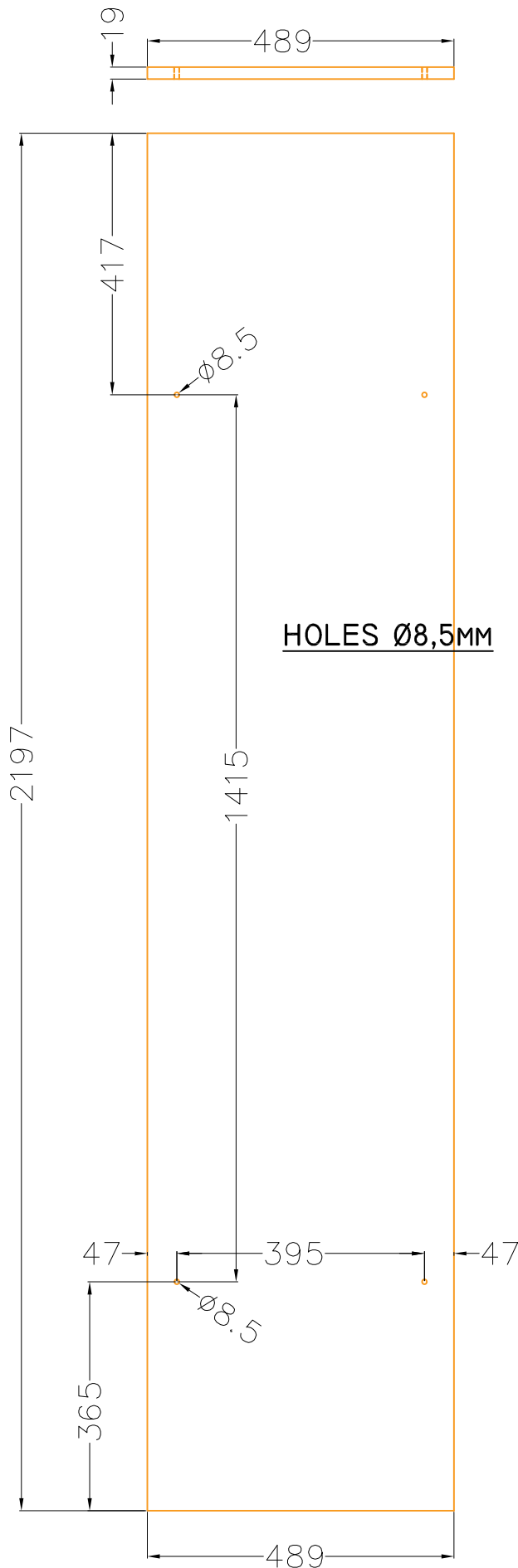

HOLES $\varnothing 8,5$ MM

SCREWS
BAG
GD1

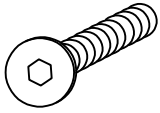
FOR FIXING THE PANEL USES:
· 8 x  TP 6x30

WOOD PANEL HOLES & POSITION REFERRED TO ART. 862513GD

(REF. D ON PAGE I)

EXTERNAL PANEL (RIGHT AND LEFT)

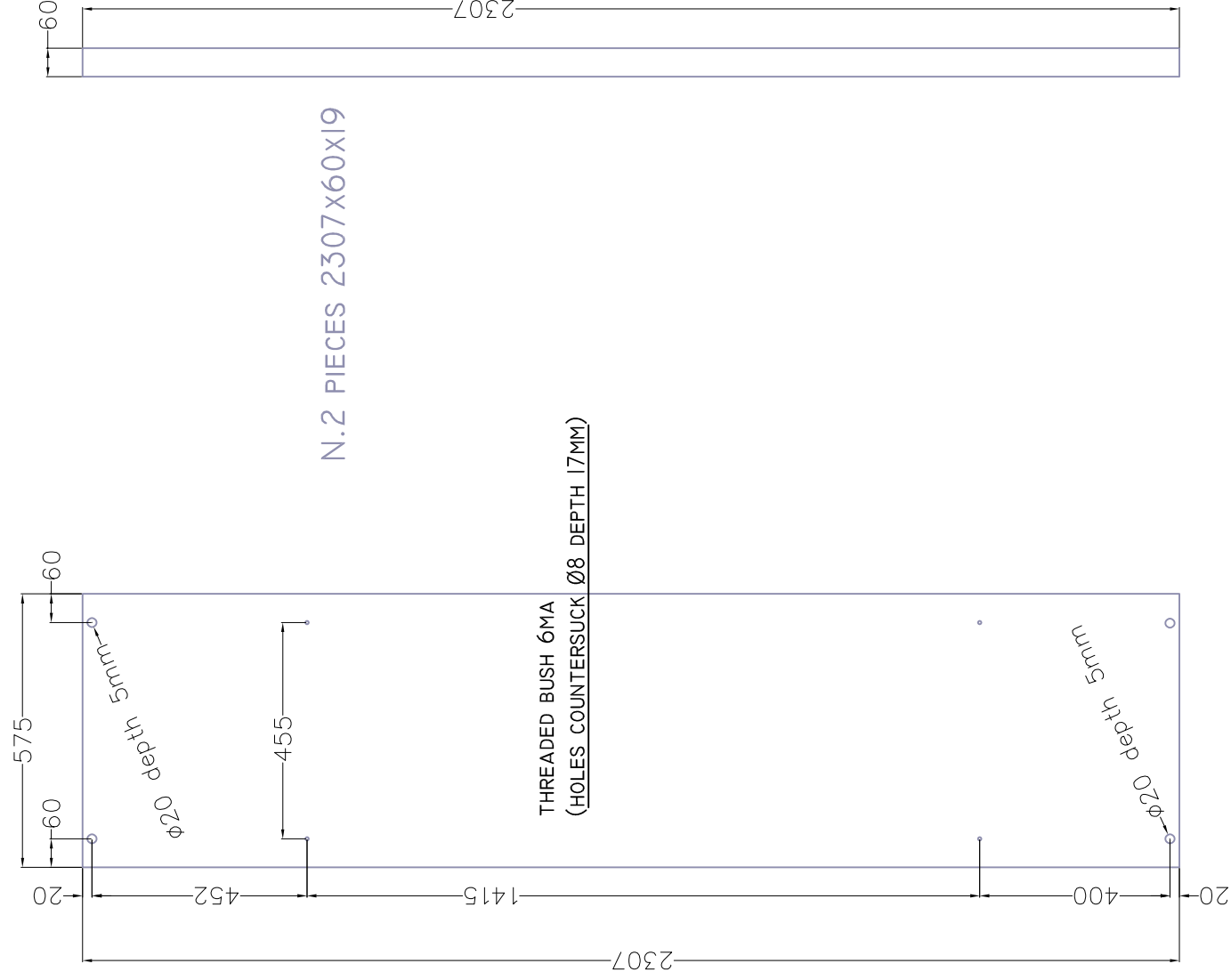

N.2 PIECES 2307X575X19

N.2 PIECES 2307X60X19

SCREWS
BAG
GD1

N.4 THREADED BUSH 6MA
PANEL RIGHT
+
N.4 THREADED BUSH 6MA
PANEL LEFT



6MA

FOR FIXING THE PANEL USES:

· 8 x  TP 6x30