

# LATERAL OPENING DOOR SYSTEMS

# LIN-X800

SLIDING & FOLDING DOOR HARDWARE

LATERAL OPENING DOOR SYSTEM



- **Lateral Opening Mechanism:** Allows doors to swing out laterally in a small radius, ideal for tight front space application.
- **4-Way Adjustable:** Vertical, horizontal, depth and parallel adjustment.
- **Smooth Movement:** Built-in dampers provide a smooth soft-closing movement.
- **Use in various applications:** Ideal for closet entryways, large pantry doors, storage, hidden rooms, etc. Can also be used on L shaped corner spaces.
- **Hardware is non-handed:** can be used for left- or right-opening doors.
- **Designed for overlay installation,** but can be installed flush with the surrounding cabinet or wall. Please contact customer service for details on inset installations.



Minimize opening clearance required with LIN-X800, compared to traditional swinging doors. When closed, the LIN-X door can be flush with the surrounding walls.

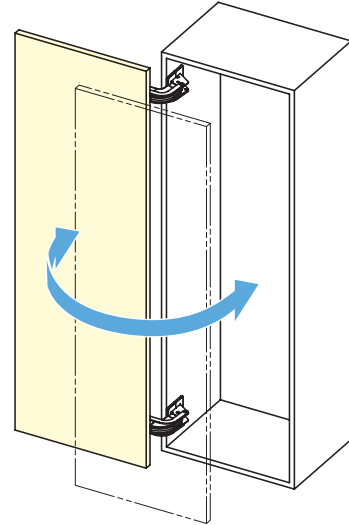
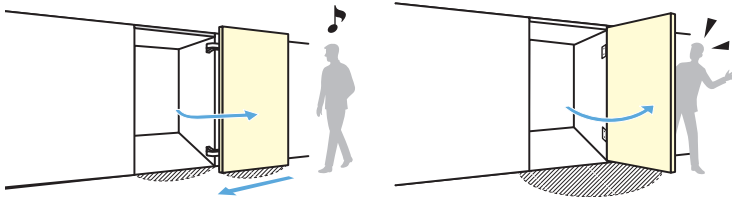

### Installation Examples

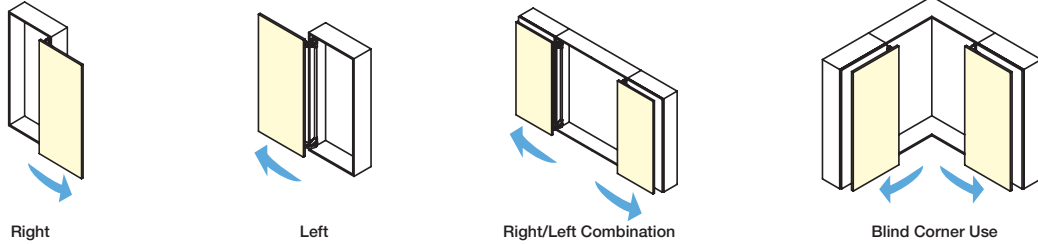

### Adjustability

Adjustable in vertical, horizontal, depth and parallel directions.

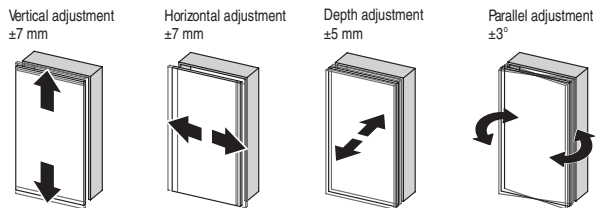

|                  | LIN-X800                     | LIN-X800H          |
|------------------|------------------------------|--------------------|
| Door Width       | 750~850mm (29-1/2"~33-7/16") |                    |
| Max. Door Height | 2400mm (94-1/2")             | 2980mm (117-5/16") |
| Door Thickness   | 24~40mm (15/16"~1-9/16")     |                    |
| Max. Door Weight | 40kg/door (88lbs/door)       |                    |

| Item No.       | Material        | Weight (kg)    | Finish |
|----------------|-----------------|----------------|--------|
| LIN-X800-WT-S  | Steel, Aluminum | 18kg (40lbs)   | White  |
| LIN-X800-BL-S  |                 |                | Black  |
| LIN-X800H-WT-S |                 | 18.7kg (44lbs) | White  |
| LIN-X800H-BL-S |                 |                | Black  |

| No. | Qty.   | Parts in Set                | Dimensions | Material   | No. | Qty.  | Parts in Set                | Dimensions | Material      |
|-----|--------|-----------------------------|------------|--|-----|-------|-----------------------------|------------|---------------|
| 1   | 1 each | Hinge A                     |            | Steel, Plastic (POM)<br>Finish: White, Matte Black | 2   | 4 pcs | Washer cover (hanging side) |            | Plastic (ABS) |
|     |        | Hinge B                     |            |  |     |       |                             |            |               |
|     |        | Washer cover (leading edge) |            |  |     |       |                             |            |               |
|     |        | Rod cover                   |            |  |     |       |                             |            |               |
| 5   | 1      | Connecting Rod              |            | Aluminium Alloy<br>Finish: Anodised: Black/silver  |     |       |                             |            |               |
|     |        |                             |            | Aluminium Alloy<br>Finish: Anodised: Black/silver  |     |       |                             |            |               |

Detailed Drawing

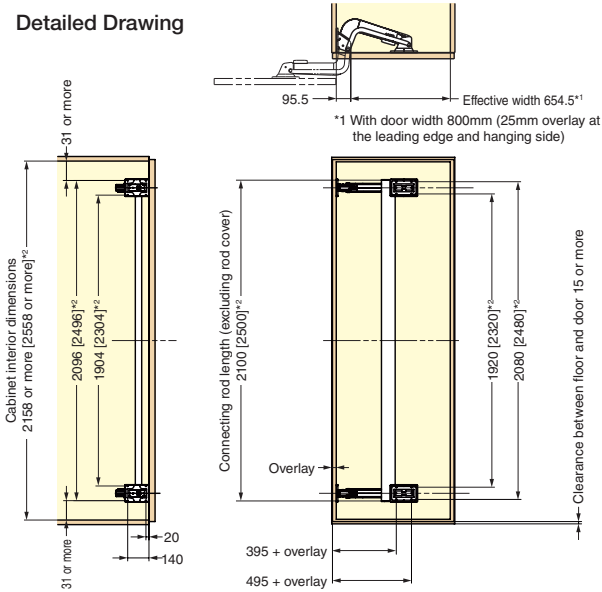

Range of Motion

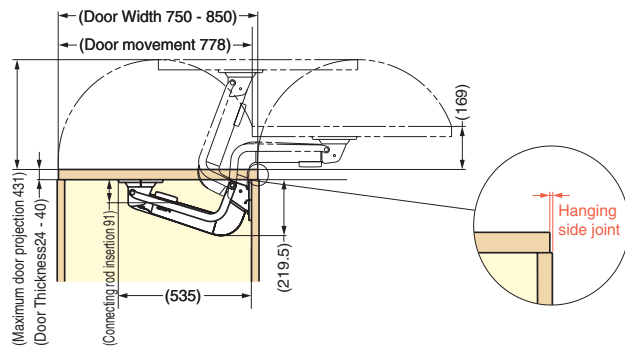

\*2 The dimensions in [ ] indicate LIN-X800H specifications.

\*2 For cabinet interior dimensions smaller than the minimum value, reduce the other dimensions marked with \*2 by an equivalent amount. The connecting rod must be cut by the customer.

Ideal for Walk-in closet, hidden shop storage, restaurant or ballroom bars as well as partition office doors.

