

ART.702

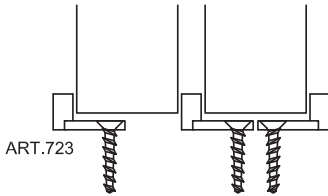

THE ART. 711 ALLOWS THE UTILIZATION OF DOORS WITH DIFFERENT THICKNESS FROM 15 MM. FOR THE PARTICLES STABLE TO THE TRACKS 710-711-720, IT IS POSSIBLE TO USE 23 SIDWAYS TO THE DOORS THUS AVOIDING MILLING.

L'ART. 711 PERMETTE SO DI ANTE A SPESORE ABILE A PARTIRE DA 15 MM. PER PARTICOLI ADATTI AI BINARII 710-711-720 È POSSIBILE UTILIZZARE 23 LATERALMENTE ALLE ANTE SENZA LA FRESA.

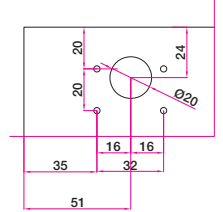
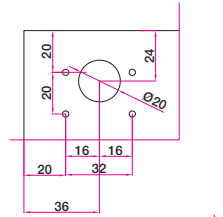
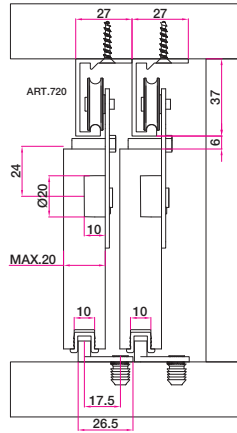
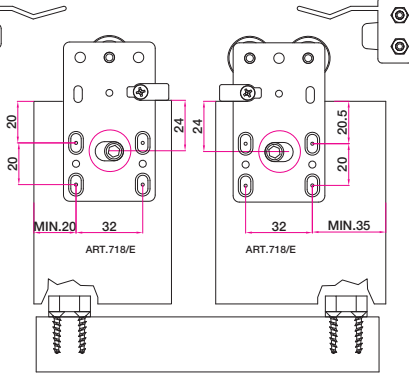