



Commercial and
Outdoor Kitchen
Heavy Duty SS
slides

Equipped with self-close and auto lock-in features

The Accuride ST8201 is the suitable solution for refrigerated drawers in food industrie, including, food preparation tables, warming and cooling drawers.

ADVANTAGES AND BENEFITS

- Bottom-mount slide
- Easy to install
- Stainless steel construction
- Full extension design (overtravel upon request)
- Operating temperature range:
-20 °C to + 80 °C (-4 °F to + 176 °F)
- Available in even lengths
16" to 30" (406.4 mm to 762 mm)
- Dishwasher safe
- NSF certified



NO
WELDING
REQUIRED

TECHNICAL SPECIFICATIONS

- Full extension slide
- Load capacity: 275 lb (124 kg)
- Finish: Stainless steel
- Slide mounting: Underneath
- Width: 15/16" 24.13 mm
- Height: 3" (76.2 mm)
- Motion Technology: Quick disconnect, retained in closed position



ST8201 SERIES FULL EXTENSION SLIDE

ST8201 SERIES SLIDE WITH STANDARD FLANGE

No.	Length
820117016SD	16" (406 mm)
820117018SD	18" (457 mm)
820117020SD	20" (508 mm)
820117022SD	22" (551 mm)
820117024SD	24" (601 mm)
820117026SD	26" (660 mm)
820117028SD	28" (711 mm)
820117030SD	30" (762 mm)

ST8201 SERIES SLIDE WITH EXTENDED FLANGE

No.	Length
820117016ED	16" (406 mm)
820117018ED	18" (457 mm)
820117020ED	20" (508 mm)
820117022ED	22" (551 mm)
820117024ED	24" (601 mm)
820117026ED	26" (660 mm)
820117028ED	28" (711 mm)
820117030ED	30" (762 mm)

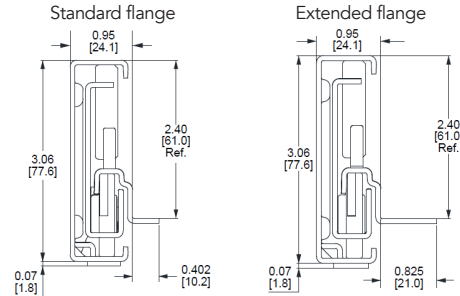

INSTALLATION

Before starting the installation process, the slides must be disassembled into the individual three members. Extend the slide members and follow the steps as shown in Figure 5.

DRAWER MEMBER MOUNTING

To install the drawer member, use #8 undercut flathead screws. The use of all the mounting holes is recommended to ensure maximum load capacity. See Figure 1.

FIGURE 1

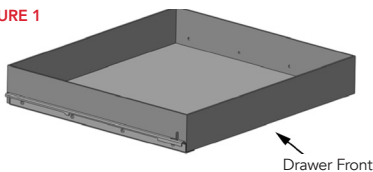

CABINET MEMBER MOUNTING

Align the cabinet member (outer member) at the proper height so that the drawer can be inserted with no interference. Install the cabinet member using #10 hex screws, and ensure slides are parallel. See Figure 2.

FIGURE 2

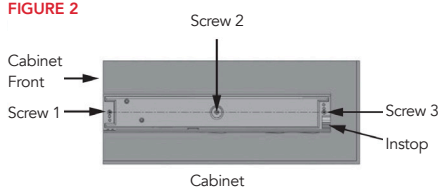

To modify angle, remove screws 1 and 3 and rotate around screw 2 to desired angle and reinstall, as shown in Figure 3.

FIGURE 3

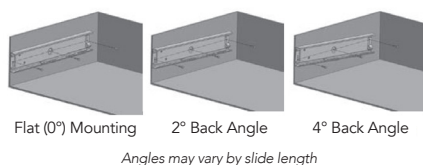

INTERMEDIATE MEMBER INSERTION

Insert intermediate member into the installed cabinet member, as shown in Figure 4.

FIGURE 4

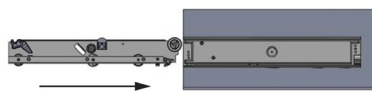

DRAWER INSERTION

Before starting drawer insertion, ensure the following:

- Intermediate member should be nested inside cabinet member (outer member).
- Extend intermediate member and pull the locking lever as shown in Figure 5.

FIGURE 5

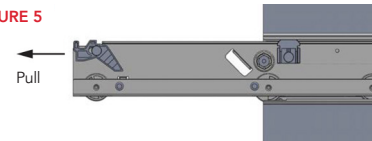

Press down on the locking lever as shown in Figure 6. If it moves freely, it is unlocked.

WARNING: Locking lever must be unlocked to insert drawer.

FIGURE 6

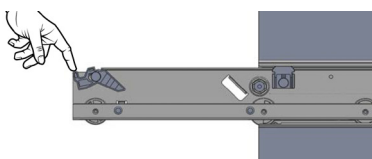

DRAWER INSERTION (CONTINUED)

Once lever is unlocked, drawer insertion can begin. The drawer begins by riding over the rollers (Figure 7), then lifts past the stop to engage with the middle rollers (Figure 8). The drawer then stabilizes into the horizontal position (Figure 9).

FIGURE 7

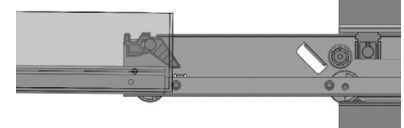

FIGURE 8

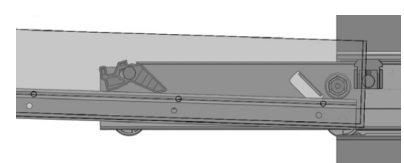
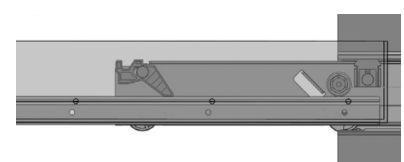

FIGURE 9



NOTE: Upon drawer closure, drawer will automatically lock.

