

GRASS DRAWER SYSTEM

# NOVA PRO SCALA

Inspiration at the right angle.  
Simple. Clear. Timeless.



**G\*GRASS®**

[www.grassusa.com](http://www.grassusa.com)



»Nova Pro is a piece of contemporary history.  
Nova Pro Scala a step into the future.«

# Nova Pro Scala incorporates the best of Nova Pro.

**Nova Pro was the original.  
Nova Pro Scala is a step into the future.**

Over the years, Nova Pro has become synonymous with double-wall drawer slides. Proven a million times over in practical use, this drawer slide remains unparalleled in terms of quality, stability, and running performance. Nova Pro Scala, with its crisp lines, right angles, and small radius, gives the new Nova Pro a timeless, futuristic design. True to its predecessors' reputation, Nova Pro Scala is designed flawlessly.

The very name of Nova Pro creates expectations of outstanding running properties, minimal drawer deflection, exceptional ease of opening, and top reliability. Everything is focused on function, quality, and value - from precision craftsmanship of every individual part to the color and surface finishes.

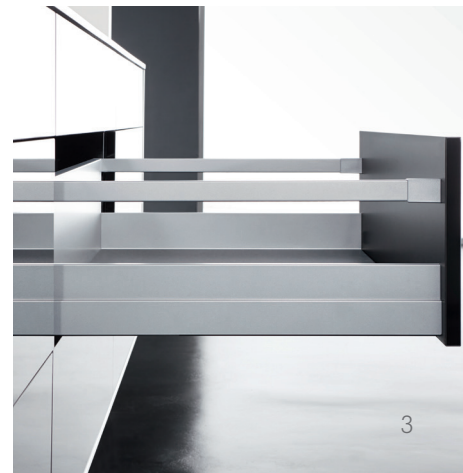

**250 millimeters.**  
An entirely  
new dimension in  
drawer sides.

**The conventional wooden drawer is basically  
a four-sided box with a front panel.**

We are adopting a back-to-basics approach in offering a drawer side height of 250mm for Nova Pro Scala. You now have the options of 63mm, 90mm, 186mm, and 250mm drawer side heights. The new drawer sides are high, solid, and beautiful.

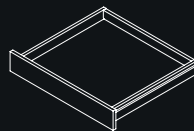

63

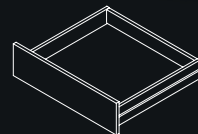

90

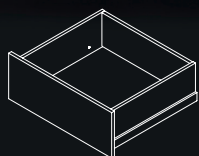

186

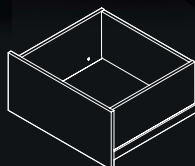

250



## Rectangular railing.

High level of stability and consistent design.

**The drawer with an added railing has long been a classic solution for adding height.**

At the bottom a 90mm drawer side, at the top a railing; now a deep drawer. For Nova Pro Scala a new rectangular railing system has been developed that optimizes all components and has been restyled to create a harmonized look. From the front bracket to the back panel connector to the integrated tilt angle adjustment – everything is aligned, fits, and matches perfectly to provide an elegant impression.

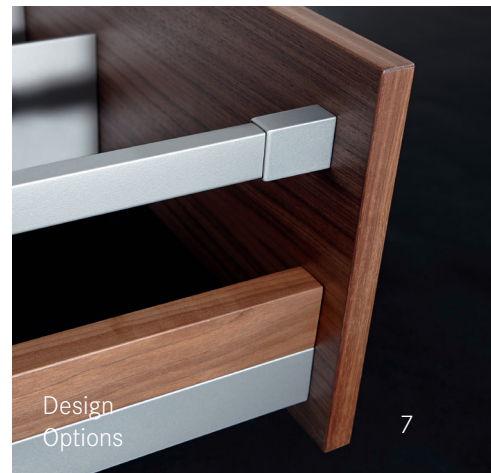
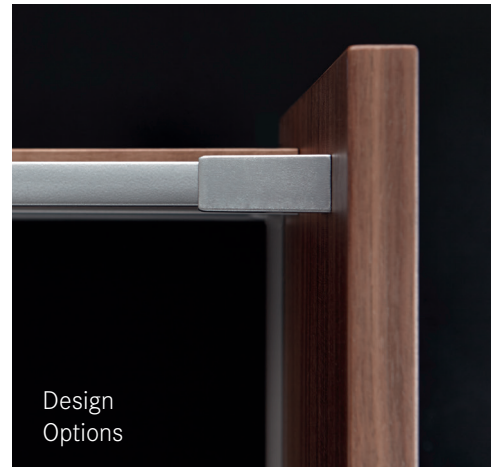

# Timeless variety. Nova Pro Scala Colors.

**Metallic colors, fine structures and satin finishes – these are the features of modern design.**

The color SILVER makes it possible to carry this design principle through to the cabinetry interior. This elegant shade has an intuitively harmonious and modern effect.

STONE represents a natural force which seems to resist all external influences. That is the inspiration for this popular shade of the same name.

The natural purity of ice and snow, the unique reflection of light and the fine surface texture – all these things inspired us to create the color ICE. This elegant shade neutralizes, brightens and enlivens.





SILVER

ICE

STONE



**Differentiation.**

Nova Pro Scala offers maximum functionality, timeless design, and aesthetic appeal which makes all the difference.

With Nova Pro Scala, an integrated drawer concept was developed as a design and functional solution to meet a wide range of requirements for a wide range of markets. Every customer is different, pursues their own philosophy and has individual requirements, ideas, and needs. Thanks to its modular versatility, Nova Pro Scala can satisfy these varied requests. Whether classic, modern or traditional, Nova Pro Scala offers each customer a functional added value product which turns the act of opening and closing drawers into an artistic experience.



## Tavinea Optima Interior accessory system.

### **Nova Pro Scala and Tavinea Optima together.**

The material, form, and color of Tavinea Optima and Nova Pro Scala are complementary. Both are made of the same steel and have the same powder coating characteristics so that the Tavinea Optima coordinates with the Nova Pro Scala and their combination in looks is striking. The Tavinea Optima system is simple with two frame elements and one divider rail. This is all you need.







Nova Pro Scala incorporates  
the best of Nova Pro.  
**And much more!**

**The outstanding features of the Nova Pro Scala  
drawer system at a glance:**

- **Timeless design:** Nova Pro Scala has an elegant, slim edge never interrupting the design outline.
- **Wide range of options:** In the colors Silver, Ice, and Stone in the heights 63mm and 90mm as well as high, closed drawers with heights of 186mm and 250mm.
- **Modular:** Nova Pro Scala includes a wide range of products that offers everything necessary for drawer building. Scala is also based on the track-proven Nova Pro slide and is therefore compatible with Nova Pro Deluxe.
- **Perfect movement:** With the track-proven Nova Pro slide for excellent running characteristics with load ratings from 88lb to 154lb.
- **Closing comfort:** Smooth closing action with the new Soft-close technology and low opening forces.
- **Simple installation:** With the clever, detailed design, installation is extremely easy and saves valuable time.



GRASS America Inc.  
1202 NC Highway 66 South  
Kernersville, NC 27284

Phone: 1-800-334-3512  
Fax: 1-800-525-8406

**Website:** [www.grassusa.com](http://www.grassusa.com)  
**E-mail:** [info@grassusa.com](mailto:info@grassusa.com)

[www.grassusa.com](http://www.grassusa.com)

GRASS Canada Inc.  
10 Newgale Gate, Unit 7  
Toronto, ON M1X 1C5

Phone: 1-800-461-4975  
Fax: 1-416-335-5907

**Internet:** [www.grasscanada.com](http://www.grasscanada.com)  
**E-Mail:** [info@grasscanada.com](mailto:info@grasscanada.com)

