

Assembly Instructions
Top Line Grant® 7000 - up to 150 lbs/panel (68 kg/panel)
for sliding / bypassing applications

Technik für Möbel

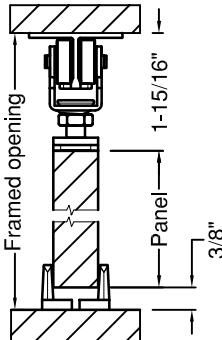
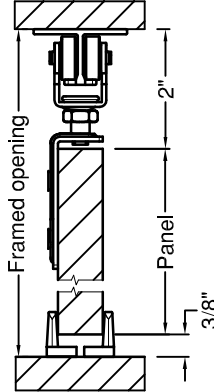
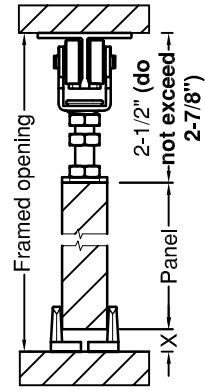

<p>71-111 Non-adjustable sliding door Single & bi-parting Top mounted Door thickness: 3/4" to 1-3/4"</p>  <p>Framed opening = 1-15/16" + Panel + 3/8" (Dimensions apply to single, and bi-parting installations.)</p>	<p>71-034 Single & bi-parting sliding door Side mounted Door thickness: 3/4"</p> <p>71-138 Single & bi-parting sliding door Side mounted Door thickness: 1-3/8"</p> <p>72-034, 73-034 Bypassing sliding door Side mounted Door thickness: 3/4"</p> <p>72-118 Bypassing sliding door Side mounted Door thickness: 1-1/8"</p> <p>72-138, 73-138 Bypassing sliding door Side mounted Door thickness: 1-3/8"</p> <p>Framed opening = 2" + PANEL + 3/8" Vertical leveling adjustment (±1/8") (Dimensions apply to single, bi-parting, and bypassing installations.)</p> 	<p>71-222 Single & bi-parting sliding door Top mounted Door thickness: 3/4" to 1-3/4"</p> <p>72-222 Bypassing sliding door Top mounted Door thickness: 3/4"</p> <p>72-223 Bypassing sliding door Top mounted Door thickness: 1-3/8"</p> <p>Framed opening = 2-1/2" + Panel + X Vertical leveling adjustment (±3/8") (Dimensions apply to single, bi-parting, and bypassing installations.)</p>  <p>X=5/8" (For 71-222) X=9/16" (For 72-222, 72-223)</p>
--	---	---

Note:

- Since these instructions apply to 13 different styles, note your set number, and follow those steps pertaining to it.
- For bi-parting doors use an additional set of hardware.
- These instructions assume a properly framed rough opening with carefully leveled header.
- For any open ended installation 7014 bumper stop **must** be used.
- It is recommended to pre-drill all screws.

1 Drill Door (For 71-222, 72-222, 72-223)

Drill a Ø3/8" hole in top of door on centerline of door thickness (approximately 1-1/2" deep) and approximately 5" from either end of door (both sides).

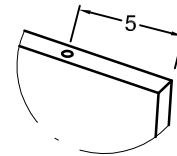

2 Top Plate

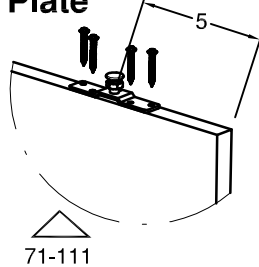

Attach 7111 top plates to top of door using #8 x 1-1/4" pan head tapping screws supplied. Bolt in center of top plate should be approximately 5" from either side.

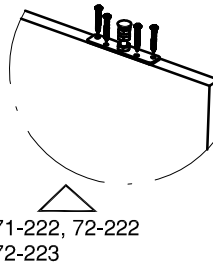

Place 7222 top plates on top of door. Insert bottom of bolt into previously drilled hole. Attach using #8 x 1-1/4" pan head tapping screws supplied.

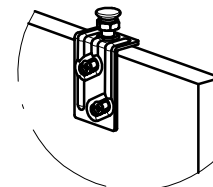

71-034, 71-138
 72-034, 72-118
 72-138, 72-134
 73-034, 73-138
 73-134

Locate holes on upper left and right hand corners of door using Template A. See instructions for mounting location on template. Attach aprons.

On sets 72-118 & 72-134, mount 3/4" aprons (7034) on front door. 3/4" aprons require #8 x 3/4" flat head tapping screws, 1-3/8" aprons require #8 x 1-1/4" flat head tapping screws.

3 Carrier / End Stop

Slide carriers and end stop (optional) onto track. Carrier opening should face most convenient side for mounting door. (For fascia track installations, orient carriers so that opening faces rear.)



4 Track

Mount track to header with #8 x 1-1/4" pan head tapping screws provided.

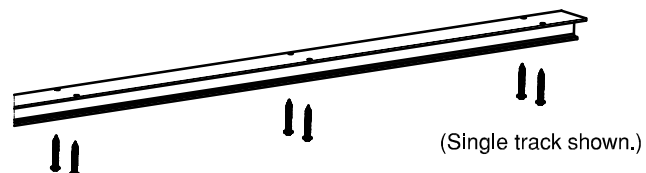

071-11-0019-00-0, Rev. C [INSTRUC\071-11-0019-00-0]

Cut along dotted line

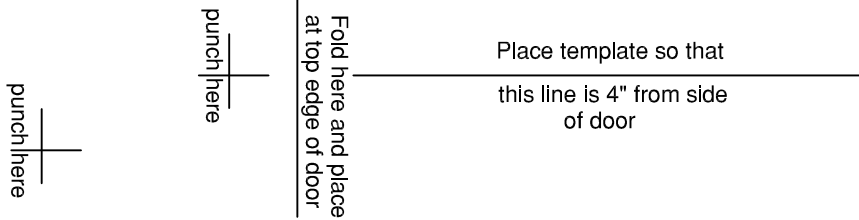

Assembly Instructions
Top Line Grant® 7000 - up to 150 lbs/panel (68 kg/panel)
for sliding / bypassing applications

Technik für Möbel



5 Floor Guide

Mount floor guide as necessary plumb with the track using the pan head tapping screws provided.

- 71-111
- 71-034
- 71-138
- 71-222

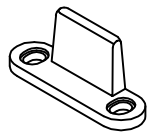
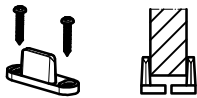

No. 110 Floor Guide:
for single door
installations.

- 72-034 72-223
- 72-118 73-034
- 72-138 73-138
- 72-134 73-134
- 72-222

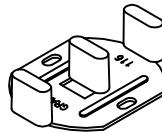

No. 116 Floor Guide: for bypassing installations. Non-adjustable for 3/4" doors.
 No. 117 Floor Guide: For bypassing installations. Non-adjustable for 1-3/8" doors.
 No. 118 Floor Guide: For bypassing installations. Non-adjustable for 1-3/4" doors.
 Only 2 screws required. All steel with nylon covered steel uprights.

6 Mounting Door(s)

Lift door and place heads of bolts into the carrier opening and rest in the cups in the carriers. (For bypass doors hang rear door first.)

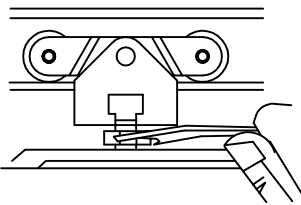

- 71-111,71-034,71-138
- 72-034,72-118,72-138
- 72-134,73-034,73-138, 73-134

Raise lock nut until it contacts the carrier housing to lock the door in. Do not tighten excessively. Play between apron and carriers is necessary for best operation.

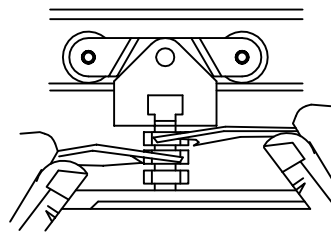

- 71-222, 72-222
- 72-223

Raise lock nut as far as possible and tighten using 1/2" wrench supplied. To prevent bolt from rotating, place 1/2" wrench on middle nut.

7 Vertical Adjustment

- 71-222, 72-222, 72-223

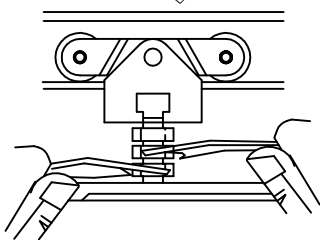

Confirm distance from floor to door bottom from the diagram at the top of page 1. This dimension can be regulated by loosening the lowest lock nut above the plate and turning middle nut on bolt until door is in desired position. Retighten bottom nut against plate, holding center nut with wrench.

- 71-034,71-138,72-034
- 72-118,72-138,72-134
- 73-034,73-138,73-134

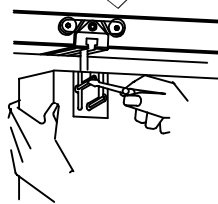

Confirm distance from floor to door bottom from the diagram at the top of page 1. If additional clearance is required at bottom of door loosen screws in adjusting slots and raise door to next higher notch. If lowering the door is required, loosen screws and lower door to next lower notch, or if necessary to lowest notch. Tighten both screws.

071-11-0019-00-0, Rev. C [INSTRUC:\071-11-0019-00-0]