

1016-S Single Bowl Sink

I.D.: 15 3/4" x 10" (400 mm x 254 mm)

Depth: 4 1/8" * (105 mm)

*Depth does not include counter top thickness



The Gemstone 1016-S Single Bowl Sink provides a seamless kitchen utility/ laboratory sink in any solid surface sheet material, acrylic, polyester or blended. This sink fits well in a tight places or in any situation where a small, rectangular sink is required, including

residential, clinical, or other commercial uses. This sink can be installed in either direction.

Gemstone Sinks are compatible and warranted when used with all major solid surface sheet brands with the same sheet warranties.



Gemstone supports conservation and green building practices and may contribute toward achieving LEED® building certification in commercial projects. All Gemstone sinks use resin containing 15% post-consumer recycled content and 5.5% rapidly renewable materials.



Gemstone sinks are proudly made in the USA and certified by:

Home Innovation Lab (NAHB) : HUD UM Bulletin No. 73a & (B45.5/IAPMO Z124 Z124.6)

UL in the US and Canada: HUD UM Bulletin No. 73a & (B45.5/IAPMO Z124 Z124.6)

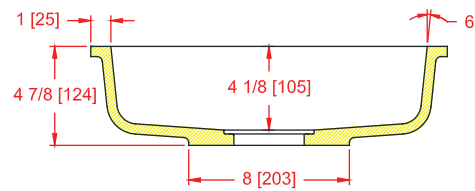
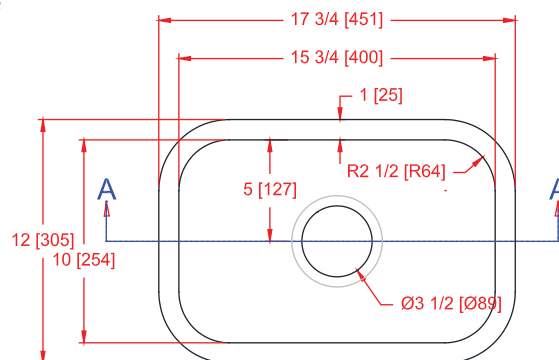

Section A-A

For router bit recommendations visit:
www.Gemstoness.com/Tech