

Bottom bracket



Waste/recycle set

Set includes:

- Adapter plate
- Drive unit (pre-attached)
- Double bottom bracket (additional drive unit can be attached)
- 110v plug-in power supply with six foot cable
- Screw-on distance bumpers (qty 4)
- INSERTA cable connector
- Mounting template and instruction sheet
- All necessary mounting screws are included

Part no.

Details

pg 56

Waste/recycle set

Z10NA30UGUS

Power supply set

Set includes:

- 19 ft universal cable
- 24 watt power supply
- Wall mount bracket
- Three-prong power cord
- Cable end protector (qty 3)
- INSERTA cable connector
- Cable clips (qty 10)
- Technical information

Part no.

Details

pg 57

Power supply set

Z10NE03UG10

TANDEM plus BLUMOTION

Specifications

Space requirements

For opening widths **340** (13-3/8") and wider

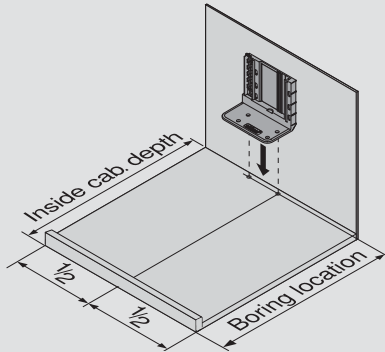

For opening widths **275 to 339** (10-13/16" to 13-3/8")

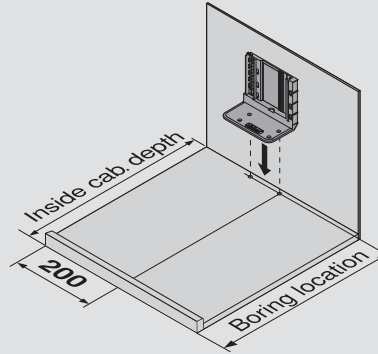

boring location requirements

| | | | | | | | | |
|---------------------------|-----------------------|------------------------|------------------------|------------------------|------------------------|------------------------|------------------------|------------------------|
| drawer length | 229 (9") | 305 (12") | 381 (15") | 457 (18") | 533 (21") | 610 (24") | 686 (27") | 762 (30") |
| boring location | 253 (9-15/16") | 329 (12-15/16") | 405 (15-15/16") | 481 (18-15/16") | 557 (21-15/16") | 634 (24-15/16") | 710 (27-15/16") | 786 (30-15/16") |
| min. inside cabinet depth | 270 (10-5/8") | 346 (13-5/8") | 422 (16-5/8") | 498 (19-5/8") | 574 (22-5/8") | 651 (25-5/8") | 727 (28-5/8") | 803 (31-5/8") |

NOTE: 41 (1-5/8") is required between drawer back and back panel

Boring specifications

Bottom boring pattern

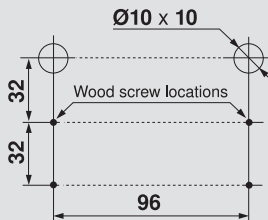

Bottom bracket

Installation of bottom bracket

1 Insert locating pins into pre-bored holes

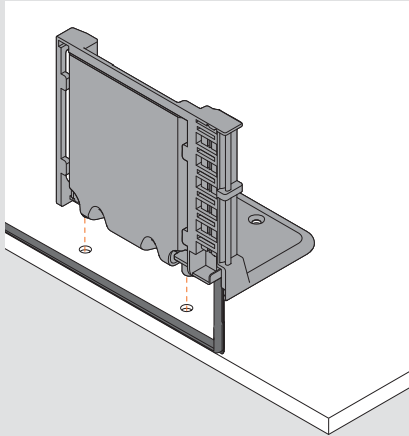

2 Secure with four wood screws (606N or 606P)

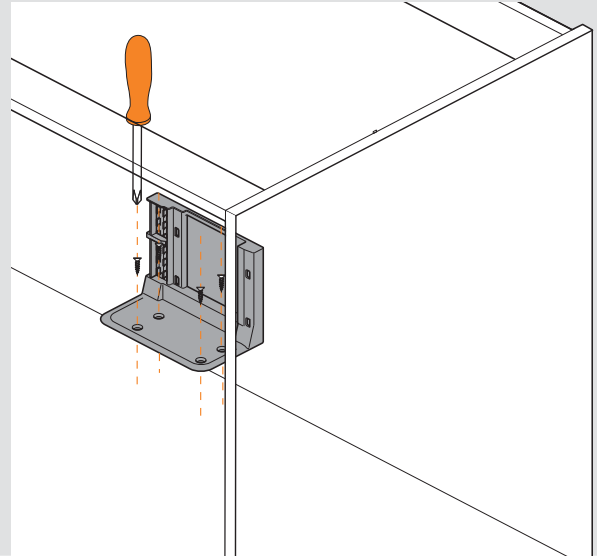

Drive unit attachment

Bottom bracket for attachment of one or two drive units

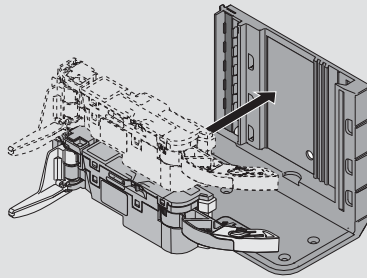

Wiring options [pg 61](#)

TANDEM plus BLUMOTION

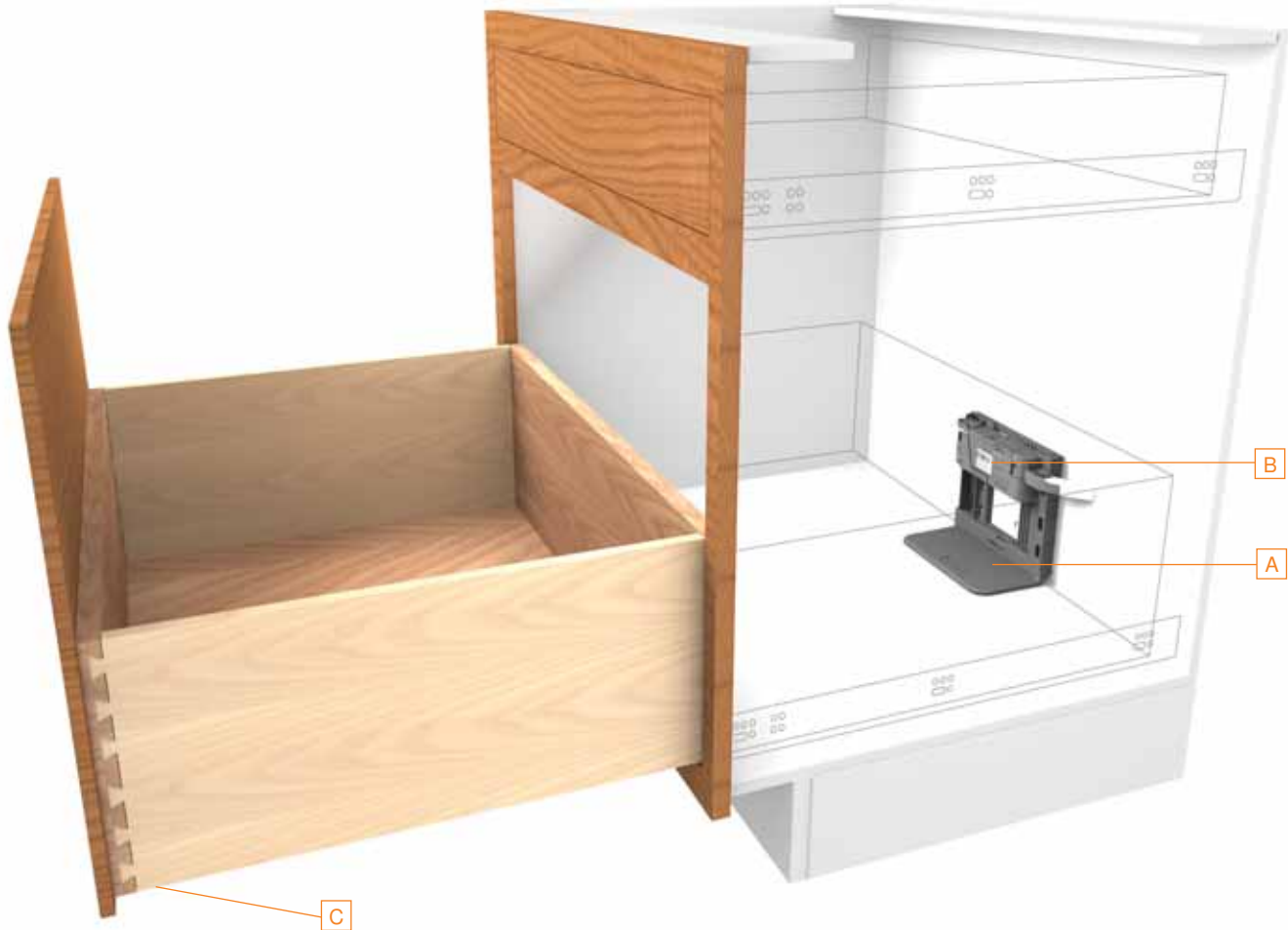

Bottom bracket

A

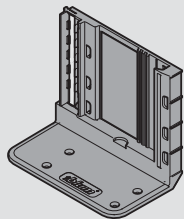

NOTE: 800 (31-1/2") universal cable is included Part no.

| | |
|--|--------------|
| Bottom bracket, double for two drive units | Z10D7201.01 |
| Installation screw | 606N or 606P |

Drive unit

B

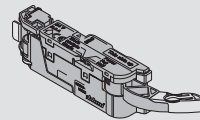

Part no.

| | | | |
|--------------|-------|------------|-------------|
| Installation | pg 63 | Drive unit | Z10A3000.03 |
|--------------|-------|------------|-------------|

SERVO-DRIVE locking device with integrated bumper

C Provides 3 (1/8") gap



Part no.

| | |
|-----------------------------------|---------------|
| SERVO-DRIVE locking device, left | T51.1901.PS L |
| SERVO-DRIVE locking device, right | T51.1901.PS R |

Inset bottom bracket



Waste/recycle set

Set includes:

- Adapter plate
- Drive unit (pre-attached)
- Double bottom bracket (additional drive unit can be attached)
- 110v plug-in power supply with six foot cable
- Screw-on distance bumpers (qty 4)
- INSERTA cable connector
- Mounting template and instruction sheet
- All necessary mounting screws are included

Part no.

Details

pg 56

Waste/recycle set

Z10NA30UGUS

Power supply set

Set includes:

- 19 ft universal cable
- 24 watt power supply
- Wall mount bracket
- Three-prong power cord
- Cable end protector (qty 3)
- INSERTA cable connector
- Cable clips (qty 10)
- Technical information

Part no.

Details

pg 57

Power supply set

Z10NE03UG10

TANDEM plus BLUMOTION

Specifications

Space requirements

For opening widths **340** (13-3/8") and wider

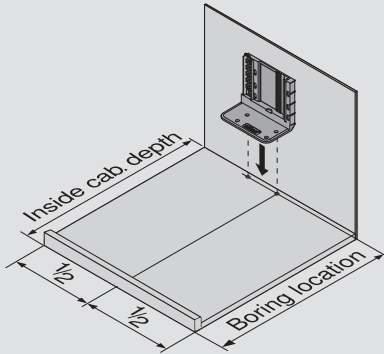

For opening widths **275 to 339** (10-13/16" – 13-3/8")

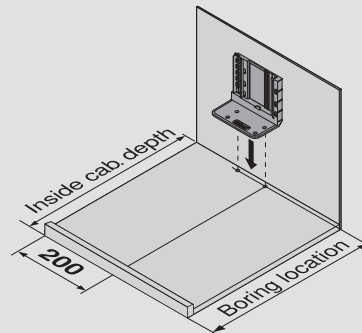

Boring specifications

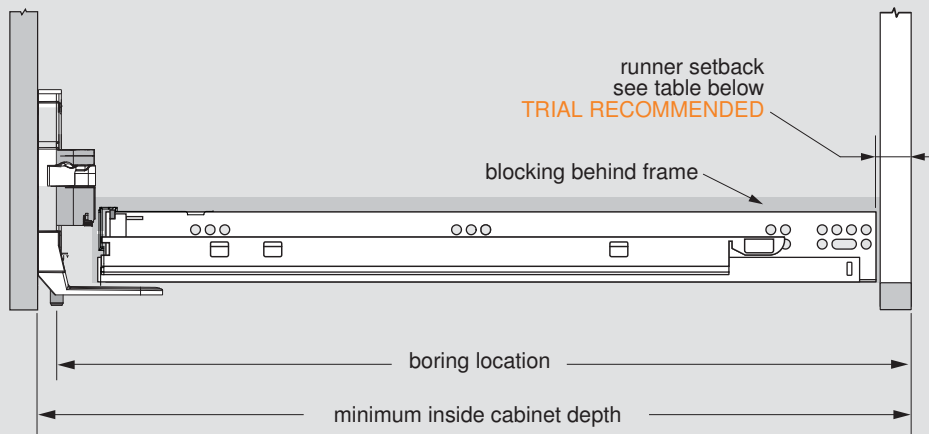

boring location requirements

boring location = drawer length + **21** (13/16") + runner setback

minimum inside cabinet depth = drawer length + **38** (1-1/2") + runner setback

Mounting the TANDEM runner for inset application

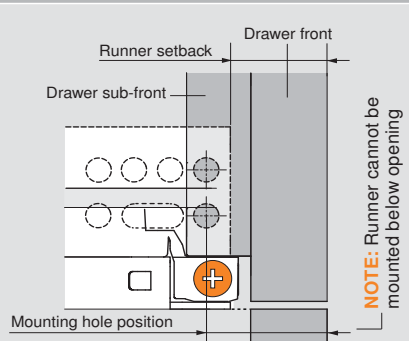

| | | 563/569 H/. | | | | 563/569 F/A | | | |
|---------------------|-----------|------------------------|--------------|--------------|---------------------|----------------|-------------|------------------------|--------------|
| | | runner setback | | | | runner setback | | | |
| sub-front thickness | 13 (1/2") | 20 (25/32") | 23 (29/32") | 26 (1-1/32") | sub-front thickness | 13 (1/2") | 17 (21/32") | 20 (25/32") | 23 (29/32") |
| | 16 (5/8") | 23 (29/32") | 26 (1-1/32") | 29 (1-5/32") | | 16 (5/8") | 20 (25/32") | 23 (29/32") | 26 (1-1/32") |
| | 19 (3/4") | 26 (1-1/32") | 29 (1-5/32") | 32 (1-1/4") | | 19 (3/4") | 23 (29/32") | 26 (1-1/32") | 29 (1-5/32") |
| | | drawer front thickness | | | | | | drawer front thickness | |
| | | 16 (5/8") | 19 (3/4") | 22 (7/8") | | | 16 (5/8") | 19 (3/4") | 22 (7/8") |

- Setbacks in this table recess the face of the drawer front inside of the cabinet **1** (1/32")
- The depth adjustment can then be used to move the drawer front out to its desired position, **2.5** (3/32") out adjustment only

calculating runner setback

563/569 H/. (sub-front thickness + drawer front thickness minus **9** (11/32") = runner setback)

563/569 F/A (sub-front thickness + drawer front thickness minus **12** (15/32") = runner setback)

NOTE: For mounting hole position, add **7** (9/32") to runner setback

Inset bottom bracket

Boring specifications

Bottom boring pattern

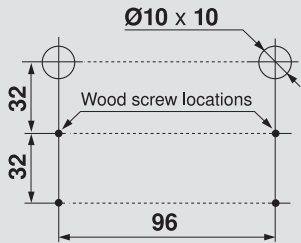

SERVO-DRIVE locking device with integrated bumper



- Captive right device and self-aligning left device
- Self-adjusting drawer length tolerance
- Minimum inside drawer width **170** (6-11/16")
- Height adjustment **+3** (1/8")
- Side adjustment ± 1.5 (1/16")
- Depth adjustment **+2.5** (3/32"), preset at **0**
- Minimum sub-front thickness **13** (1/2")
- Designed for **13** (1/2") drawer bottom recess
- Integrated **3** (1/8") distance bumper for inset or overlay SERVO-DRIVE applications

Installation **pg 64**

Installation of bottom bracket

1 Insert locating pins into pre-bored holes

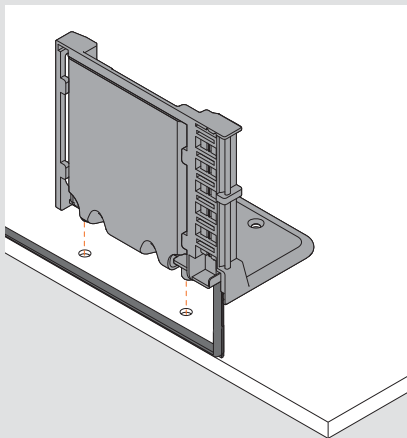

2 Secure with four wood screws (606N or 606P)

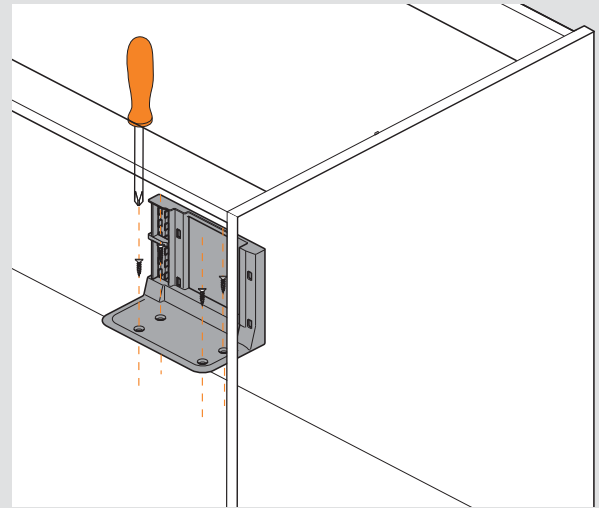

Drive unit attachment

Bottom bracket for attachment of one or two drive units

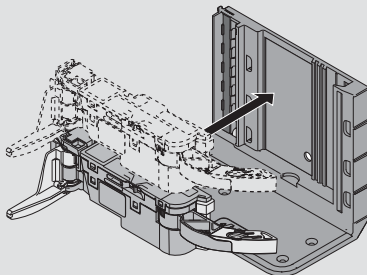

Wiring options **pg 61**

TANDEM inset spacer

For applications where there would not be enough space behind the drawer box to add SERVO-DRIVE due to cabinet construction, plumbing, etc. Two required per drawer.

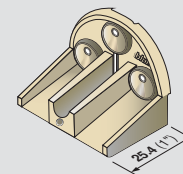

Part no.

TANDEM spacer

T59.A5P0S

Installation screw

606N or 606P