

EASY-ADD SD100 SOFT CLOSE

Universal Soft Close System, Add-on for Wall Mount/Barn Door Sliding Systems.

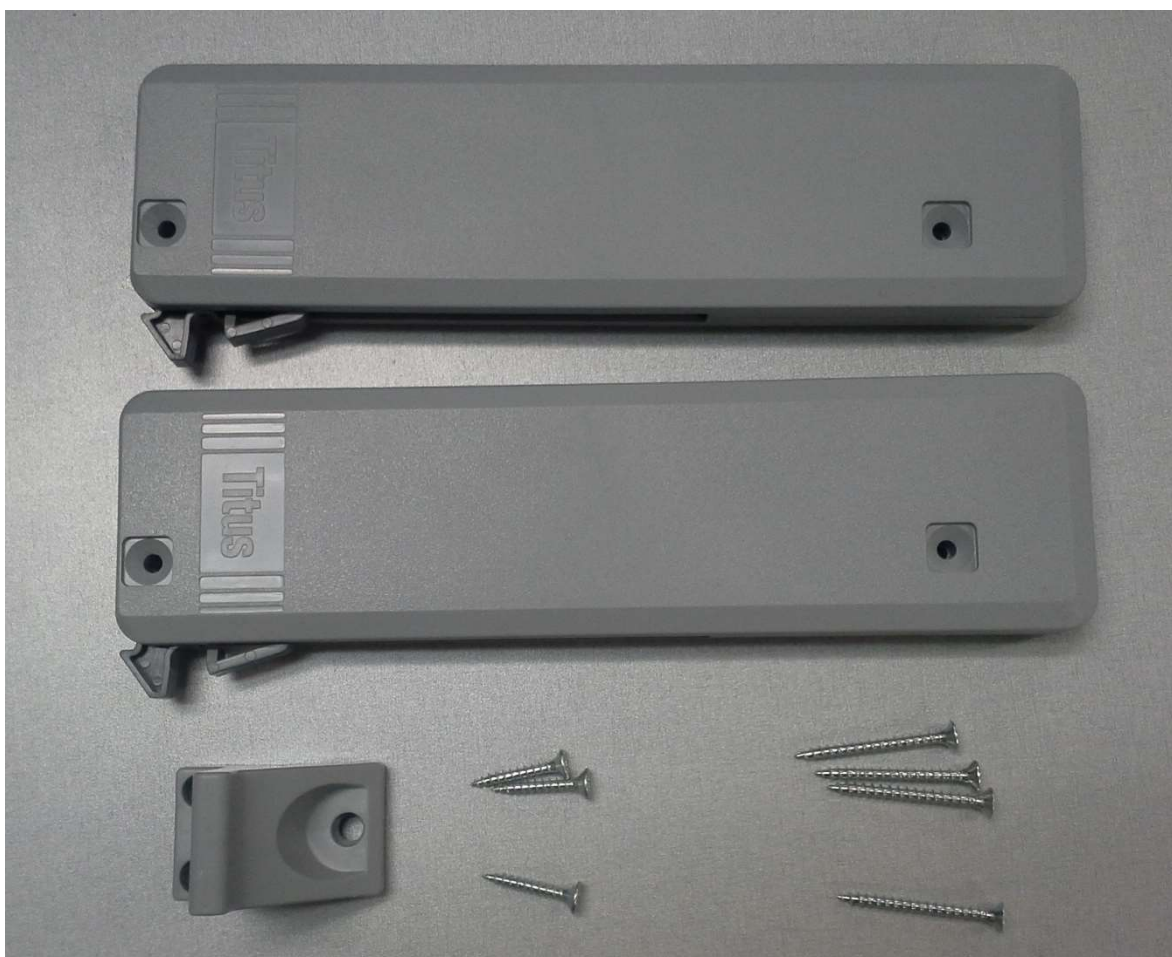

EASY-ADD SD100 SOFT CLOSE

Item no. 89SD1000RETROKT

Description:

Universal Soft Close System
that can be adapted to a wide variety of
Wall Mount/Barn Door Sliding Systems.

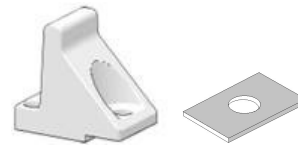
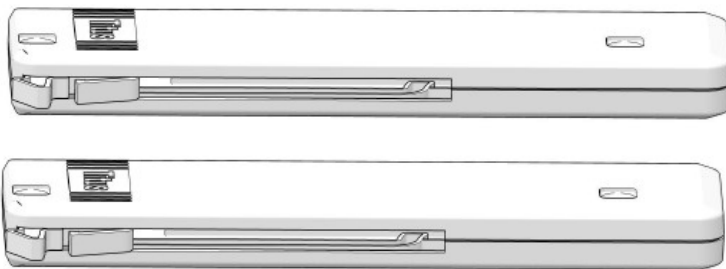

Set Includes:

- ✓ Soft Mechanism (grey) 50kg, QTY = 2
- ✓ Actuator (grey) , Qty = 1
- ✓ Phillips Flat Head Screw # 6 x 1-1/4" , Qty = 3
- ✓ Phillips Flat Head Screw # 8 x 2" , Qty = 4
- ✓ Plastic Shim, QTY = 1

TECHNICAL DATA

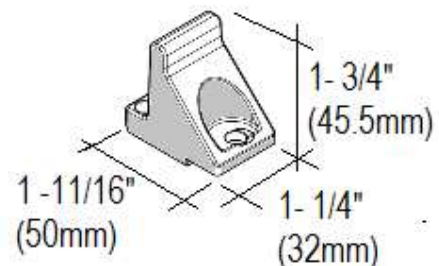
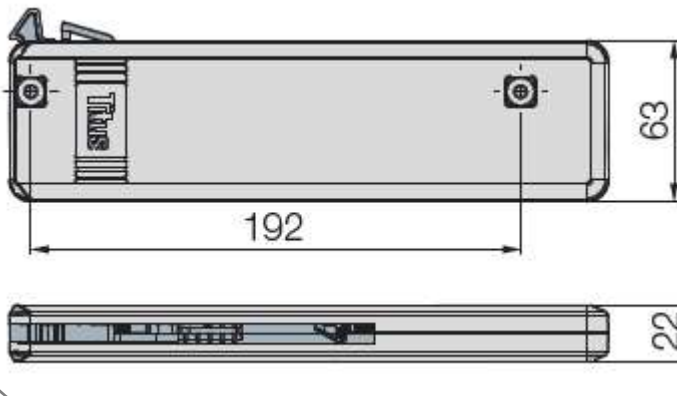

EASY-ADD SD100 SOFT CLOSE

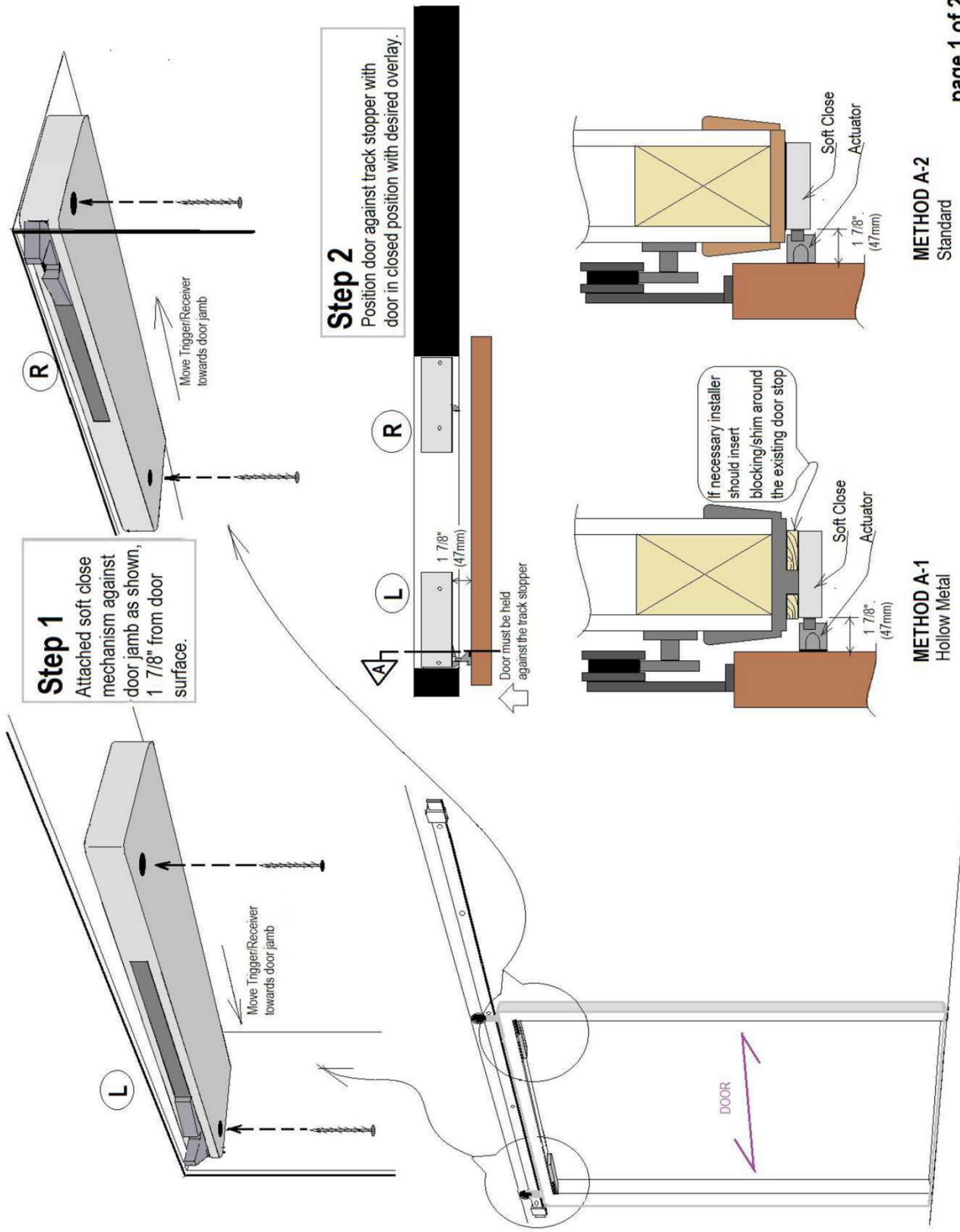

EASY-ADD SD100 SOFT CLOSE

Step 2 Slide the door so that it is in the fully closed position, with desired overlay. (Consider the handle position). Temporarily secure track stopper against the trolley

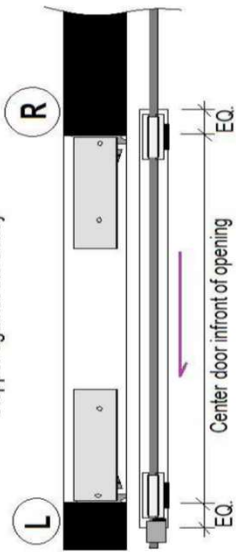

Step 4 Move the door towards the center of opening and attach actuator as marked being sure to use the supplied shim (please pre-drill).

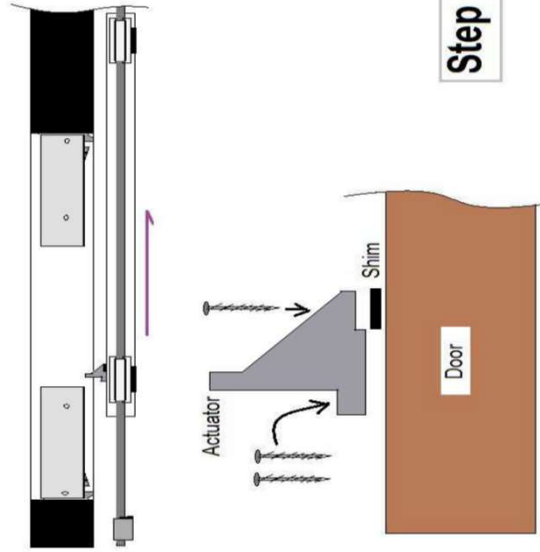

Step 3 Position actuator into the soft close mechanism with the door fully closed. Mark location of actuator on door

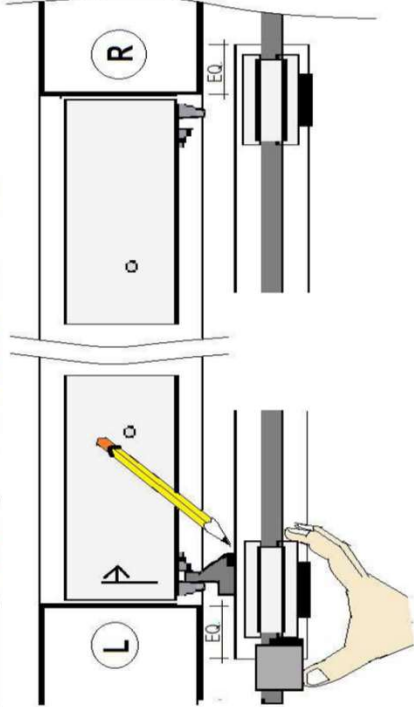

Step 5 Charge the soft close mechanism by manually pushing the tabs towards the center of the opening until loads (you will feel resistance)

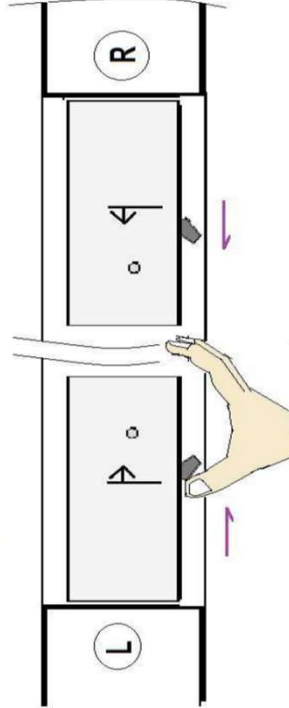

Step 5 Slide door gently to the left so that it engages with the soft close and fully cycles. Loosen track stopper, move door and track stopper with actuator engaged 1/4" towards the center of opening. Firmly tighten track stopper. Repeat on the opposite side

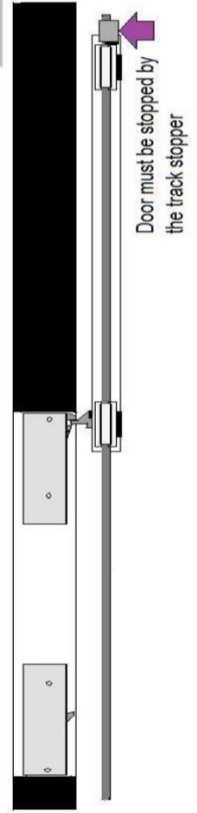

***Trolley should rest against the track stopper prior to the soft close reaching full cycle

IMPORTANT NOTE:
The Soft Close Mechanism must work together with a fixed Door Track Stopper. The intent of the Soft Close Mechanism is to assist in slowing the door until the door reaches its final stop and resting position against the fixed track stopper. The fixed track stopper must stop the door before the soft close mechanism fully cycles