

# SINGLE WALL

## OVERALL DIMENSIONS

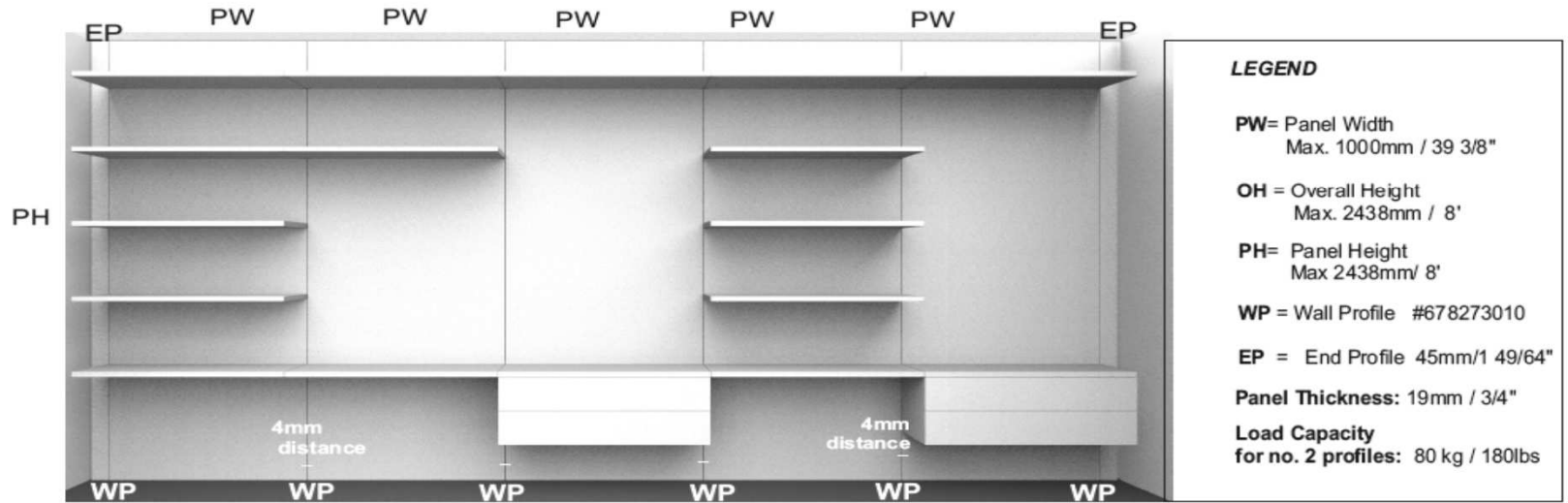

## OVERALL DEPTH

Min and Max DEPTH (Y)  
with min and max adjustment and  
shelf depth available.

wood strips thickness = 19mm

Y= min.405mm

Y= max. 513mm

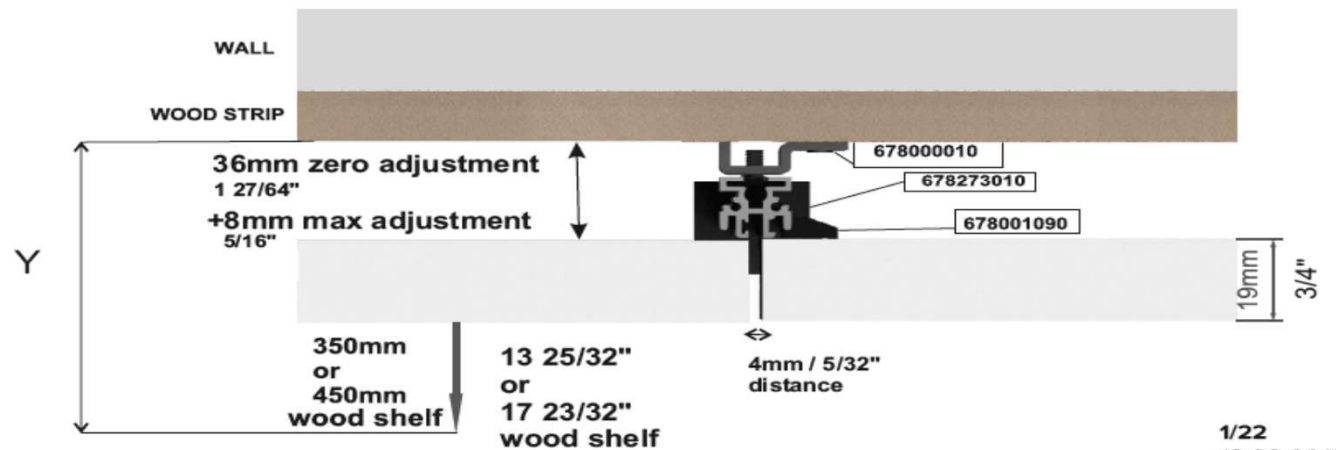

# SINGLE WALL

OVERALL WIDTH

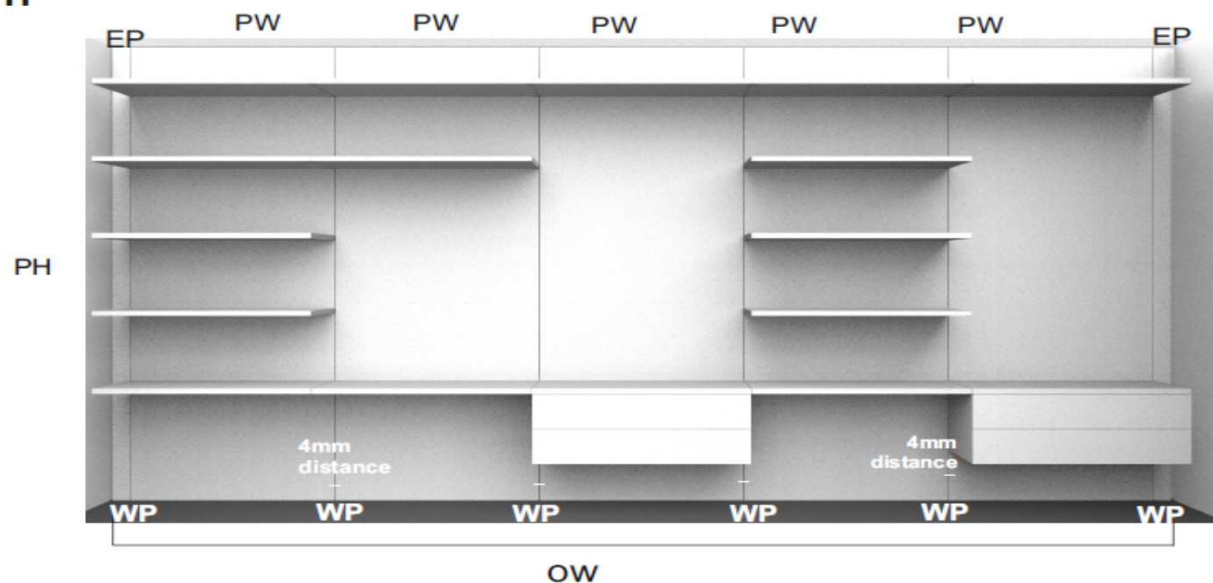

## LEGEND

**PW**= Panel Width  
Max. 1000mm / 39 3/8"

**OH** = Overall Height  
Max. 2438mm / 8'

**PH**= Panel Height  
Max 2438mm/ 8'

**WP** = Wall Profile #678273010

**EP** = End Profile 45mm/1 49/64"

**Panel Thickness**: 19mm / 3/4"

**Load Capacity**  
for no. 2 profiles: 80 kg / 180lbs

**OW= Overall installation width required:**

**EP**: end profile width 45mm / 1 49/64"

**QWP**: ( quantity of WP-wall profiles)#678273010 to order = # of panels+1  
4mm( 5/32") : distance in between 2 wall panels

**OW**= 90mm +sum of all PW+ (4mmxQWP)

**OW**= 3 35/64" +sum of all PW+ (5/32" x QWP)

## ELEMENTS MIN-MAX DIMENSIONS

**REAR PANEL,  
SHELF and  
CABINET  
MUST HAVE SAME WIDTH**

<b><u>REAR PANEL :</u></b>	Max. Width	1000mm / 39 3/8"
	Max. Height	2438mm / 8'
	Thickness	19mm / 3/4"

<b><u>SHELF:</u></b>	Max. Width	1000mm / 39 3/8"
	Depth:	350mm / 13 25/32" or 450mm / 17 23/32"
	Thickness:	19mm / 3/4" or 25mm 63/64"

<b><u>CABINET:</u></b>	Max. Width	1000mm / 39 3/8"
	Depth:	350mm / 13 25/32" or 450mm / 17 23/32"

<b><u>END GABLE:</u></b>	Max. Height	2438mm / 8'
	Min Width:	45mm / 1 49/64"

# WALL PREPARATION and WALL FIXING POSITION

## FIXING DETAILS

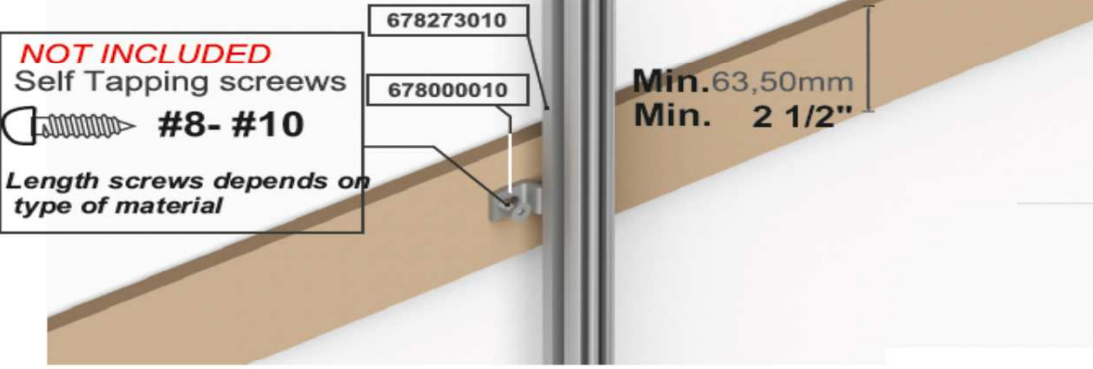

**Max. Panel dimensions:**  
Height: 2438mm / 8'  
Width: 1000mm / 39 3/8"

## Wood strips installation:

**first strip:** centered 50,80mm/ 2" lower than panel height  
**last strip:** centered 152,40mm/ 6" higher than bottom panel  
**others strips:** X= 500mm\*\* / 19 11/16"

\*\* dimension with 8' panels

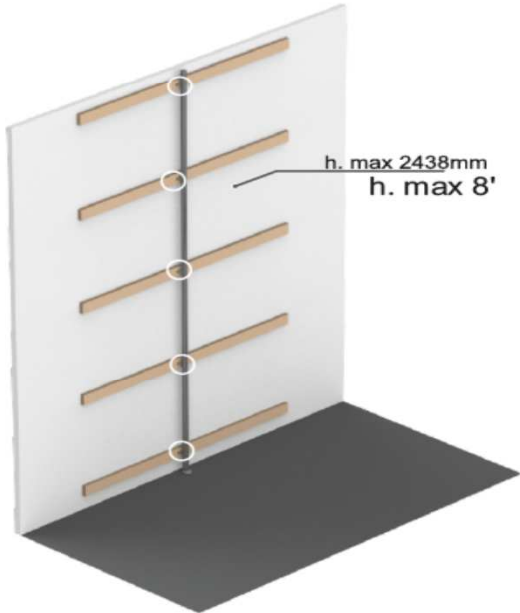
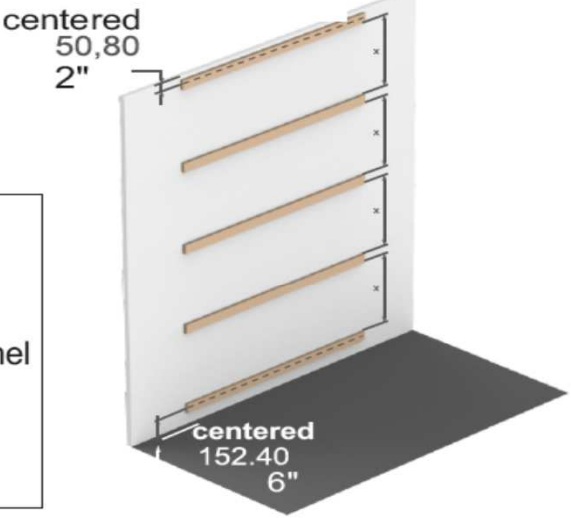

PROFIL PREPARATION

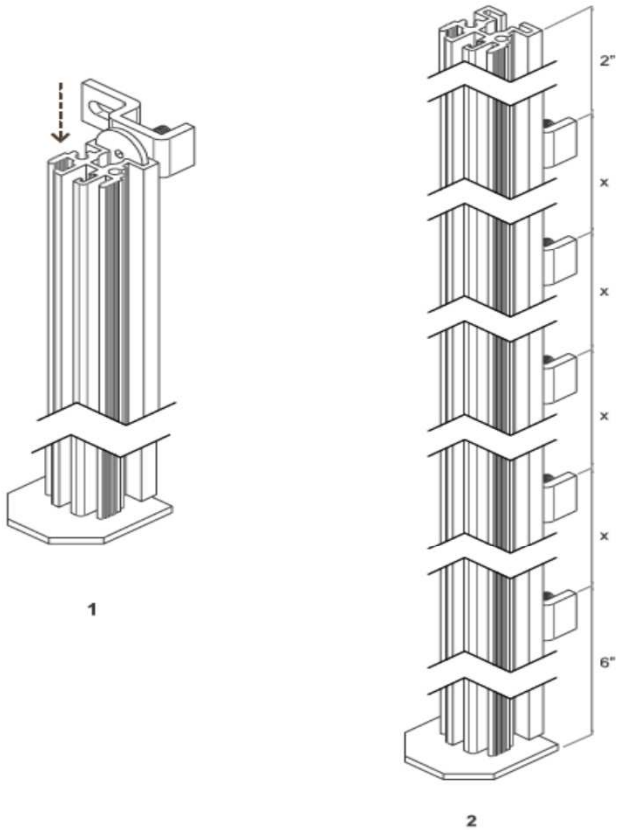
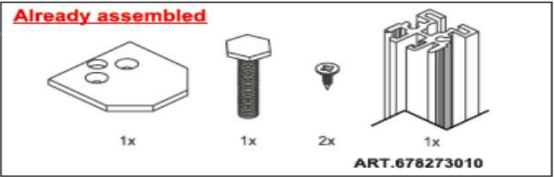
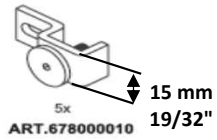

FIXING DETAILS

**NOT INCLUDED**  
Self Tapping screws  
Ø 8 - 10 mm  
Length screws depend on  
type of material

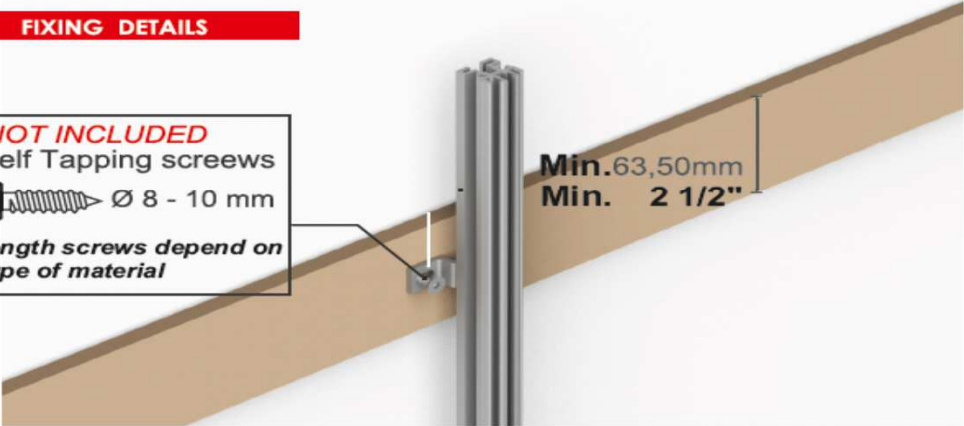

TOP VIEW DETAILS

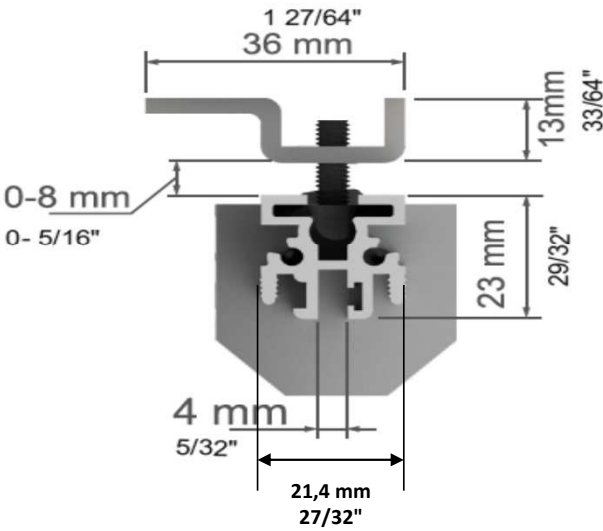

## PROFIL PREPARATION

### Bottom Shelf Positioning

Min Height  
from Floor to underneath the shelf:  
65mm / 2 9/16"



## PANEL PREPARATION

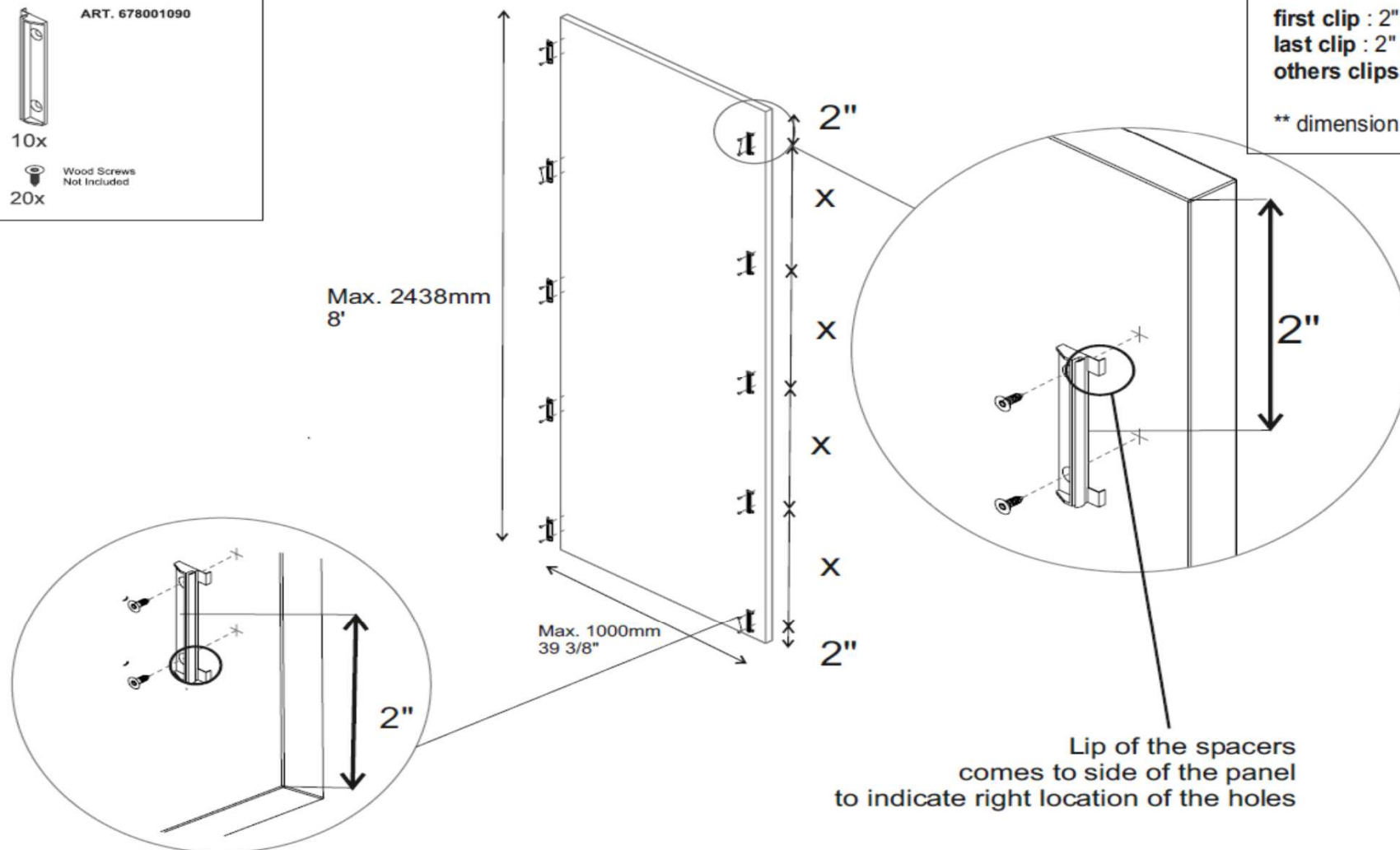
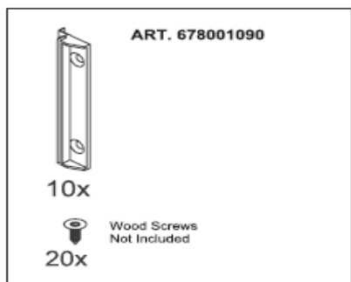

**Suggested Clip Position:**  
all dimensions: center of the clip.

**first clip :** 2" lower than panel height  
**last clip :** 2" higher than panel height  
**others clips:** X= 584,2mm / 23" \*\*

\*\* dimension with 8' panel



## END PROFILE

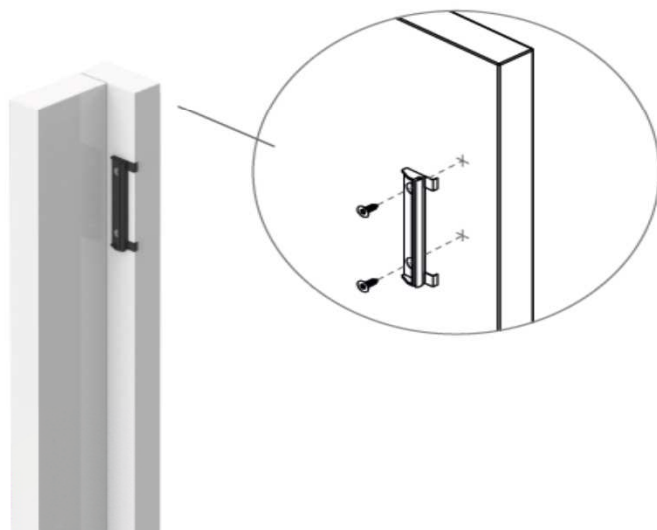
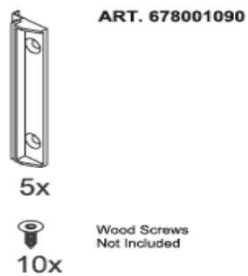

## TOP VIEW

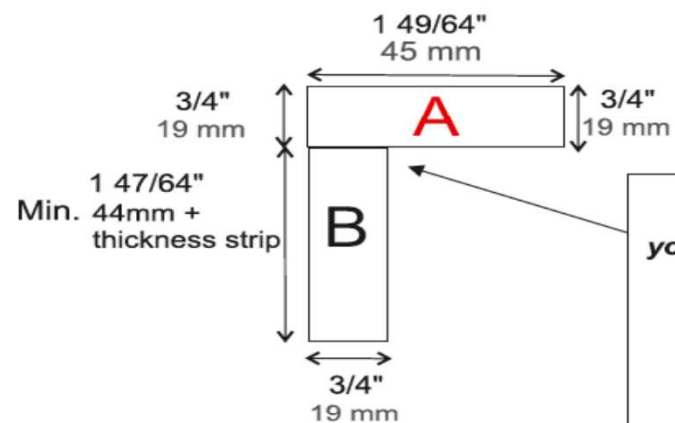

*To fix A with B element,  
you can use the Wooden Dowels  
(NOT INCLUDED)*





## PROFIL -MOUNTING STEP-

1.

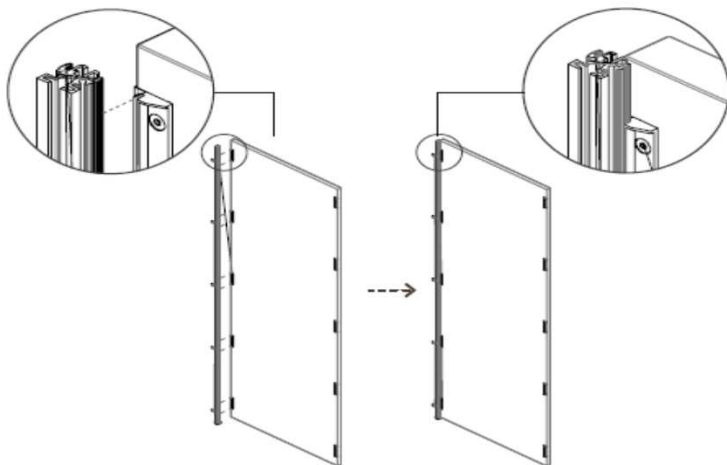

2.

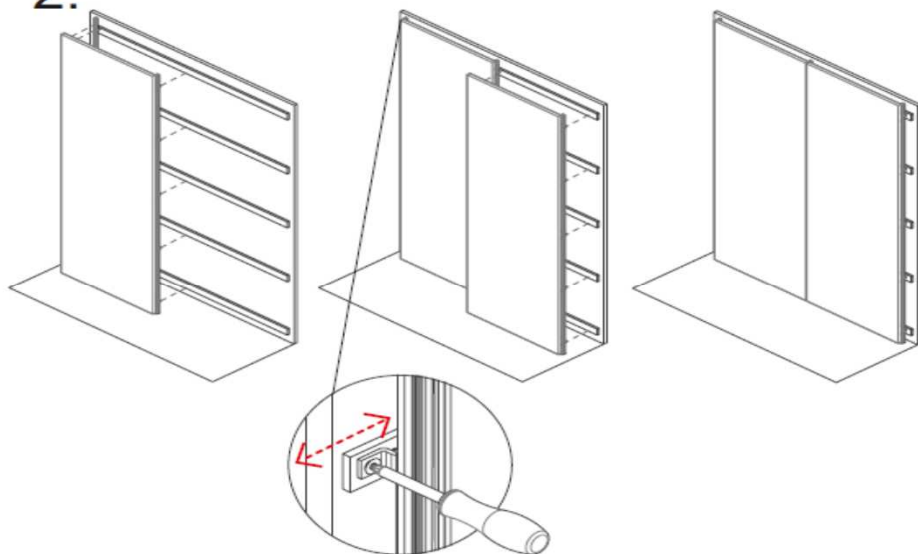

3.

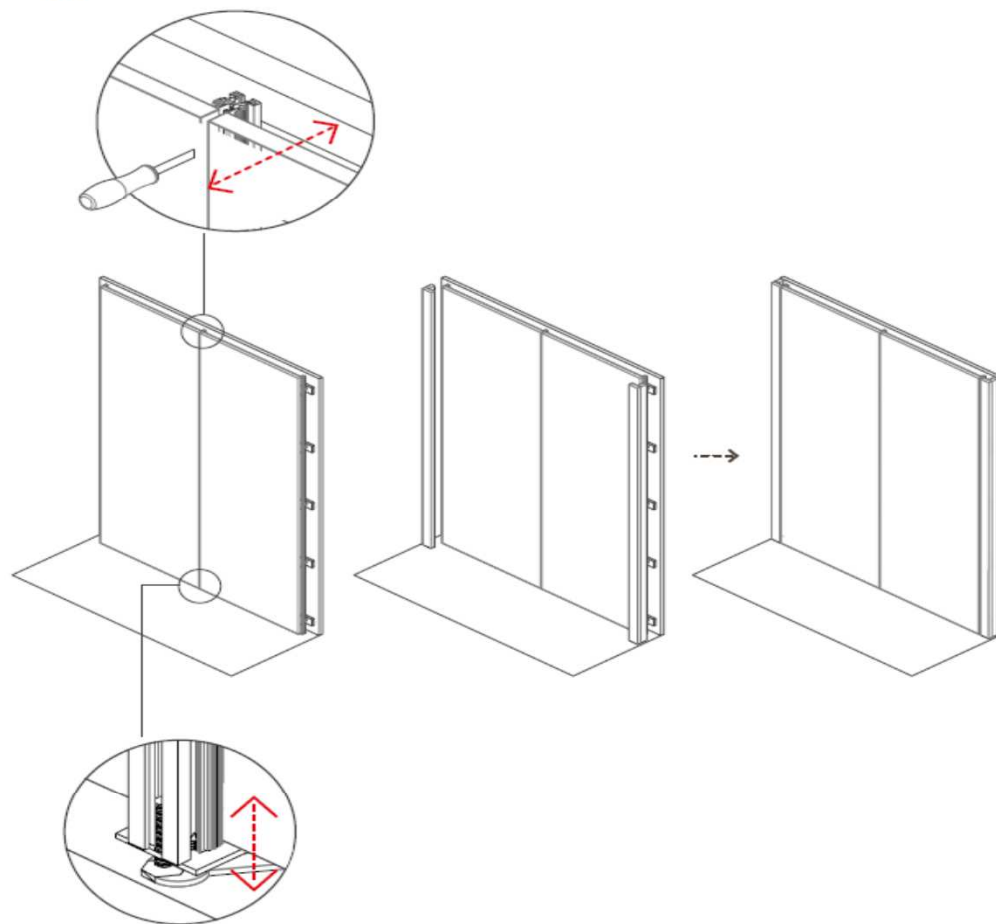

## ADJUSTMENT STEPS

FOCUS ON  
FINE 3D ADJUSTMENT  
*AFTER MOUNTING*

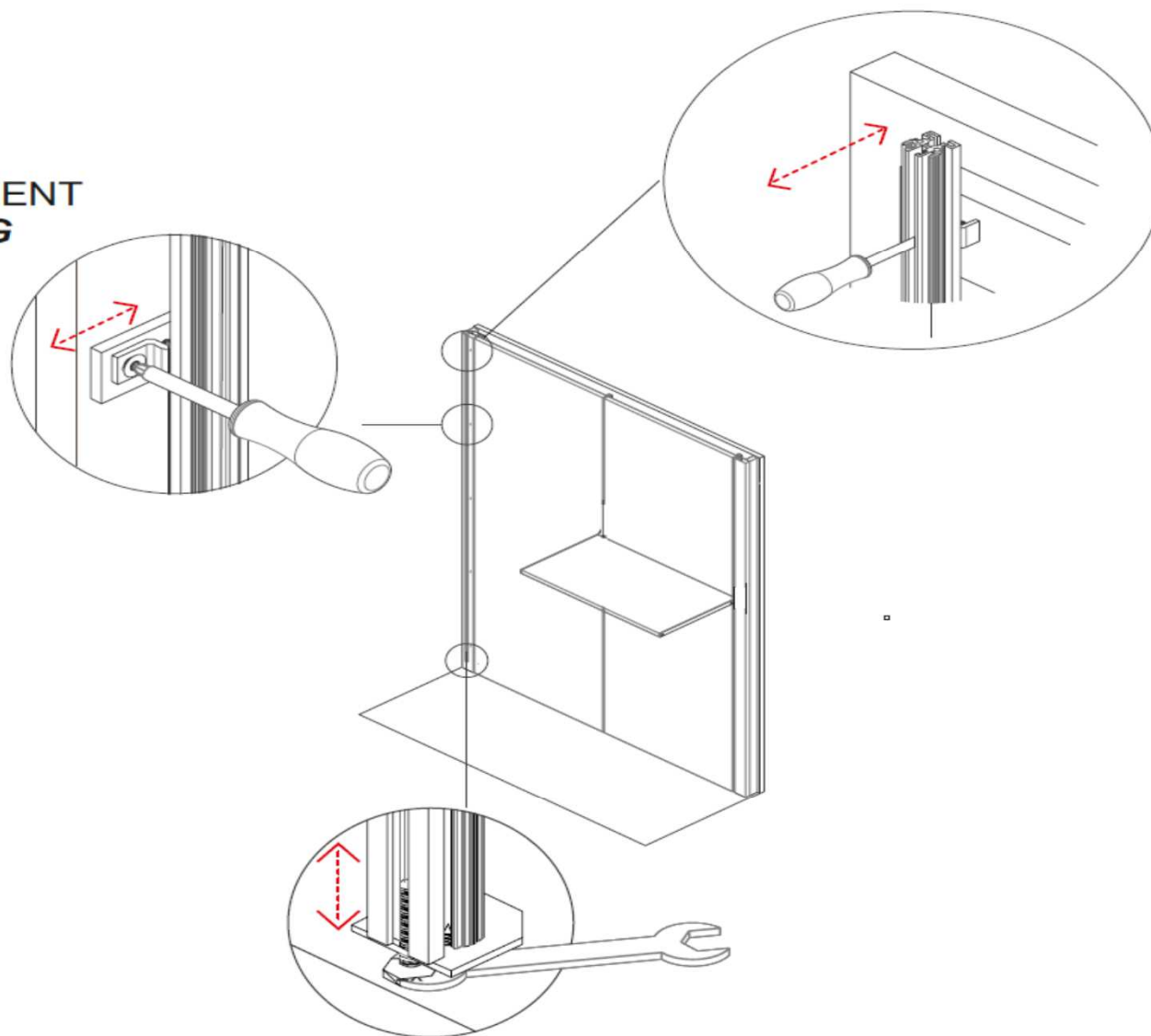

## CORNER OPTION

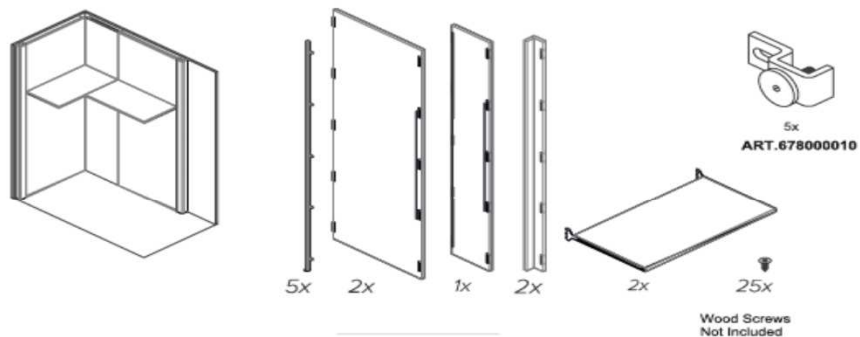

**Max. Panel dimensions:**  
Height: 2438mm / 8'  
Width: 1000mm / 39 3/8"

**\* FIRST PANEL OF THE CORNER:**  
450mm / 17 23/32" WIDTH

**Max. Shelf dimensions:**  
Depth: 350mm or 450mm  
13 25/32" or 17 23/32"  
Width: 1000mm / 39 3/8"

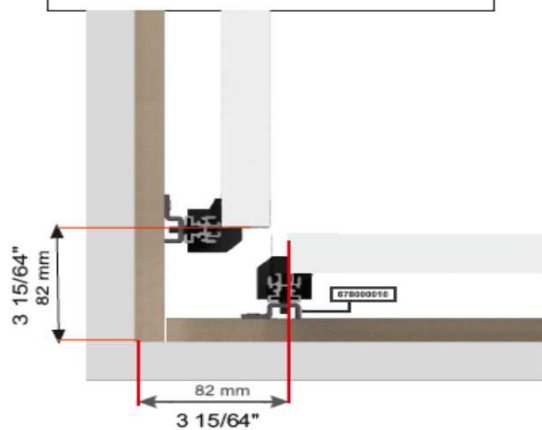
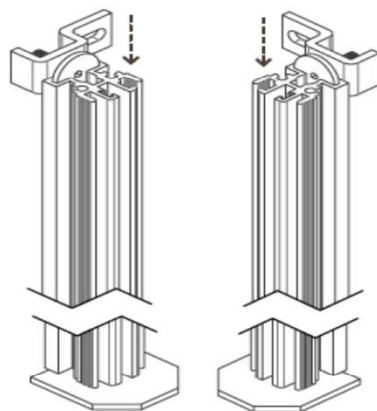

## CORNER OPTION

For bottom and top shelves,  
You have to use 450mm depth self.

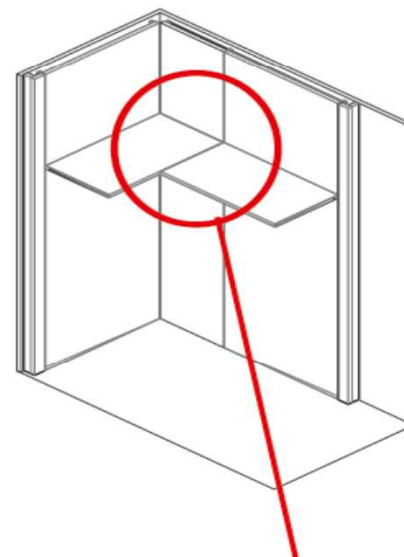

You can have this connection  
ONLY using 450mm depth shelf.

\*In between, using 350mm depth shelf  
you cannot have this connection.

## Mounting Step

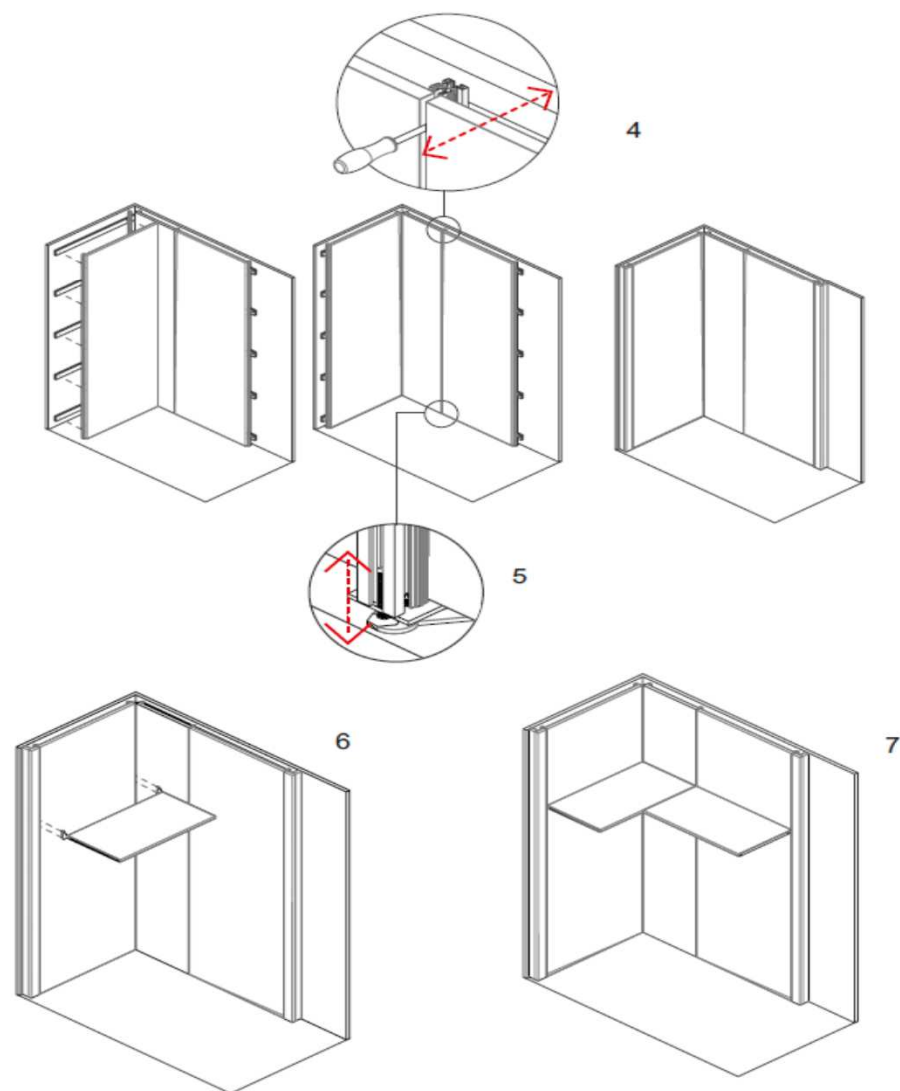
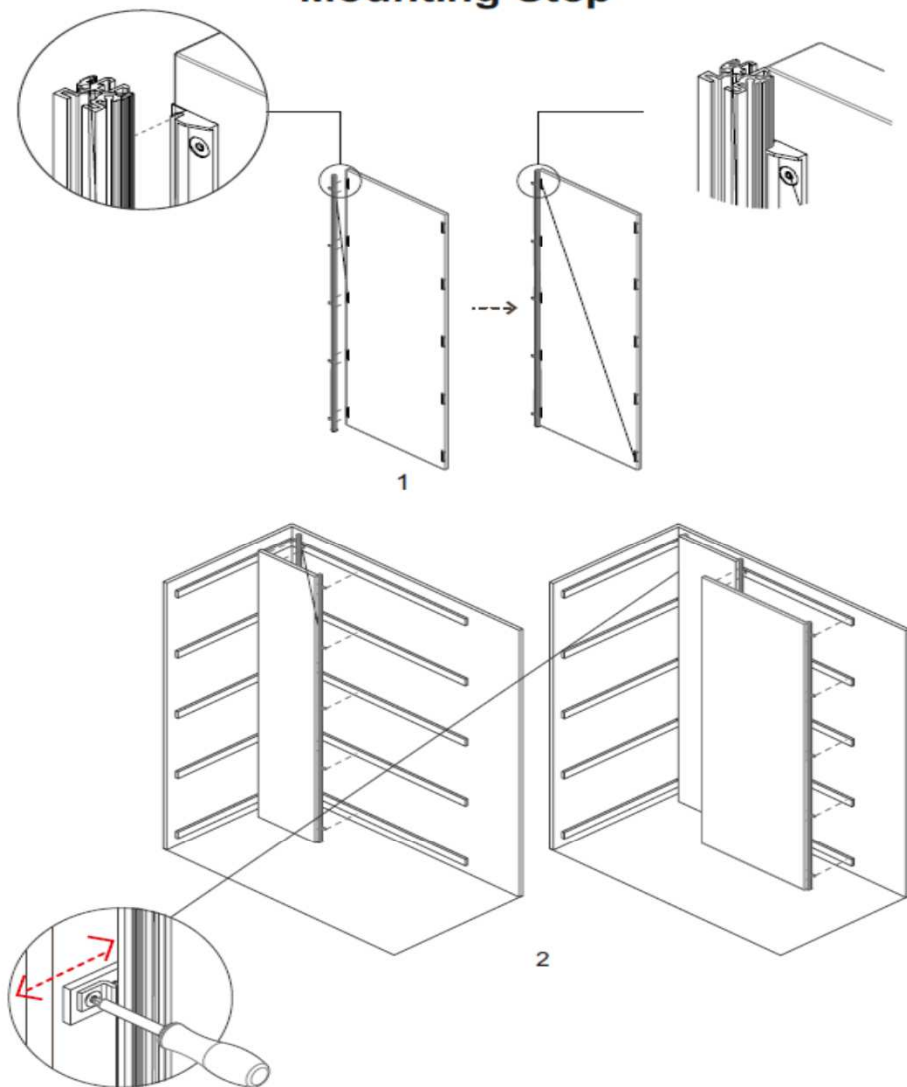

## ADJUSTMENT STEPS

FOCUS ON  
FINE 3D ADJUSTMENT  
***AFTER MOUNTING***

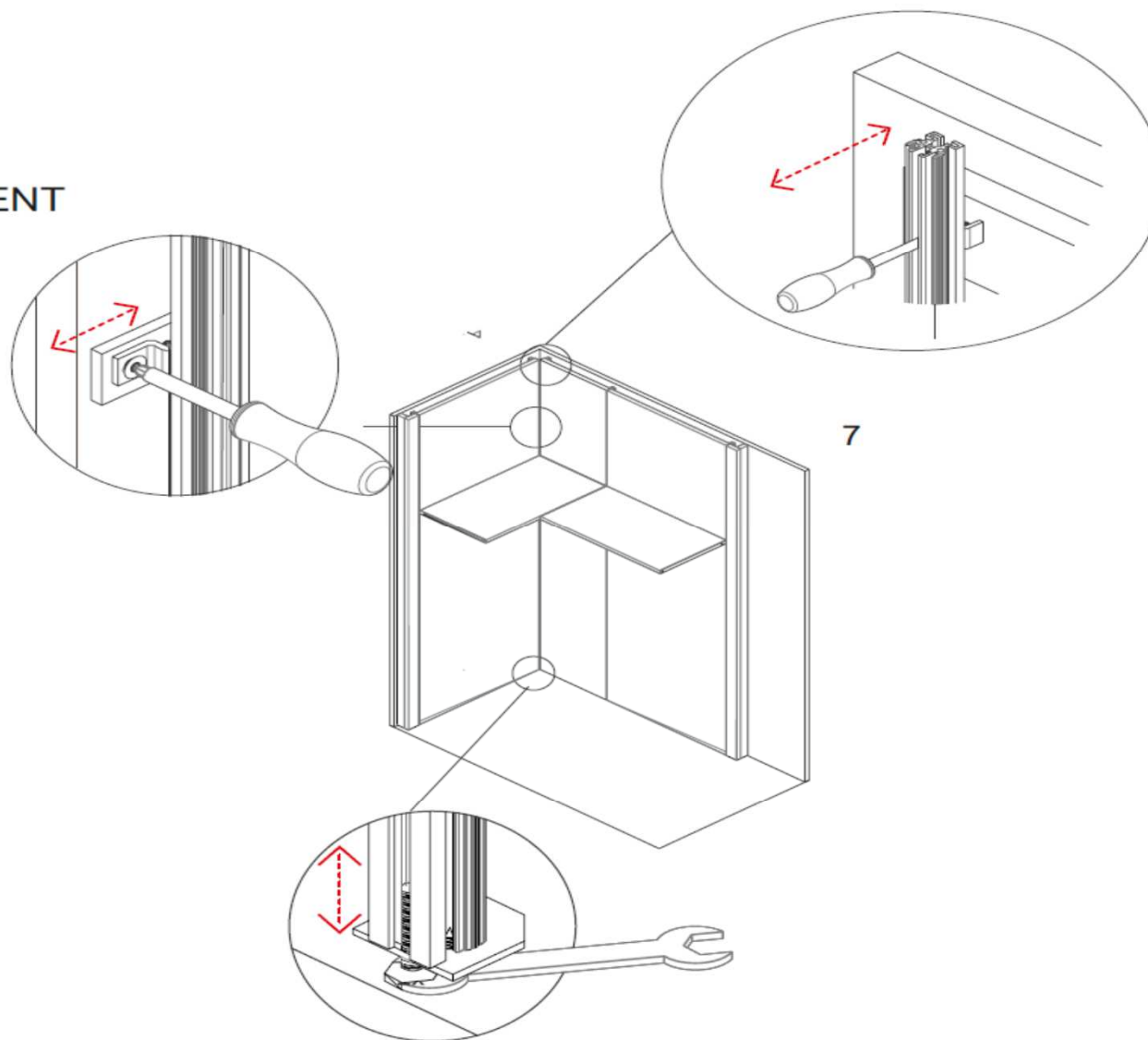

## GENERAL VIEW

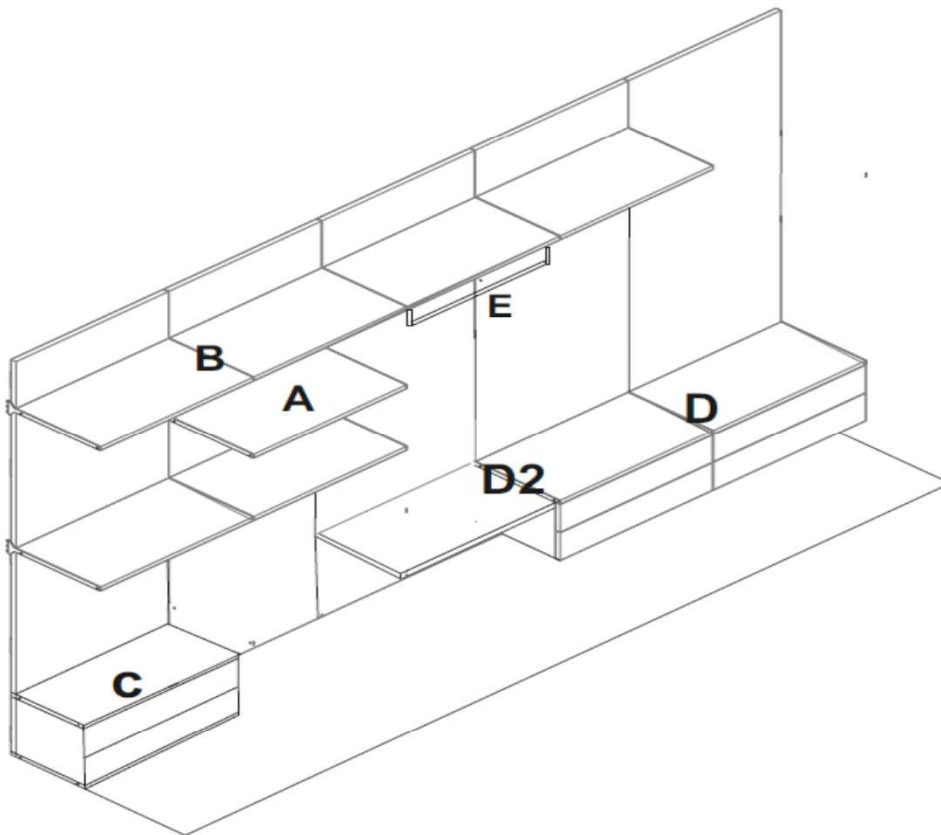

## *Configurations*

- A. Single Shelf
- B. Double Shelf
- C. Cabinet inserted between 2 shelves
- D. Double Cabinet
- D2. Cabinet+Shelf
- E. Rod

# CONFIGURATION A WOOD SHELF APPLICATION ONLY

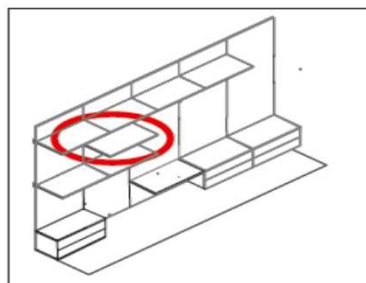
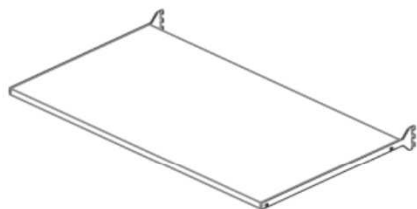

**SHELF DIMENSIONS:**  
Width: 1000mm / 39 3/8" MAX  
Depth: 350mm or 450mm  
13 25/32" or 17 23/32"

- ART. 6781265-xxx (for 450mm x th.25mm shelf (for 17 23/32" x 63/64" shelf)
- ART. 6781264-xxx (for 450mm x th.19mm shelf (for 17 23/32" x 3/4" shelf)
- ART. 6781275-xxx (for 350mm x th.25mm shelf (for 13 25/32" x 63/64" shelf)
- ART. 6781277-xxx (for 350mm x th.19mm shelf (for 13 25/32" x 3/4" shelf)

XXX : 100 grey finish, 060 brown finish

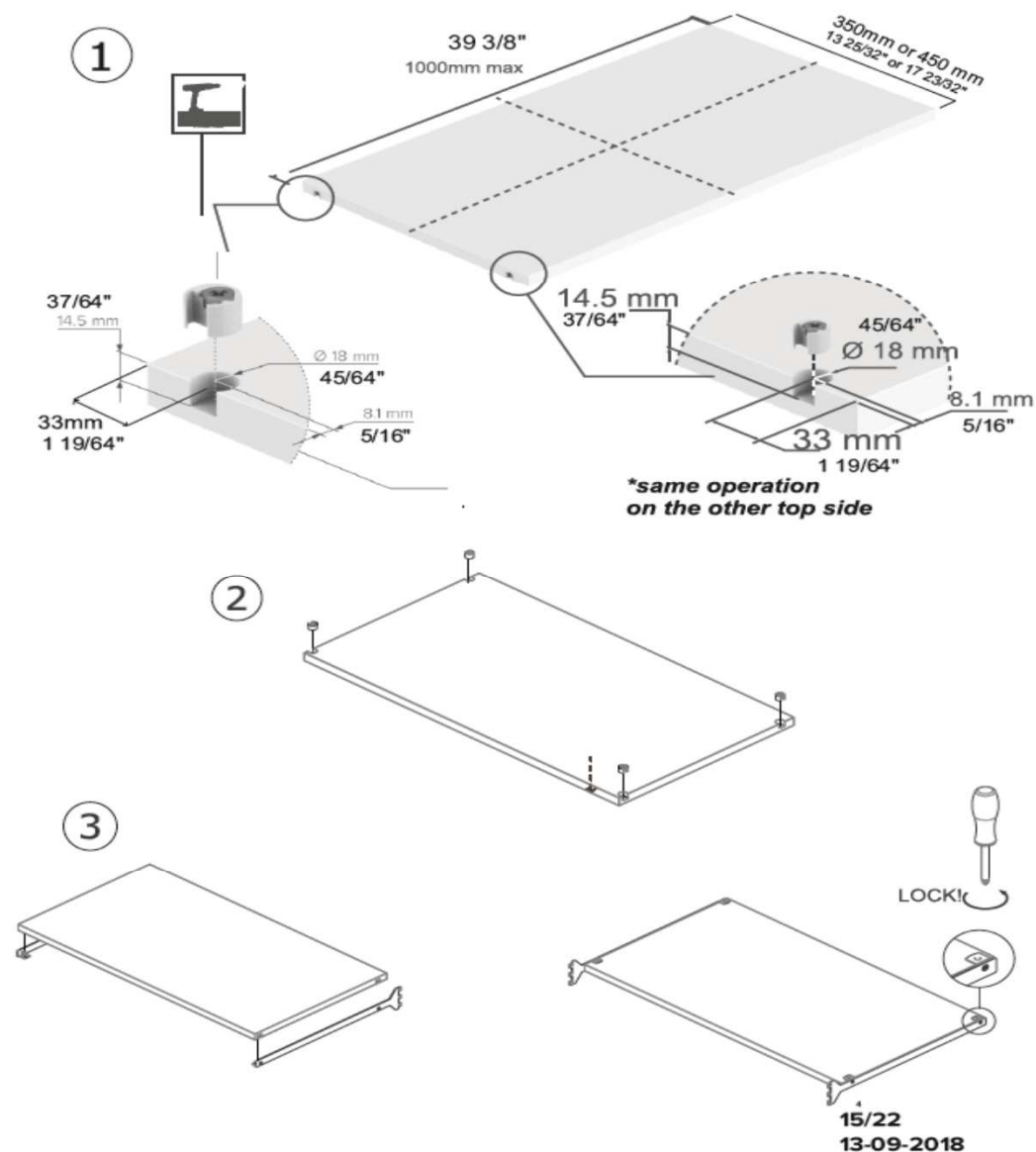
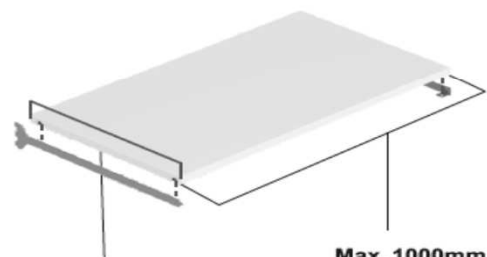
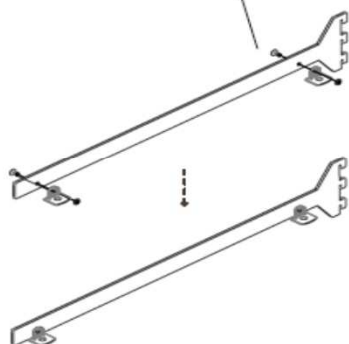
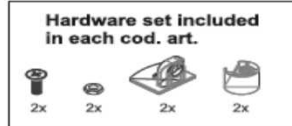



## CONFIGURATION B

### DOUBLE WOOD SHELF APPLICATION

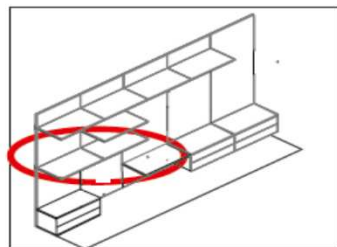

**SHELF DIMENSIONS:**  
Width: 1000mm / 39 3/8" MAX  
Depth: 350mm or 450mm  
13 25/32" or 17 23/32"

Hardware set already mounted on each cod. art.

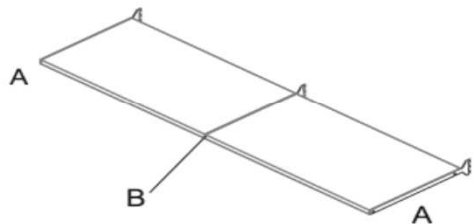

ART. 678298-xxx (for 450mm x th.25mm shelf (for 17 23/32" x 63/64" shelf)  
ART. 678299-xxx (for 450mm x th.19mm shelf (for 17 23/32" x 1/4" shelf)  
ART. 678300-xxx (for 350mm x th.25mm shelf (for 13 25/32" x 63/64" shelf)  
ART. 678301-xxx (for 350mm x th.19mm shelf (for 13 25/32" x 1/4" shelf)

XXX : 100 grey finish, 060 brown finish

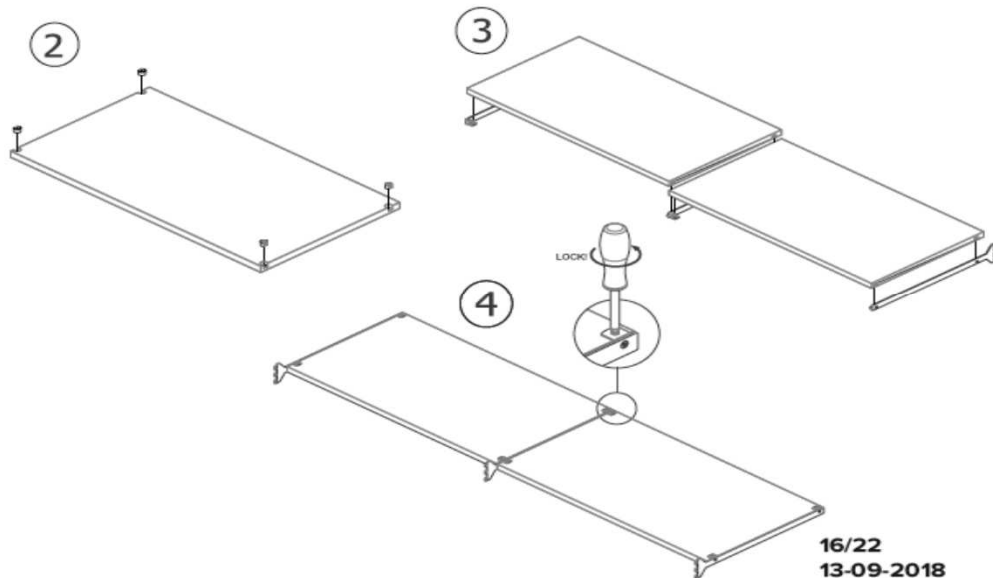
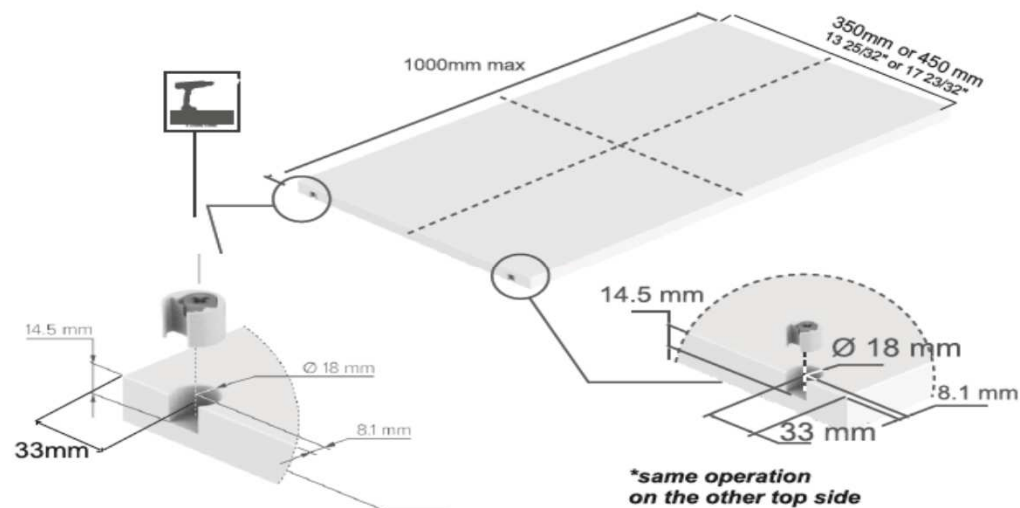
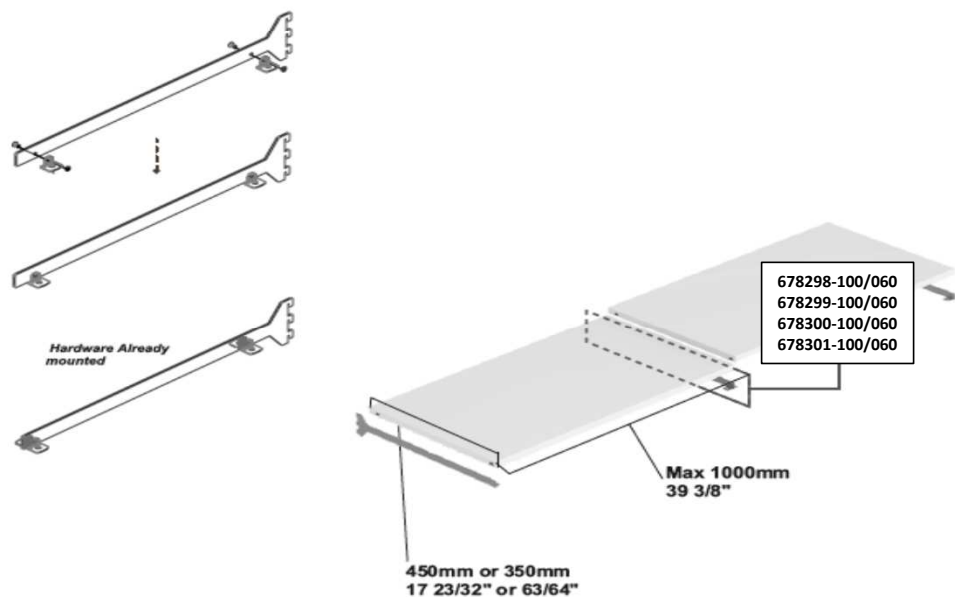

16/22  
13-09-2018

CONFIGURATION C  
CABINET APPLICATION

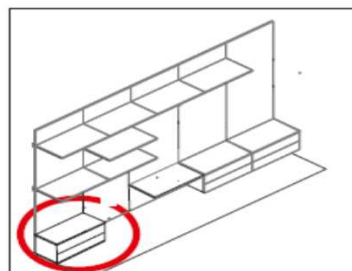

Ready cabinet to insert between 2 shelves.  
Brackets to use: as per configuraiton A)

With BRACKET of 19mm th. (art. 6781264-100/060 – 6781277-100/060

**CLEARANCE HEIGHT: 429mm**

(add or detract 32mm and multiple, if you need to change height cabinet.)

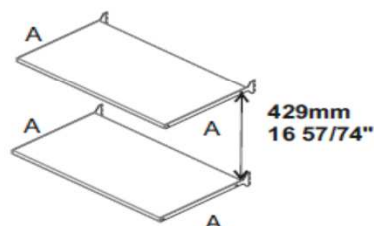

**CABINET DIMENSIONS**

HEIGHT: Min.Suggested 429mm / 16 57/74"  
DEPTH(\*): 450mm / 17 23/32" or 350mm/ 13 25/32"  
WIDTH: Max. 1000mm / 39 3/8"

*\* = Front Included*

With BRACKET of 25mm th. (art. 6781265-100/060 – 6781275-100/060

**CLEARANCE HEIGHT: 423mm**

(add or detract 32mm and multiple, if you need to change height cabinet.)

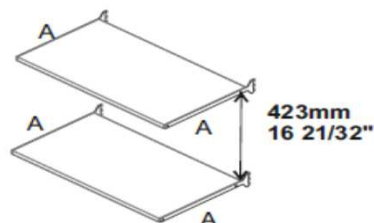

**CABINET DIMENSIONS**

HEIGHT: Min.Suggested 423mm / 16 21/32"  
DEPTH (\*): 450mm / 17 23/32" or 350mm/ 13 25/32"  
WIDTH: Max. 1000mm / 39 3/8"

*\* = Front Included*

CONFIGURATION C  
CABINET APPLICATION

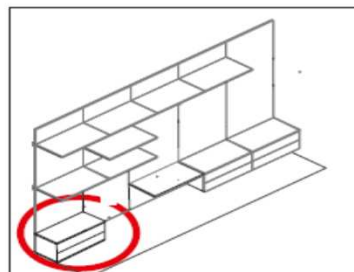

## HOW TO INSERT THE CABINET

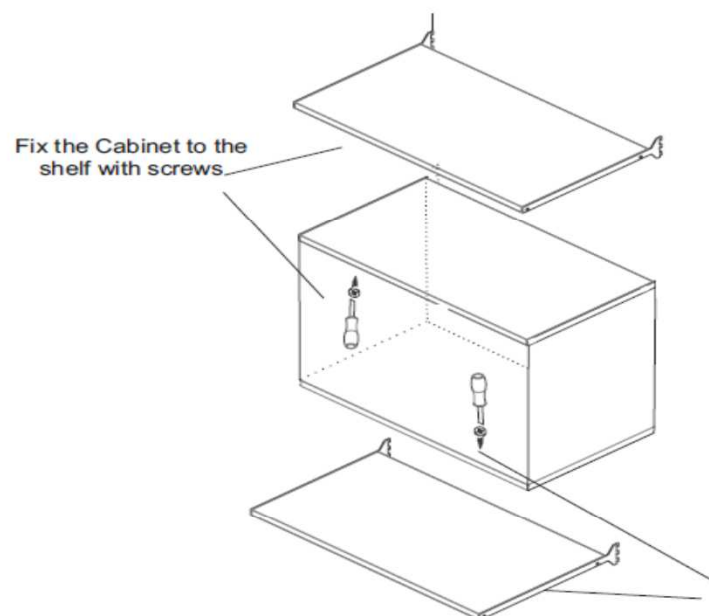
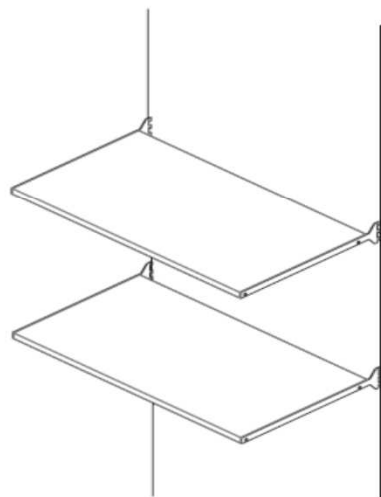

Fix the Cabinet to the  
shelf with screws

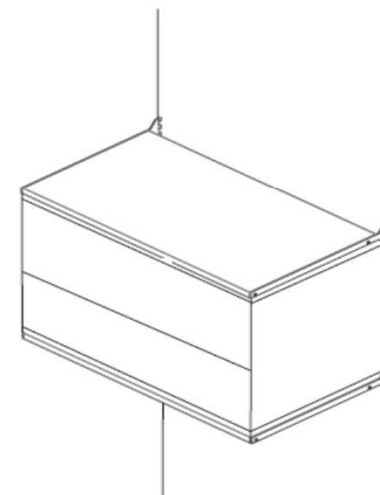

***Screws from above or below  
depending if screw visible or not***

CONFIGURATION D  
DOUBLE CABINET APPLICATION

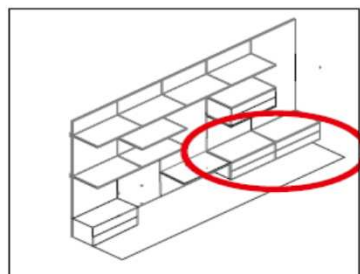
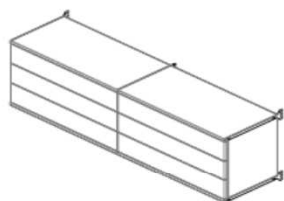

Ready double cabinet to insert between 2 shelves.  
Brackets to use: as per configuraiton B)

With BRACKET of 19mm th. (art. 678299-100/060 – 678301-100/060

**CLEARANCE HEIGHT: 429mm**

(add or detract 32mm and multiple, if you need to change height cabinet.)

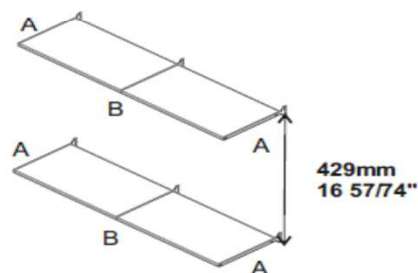

With BRACKET of 25mm th. (art. 678298-100/060 – 678300-100/060

**CLEARANCE HEIGHT: 423mm**

(add or detract 32mm and multiple, if you need to change height cabinet.)

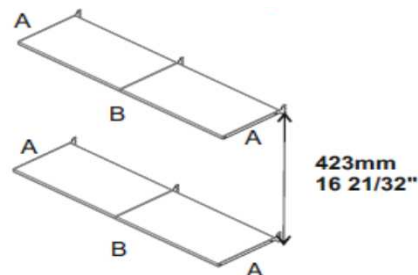

**DOUBLE CABINET DIMENSIONS**

HEIGHT: Min.Suggested 429mm / 16 57/74"  
DEPTH(\*): 450mm / 17 23/32" or 350mm/ 13 25/32"  
WIDTH: Max. 1000mm+1000mm /  
39 3/8" + 39 3/8"

**\* = Front Included**

**DOUBLE CABINET DIMENSIONS**

HEIGHT: Min. Suggested 423mm / 16 21/32"  
DEPTH(\*):450mm / 17 23/32" or 350mm / 13 25/32"  
WIDTH: Max. 1000mm + 1000mm/  
39 3/8" + 39 3/8"

**\* = Front Included**

CONFIGURATION D  
CABINET APPLICATION

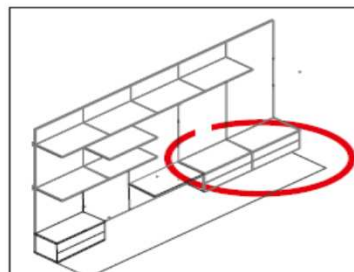

HOW TO INSERT THE CABINET

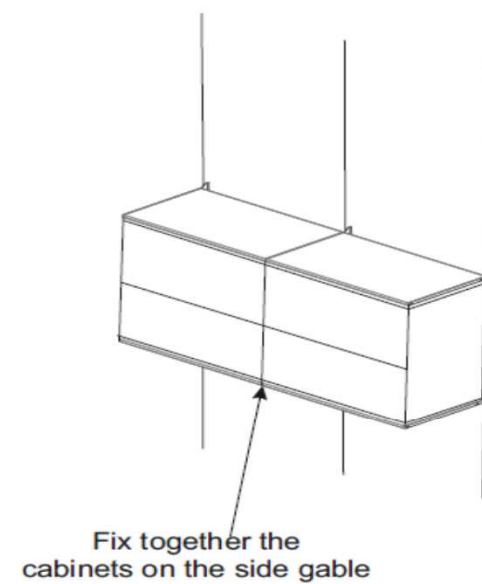
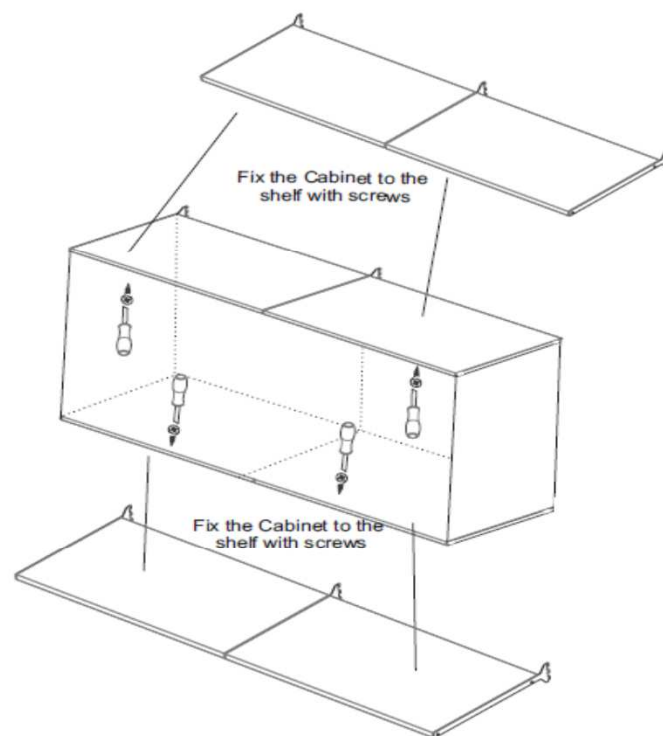
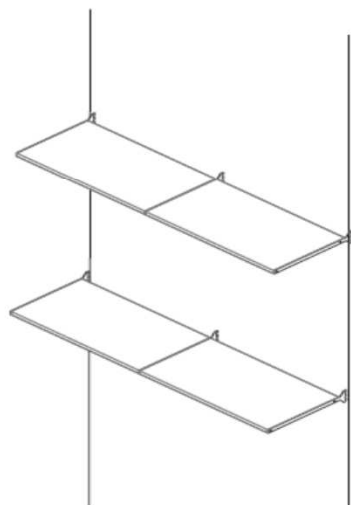



CONFIGURATION D2  
CABINET + SHELF APPLICATION

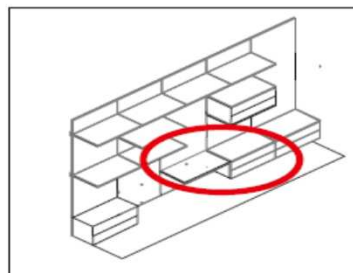
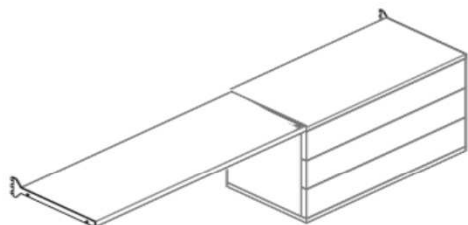

Same steps and dimensions of CONFIGURATION D.

Only difference: use only 1 cabinet to insert.

**SHELF NEEDS TO HAVE THE SAME DEPTH THAN THE CABINET**

With BRACKET of 19mm th. (art. 678299-100/060 – 678301-100/060)

**CLEARANCE HEIGHT: 429mm**

(add or detract 32mm and multiple, if you need to change height cabinet.)

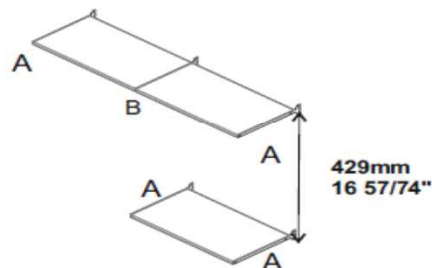

With BRACKET of 25mm th. (art. 678298-100/060 – 678300-100/060)

**CLEARANCE HEIGHT: 423mm**

(add or detract 32mm and multiple, if you need to change height cabinet.)

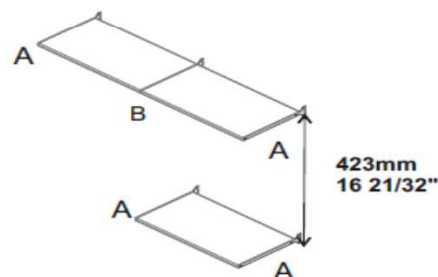

**SINGLE CABINET DIMENSIONS**

HEIGHT: Min. Suggested 429mm / 16 57/74"  
DEPTH(\*): 450mm / 17 23/32" or 350mm / 13 25/32"  
WIDTH: Max. 1000mm / 39 3/8"

**SHELF DIMENSIONS**

DEPTH(\*): 450mm / 17 23/32" or 350mm / 13 25/32"  
WIDTH : Max. 1000mm / 39 3/8"  
THICKNESS 19mm / 3/4"

\* = *Front Included*

**SINGLE CABINET DIMENSIONS**

HEIGHT: Min. Suggested 423mm / 16 21/32"  
DEPTH(\*): 450mm / 17 23/32" or 350mm / 13 25/32"  
WIDTH: Max. 1000mm / 39 3/8"

**SHELF DIMENSIONS**

DEPTH(\*): 450mm / 17 23/32" or 350mm / 13 25/32"  
WIDTH : Max. 1000mm / 39 3/8"  
THICKNESS 25mm / 63/64"

\* = *Front Included*

## CONFIGURATION E ROD APPLICATION

**ART. 678446-100/060**

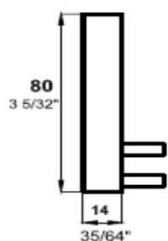

**ART. 678538-100/060**

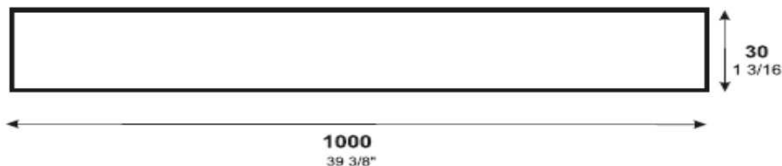

**ART. 678447-100/060**

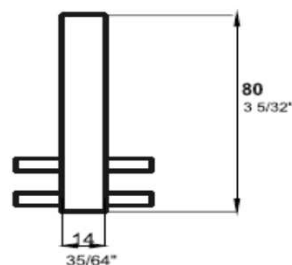

**Lateral Rod Support:** art. 678446-100/060  
**Central Rod Support:** art. 678447-100/060  
**Rod** : art. 678538-100/060

To fix Rod Support to the shelf,  
the suggestion is to use:

M5x22mm screws for 16mm th. shelf  
M5x25mm screws for 19mm th. shelf  
M5x30mm screws for 25mm th. shelf

Screws not included.

*\*= variance in screw length of +/- 1 mm,  
is acceptable*

What to **CONSIDER** to determinate the rod cut:

for Aesthetic Reason: **6 mm ( 15/64")** gap to side panel

Overall of each support (lateral/ central) : **14mm (35/64")**

*Example:*

*rod= 1000mm / 39 3/8"*

*panel width= 800mm / 31 1/2"*

*Rod cut= 1000-200= 800(panel width) -6-6-14-14= 760mm / 29 59/64"*

