

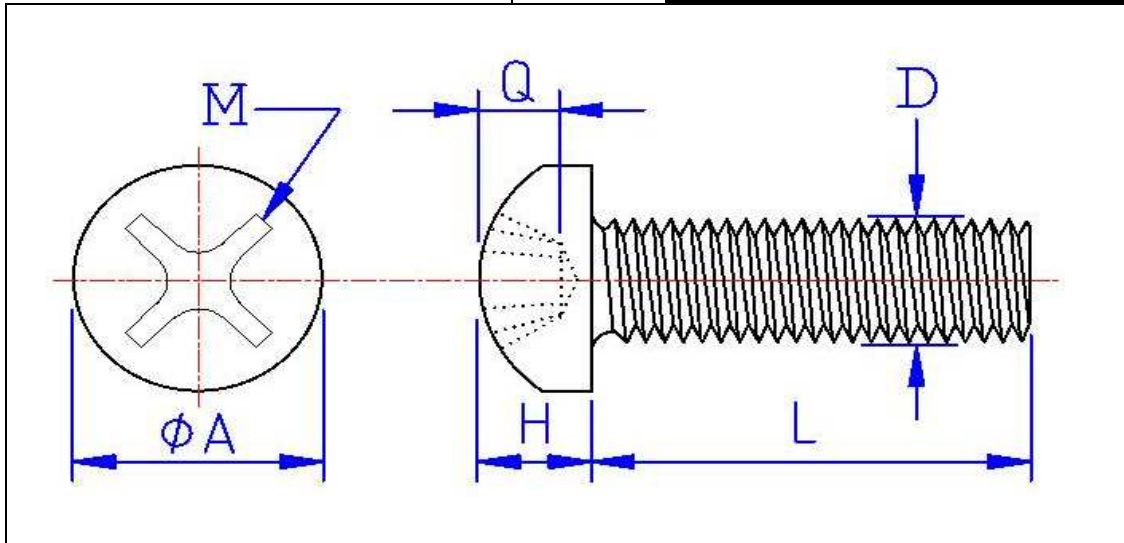

Brand	Root
	<b>PPMZM...</b>



unit: MM  
ISO 7045

<b>L</b> LENGTH TOLERANCE	≤ 13mm	+ 0	- 0.5
	> 13mm to ≤ 25mm	+ 0	- 0.7
	> 25mm to ≤ 50mm	+ 0	- 1.5
	> 50mm	+ 0	- 2.3

**FULL THREAD**

SCREW SIZE	M PUNCH		Q DRIVE DEPTH	H HEAD HEIGHT	A HEAD DIAM.	D THREAD DIAM.	THREAD PITCH MM
M3	# 1	Min	1.400	2.260	5.300	2.874	0.5
		Max	1.800	2.400	5.600	2.980	
M4	# 2	Min	1.900	2.920	7.640	3.838	0.7
		Max	2.400	3.100	8.000	3.978	
M5	# 2	Min	2.500	3.520	9.140	4.826	0.8
		Max	2.900	3.700	9.500	4.976	
M6	# 3	Min	3.100	4.300	11.570	5.794	1
		Max	3.600	4.600	12.000	5.974	
M8	# 4	Min	4.000	5.700	15.570	7.760	1.25
		Max	4.600	6.000	16.000	7.972	

**Pan head, Phillips drive, Machine screw, Zinc plated (CLASS 4.8)**

Root = Pan Phillips Machine Zinc Metric

**Bulk Label Description:**

- English: PAN HEAD, PHILLIPS, MACHINE SCREW, ZINC
- French: VIS MACHINE, TÊTE PAN, CRUCIFORME, ZINC
- Spanish: TORNILLOS DE MÁQUINA, CABEZA REDONDA, CRUCIFORME, ZINC

Date : 17 janvier 2019

Done by : P.B.