

R 908 Series - 84mm Inner Drawer Components

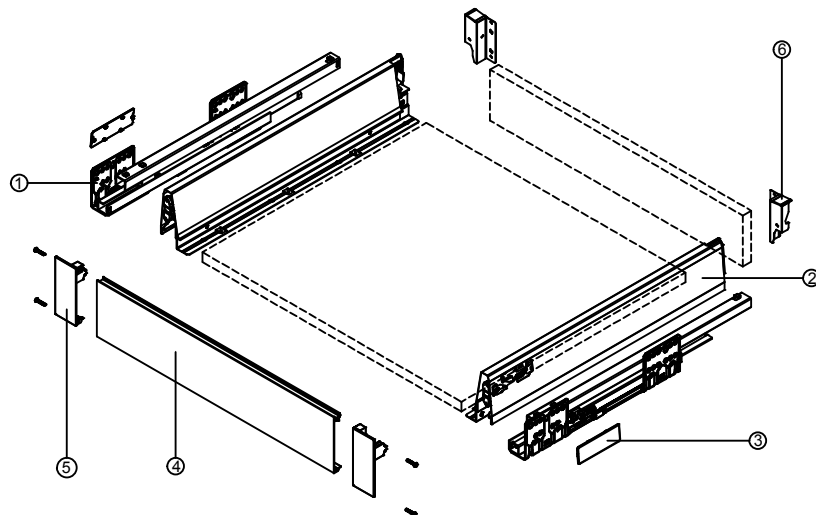

- 1. Slides (L/R)
- 2. Drawer profiles (L/R)
- 3. Cover caps
- 4. Front panel
- 5. 84 Inner front brackets
- 6. 84 Rear brackets

Nominal length	Internal drawer length	Min.installation length of drawer
270mm	244mm	280mm
300mm	274mm	310mm
350mm	324mm	360mm
400mm	374mm	410mm
450mm	424mm	460mm
500mm	474mm	510mm
550mm	524mm	560mm

Slide installation

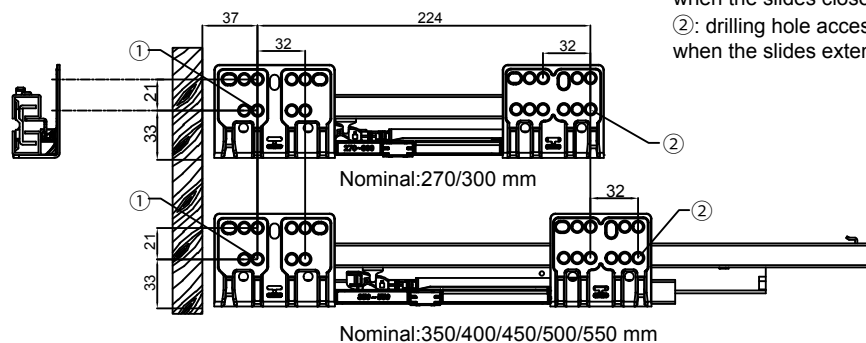

- ①: drilling hole accessible when the slides are closed.
- ②: drilling hole accessible when the slides are extended.

R 908 series - 84mm Inner Drawer

Assembling dimensions of cabinet

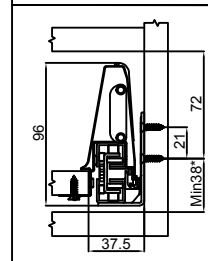

Drawer back

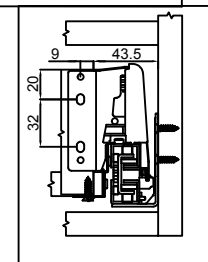

* Please note additional clearance required beneath the drawer slides.

Bottom and back panels measurement

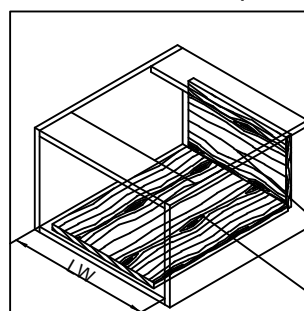

16mm Thickness panel
LW: Internal cabinet width

Nominal Length:
270/300/350/400/450/500/550mm

Back panel height= 84
Back panel width= $LW-87\pm0.5$

Bottom panel width= $LW-75\pm0.5$
Bottom panel length= Nominal length-24mm

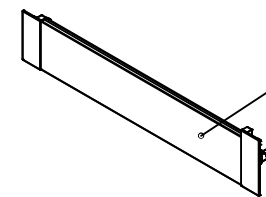

Aluminium front panel width = $LW-87\pm0.5$

* Please note additional clearance required beneath the drawer slides.

Install inner drawer front

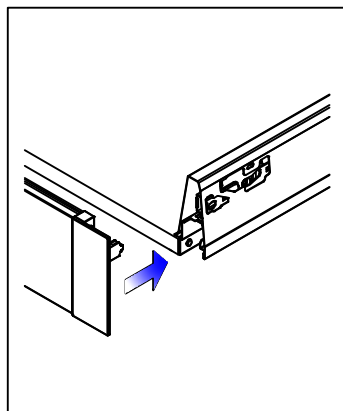
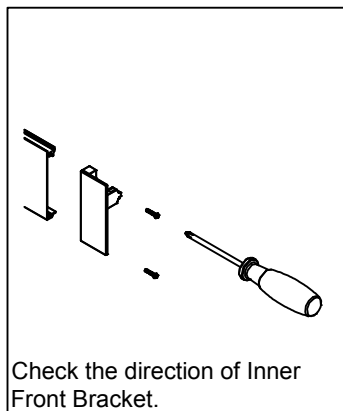

Disassemble inner drawer front

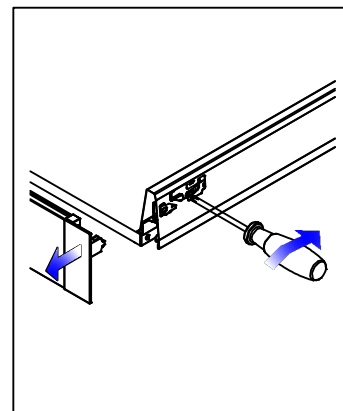
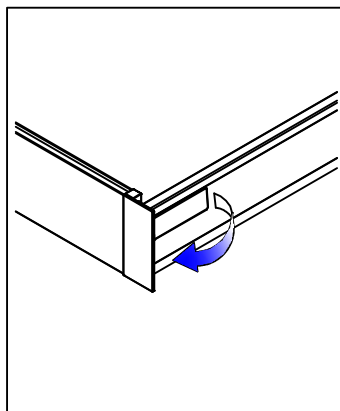

Drawer assembly

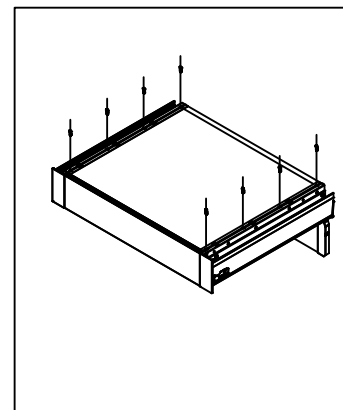
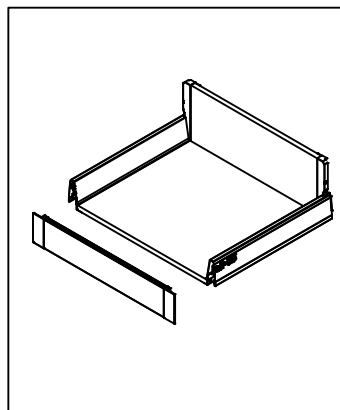
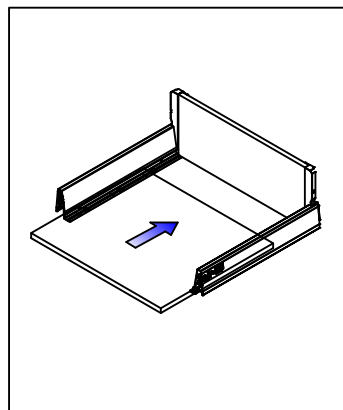
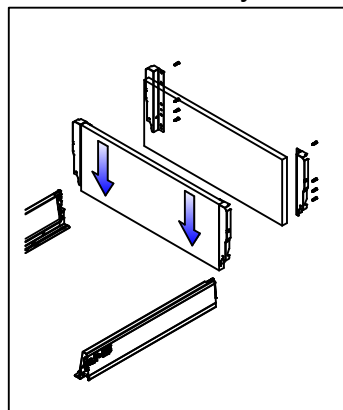

Inner drawer front height adjustment $\pm 2\text{mm}$

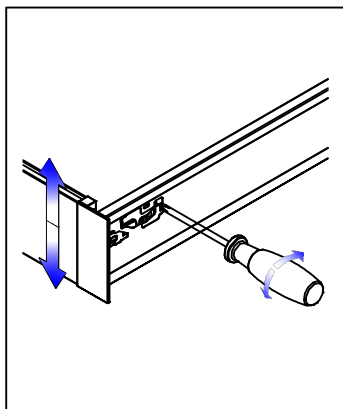

Ensure clearance to open drawer

