

PURCHASE P/N	FINISH
TRSC-12	CHROME
TRSS-12	SATIN NICKEL
TRSO-12	OIL RUBBED BRONZE

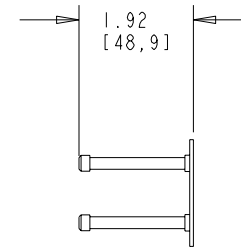
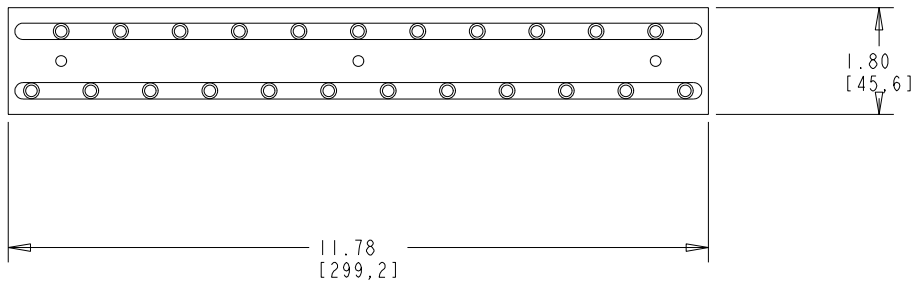

This drawing is the property of Rev-A-Shelf (RAS) and is disclosed in confidence to the extent its subject matter is original to RAS. Any vendor receiving this drawing from RAS shall hold and use this drawing for the sole benefit of RAS and shall not disclose it to, or use or reproduce it for any third party, or perform any act adverse to the interest of RAS with respect to this drawing without the express written permission of RAS. Vendors shall not revise any physical, dimensional or performance characteristic unless authorized by Rev-A-Shelf Engineering.

REV.	DATE	BY	DESCRIPTION OF CHANGE
A	12/13/11	BKT	ECN11-073

INCH [MM]	AMERICAN PROJECTION	DRAWN	BY	DATE	REV-A-SHELF, INC.		
		BKT		7/8/2011	SIZE B	TIE RACK STATIC 12"	
TOLERANCES		ANGLES	MATERIAL		DRAWING NO.	TRSI2	SCALE
MAT. DEC. (WOOD) .XX ±.03 [8mm]		±1/2"	FINISH		PART NO.	SEE ABOVE	SHEET OF
(OTHER) .XX ±.02 [5mm]							2
(ALL) .XX ±.005 [13 mm]							
FRACTIONS ±1/32 [8 mm]							