

Installation Instructions

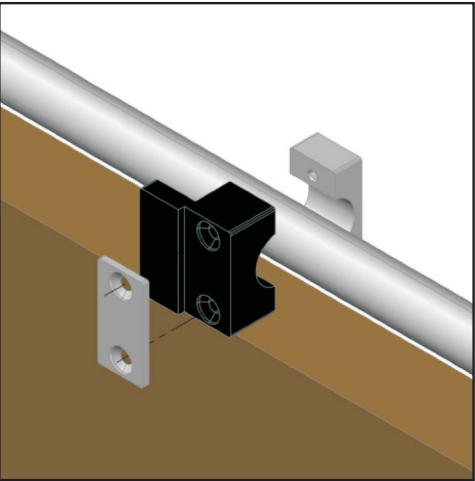

- STEP 6**
Install stoppers
- Install the door stoppers on the left and right ends of the running rail.
 - **WARNING:**
To prevent sliding door from sliding off the running rail during installation.

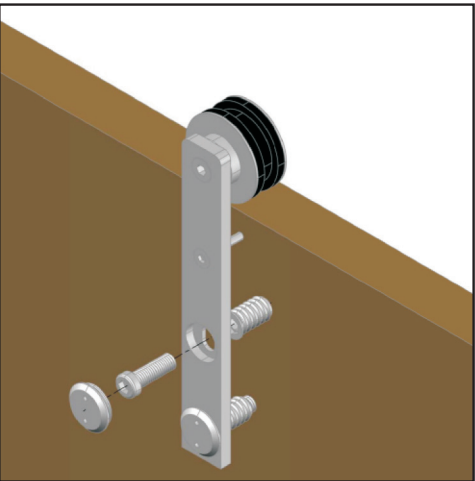

- STEP 7**
Fastening the roller carriage
- Before installing the roller carriage on your wood door, be sure to outline the correct position and pre-drill your holes.
 - Remove lift-locking device and threaded rings from the roller carriage.
 - Screw the threaded rings into the pre-drilled holes on the wooden door panel.
 - Affix roller carriage to wooden door panel using included screws. Tighten by hand. Use included screw caps to hide cover screw heads.

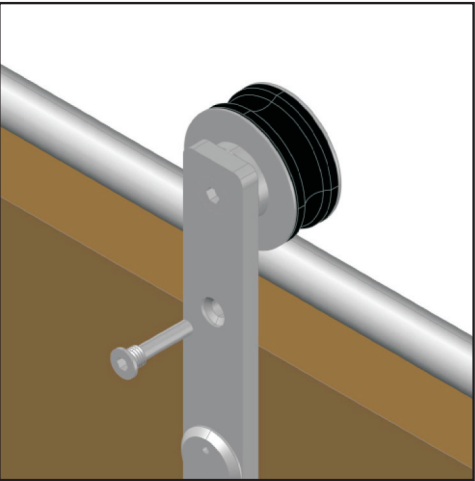

- STEP 8**
Hanging the glass sliding door panel and fastening the lift-locking device
- Hang assembled sliding door onto the running rail.
 - **FOR SECURITY REASONS:** Put plastic wedges under sliding door panel and ensure 7mm-10mm spacing.
 - Slide door panel into floor guide.
 - Re-fasten the lift-locking device on the roller carriage.
 - **WARNING:**
Lift-locking device should not hit running rail!
 - Remove plastic wedges.

Installation Instructions

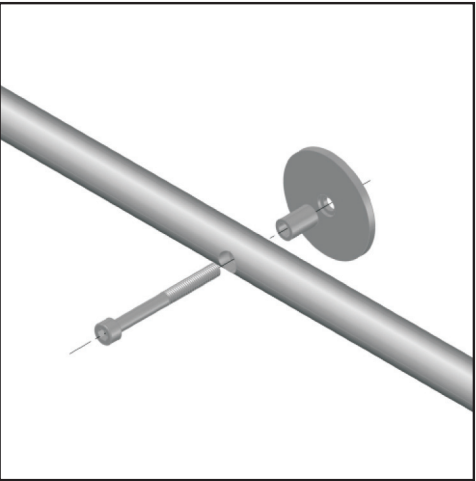

- STEP 3**
Fasten running rail on wall
- Fasten both extremities of the running rail on the wall with the back plate and sleeve using the enclosed fastening devices.

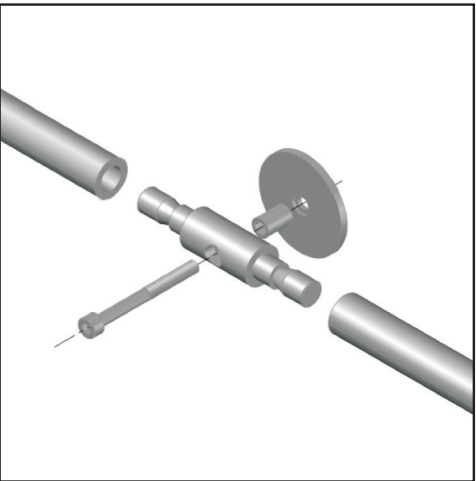

- STEP 4**
Fasten running rail connector if installing a door 34" - 48"
- Join both extremities of the running rail and connector together with the back plate and sleeve using the enclosed fastening devices.
 - **WARNING:**
If you have bought ADDITIONAL ITEM 1, you will have 2 connectors to install.

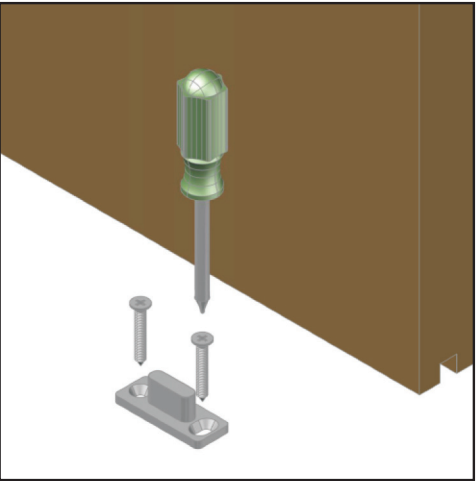

- STEP 5**
Fasten floor guide
- Fasten the floor guide to the floor according to the detailed technical drawing.
 - **WARNING:**
The door leaf should run parallel to the wall and be positioned at the desired distance from the wall.



Installation Instructions

(8916604170)

Installation Instructions



- You need**
- Spirit level
 - Measuring tape/foot rule
 - Power drill
 - 8mm/10mm drill bit for stone
 - Phillips screwdriver
 - Allen key set
 - Plastic wedges
- Please see safety instructions on power drill before starting assembly.

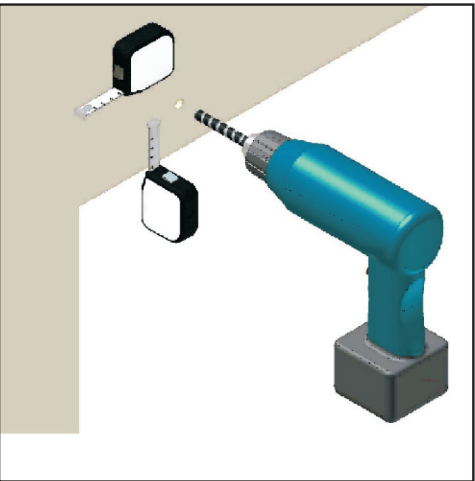

- STEP 1**
First wall drilling
- Drill hole for exterior fastening of running rail on wall according to detailed drawing.

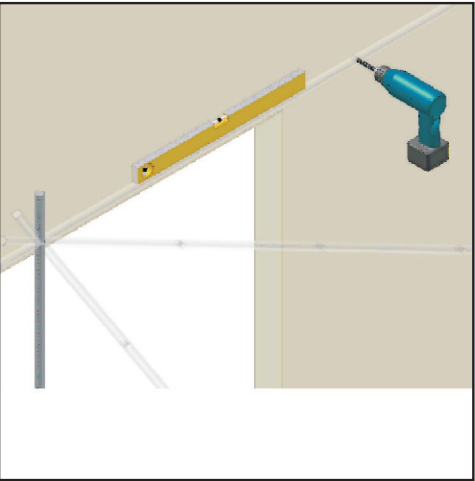

- STEP 2**
Remaining wall drillings
- «Loosely» screw on the exterior end of the running rail. Using the spirit level, ensure the running rail will be horizontally straight and use it as a drilling jig to pre-drill the fastening holes with an 8mm drill bit. Drill the holes for the screw anchors with a 10mm drill bit.

8916604170 STRAP MOUNT HANGER SLIDING DOOR KIT

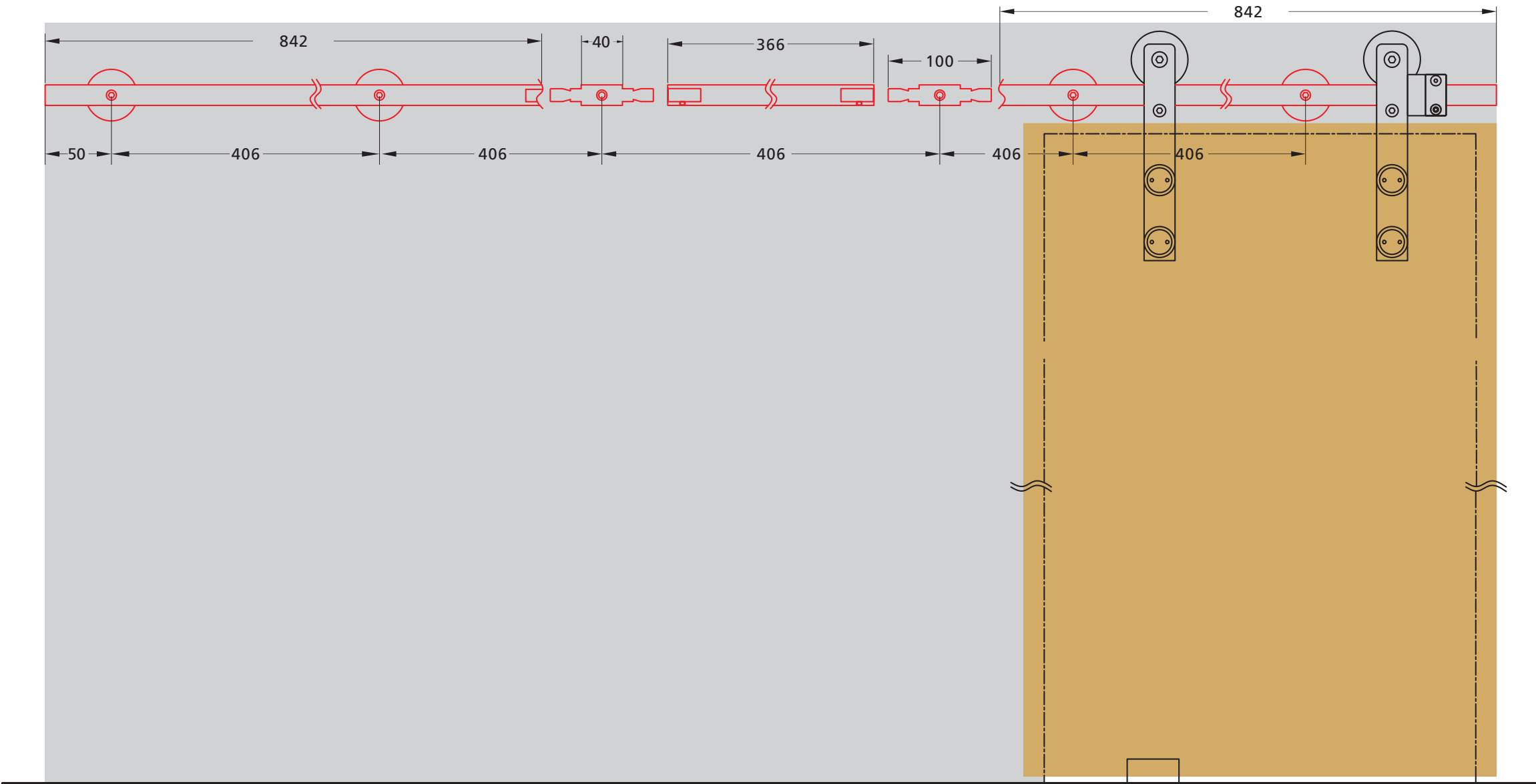

PARTS LIST (FOR 1 DOOR KIT)

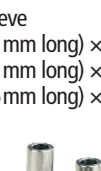
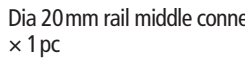
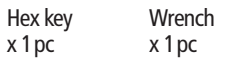
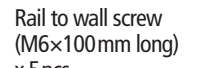
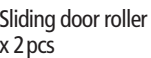

ADDITIONAL ITEM 1
(Item: 89166010170)

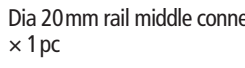
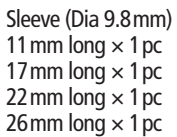
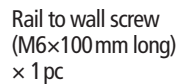
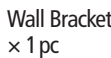

ADDITIONAL ITEM 2
(Item: 89970A1002S)

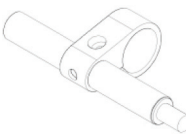

ADDITIONAL ITEM 3
(Item: 970A1002)



8916604170 STRAP MOUNT HANGER SLIDING DOOR KIT

