

Bracket

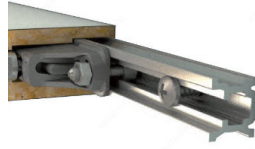

Triade



Triade Profile Support

**COMBINATION SHELF LOAD AND SHELF DEPTH (The figures refer to 1 shelf support)**

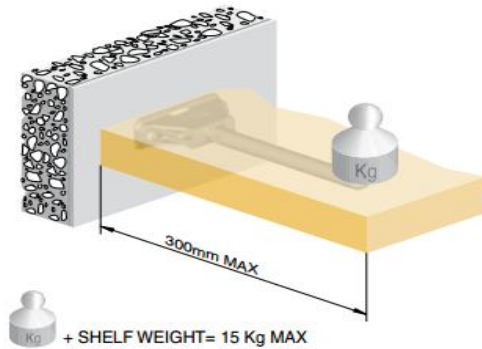
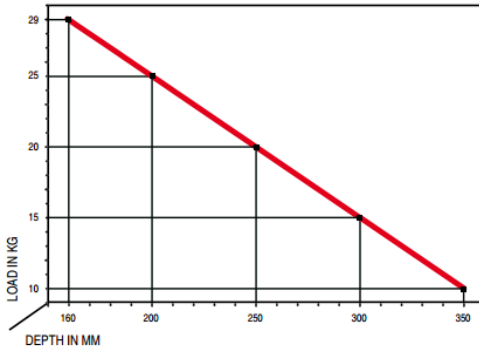

**TRIADE** : the concealed way to support shelves of great thickness!  
 With three independent adjustments, you will be able to set your shelves the exact way you visualized them!



## Advantages/Benefits

- ✓ Useful for both flat-pack and rigid furniture, this support is ideal for transport as it secures the shelf in position.
- ✓ Easy and quick installation.
- ✓ Adjustable in height, you can align it vertically with the slots (2,5mm).
- ✓ While placing the shelf in position, the supporting pins can be slid horizontally (2,5mm).
- ✓ When the shelf is partially inserted, the shelf angle can be adjusted front to back by turning the supporting pins with a 10mm open-ended wrench.
- ✓ A locking bolt will conserve your adjustments.
- ✓ A bracket (sold separately) improve the load capacity; it distributes the shelf load on the wall through a Ø8mm pin.
- ✓ Made of zinc alloy and steel material.
- ✓ Exclusive to Richelieu.



## Important information

- ✓ **It is strongly recommended to use the bracket in combination with the Triade to increase the load rating**

Product number	Description	Shelf Thickness	Finish
1621512G	Triade Concealed Shelf Support	25 to 40 mm (1" to 1-9/16")	Nickel
111682G	Triade brackets support for Concrete Walls		
1622410	Triade Profile Support for Drywall Walls		
BP1622G	Hardware for Triade Profile Support		



Technical drawings

## TRIADE

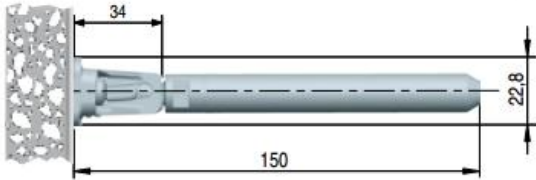

For shelf 25-30mm thick

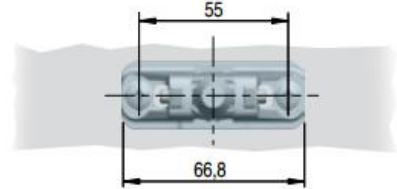
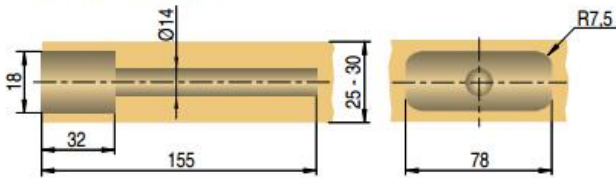

For shelf 30mm thick and above

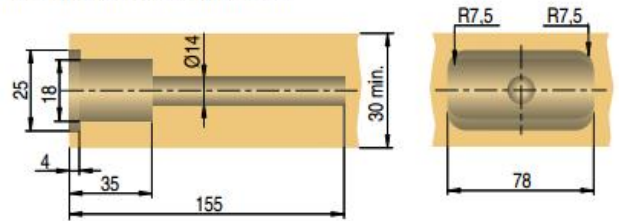

## Bracket

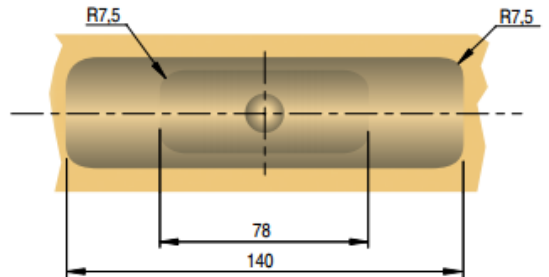
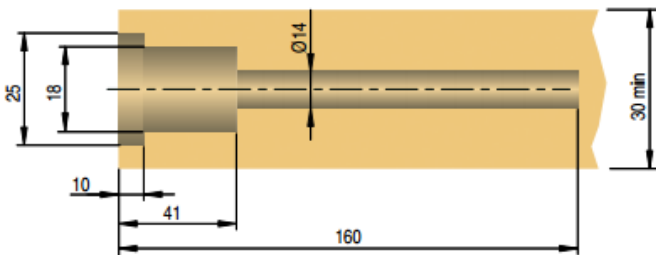
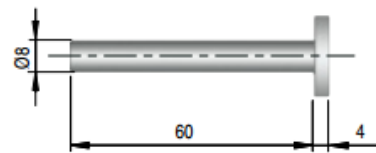
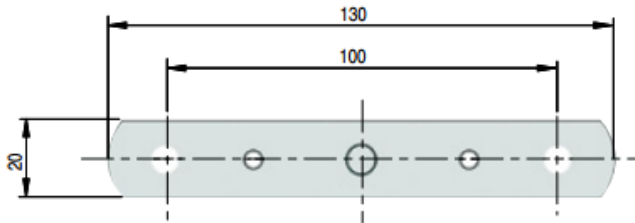



Installation TRIADE alone and TRIADE with bracket

## FIXING TO CEMENT WALL

### VERY IMPORTANT

Triade has to be installed with the writing "TOP - ALTO" facing upwards.

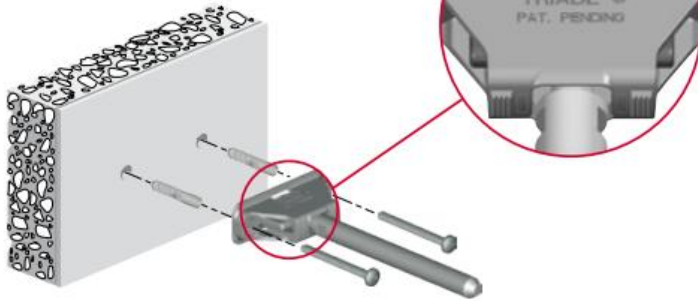

### Fixing:

- to cement wall with rawplugs Ø 8mm & pan head screws Ø 5x50mm.
- to wood panels with pan head wood screws Ø 5mm.
- to plaster boards with umbrella fittings Ø 8mm & pan head screws M4x46mm.

### It is the responsibility of the customer:

- to ensure the wall is of a suitable quality to hold the shelf fixing in place.
- to use the proper hardware fittings according to the construction of the wall.

## FIXING TO WALL

Fixing the TRIADE onto the bracket with pan head screws M5x12mm.

### Fixing the assembled TRIADE & bracket:

- to cement wall with rawplugs Ø 8mm & pan head screws Ø 5x50mm.
- to wood panel with 2 pan head wood screws Ø 5mm.
- to plaster board with umbrella fittings Ø 8mm & pan head screws M4x16mm.

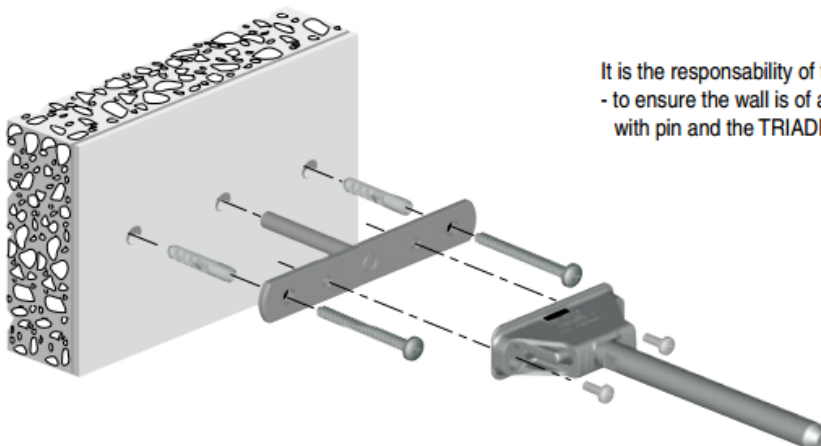

### It is the responsibility of the customer:

- to ensure the wall is of a suitable quality to hold both the inserting of the bracket with pin and the TRIADE in place.

## ! Adjustments

### VERTICAL ADJUSTMENT

RELEASE THE FIXING SCREWS

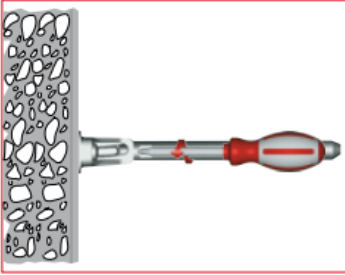

ALIGN BRACKETS VERTICALLY ACCORDINGLY

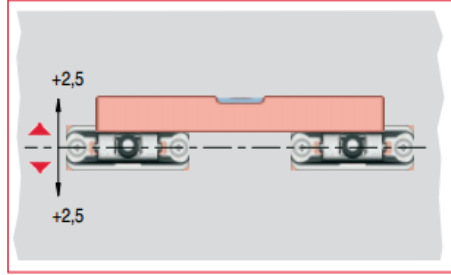

TIGHT THE FIXING SCREWS

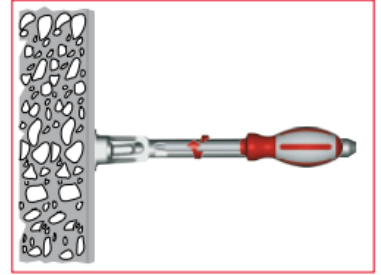

### SHELF INSERTING AND HORIZONTAL ADJUSTMENT

TILT THE SHELF TO MATCH BOTH SUPPORTING PINS AND SHELF HOUSINGS

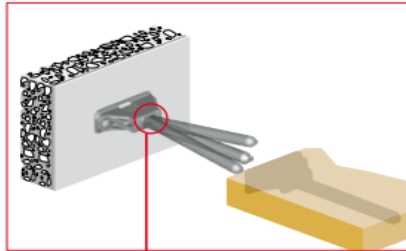

INSERT PARTIALLY THE SHELF

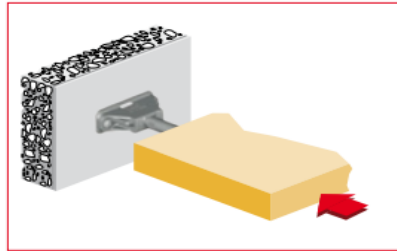

ADJUST THE SHELF HORIZONTALLY ACCORDING TO THE APPLICATION (i.e. MULTI-SHELF COMPOSITION)

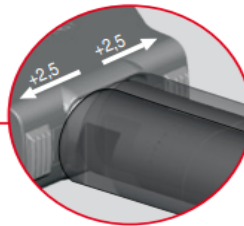
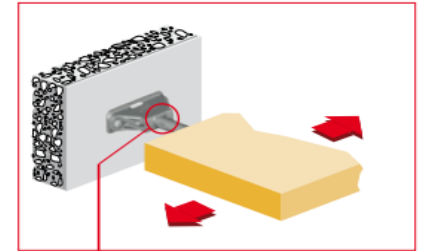

### INCLINATION ADJUSTMENT

TURN CLOCKWISE THE SUPPORTING PIN WITH A 12mm OPEN-ENDED WRENCH TO ADJUST THE SHELF ANGLE FRONT TO BACK ACCORDINGLY

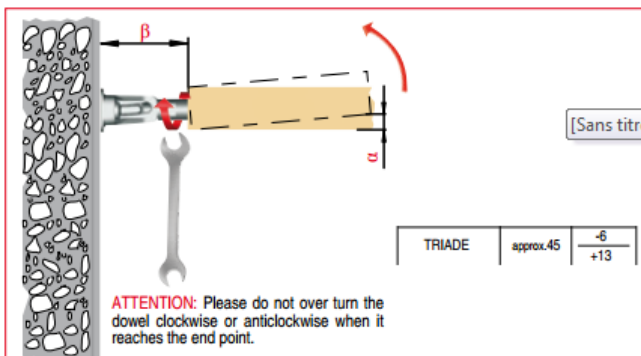

SCREW THE LOCKING BOLT TO BLOCK THE PIN

