

## 2002 Pocket Door Lock / Pull (#2002CPDL)

3/4" Backset

Operation\*:

- 2002 CPDL-1 By Key Outside Only
- 2002 CPDL-2 By Key Outside and Inside
- 2002 CPDL-3 By Key Outside, Thumb turn Inside
- 2002 CPDL-4 By Thumb turn Inside Only
- 2002 CPDL-5 By Thumb turn Inside, Emergency key Outside

*\*Numbers are for specification and door preparation purposes. The lock itself is the same for all operations.*



CASE:

Heavy Gauge, Wrought (11/16" thick)

DEAD BOLT:

1/2" thick, 1 7/32" high, 1" Throw

PULL:

1/2" thick, 2" high, 1 1/4" throw

THUMB TURN HUB:

3/16" (5mm) on the diamond

STRIKE:

Single doors: 3 1/2" x 1"

Double doors: refer to #2002CPDS

ARMOR FRONT:

Brass

CYLINDER:

Available to order (3/4" length)

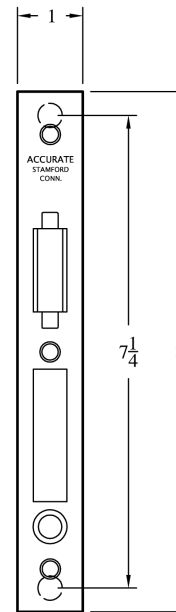
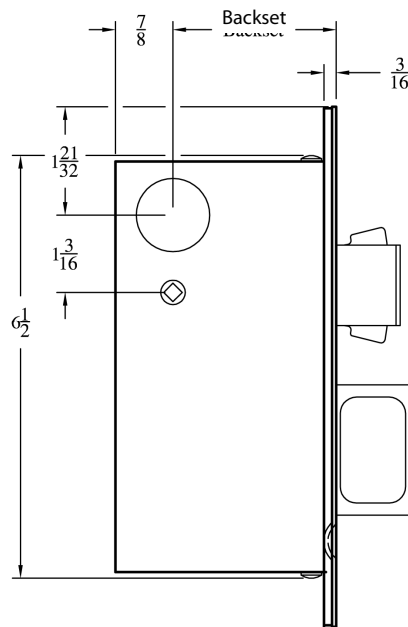

SUGGESTED TRIM:	CPDL-1	CPDL-2	CPDL-3	CPDL-4	CPDL-5
Inside	Optional A2002B, S2002B	A2002C, S2002C	A2002T, S2002T	A2002T, S2002T	A2002T, S2002T
Outside	A2002C, S2002C	A2002C, S2002C	A2002C, S2002C	Optional A2002B, S2002B	A2002E, S2002E