

Electrical ironing board for recessed mounting.



Advantages

- Designed for recessed mounting, but can also be surface mount. Read mounting instructions consequently.
- Ventilated steel board allowing humidity caused by the iron to dry faster.
- Door mounted on piano hinge with right hand opening (E421) or left hand opening (E4213).
- Unfinished maple veneer door include a roller catch to keep it closed.
- Locking device to hold the board lift up when opening the door.
- Electrical box including a light, a timer and a push button switch.



Suggested product
Replacement cover pad
001500



Code	Description	Dimensions W x D x H	Replace
E421	DE LUXE IRON BOARD R.H. MAPLE	15" x 7 3/4" x 52"	E3420203
E4213	DE LUXE IRON BOARD L.H. MAPLE	15" x 7 3/4" x 52"	E3420303

Technical information

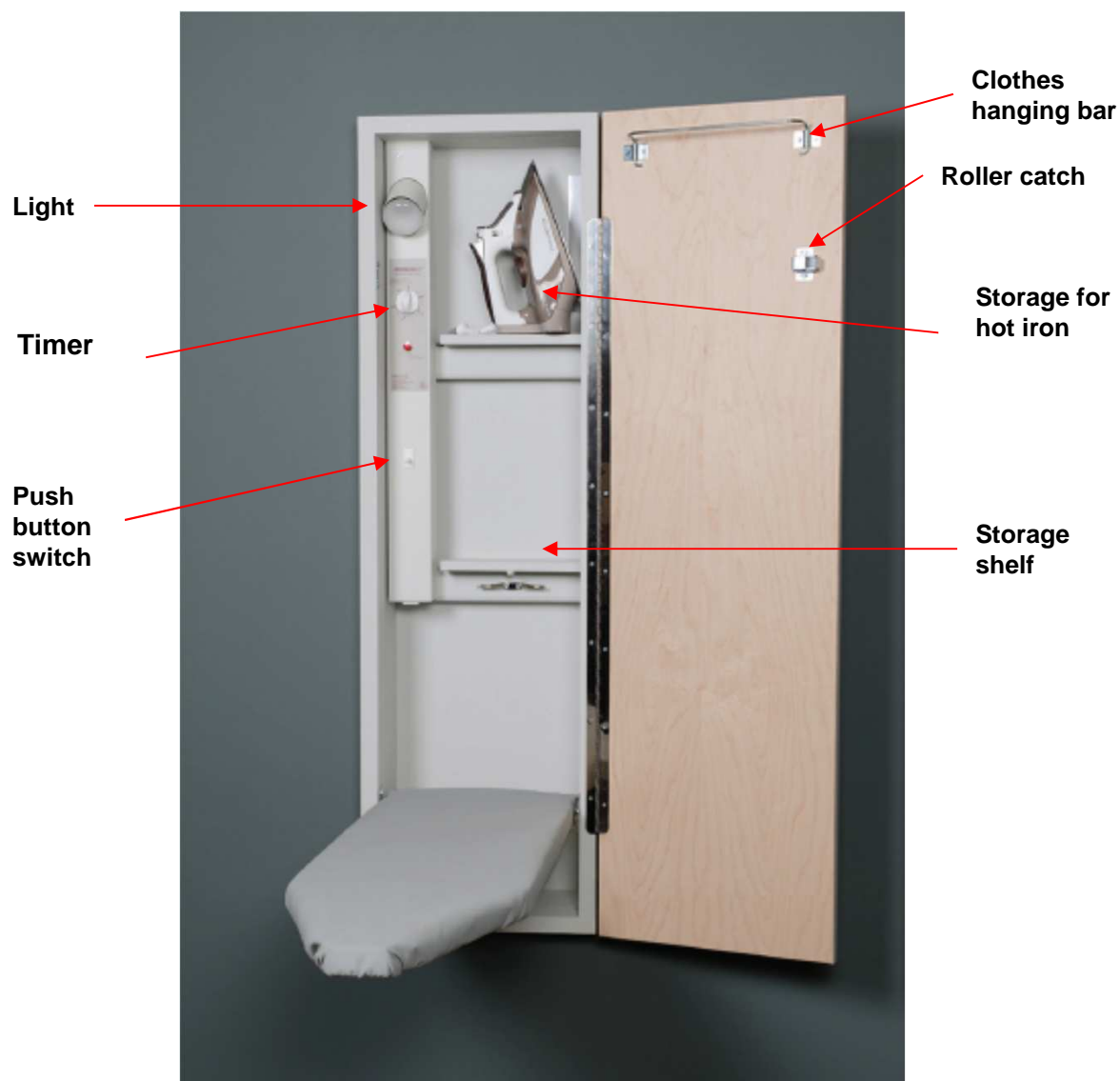

Technical information

Old model

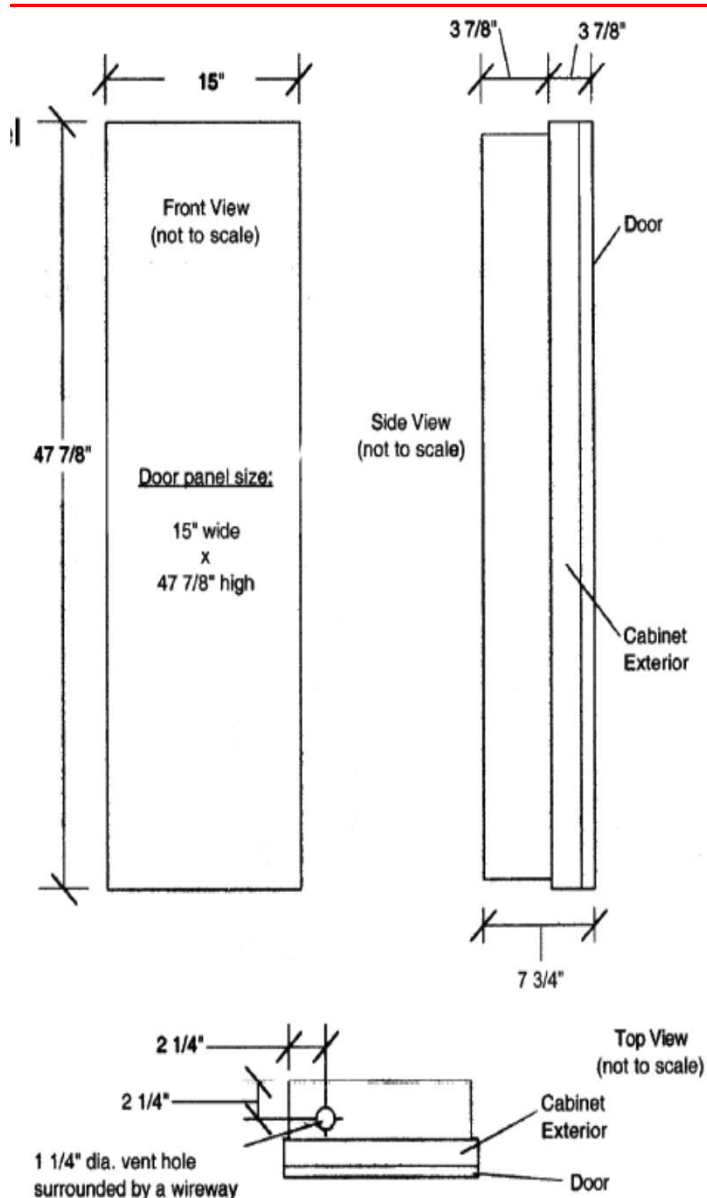

New model

